

## **NOTE FOR PUBLIC WORKS SUBCOMMITTEE OF FINANCE COMMITTEE**

### **Supplementary information on 375RO – District open space in Areas 3 and 8, Tsing Yi**

#### **INTRODUCTION**

In considering the paper referenced PWSC(2002-03)42 on project **375RO** “District open space in Areas 3 and 8, Tsing Yi” at the Public Works Subcommittee meeting on 12 June 2002, Members sought additional information on the design details of the project.

#### **THE ADMINISTRATION’S RESPONSE**

2. The scope of **375RO** comprises a 3.1-hectare waterfront promenade and a one-hectare landscaped garden. The layout and design plan is at Enclosure 1. Details on the proposed facilities for the waterfront promenade and the landscaped garden are at Enclosures 2 and 3 respectively.

-----  
-----  
  
-----  
  
Home Affairs Bureau  
July 2002

**375RO – District open space in Areas 3 and 8, Tsing Yi**

**Proposed Facilities for the Waterfront Promenade**

(a) Design concept –

A contemporary design open space with dynamic waterfront theme and special design in contrasting colours and different levels to match with the passive and active recreational facilities.

(b) Facilities –

- (i) functional and modern form pergolas and pavilions with seating;
- (ii) a jogging track/footpath paved with pleasant and lively pattern in warm and contrasting colours;
- (iii) a pebble foot massage path;
- (iv) dynamic and colourful fitness stations with safety matting and equipment for both youngsters and the elderly;
- (v) a multi-functional open area with paving to demarcate a performance area;
- (vi) a rhythmic and colourful seawall railing with life buoys, pole lights and warning notices at intervals;
- (vii) continuous planting along interface with adjoining residential developments, sports ground and bus terminus;
- (viii) lawn with earth mounds and trees with wide crown to provide shading;
- (ix) tree plaza with trees regularly arranged to provide continuous greenery and shading; and
- (x) a functional service building with direct vehicular access and parking spaces for operational vehicles.

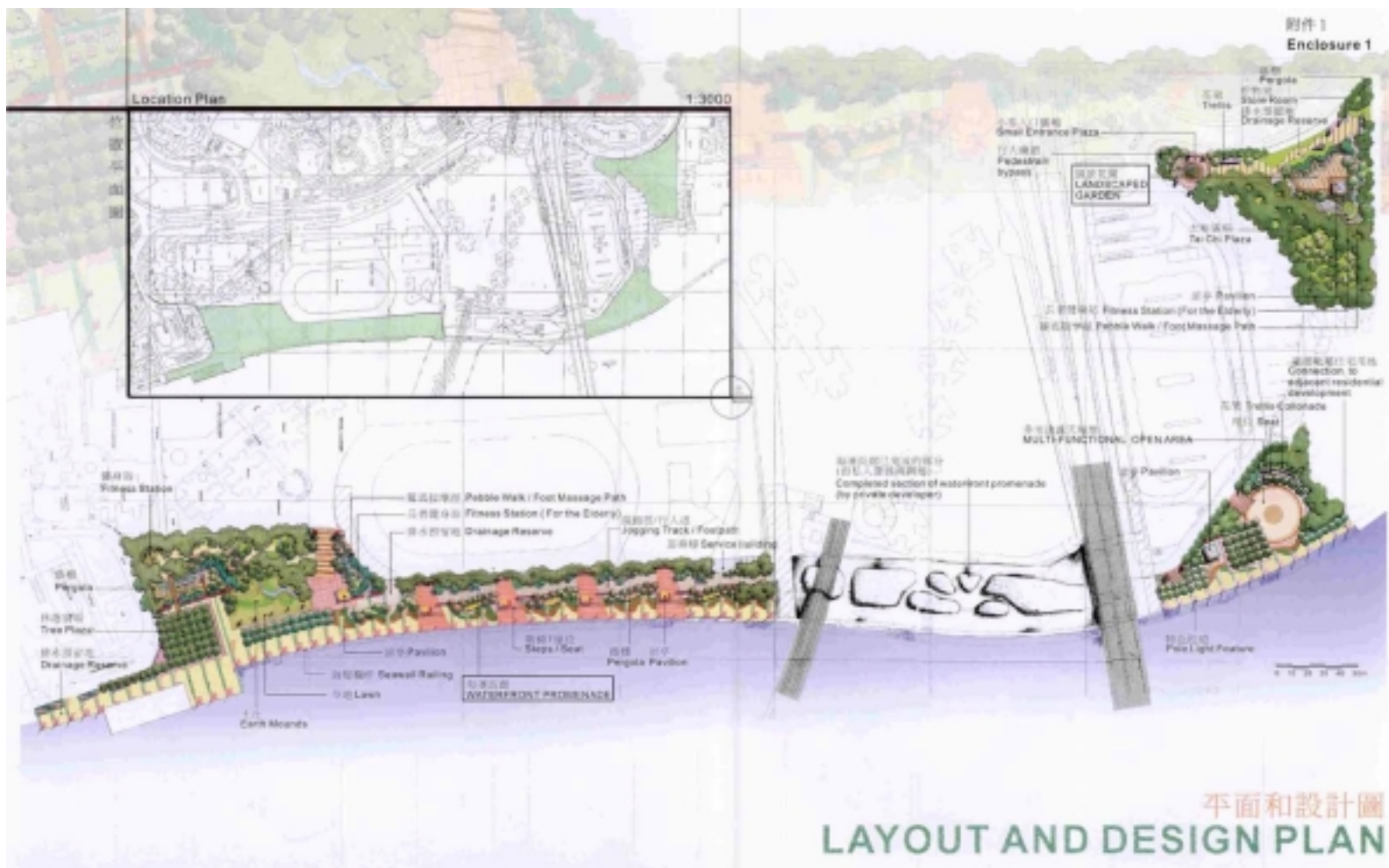

平面和設計圖  
**LAYOUT AND DESIGN PLAN**



375RO青衣第3及8區的地區休憩用地  
 375RO DISTRICT OPEN SPACE IN AREAS 3 AND 8, TSING YI

**375RO – District open space in Areas 3 and 8, Tsing Yi**

**Proposed Facilities for the Landscaped Garden**

(a) Design concept –

A contemporary design inward-looking garden with naturalistic layout, sculptural form of planting and landscaped hardwork to provide a tranquillity mood.

(b) Facilities –

- (i) functional and modern form pavilion, pergola and trellis with seating;
- (ii) a Tai Chi plaza with granite stone slabs and seat wall;
- (iii) bamboo grove along Tai Chi plaza;
- (iv) a pebble foot massage path with continuous railing and fitness stations for the elderly;
- (v) continuous peripheral planting to provide buffer between the park and the adjacent vehicular/pedestrian traffic;
- (vi) a small entrance plaza;
- (vii) peripheral seating along the pedestrian bypass and landscape planting as a natural screen towards the adjacent road; and
- (viii) a functional store room.