

For discussion
on 14 April 2008

**LEGISLATIVE COUNCIL
PANEL ON WELFARE SERVICES**

**Setting up an Integrated Community Mental Health
Support Services Centre and a Long Stay Care Home
in Tin Shui Wai Area 109**

Purpose

This paper seeks Members' support for the Administration's proposal to set up an integrated community mental health support services centre (ICMHSSC) and a long stay care home (LSCH) for discharged chronic mental patients in Tin Shui Wai (TSW) Area 109.

The Administration's Proposal

2. The Social Welfare Department (SWD) and the Hospital Authority plan to construct a joint-user complex in TSW Area 109 for the provision of primary health care and welfare services. The health care facilities will include a general out-patient clinic, a community multi-specialty clinic and an integrated clinic. The welfare facilities are made up of the following components :

- (a) an ICMHSSC providing integrated community support services on mental health; and
- (b) a 75-place LSCH for discharged chronic mental patients.

3. The site is located in TSW Area 109, with an area of about 2 220 m². The site plan is at **Annex A**. We propose to construct a building with a construction floor area (CFA) of about 11 500 m², 5 600 m²

of which will be earmarked for the welfare facilities, i.e. the ICMHSSC and LSCH. The health care facilities will occupy G/F to 2/F of the building, while the LSCH is located on 3/F and 4/F, and the ICMHSSC on 5/F. As this project will be implemented under the Design and Build (D&B) contract, the above CFA figures are indicative only, and are subject to review following the award of the D&B contract.

The Welfare Facilities

4. The focus of this paper is on the welfare facilities to be provided under the project, viz. the ICMHSSC and the LSCH.

5. At present, there are two Community Mental Health Link (CMHL) units, four Community Mental Health Care Services (CMHC) units, one Community Rehabilitation Day Services (CRDS) unit and one Community Mental Health Intervention Project (CoMHIP) team providing community support services for persons with mental health problems in TSW and Yuen Long district. Details of these services are at **Annex B**. These services are operated by different Non-governmental Organisations (NGOs). While these programmes seek to provide tailored services for respective target groups of persons with mental health needs, the service users are required to approach different NGOs/service units for different services at their different rehabilitation stages. To provide more accessible and integrated services to the users, there is a need to re-align these programmes towards a person-oriented service delivery mode, so that users may acquire the required services at a single centre during their various stages of rehabilitation.

6. To this end, the proposed **ICMHSSC** aims to provide one-stop and integrated community mental health care services to the services users, including networking services, community mental health education, centre-based and outreaching occupational therapy, centre-based daily living skills training as well as vocational training, etc. in a seamless and convenient manner. The target clientele of the ICMHSSC include persons with or suspected to have mental health problems and ex-mentally ill persons,

as well as their families and carers living in the TSW area. Subject to the effectiveness of this new service delivery mode, SWD will consider adopting such mode in other districts through revamping the existing community mental health support services.

7. As to the **LSCH**, while SWD currently provides a total of 1 407 places in the territory, there are still about 550 persons on the waiting list and the average waiting time is 35 months. Most of the people on the waiting list of LSCH service are either in-patients of psychiatric hospitals or out-patients receiving community support services from various community mental health programmes. The planned 75 additional LSCH places provided under this project would help meet the demand, and go some way towards reducing the average waiting time.

Public Consultation

8. SWD consulted the Culture, Recreation, Community Service and Housing Committee of the Yuen Long District Council (YLDC) on the proposed project on 11 March 2008. The Committee generally supported the proposal.

Financial Implications

9. The estimated capital cost of the whole project is \$393 million in money-of-the-day (MOD) prices. As is the established practice, the construction cost of the welfare facilities, i.e. the ICMHSSC and LSCH, estimated at \$153 million, will be funded by the Lotteries Fund.

Implementation Timetable

10. The Secretary for Food and Health will consult the Legislative Council (LegCo) Panel on Health Services on the planned provision of the

health care facilities under this project. Following consultation with this Panel and the LegCo Panel on Health Services, we will seek the funding approval of the Public Works Subcommittee and the Finance Committee of the LegCo at their respective meetings in June 2008. Subject to funding approval, the construction works will commence in mid-2009 and the project is targeted to complete by the end of 2011.

Background

11. The overall objective of our rehabilitation policy is to support full integration of persons with disabilities, including those with mental illness, into society. To achieve this, SWD has in recent years developed a series of community support services for persons with mental health problems with a view to helping persons with relevant needs to live in the community with their families and friends. These services, which include Community Mental Health Link, Community Mental Health Care Services, Community Rehabilitation Day Services and Community Mental Health Intervention Project, also aim to strengthen the caring capacity and relieve the stress of carers and family members of persons with disabilities.

12. To meet the needs of those who cannot live on their own and cannot be adequately cared for by their families, SWD provides a range of residential care services. As at April 2008, SWD is providing a total of 2 999 residential places, including LSCH, halfway house and supported hostel places for the ex-mentally ill persons.

Advice Sought

13. Members are invited to note and support the Administration's proposal to set up an ICMHSSC and LSCH at TSW Area 109.

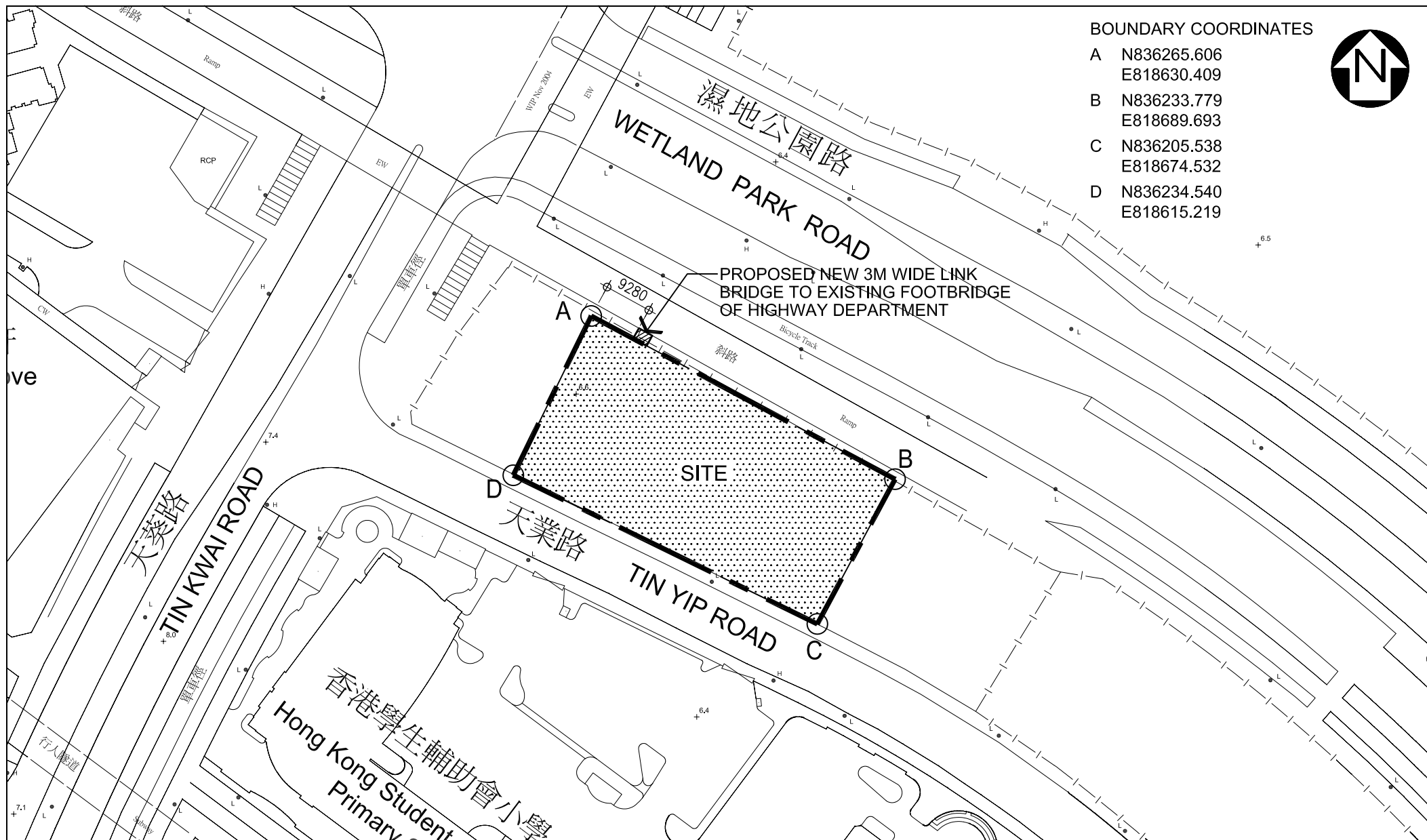

SITE PLAN

PROPOSED GENERAL OUT-PATIENT CLINIC AND INTEGRATED COMMUNITY SUPPORT SERVICES CENTRE CUM LONG STAY CARE HOME FOR EX-MENTALLY ILL PERSONS AT TIN SHUI WAI AREA 109



ARCHITECTURAL SERVICES DEPARTMENT



26 FEB 2008

Community mental health support services available in Tin Shui Wai

Service	Community Mental Health Link (CMHL) ¹	Community Mental Health Care Service (CMHC) ²	Community Rehabilitation Day Services (CRDS) ³	Community Mental Health Intervention Project (CoMHIP) ⁴
Operating NGOs	<ul style="list-style-type: none"> ● Richmond Fellowship of Hong Kong (RFHK) ● New Life Psychiatric Rehabilitation Association (NLPRA) 	<ul style="list-style-type: none"> ● RFHK ● HK Sheng Kung Hui Welfare Council (HKS KHWC) ● The Society of Rehabilitation and Crime Prevention (SRACP-HK) ● NLPRA 	<ul style="list-style-type: none"> ● NLPRA 	<ul style="list-style-type: none"> ● SRACP-HK
Objectives	To provide accessible support services for the discharged mentally ill patients and their families / carers in their neighbourhood	To provide continuous support to mental patients discharged from psychiatric wards / hospitals and the halfway houses	To provide outreaching occupational therapy to ex-mentally ill persons living in the community	To assist persons in the community with suspected mental health problems in the community
Target group	All ex-mentally ill persons and their family members / carers	Newly discharged mental patients from psychiatric wards / hospitals and halfway houses	All ex-mentally ill persons who are assessed to be in need of occupational therapies	Persons in the community with suspected mental health problems and / or their family members
Location of the service unit(s)	Attached to: <ul style="list-style-type: none"> ● Ping Shan Halfway House [Yuen Long (YL)] ● Tin Yuet halfway House [Tin Shui Wai (TSW)] 	Attached to: <ul style="list-style-type: none"> ● Ping Shan Halfway House ● Providence Garden for Rehab [Tuen Mun (TM)] ● Shan King Halfway House (TM) ● Sunrise House (TSW) 	<ul style="list-style-type: none"> ● Attached to Tuen Mun Training and Activity Centre (TM) 	<ul style="list-style-type: none"> ● Attached to Sunrise House (TSW)
Service boundary	Territory-wide	TM and YL (including TSW)	TM and YL (including TSW)	YL (including TSW)

Notes:

- ¹ CMHL commenced service in January 2001 to provide all ex-mentally ill persons and their family members with supportive services including regular visits, counselling, arranging linkage activities and supportive programmes.
- ² CMHC commenced service in October 2005 to provide newly discharged mental patients from psychiatric wards/hospitals and halfway house residents with supportive services including regular visits, counselling, arranging vocational rehabilitation services and supportive programmes.
- ³ CRDS commenced service in October 2006 to provide outreaching occupational therapy to ex-mentally ill persons.
- ⁴ CoMHIP commenced service in October 2007 to provide intensive social work intervention to persons with suspected mental health problems in the community.