

香港特別行政區政府

The Government of the Hong Kong Special Administrative Region

發展局

香港花園道美利大廈九樓



Development Bureau

9/F, Murray Building
Garden Road, Hong Kong

電話 Tel: 2186 8795

傳真 Fax: 2845 3489

本局檔號 Our Ref. DEVB(PL-CR) 50/14/25

來函檔號 Your Ref. CB1/F/2/6(II)

20 April 2009

Clerk to Public Works Subcommittee
Legislative Council,
Legislative Council Building,
8 Jackson Road, Central,
Hong Kong
(Attn: Ms Angel SHEK)

Dear Ms SHEK,

Public Works Subcommittee
Follow-up to meeting on 8 April 2009

PWSC (2009-10)3

With reference to your letter dated 9 April 2009 to the Secretary for Financial Services and the Treasury, we provide below the information requested by the Hon Patrick Lau and the Hon Kam Nai-wai in respect of PWSC(2009-10)3 –

- (i) The design concept of the bridge and the adjacent landscaping works are shown at Plans 1 to 3. Plan 1 shows the proposed land use and cycle tracks in the waterfront areas, Plan 2 portrays the existing environment and perspective view of the completed road

scheme, and Plan 3 is the landscaping proposal.

(ii) The objector on the proposed road scheme after the Road Gazette is the Incorporated Owners of a residential development near the proposed works. We received their objection letter on 14 May 2008. CEDD have met them thrice and attended a residents' meeting to understand their concerns and discuss on various measures to alleviate them. Their concerns are set out as follows -

- (a) The proposed works would impair the natural visual environment of the water channel;
- (b) The proposed works would create noise nuisance and bring about public order problems to the nearby areas;
- (c) The planned bridge in the southern end of the water channel and the bridge to be provided as part of the proposed works should be combined into one;
- (d) The proposed cycle track has no direct connection to the residential development. They argued that the proposed works would increase the usage of the public open space in the residential development currently managed and maintained by the Incorporated Owners, and suggested the Government to take up the management of the public open space; and
- (e) The Government should improve a pathway at the other side of the residential development.

In response to their concerns, we have explained to them that -

- (a) The proposed works not only aims to enhance accessibility for developments on both sides of the water channel, it also serves to integrate the open space developments along the waterfront of Tseung Kwan O (TKO) New Town. To this effect, the project has been planned to provide a good leisure environment along the waterfront for pedestrians and cyclists, with planting strips alongside the cycle track/footpath including that on the bridge, and a large landscape area at the southern end of the scheme to improve the visual environment;

- (b) The primary objective of the proposed works is to provide a footpath and cycle track for the use of pedestrians and cyclists. Upon completion of the works, the road scheme would be open to public use. The Government would manage the completed works similar to other public roads/areas;
- (c) The two bridges, constituting an integral part of the comprehensive pedestrian circulation network in TKO, connect to different parts of the town centre south to integrate into the comprehensive development plan. The bridge to be provided in the proposed works would serve as a linkage for pedestrians and cyclists to the developments around the MTR TKO Station while the bridge in the southern end of the water channel, which is about 380m apart, would serve as a link to the open space developments and promenade along the waterfront;
- (d) To provide better connection to the residential development, we have proposed modification to the proposed works by extending the cycle track and cycle park right adjacent to the residential development. As the proposed works are away from the residential development, we are not in a position to take over the public open space within the residential development. We suggested that the Incorporated Owners could make the connection to the cycle track by extending an existing footpath inside the residential development right to the boundary adjoining the cycle park; and

- (e) We have separately followed up on their request to improve the pathway at the other side of the residential development, as it does not fall within nor is connected to the proposed works.

Yours sincerely,

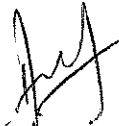

(Annie Kong)
for Secretary for Development

c.c.

SFST (Attn: Miss Belinda Wong)

DCED (Attn: Mrs Joanne Kwok)

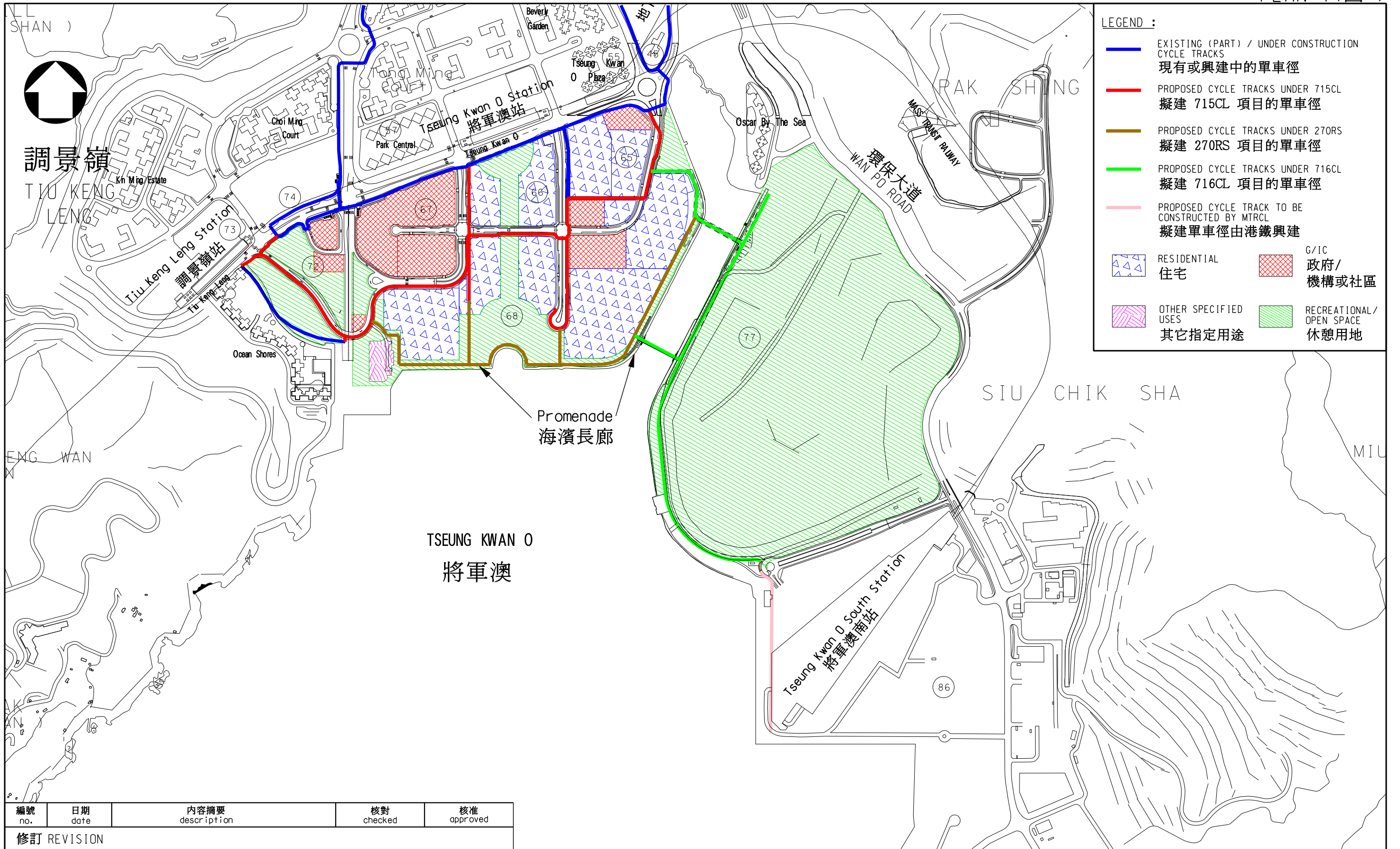

編號 no.	日期 date	內容摘要 description	核對 checked	核准 approved
修訂 REVISION				

圖則名稱 drawing title	繪圖 drawn	簽署 initial	日期 date	項目編號 item no.	辦事處 office 新界東拓展處 NEW TERRITORIES EAST DEVELOPMENT OFFICE
PROPOSED LAND USE AND CYCLE TRACKS IN WATERFRONT AREAS OF TSEUNG KWAN O	S.C.FUNG		09.04.09		
將軍澳臨海地區的建議用地及單車徑	核對 checked	簽署 initial	日期 date	比例 scale	
	C.C.LEUNG		09.04.09	1 : 10 000	
	核准 approved	簽署 initial	日期 date	圖則編號 drawing no.	 土木工程拓展署 CIVIL ENGINEERING AND DEVELOPMENT DEPARTMENT
	K.C.LEUNG		09.04.09	TKZ0636	

Perspective View 透視圖



Existing Environment 現有環境



Perspective View of Completed Bridge and Surrounding Landscape Works
天橋及附近的園林設計完成後的透視圖

Landscaping Proposal 園林設計

