

The Relocation of the

COURT OF FINAL APPEAL

Consultation with the Panel on Administration of Justice and Legal Services (AJLS)
of the Legislative Council

10 July 2012

PRESENTATION AGENDA

- 1. Background**
- 2. Improved Facilities**
- 3. Heritage Considerations**
- 4. Project Planning**
- 5. Project Programme**

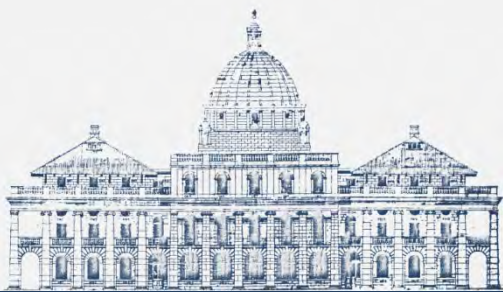

1 BACKGROUND

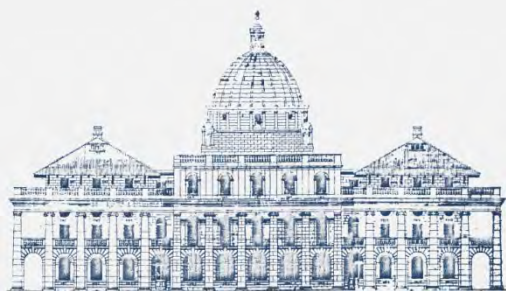

The Relocation of the
COURT OF FINAL APPEAL

BUILDING LOCATION

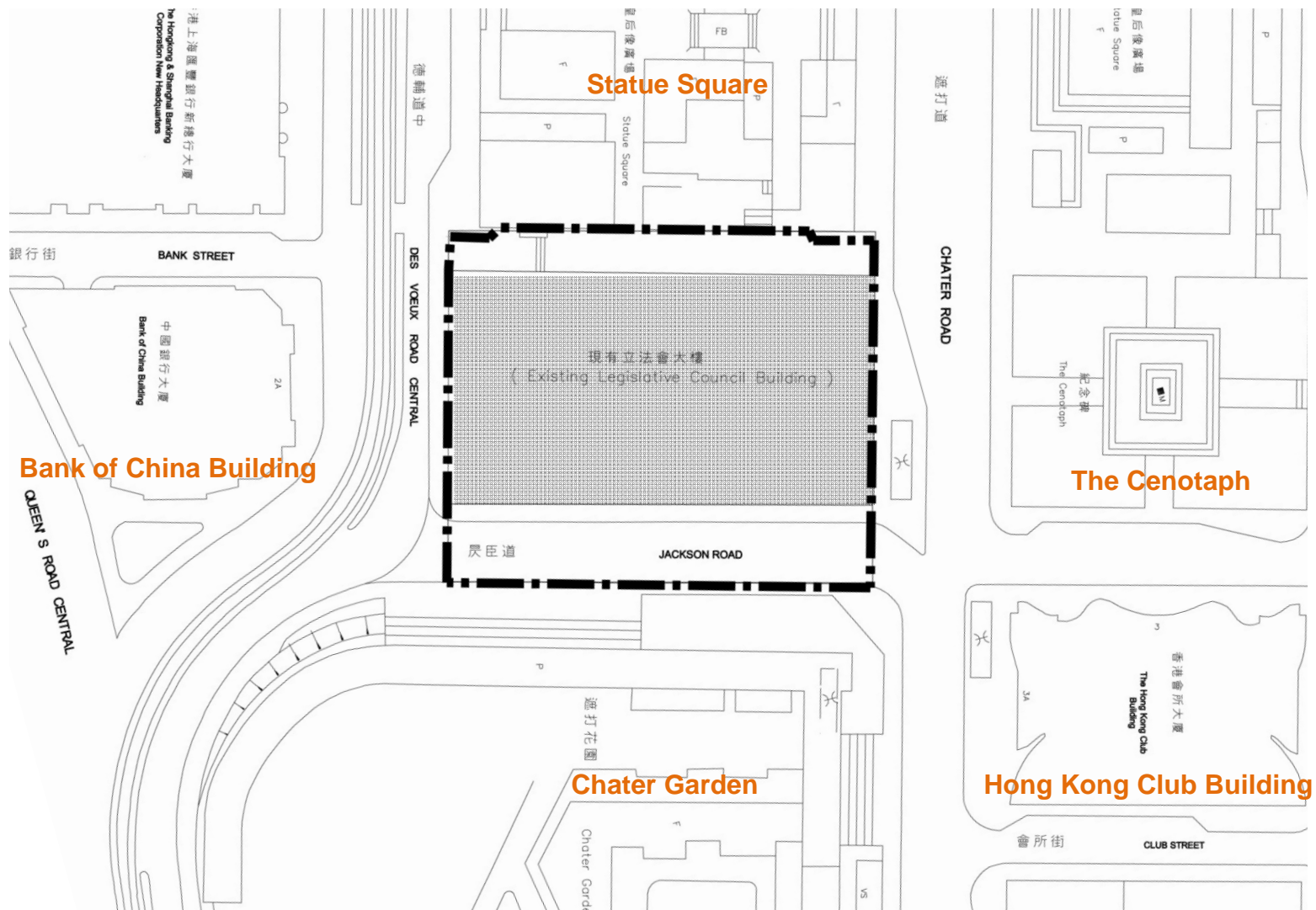

Site Plan

Victoria Harbour



HISTORY

- 1900-12 Construction of the Supreme Court
- 1912 Governor Sir Frederick Lugard officially opened the Supreme Court
- 1941-45 Headquarters of the Hong Kong Military Police under Japanese Occupation
- 1945-78 The Supreme Court continued operation
- 1978 The Supreme Court relocated elsewhere for structural repair of the building during construction of MTR
- 1985-2011 The Legislative Council



HERITAGE IMPORTANCE

- The **exterior** of the Building was **declared a monument in 1984**, which empowered the Antiquities Authorities to prevent alterations or impose conditions upon any proposed alterations.
- The **interior** of the Building was **NOT declared a monument**, however as discussed with AMO and listed in the AMO conservation guideline, **AMO's approval** shall be obtained for modifications in the interior of the Building.

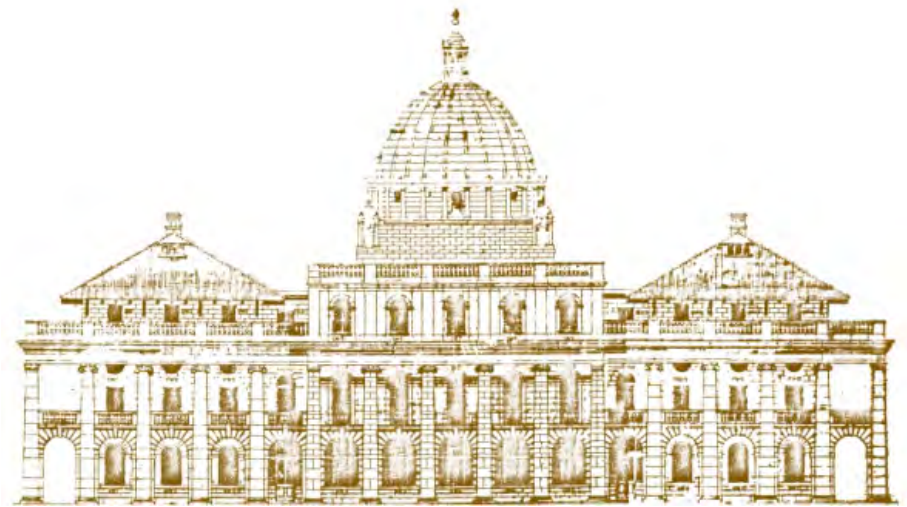

ACCOMMODATION

- **Approved Operational Floor Area : about 3,070 m²**

Facilities		Number Proposed
(1)	Courtrooms	2 (one around 230 m ² and the other around 95 m ²)
(2)	Lawyers' Common Room	1
(3)	Lawyers' Robing Rooms	2
(4)	Lawyers' Consultation Rooms	4
(5)	Galleries	2 (Note)
(6)	Press Room	1
(7)	Baby-care Facility	1
(8)	Library	1
(9)	Judges' Chambers	8
(10)	CFA Registry	1
(11)	Conference Rooms	2

Note: - One gallery (about 150m²) is proposed to be located on **1/F** for the hosting of exhibits relevant to the Judiciary and receptions;
 - The other (about 100m²) is proposed at the **basement** for the display of the Building history.

CONSERVATION CONCEPTS

1. **Fit in** the new function of Court of Final Appeal. Adaptive reuse the historical building.
2. **Upgrade** to comply with current statutory requirements and up-to-date building services systems.
3. **Preserve** valuable heritage elements of the building as many as possible. When new elements are added, contemporary style will be adopted to make them distinguishable from the old ones.
4. **Restore** valuable heritage elements as appropriate. For elements which could not be restored, it will be archived and displayed as exhibits.
5. **Open** the preserved elements for public appreciation as many as possible and give a new life to this valuable heritage building.

2 IMPROVED FACILITIES

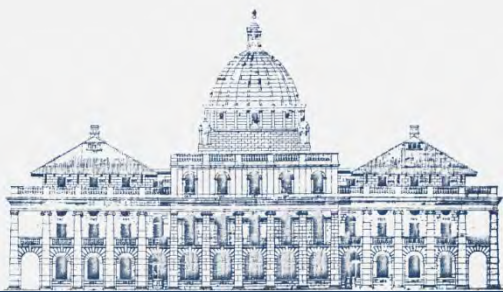

The Relocation of the
COURT OF FINAL APPEAL

SCHEMATIC SECTION

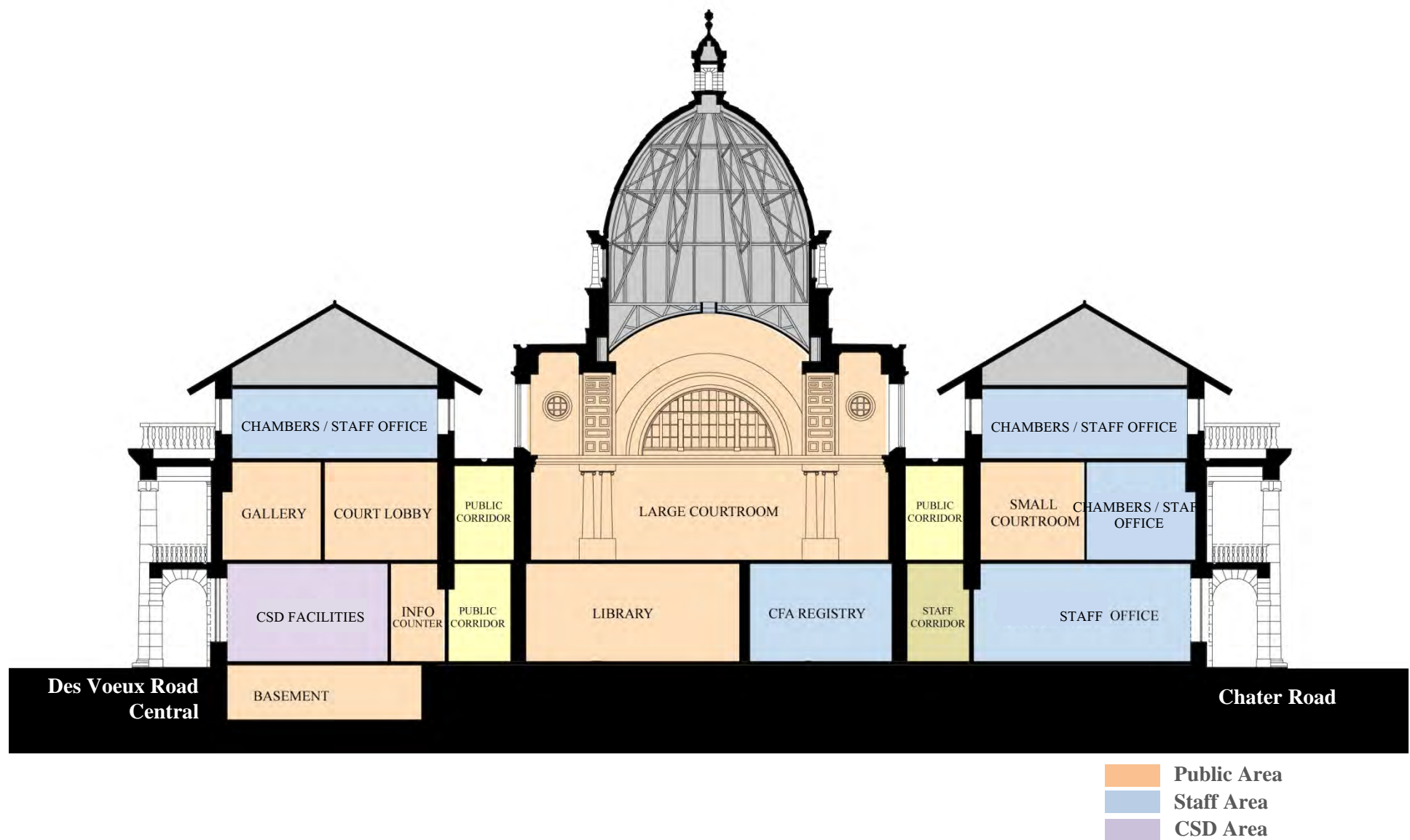

GROUND FLOOR

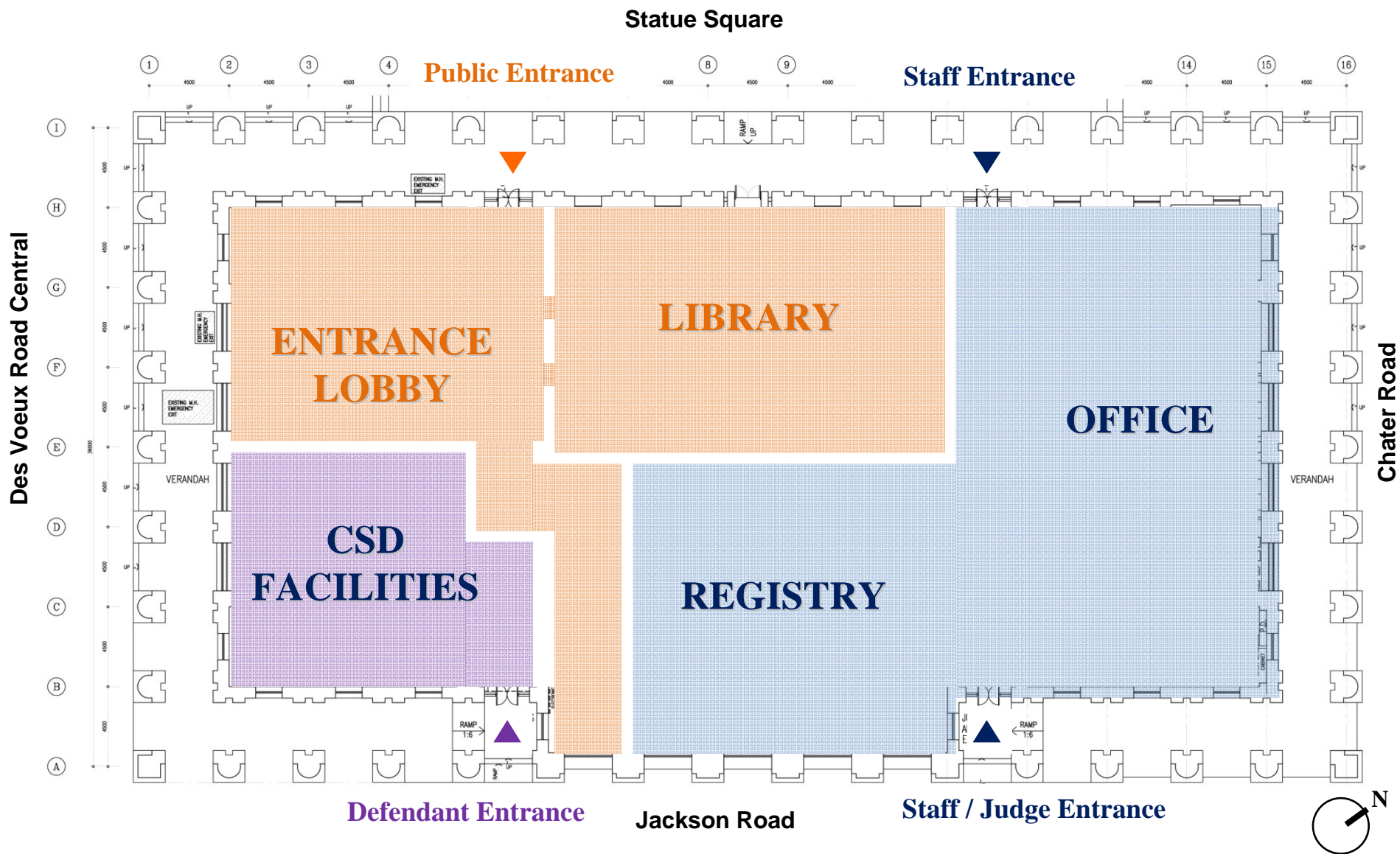

FIRST FLOOR

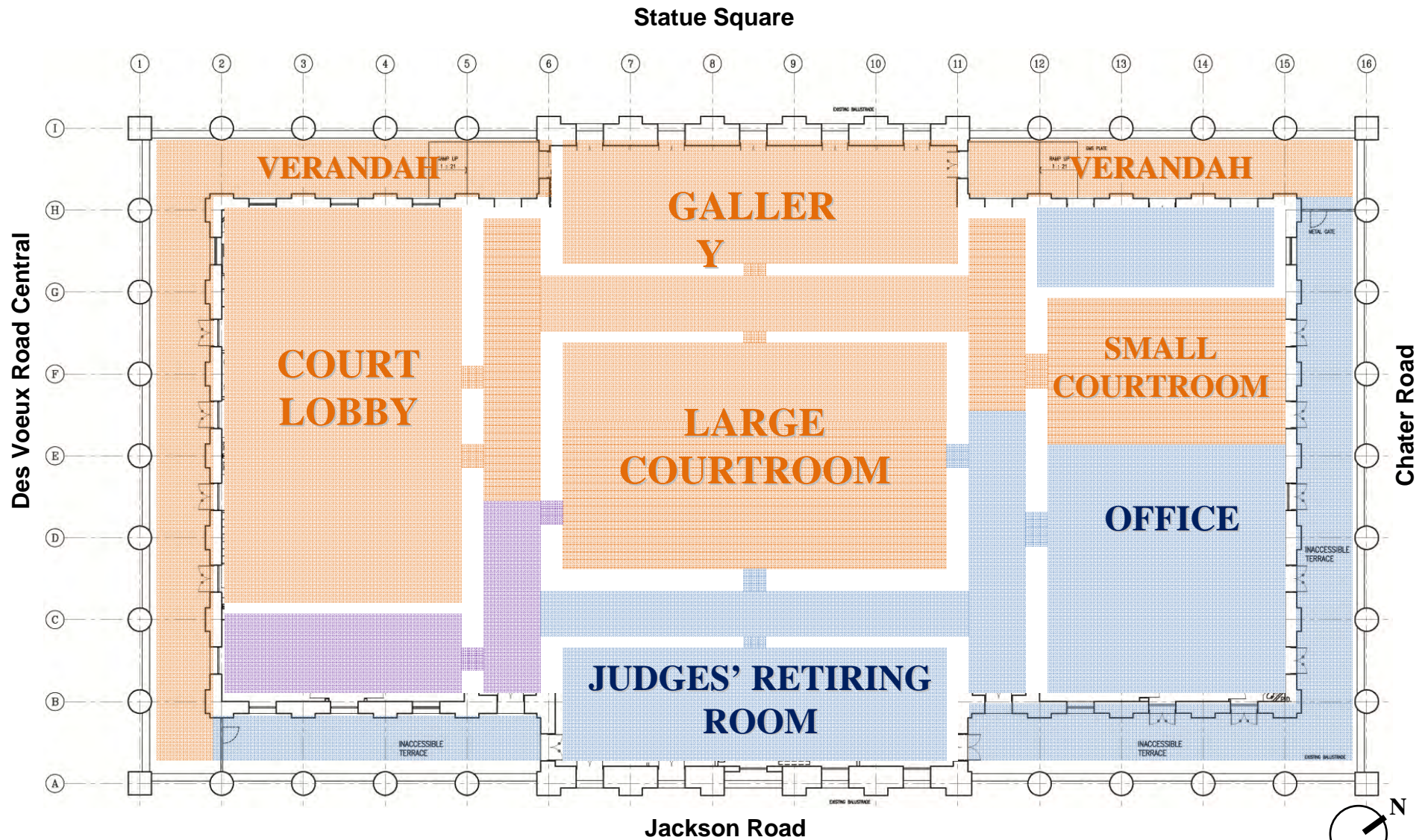

SECOND FLOOR

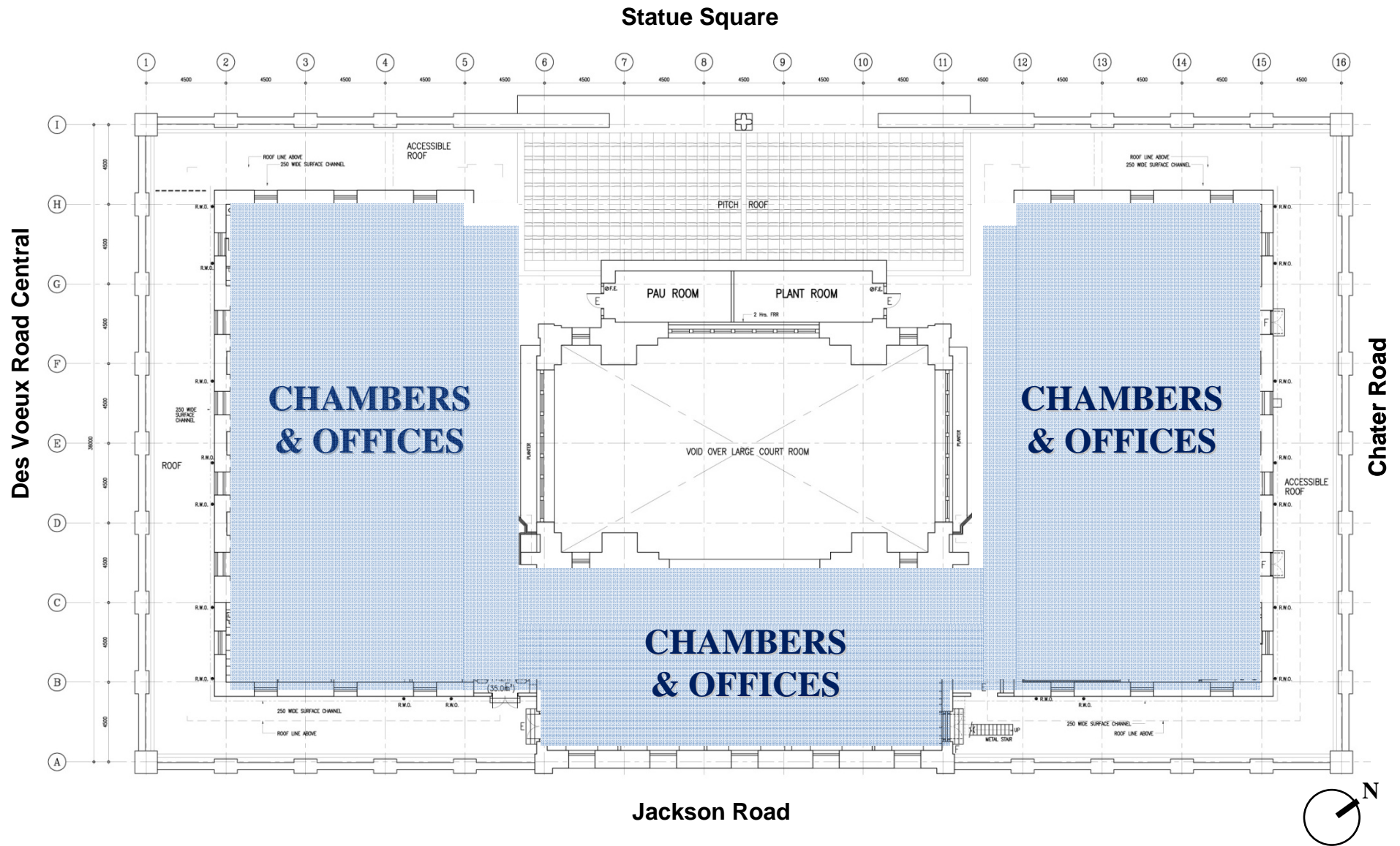

(A) COURTROOMS

1. Large Courtroom

2. Small Courtroom

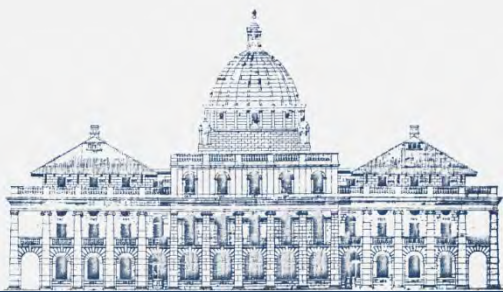

COURTROOMS

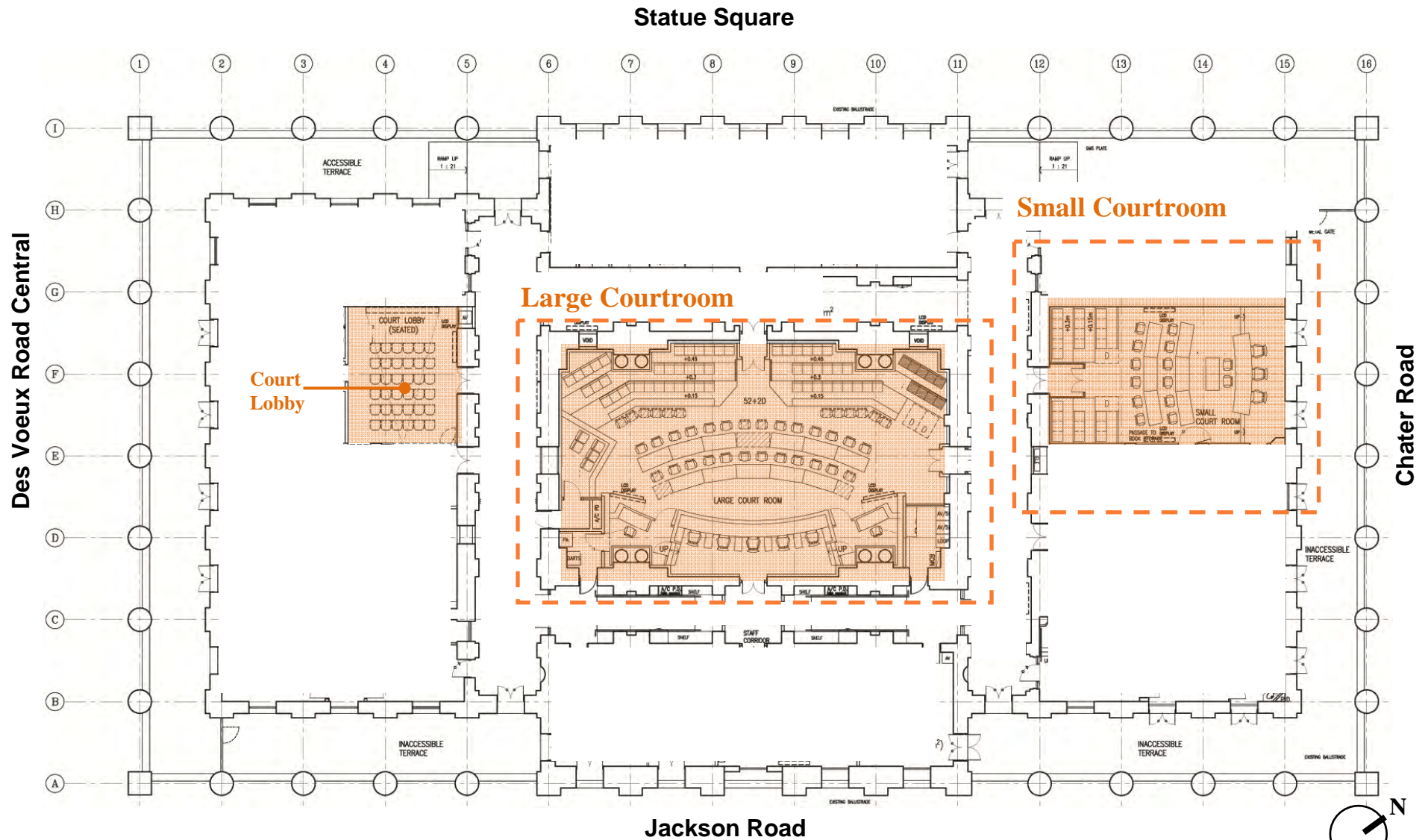

LARGE COURTROOM (PRE-CONVERSION : FORMER CHAMBER OF THE LEGCO)



LARGE COURTROOM



SMALL COURTROOM

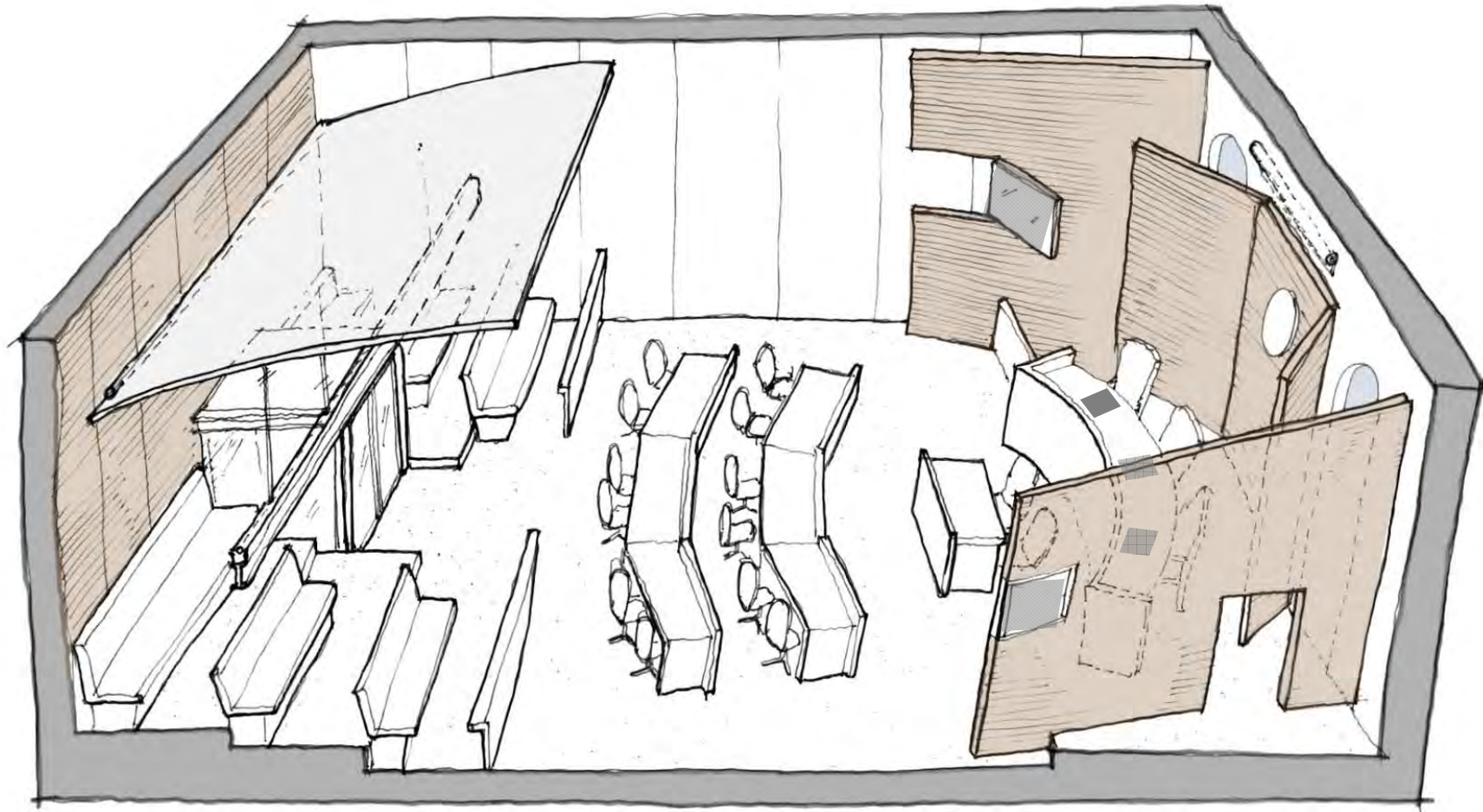

(B) FACILITIES FOR JUDGES AND SUPPORT STAFF

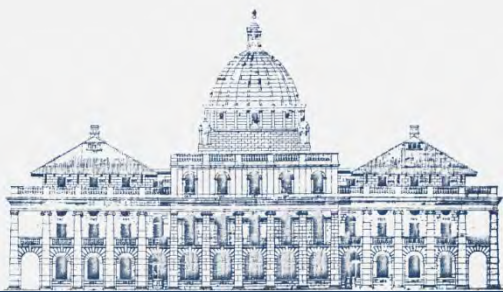

FACILITIES FOR JUDGES AND SUPPORT STAFF

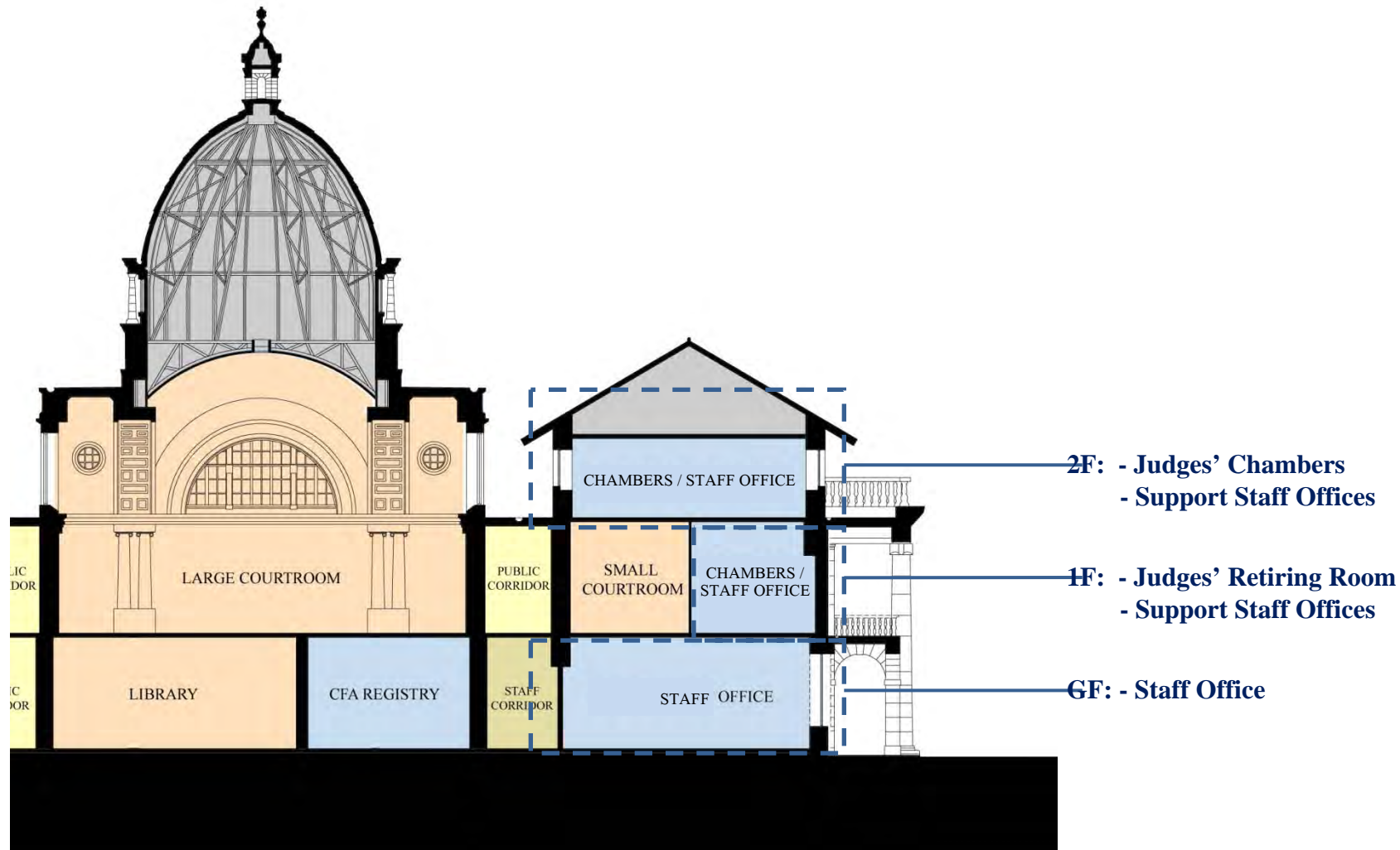

(C) FACILITIES FOR LEGAL REPRESENTATIVES

-
- 1. 1/F: Lawyers' Robing, Consultation and Common Rooms**
-

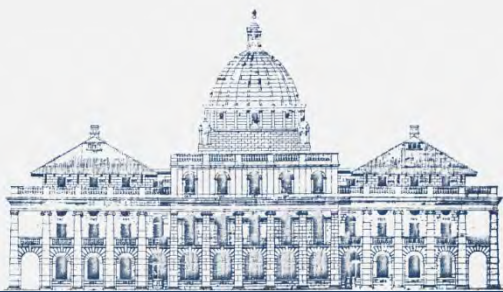

COMMON ROOMS

Statue Square

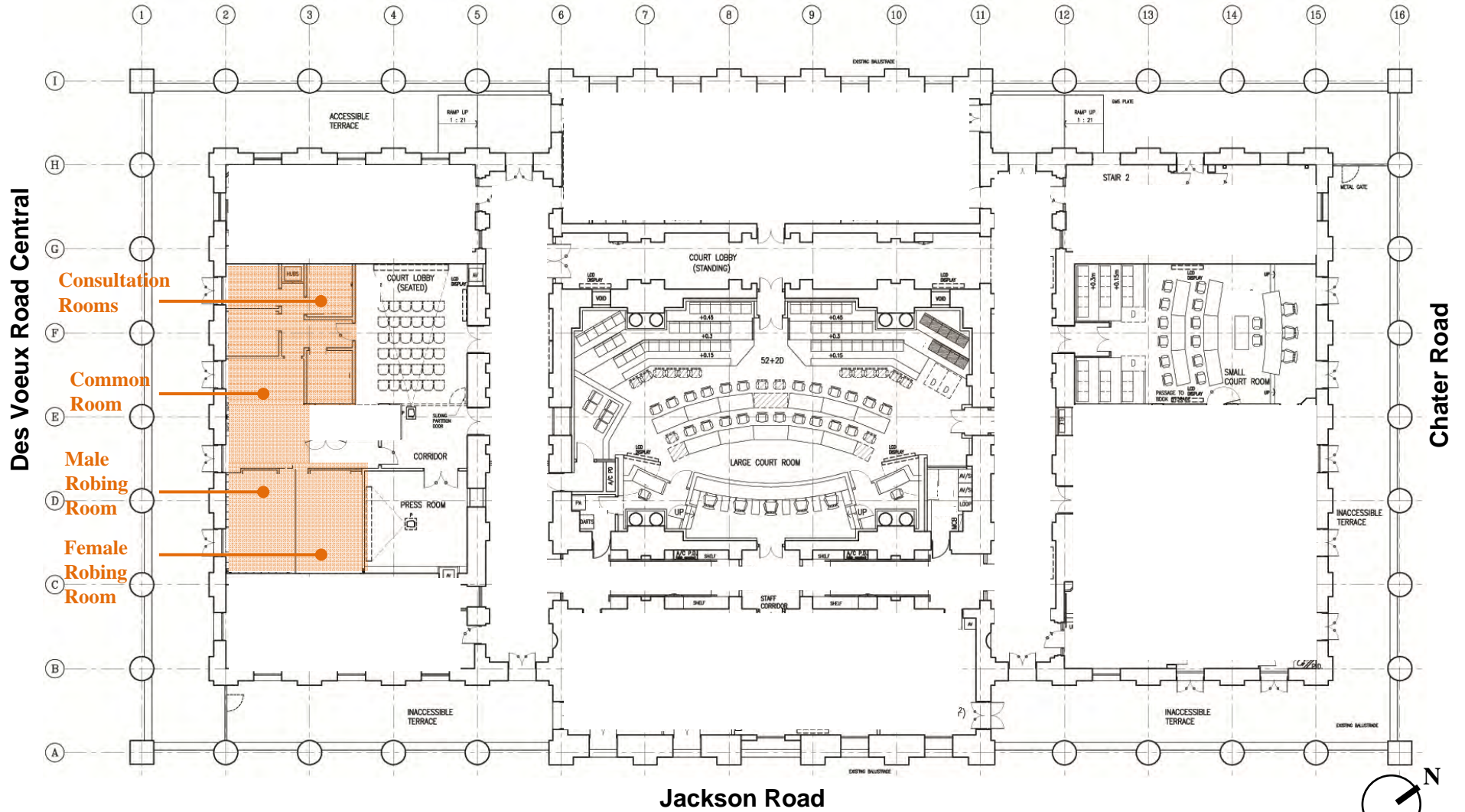

(D) FACILITIES FOR THE PRESS

1. 1/F: Press Room

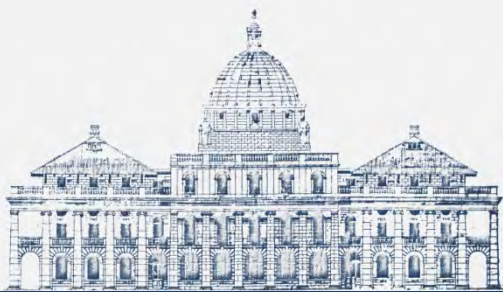

1/F : PRESS ROOM

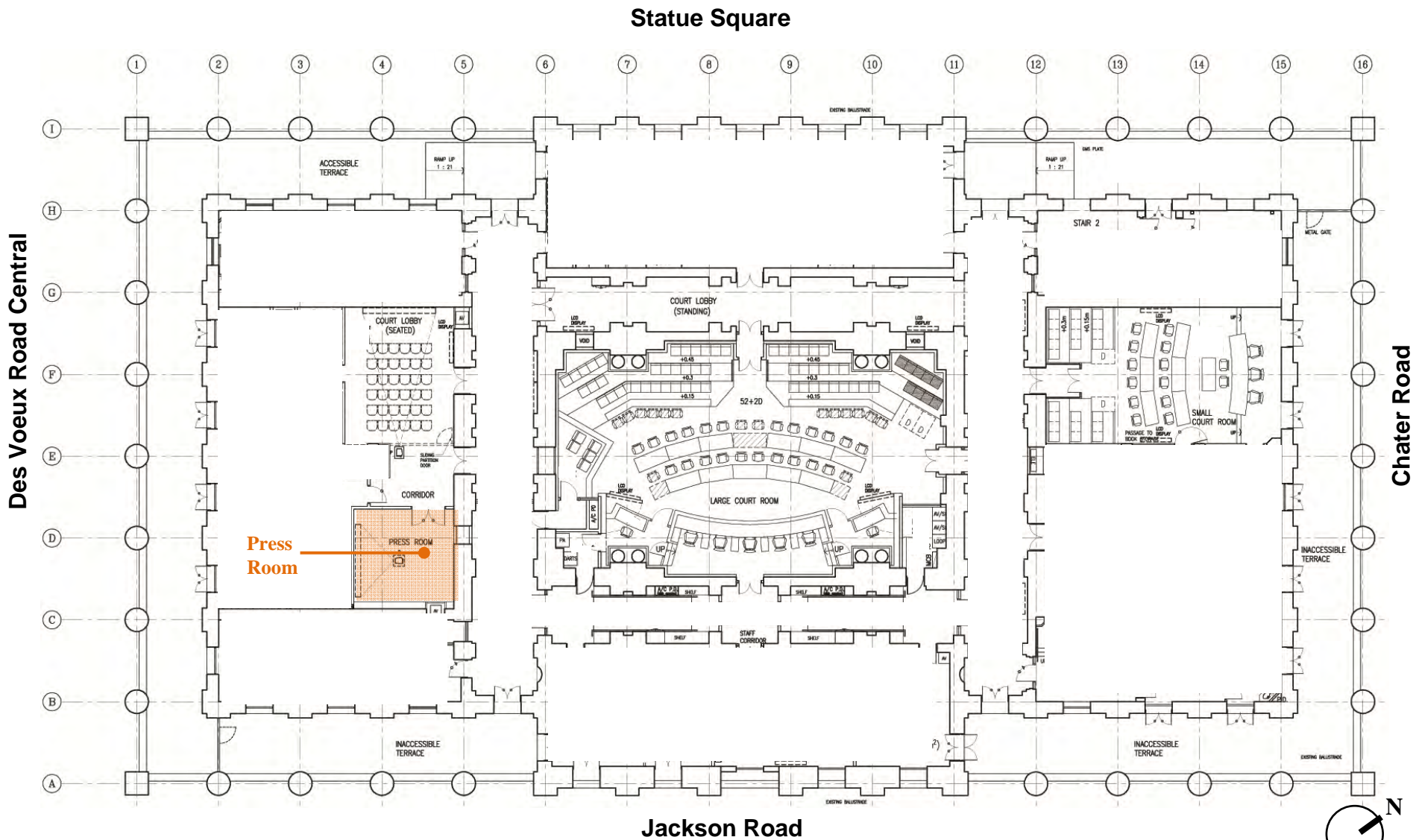

(E) FACILITIES FOR THE PUBLIC

1. G/F: Entrance Lobby and Registry

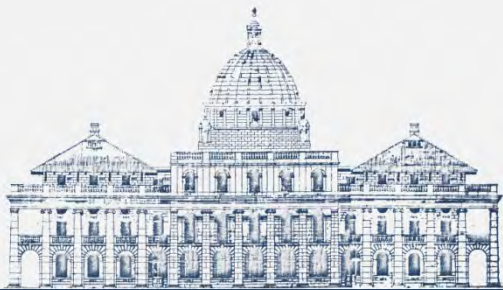

G/F : ENTRANCE LOBBY AND REGISTRY

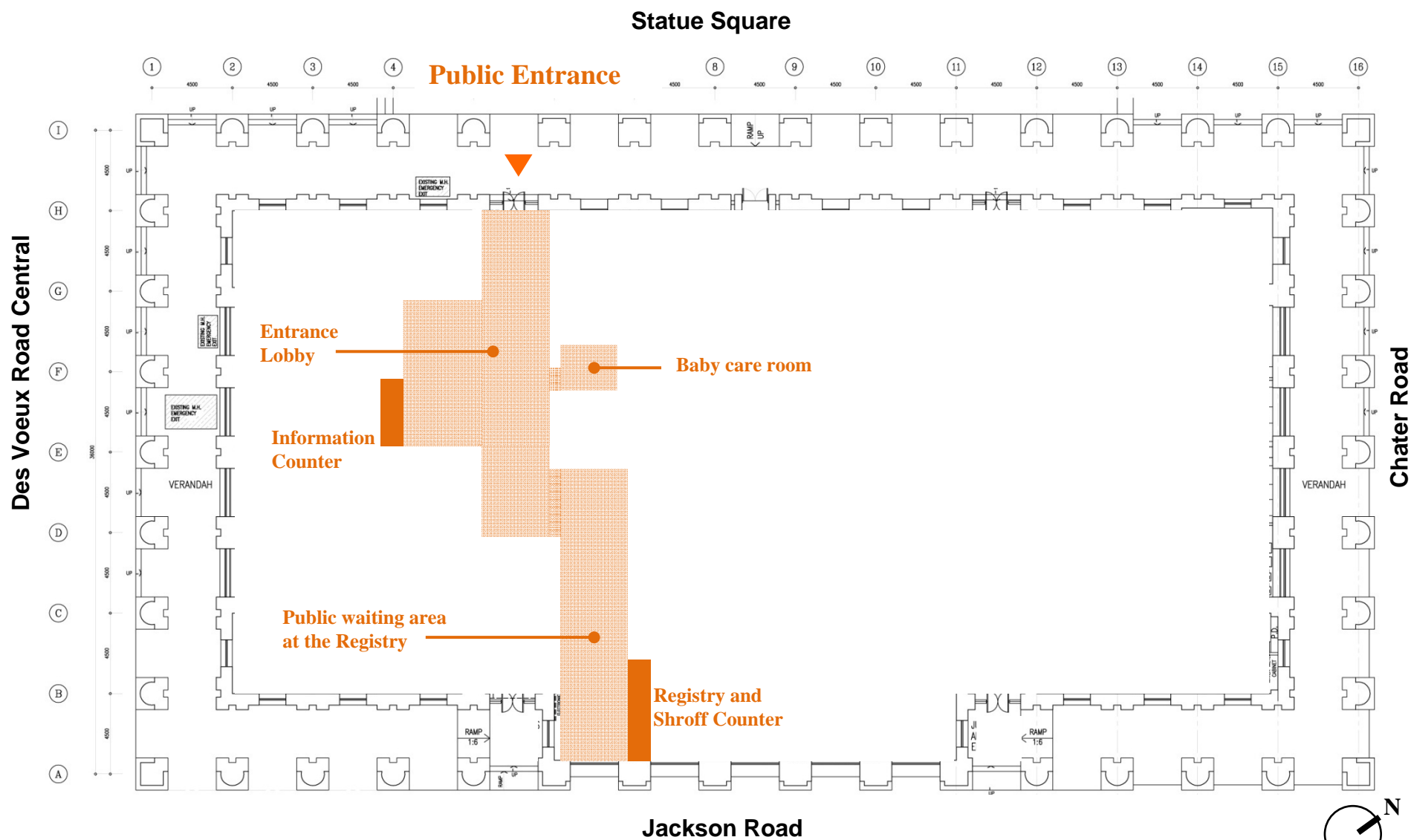

3 HERITAGE CONSIDERATIONS

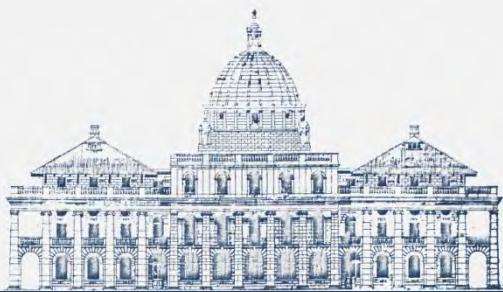

EXTERNAL WALL

Proposed Restoration :

Selective Cleaning and Repairing

- Removing salt deposit & stains as appropriate (e.g. at prominent locations)
- Repair cracks and defective locations



TIMBER ELEMENTS

Proposed Restoration :

- Refinish with proper protection paint to match their original appearance



The Relocation of the
COURT OF FINAL APPEAL

MOULDINGS

Findings:

- Mouldings hidden above false ceiling

Design opportunities:

- Exposing the mouldings for public appreciation at strategic locations where appropriate

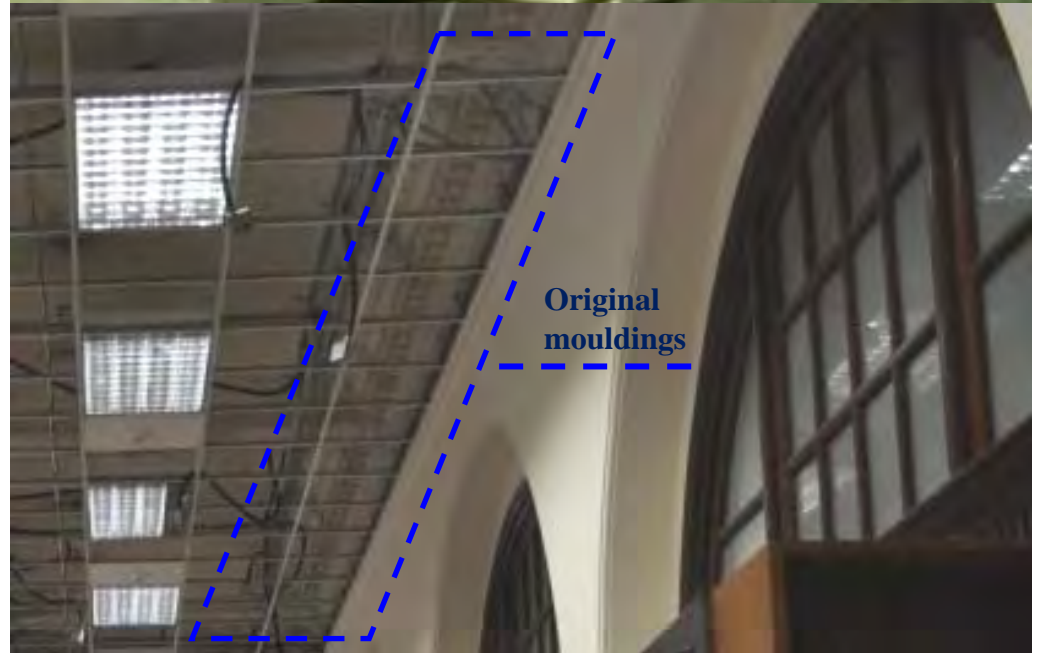

FLOOR FINISHES

Proposed Restoration :

- Restore the original flooring and expose at strategic locations
- Reveal the original style of certain areas of the interior of the building



Original floor tiles



Original tiles near fireplaces



Original teakwood flooring

GALLERY – 1/F



- For display of exhibits relevant to the Judiciary for public viewing
- The Gallery may also be used to hold functions as appropriate
- Restoration of Spiral Staircase

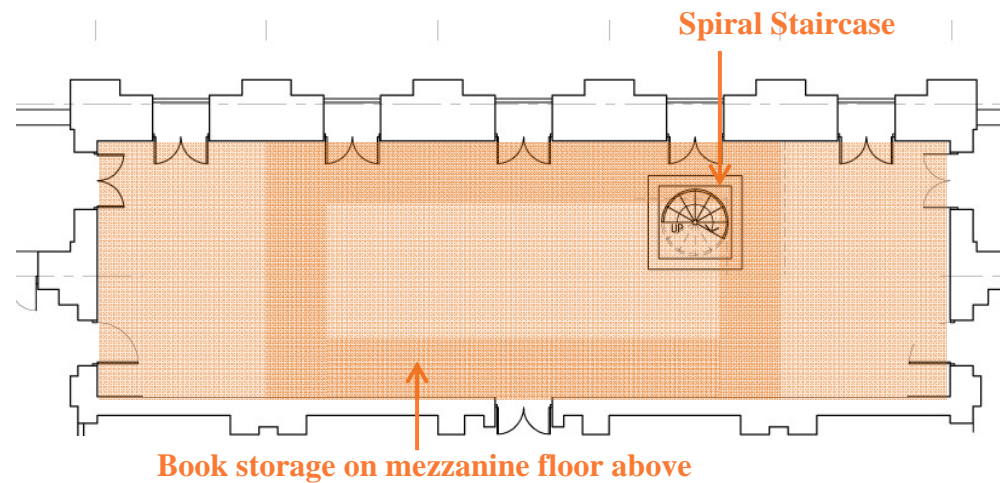
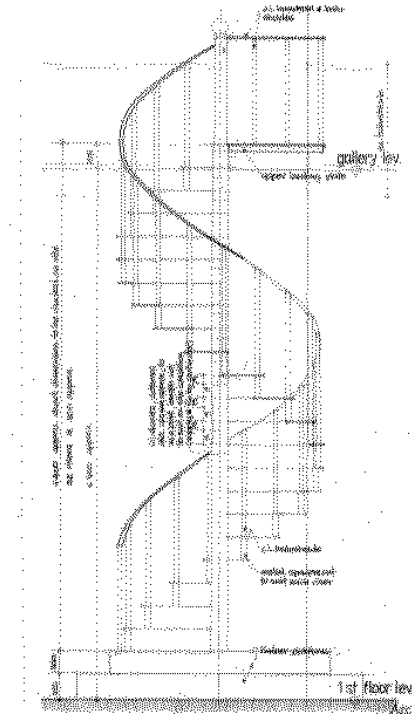

GALLERY - BASEMENT

- Original space for building heating system apparatus
- With rich architectural characteristics different from other floors
 - e.g. - prisms for daylight reflection
 - exposed structural arches & stone walls



GALLERY - BASEMENT

Architectural Heritage Gallery

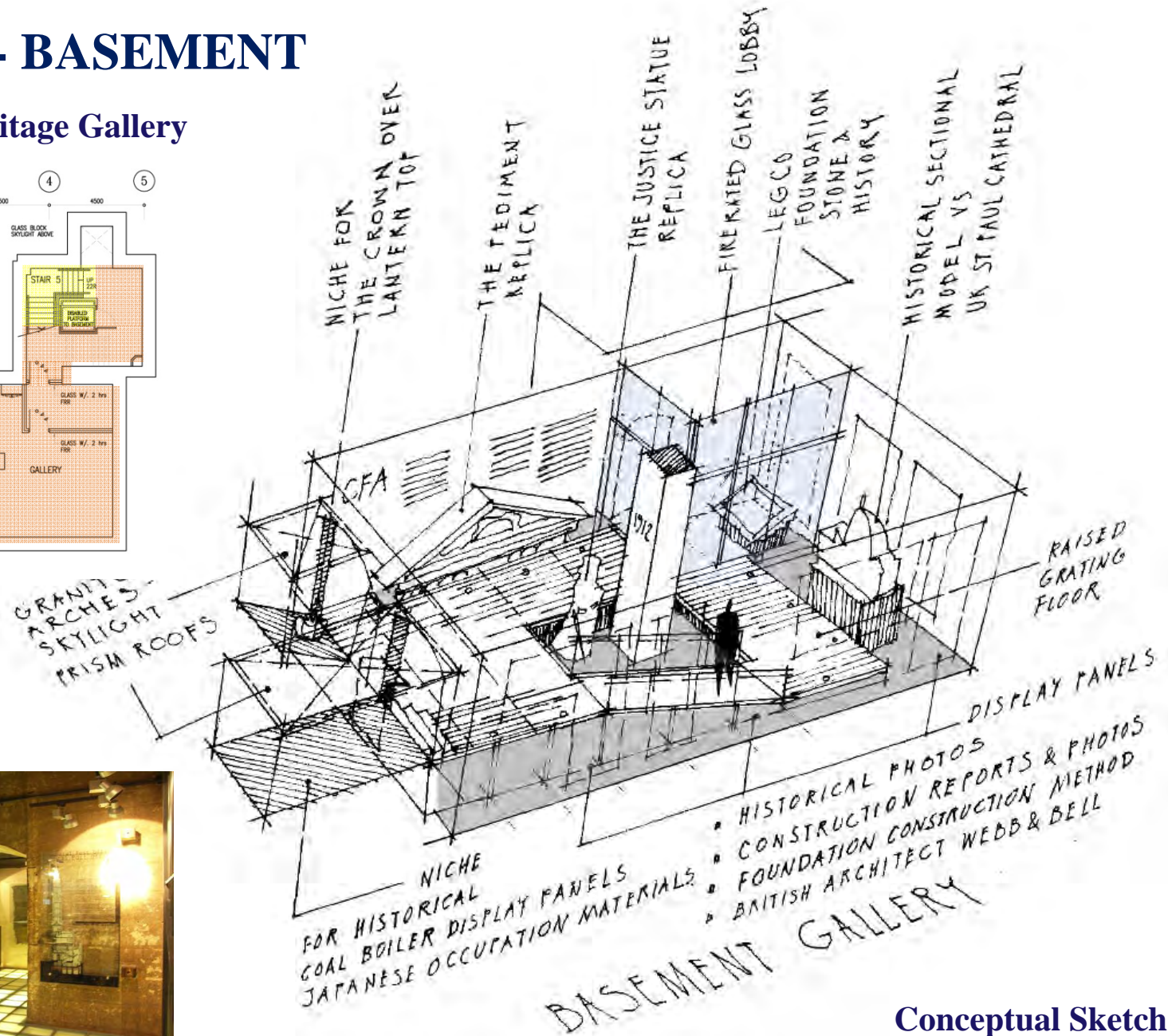
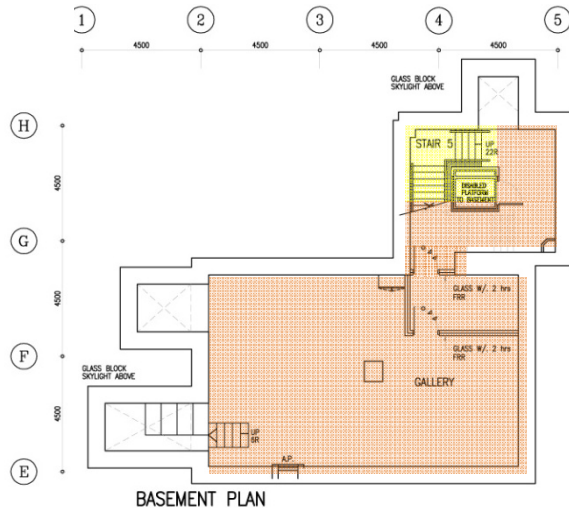

Conceptual Sketch

1/F VERANDAH

- Provide opportunity for public enjoyment of the unique space
- Minor modifications to suit statutory and security requirements

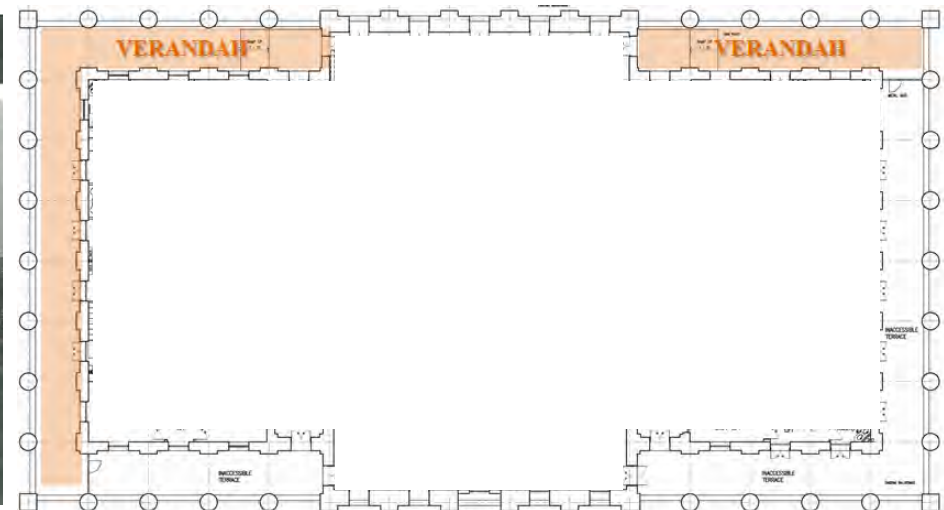

“BRIDGE OF SIGHS”

Original defendants' waiting area in 1912

Original Defendant Entrance

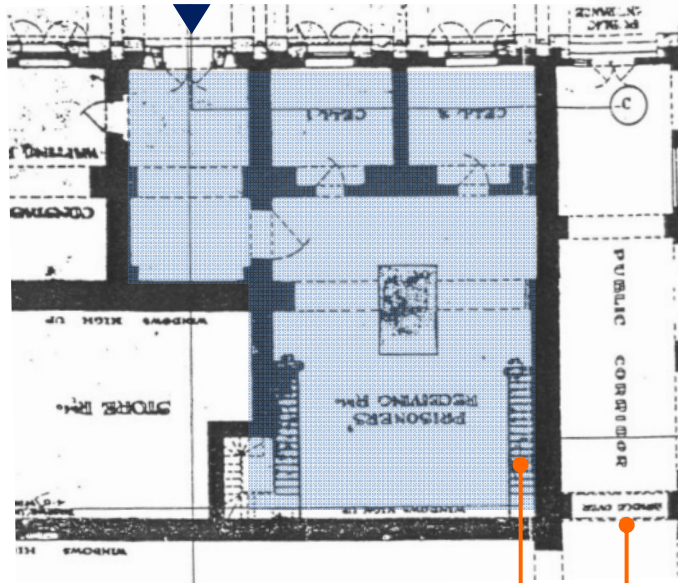

Original staircase
to court above

Original Bridge
of Sighs above

Future Library

Future Ceremonial Entrance

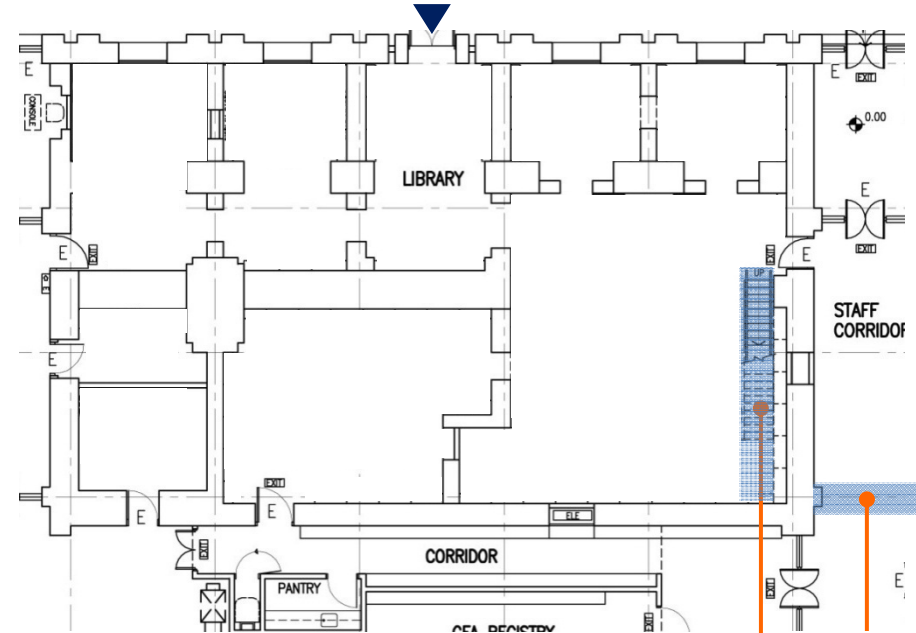

Newly reconstructed
staircase

Remains
of Bridge
of Sighs
above

- Newly reconstructed staircase provide access to the remains of the Bridge of Sighs
- Provide opportunities for appreciation of the historic features

“BRIDGE OF SIGHS”

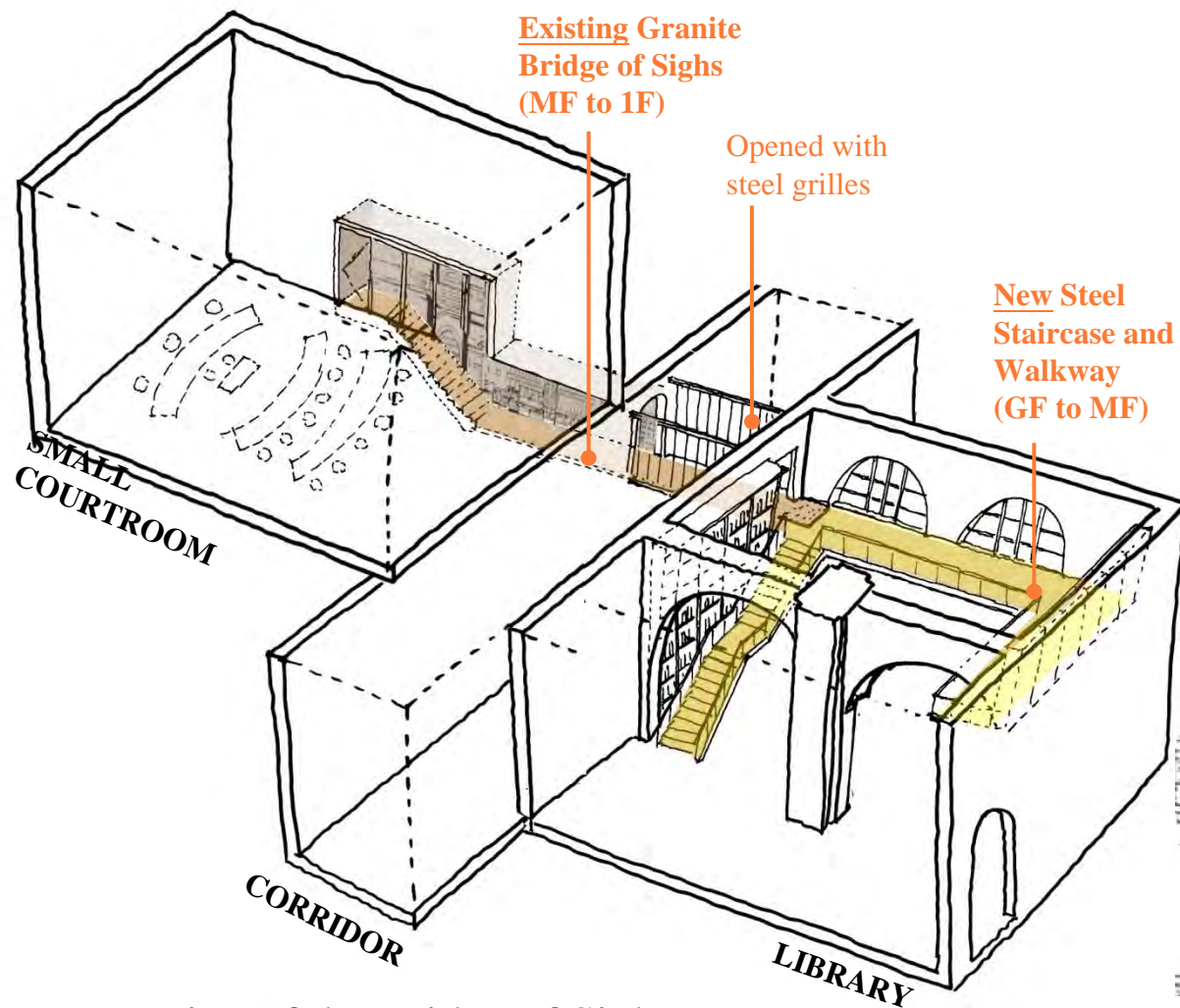

Restoration of the Bridge of Sighs

Original Courtroom

Original defendant's area

EXTERNAL AREA

Existing Layout

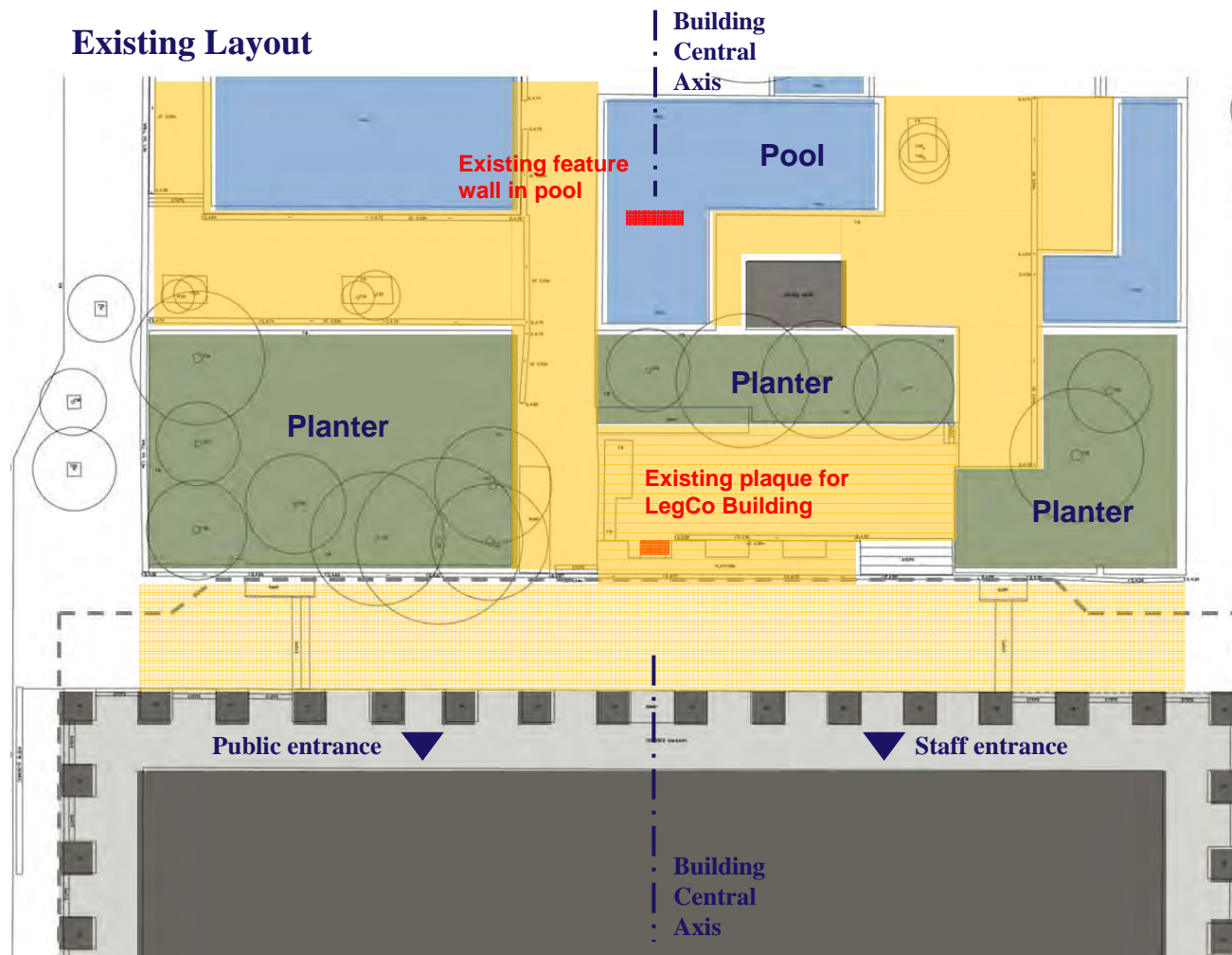

EXTERNAL AREA

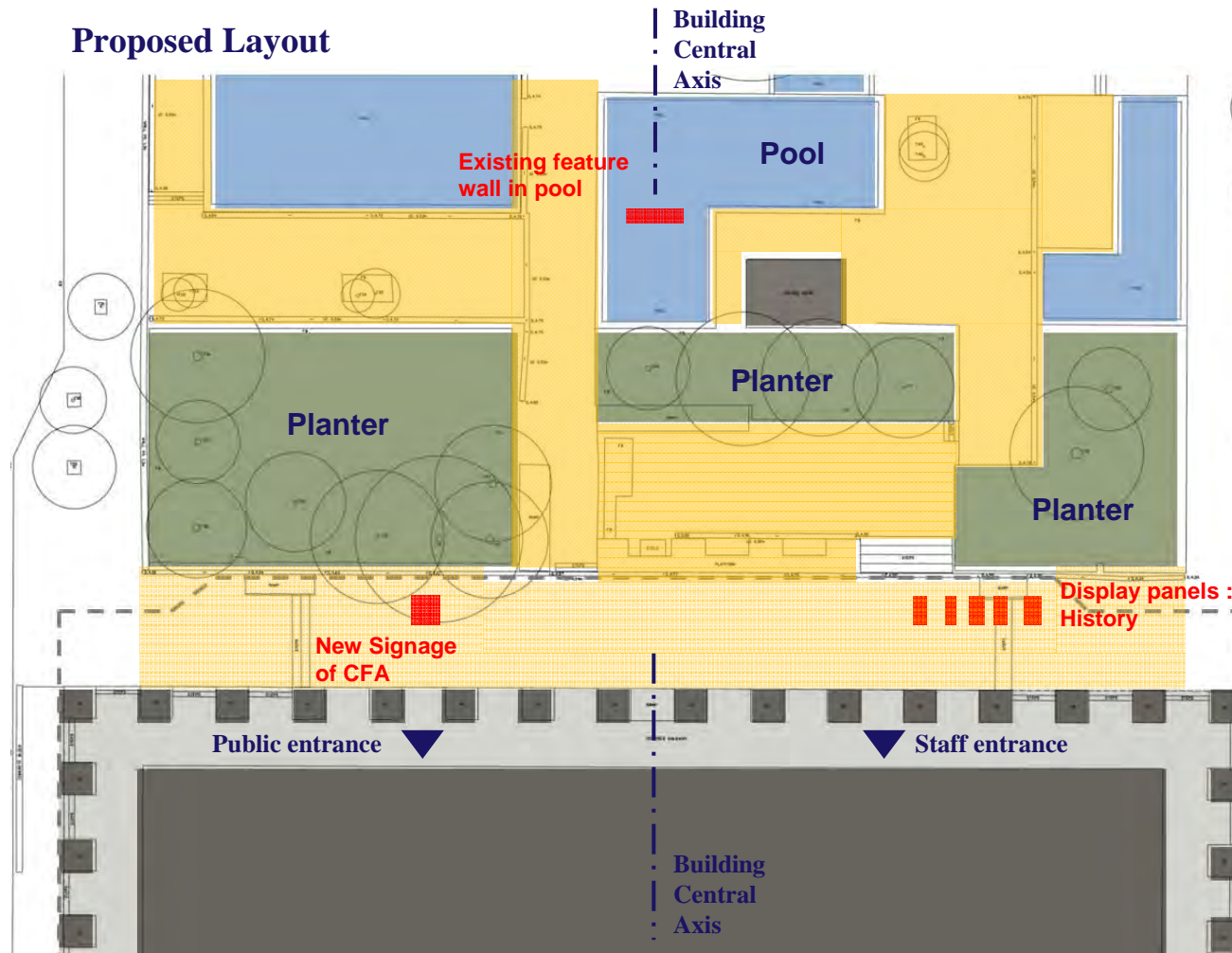

- Pavement to be upgraded
- New Signage of CFA on the external area
- Existing plaque of the LegCo Building to be relocated to the Basement Gallery
- Display panels on building history to be erected

4 PROJECT PLANNING

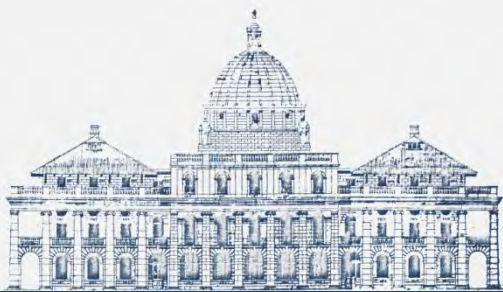

The Relocation of the
COURT OF FINAL APPEAL

PROJECT PLANNING

- Set up a **Steering Committee**, chaired by the CJ, to steer the project ahead
- Proposals presented have been **endorsed** by the Steering Committee for consultation

5 PROJECT PROGRAMME

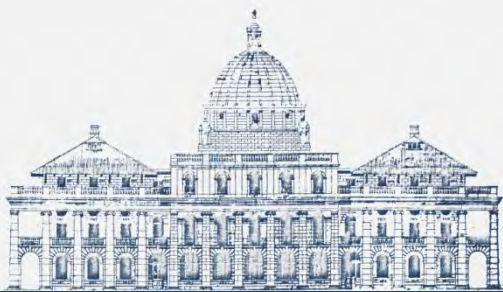

The Relocation of the
COURT OF FINAL APPEAL

PROJECT PROGRAMME

Oct 2012	Invitation to Tender
2 nd Quarter of 2013	Funding approval from the LegCo Finance Committee
2 nd Quarter of 2013	Commencement of Conversion Works
4 th Quarter of 2014	Completion of Conversion Works

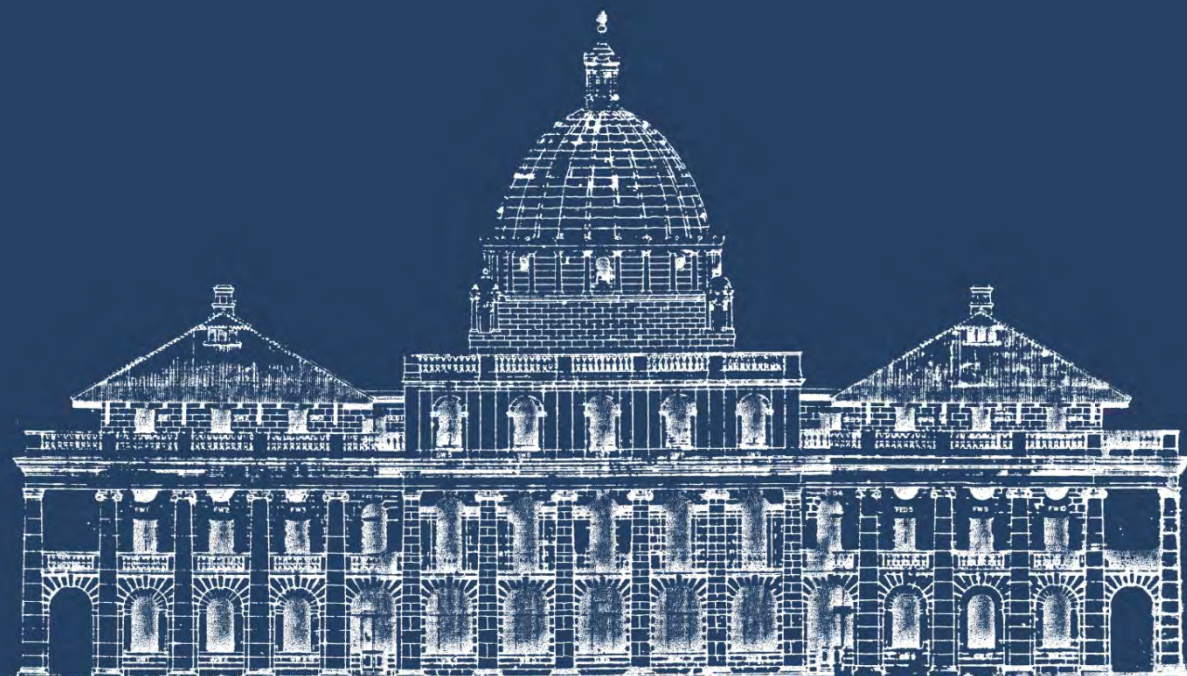

The Relocation of the

COURT OF FINAL APPEAL

Consultation with the Panel on Administration of Justice and Legal Services (AJLS)
of the Legislative Council

10 July 2012