

For discussion on
20 April 2012

**Legislative Council Panel on Home Affairs
Expansion and Improvement of Wanchai Campus of
Hong Kong Academy for Performing Arts**

PURPOSE

This paper briefs Members on a proposed capital works project for the expansion and improvement of the Wanchai campus of the Hong Kong Academy for Performing Arts (HKAPA).

BACKGROUND

2. Established in 1984 under the HKAPA Ordinance (Cap. 1135), the Academy provides professional undergraduate education and practice-based postgraduate programmes in Dance, Drama, Film and Television, Music, Theatre and Entertainment Arts, and Chinese Traditional Theatre.

3. The site of the main HKAPA campus is located on the Wanchai waterfront. Development of the HKAPA's academic programmes and gradual expansion of student population over the years has given rise to a demand for increased campus space. Since 2006, the HKAPA established its second campus in Bethanie in Pokfulam, which principally houses specialist facilities for the School of Film and Television.

PROJECT SCOPE AND NATURE

4. The scope of the project comprises –

- (a) construction of a 9-storey high building block adjoining the north-eastern side of the existing Theatre Block. This will house

classrooms, studios, laboratories, music rooms, office, workshops and support facilities (e.g. mechanical and electrical rooms, dressing rooms, storage areas). The new block will also include a chiller plant room for the installation of an air cooled chiller for serving the whole Wanchai campus in future;

- (b) construction of a one-storey lightweight structure on the flat roof over the existing Concert Hall, Lyric Theatre, TV Studio and Recital Hall at the Theatre Block. The structure will house studios, laboratories (e.g. computer laboratory, dance science laboratory, multi-media laboratory and other technical laboratories), office and support facilities (e.g. dressing rooms and storage areas);
- (c) construction of an additional floor at upper level of the void space over the existing Scenic Art Workshop at UG/F of the Theatre Block. The additional floor will house classrooms and storage areas;
- (d) conversion of the existing fountain pump room into an administration office and a store room; and
- (e) redesign and reconfiguration of the existing library including establishment of learning commons with group study rooms.

_____ A site plan, artist's impressions of the annex building and sectional drawing are at Enclosure 1, 2A to 2B and 3A to 3C respectively.

JUSTIFICATIONS

5. When the existing Wanchai campus buildings of the HKAPA were constructed, they were originally designed to house 600 full-time students. Development of the Academy's academic programmes and gradual expansion of student population over the years have given rise to further demand for campus space. In 2011/12, the total number of full-time equivalent students is 932¹. While the space shortage was partly relieved with the lease of Bethanie

¹ The ratio of part-time students to full-time students is based on the duration of individual part-time programme and the number of teaching hours involved.

(a heritage building at Pokfulam which provides about 1 240 m² in net operating floor area (NOFA)) as the HKAPA's second campus since 2006, the problem has not been entirely resolved.

6. With the migration from current three-year programme to a four-year undergraduate degree programme structure from the 2012/13 academic year onwards, the HKAPA's space shortage problem will be aggravated due to the projected increase of full-time equivalent students to 979¹ by 2016/2017. Apart from increase in student population, more space will be required because more classes, lectures, rehearsals and inter-disciplinary activities will be held concurrently under the new academic structure. On the basis of the planning standards of the University Grants Committee, the HKAPA estimates that there will be a space shortfall of 8 287 m² in NOFA under the new academic structure by 2016/2017.

7. In light of the space shortfall explained above, the HKAPA plans to carry out the proposed expansion and improvement of the existing campus (works under paragraphs 4(a) to (d) above) to provide some additional 5 120 m² in NOFA to support the implementation of the new four-year degree programme structure and to relieve the existing space shortage. The project will provide classrooms, music rooms, studios, laboratories, study space, offices and support facilities.

8. The HKAPA also plans to take this opportunity to redesign and reconfigure the existing library to rationalise its layout, and enhance the learning environment by improving the layout of the common area to facilitate self-study, project work and co-operative learning, including the establishment of group study rooms.

9. This campus expansion and improvement project seeks to maximise the structural capacity of the existing premises and the extension blocks to provide additional space. In the meantime, the HKAPA will continue to rent commercial premises in or near Wanchai to provide the necessary teaching and rehearsal space.

FINANCIAL IMPLICATIONS

10. The latest estimated cost of the project is around \$444.8 million in money-of-the-day prices.

IMPLEMENTATION TIMETABLE

11. We plan to seek the approval of the Public Works Sub-committee and the Finance Committee of the Legislative Council for the proposed project in May 2012 and June 2012 respectively.

12. Subject to the funding approval of the Finance Committee, the HKAPA plans to commence the construction works in the second quarter of 2013 for completion in the fourth quarter of 2015.

PUBLIC CONSULTATION

13. The project will be executed within the existing boundary of the Wanchai campus of the HKAPA. There are no residential developments nearby, and the project will not affect residents in the vicinity. The proposed project has received support from the Wan Chai District Council and the Task Force on Harbourfront Developments on Hong Kong Island under the Harbourfront Commission. The HKAPA has also consulted its staff and students in December 2011 who have expressed support for the project.

ADVICE SOUGHT

14. Members are invited to support the funding application for the expansion and improvement of the Wanchai campus of the HKAPA.

Home Affairs Bureau
April 2012

28QJ – Expansion and Improvement of Wanchai Campus of Hong Kong Academy for Performing Arts

28QJ – 香港演藝學院灣仔校園擴建及改善工程

總平面圖 SITE PLAN

比例 SCALE 1:800

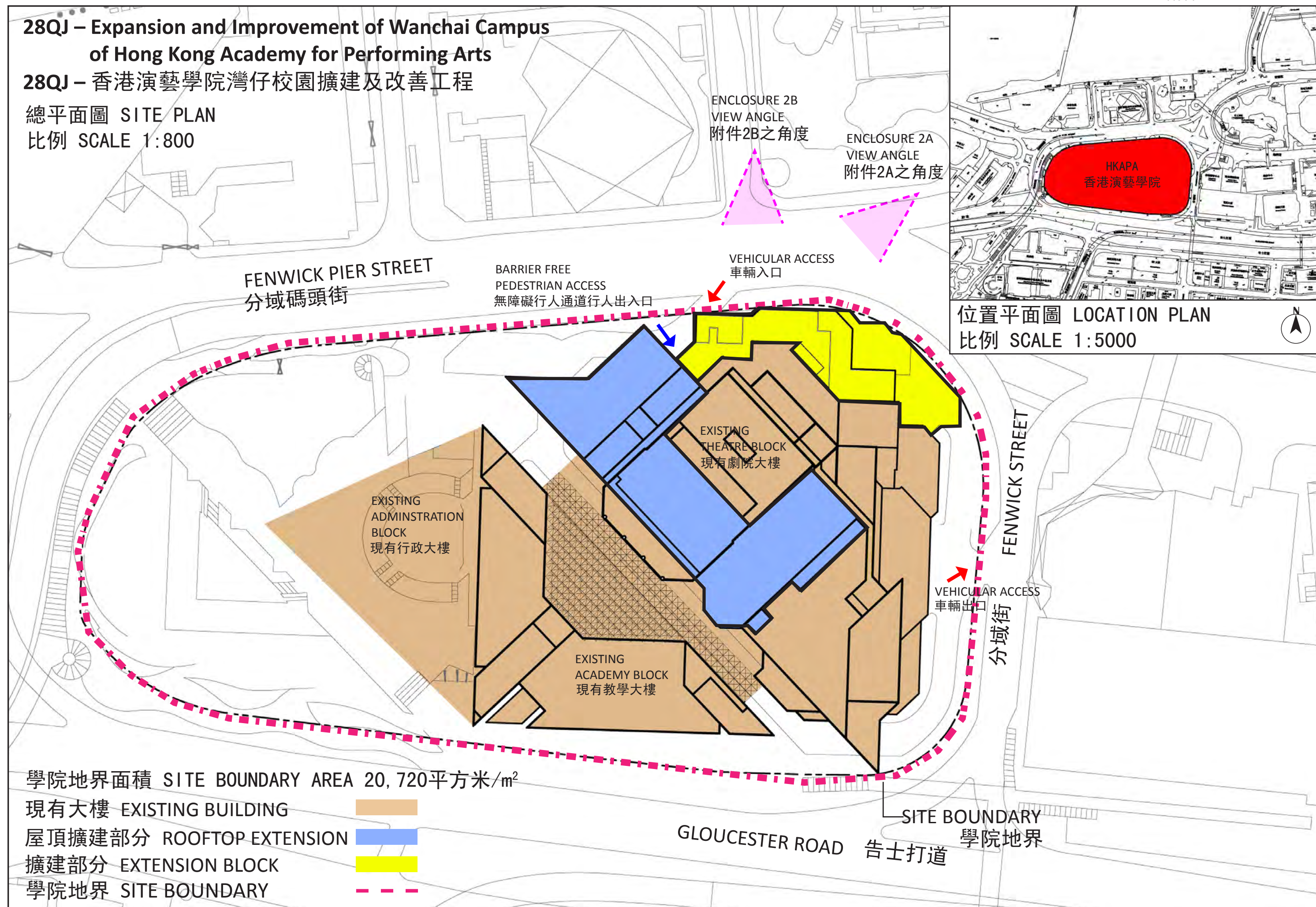

位置平面圖 LOCATION PLAN
比例 SCALE 1:5000



**28QJ – Expansion and Improvement of Wanchai Campus
of Hong Kong Academy for Performing Arts**
28QJ – 香港演藝學院灣仔校園擴建及改善工程

VIEW OF THE EXPANSION FROM NORTH-EAST (ARTIST'S IMPRESSION)

從東北面望向擴建部份外觀構思圖



**28QJ – Expansion and Improvement of Wanchai Campus
of Hong Kong Academy for Performing Arts**
28QJ – 香港演藝學院灣仔校園擴建及改善工程

BIRD'S VIEW OF THE EXPANSION FROM NORTH (ARTIST'S IMPRESSION)

從北面望向擴建部份的鳥瞰圖



28QJ – Expansion and Improvement of Wanchai Campus of Hong Kong Academy for Performing Arts

28QJ – 香港演藝學院灣仔校園擴建及改善工程

截面圖BB' SECTIONAL PLAN BB'

比例 SCALE 1:250

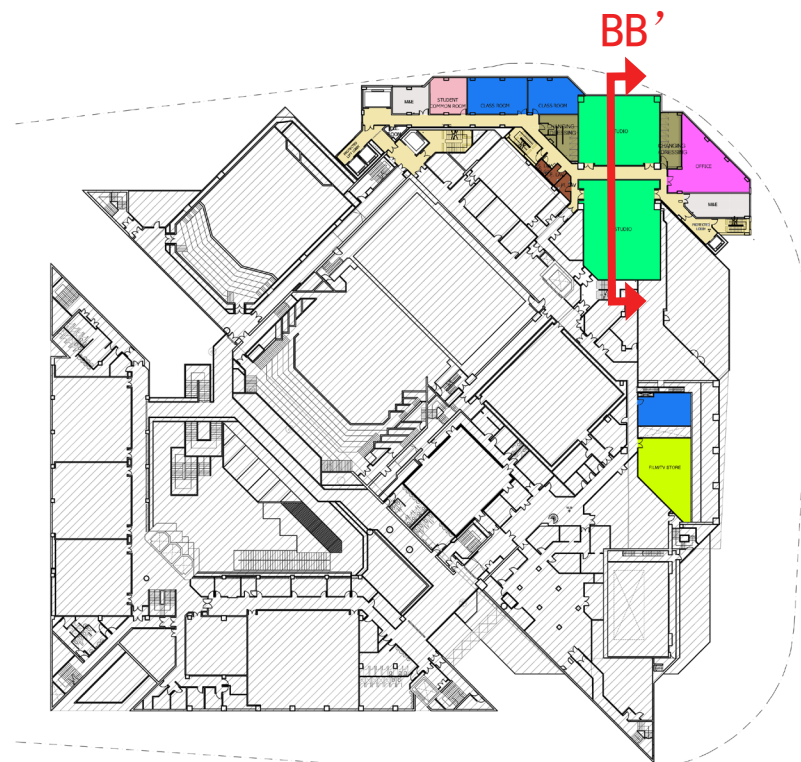

SITE BOUNDARY
基地邊界

FENWICK PIER STREET
分域碼頭街

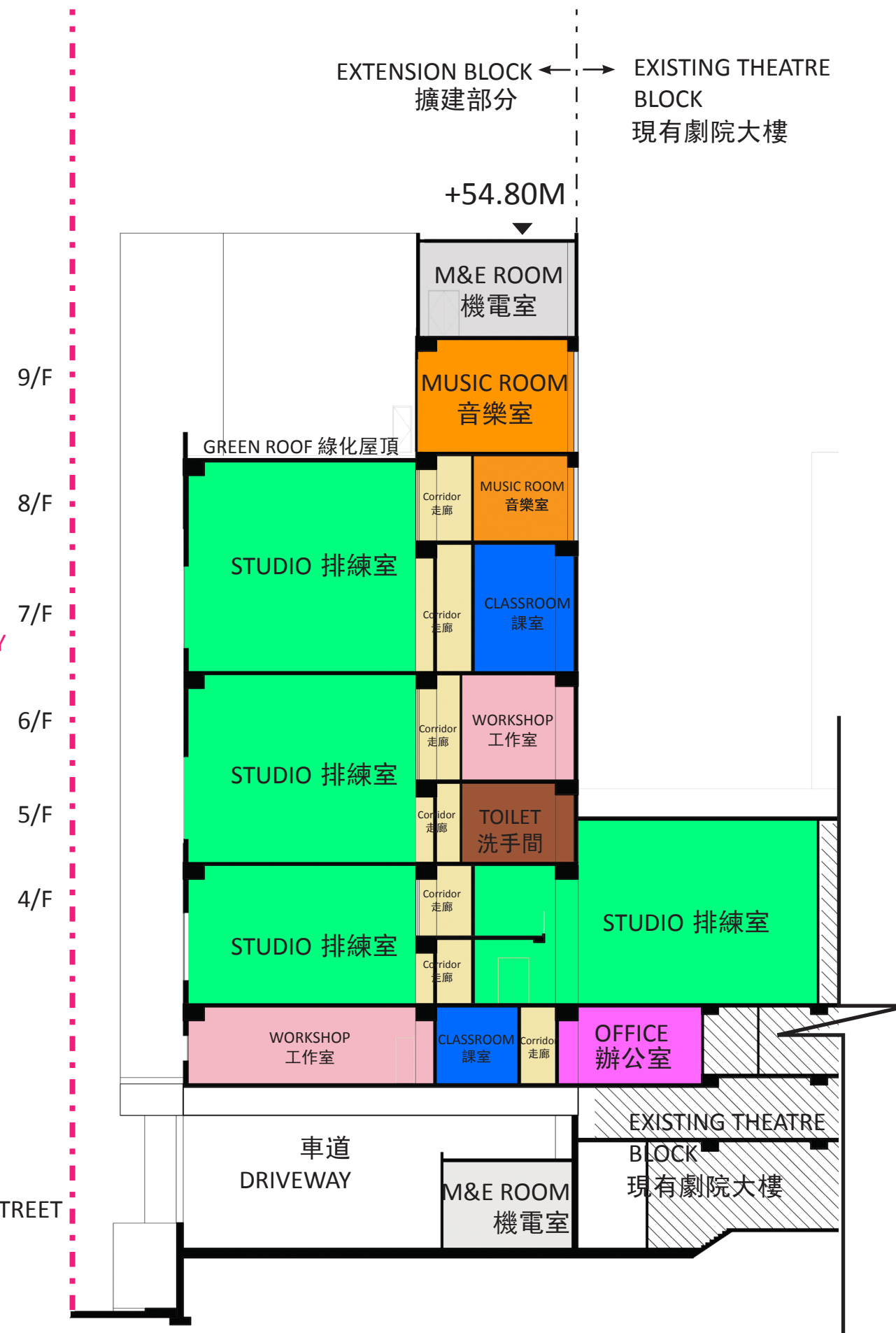

28QJ – Expansion and Improvement of Wanchai Campus of Hong Kong Academy for Performing Arts

28QJ – 香港演藝學院灣仔校園擴建及改善工程

截面圖CC' SECTIONAL PLAN CC'

比例 SCALE 1:100

