

香港特別行政區政府  
The Government of the Hong Kong Special Administrative Region

發展局(規劃地政科)

香港添馬添美道二號  
政府總部西翼十七樓



Development Bureau  
(Planning & Lands Branch)

17/F, West Wing  
Central Government Offices  
2 Tim Mei Avenue, Tamar

本局檔號 Our Ref. DEVB(PL-UR) 36/02/03 Pt.14

來函檔號 Your Ref.

電話 Tel.: 3509 8807

傳真 Fax: 2905 1002

11 March 2013

Clerk to the Public Works Subcommittee  
Legislative Council Complex  
1 Legislative Council Road  
Central  
Hong Kong  
(Attn: Ms Annette LAM)

Dear Ms LAM,

**Public Works Subcommittee  
Follow-up Action on the Discussion  
at the Meeting Held on 5 February 2013**

At the meeting of the Public Works Subcommittee on 5 February 2013, Members requested further information relating to PWP Item No. 111KA - Government, Institution or Community Facilities in the Kwun Tong Town Centre Redevelopment – Additional Medical and Health Facilities. I have pleasure in enclosing the information as below –

- (a) There is one disabled toilet in the Occupational Health Clinic (OHC) in the new Kwun Tong Jockey Club Health Centre (KTJCHC). This is in accordance with the requirement under the relevant provision in the Building (Planning) Regulations that there should be one disabled toilet compartment provided on a floor if there are no more than 20 toilet compartments (male and female in total) on that same floor. According to the records of Labour Department, the majority of patients visiting OHC are workers with work-related illnesses, including musculoskeletal disorders, dermatitis, hearing disorders, etc. Only a very small number of the patients on wheel chair attend OHC for treatment. Therefore, no enhanced provision is considered necessary.

If the disabled toilet at the OHC is occupied, attending disabled patients can use the other disabled toilets in the KTJCHC, namely, at either the Hospital Authority's General Out-patient Clinic (GOPC) or the Department of Health's

Maternal & Child Health Centre (MCHC) or Government Dental Clinic (GDC). There are three disabled toilets at the GOPC which is at the upper ground floor and two disabled toilets at the MCHC and the GDC which is at the lower ground floor;

- (b) The ratio of male to female toilet compartments in the OHC is approximately 1:1.5. This is an enhanced ratio from the requirement under the relevant Practice Notes issued by the Buildings Department at 1:1;
- (c) The breast-feeding room at the MCHC is located next to the Children Playing Area (please see the plan attached at the **Annex**). The Government developed the Advisory Guidelines on Babycare Facilities in August 2008 for reference by government departments and public organisations. According to these Guidelines, the breast-feeding room should be family-friendly. Supporting facilities in the breast-feeding room include sink with lever tap and soap dispenser, hot and cold water dispenser (for bottle-feeding), nappy changing table with raised edge and wipeable soft mat, breastfeeding chair and simple breast-feeding equipment; and
- (d) The ratio of male to female toilet compartments in the MCHC is approximately 1:5. This is an enhanced ratio from the requirement under the relevant Practice Notes issued by the Buildings Department at 1:1.

Yours sincerely,



( Winnie So )  
for Secretary for Development

c.c.

Secretary for Financial Services & the Treasury (Attn.: Ms Joyce HO)  
Director of Civil Engineering & Development (Attn.: Mr Janson WONG)  
Director of Health (Attn.: Ms June HO)  
Commission for Labour (Attn.: Ms Jay CHAN)

Internal  
CEO(RM)

圖例 LEGEND :

- 母嬰健康院(衛生署)  
MATERNAL & CHILD HEALTH CENTRE  
(DEPARTMENT OF HEALTH)
- 走廊/公用地方  
CORRIDOR / COMMON AREA

協和街  
Hip Wo Street

地下低層樓層(部分圖則)  
LOWER GROUND FLOOR(PART PLAN)

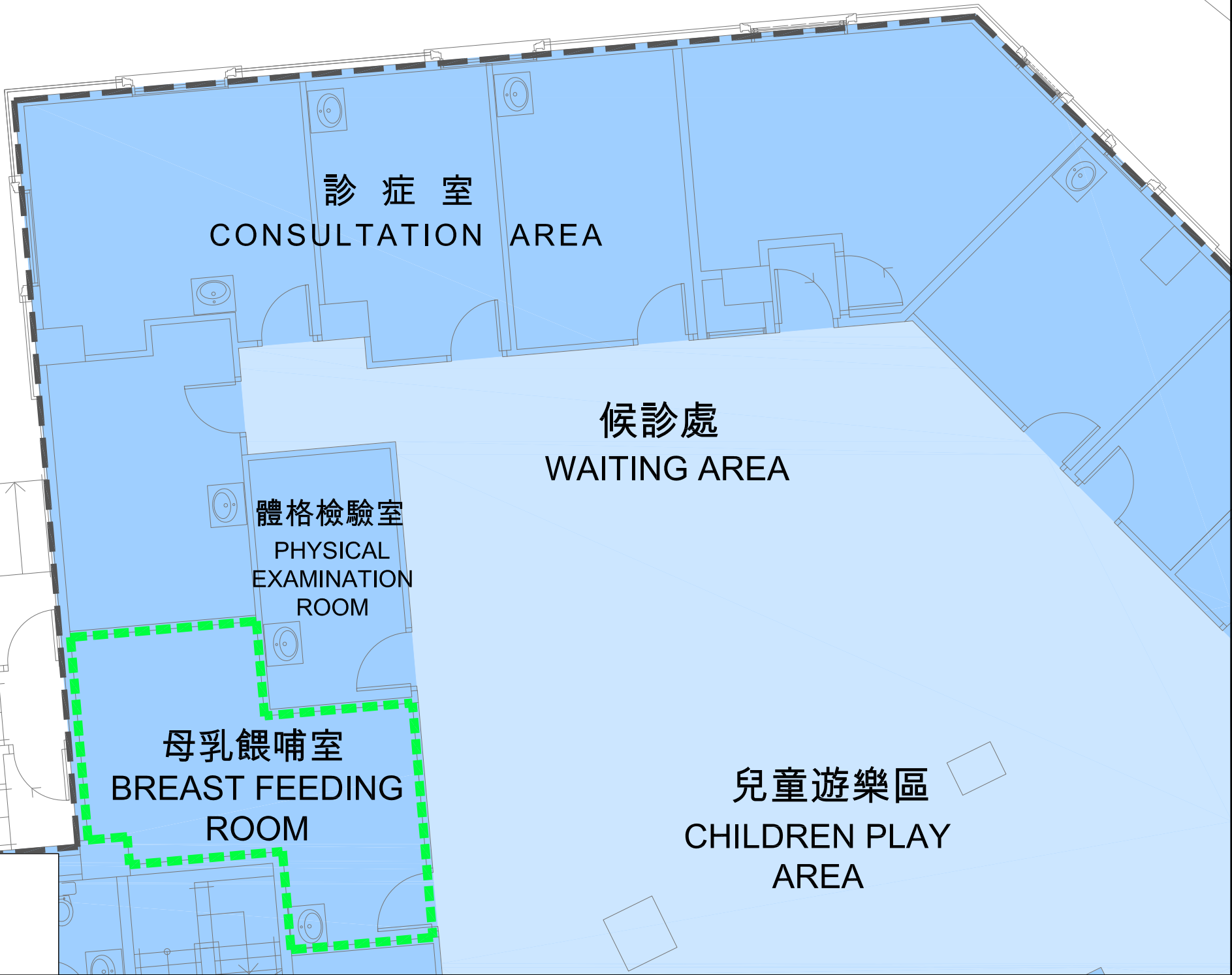

2012年至2013年年度工務小組委員會文件 PWSC Submission 2012 - 2013

|  |             |            |            |                  |  |
|--|-------------|------------|------------|------------------|--|
| <div>圖則名稱 Drawing Title</div> <div>工務計劃項目第7111KA號 -</div> <div>觀塘市中心重建計劃中重置的政府、機構/社區設施 -</div> <div>增置醫療衛生設施</div> <div>母嬰健康院內的母乳餵哺室位置圖</div> <div>PWP ITEM NO.7111KA -</div> <div>GOVERNMENT, INSTITUTION OR COMMUNITY FACILITIES IN THE KWUN TONG TOWN</div> <div>CENTRE REDEVELOPMENT</div> <div>- ADDITIONAL MEDICAL AND HEALTH FACILITIES</div> <div>Location Plan of Breast-feeding Room inside Maternal &amp; Child Health Centre</div> | 繪圖 Drawn    | 簽署 Initial | 日期 Date    | 項目編號 Item no.    | 辦事處 Office   |
|  | C.K. WONG   | SIGNED     | 05.03.2013 | 7111KA           |  |
|  | 核對 Checked  | 簽署 Initial | 日期 Date    | 比例 Scale         | 九龍拓展處<br>KOWLOON DEVELOPMENT OFFICE  |
|  | K.K. WU     | SIGNED     | 05.03.2013 | N.T.S.           |  |
|  | 核准 Approved | 簽署 Initial | 日期 Date    | 圖則編號 Drawing no. | <div><div>CEDD</div>土木工程拓展署<br/>CIVIL ENGINEERING<br/>AND DEVELOPMENT DEPARTMENT</div> |
|  | H.K. CHAN   | SIGNED     | 05.03.2013 | KZ748            |  |