

Legislative Council Panel on Housing

**Public Works Programme Item No. B083TI –
Public Transport Interchange at Pak Wan Street, Sham Shui Po**

PURPOSE

This paper seeks Members' support for the Government's proposal to upgrade **B083TI** to Category A at an estimated cost of \$108.2 million in money-of-the-day (MOD) prices, to support the public housing development programme at Pak Tin Estate, Sham Shui Po.

PROJECT PROPOSAL

2. The proposed scope of works under **B083TI** includes –
 - (a) construction of a covered public transport interchange (PTI) with six bays for franchised buses and green minibuses; and
 - (b) associated works for the PTI including plumbing, drainage, public lighting facilities, fire services, ventilation, electrical and mechanical systems.

—————
A site plan and an artist's impression drawing of the proposed PTI are at **Annex A** and **Annex B** respectively.

3. Subject to the funding approval from the Legislative Council (LegCo) Finance Committee, we plan to commence the construction of the proposed works in 2016 for completion in end 2019.

JUSTIFICATION

4. There is an existing open-air PTI at Pak Wan Street, Pak Tin Estate. We need to vacate the existing PTI to provide land for the construction of two public housing domestic blocks, which will provide about 1 100 flats for a population of about 3 370 as part of the public housing development programme.

5. To provide continual service of the existing public transportation facilities for franchised buses and minibuses, we propose to construct a new PTI at the southern section of Pak Wan Street. In addition, in order to optimise the land use, four domestic blocks will be built above the PTI as part of the public housing development programme. This will provide about 2 000 flats for a population of about 6 120. The drop-off/pick-up facilities and stacking area will be peripherally and centrally located at the PTI respectively. This arrangement can enhance the operation efficiency and also enhance passengers' safety as they do not have to get across the traffic.

6. To tie in with the programme of the domestic blocks above the proposed PTI, we need to commence the construction of PTI and associated works in 2016. As an integral part of the composite development, the construction works of the PTI has to be implemented in conjunction with the public housing development. The Government therefore plans to entrust the design and construction of the proposed works to the Hong Kong Housing Authority. This arrangement will allow better coordination of the PTI project and the public housing development programme to ensure timely completion of the PTI and associated works for public use. Upon completion of the construction, the PTI will be handed over to relevant departments for management and maintenance.

PROJECT ESTIMATE

7. The capital cost of the project is estimated to be \$108.2 million in MOD prices.

PUBLIC CONSULTATION

8. The Government consulted the Housing Affairs Committee of the Sham Shui Po District Council on the proposed public housing development programme including the construction of the proposed PTI on 11 October 2012. Members had no objection to the proposal.

IMPLEMENTATION

9. Subject to Members' support, we plan to seek funding approval from the LegCo Finance Committee after consulting the LegCo Public Works Subcommittee in end 2015.

ADVICE SOUGHT

10. Members are invited to support the funding proposal for the proposed works.

**Transport and Housing Bureau
May 2015**

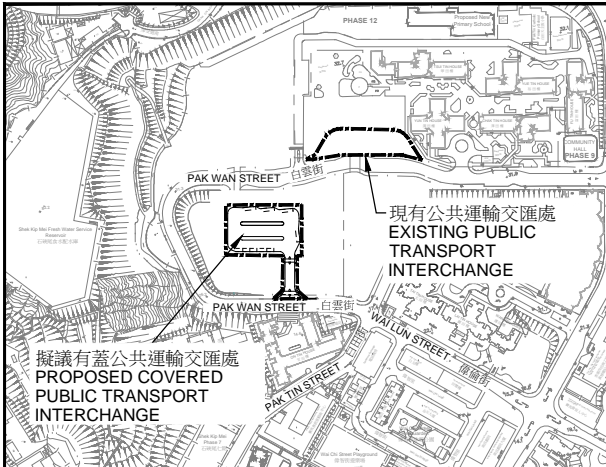

索引圖 KEY PLAN
比例 SCALE 1 : 7500

擬議有蓋公共運輸交匯處
PROPOSED COVERED
PUBLIC TRANSPORT
INTERCHANGE

擬議停車處供專利巴士及
綠色專線小巴使用
PROPOSED BAYS FOR
FRANCHISED BUSES
AND GREEN MINI BUSES

圖例	LEGEND
	施工區界限 LIMIT OF WORKS AREA
	擬議行車道 PROPOSED CARRIAGEWAY
	擬議行人路 PROPOSED FOOTPATH
	擬議安全島 PROPOSED TRAFFIC ISLAND

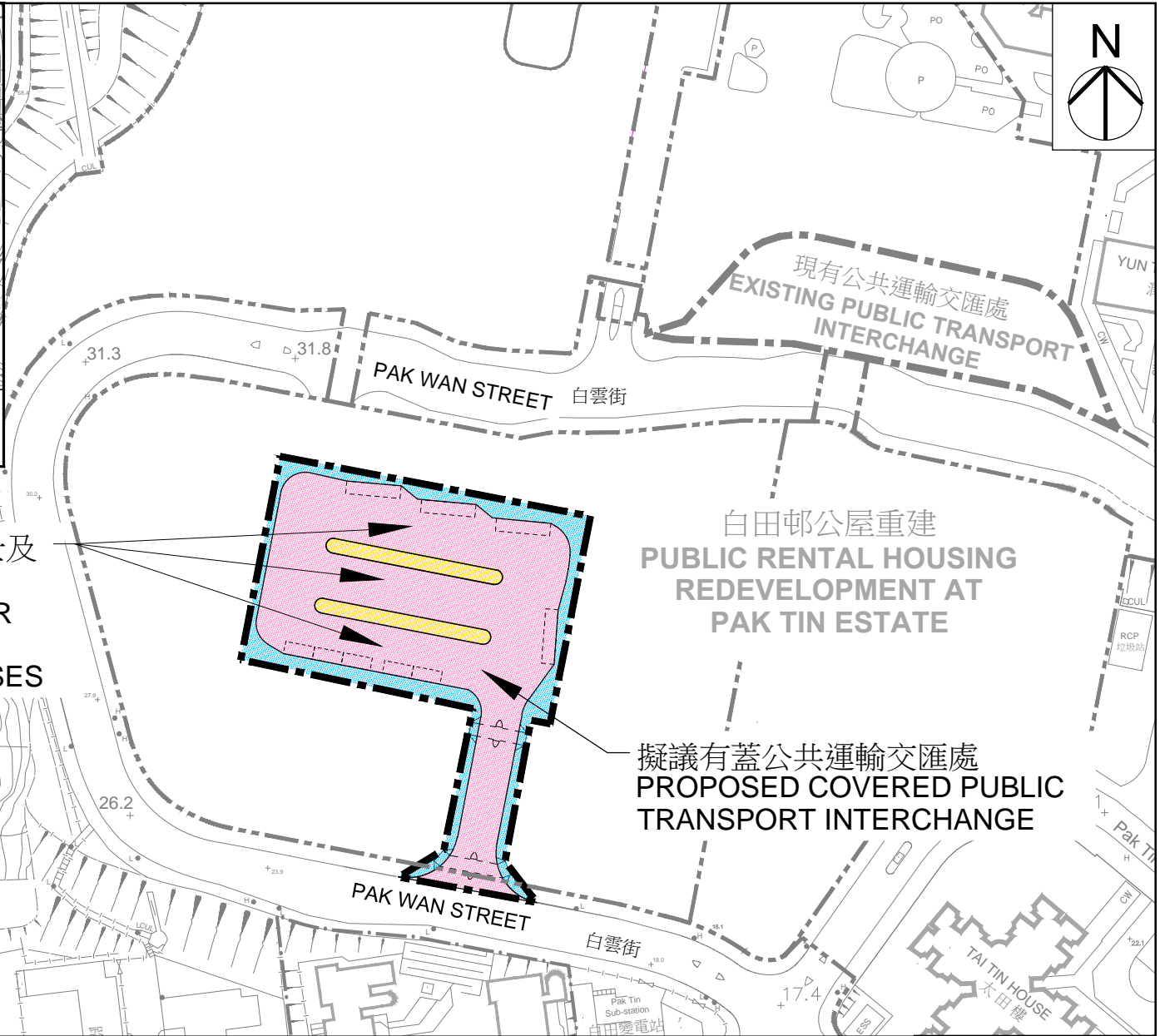

白田邨公屋重建
PUBLIC RENTAL HOUSING
REDEVELOPMENT AT
PAK TIN ESTATE

擬議有蓋公共運輸交匯處
PROPOSED COVERED PUBLIC
TRANSPORT INTERCHANGE

工務計劃項目編號 B083TI
深水埗白雲街公共運輸交匯處
PWP ITEM NO. B083TI

PUBLIC TRANSPORT INTERCHANGE AT PAK WAN STREET, SHAM SHUI PO

工地平面圖
SITE PLAN

比例 SCALE : 1:1500



工務計劃項目編號 B083TI
深水埗白雲街公共運輸交匯處
PWP ITEM NO. B083TI

PUBLIC TRANSPORT INTERCHANGE AT PAK WAN STREET, SHAM SHUI PO

構思圖
Artist's Impression
Drawing

附件一
Annex B