

立法會
Legislative Council

LC Paper No. CB(1)288/16-17(04)

Ref.: CB1/PL/DEV

Panel on Development

Meeting on 16 December 2016

**Background brief on
the re-provisioning of Transport Department's
Vehicle Examination Centres at Tsing Yi**

Purpose

This paper provides background information on a proposal submitted by the Administration in May 2016 to relocate the three existing Vehicle Examination Centres ("VECs") in Kowloon Bay, New Kowloon Bay and To Kwa Wan of the Transport Department to Sai Tso Wan, Tsing Yi ("the re-provisioning project"). It also summarizes the views and concerns expressed by members when the proposal was discussed by the Panel on Development ("DEV Panel") in the 2015-2016 session.

Background

2. As one of the steps under the "Energizing Kowloon East" ("EKE") initiative to enhance the connectivity, improve the environment and unleash the development potential of Kowloon East ("KE"),¹ the Administration has suggested relocating or rationalizing the existing government facilities in the Kowloon Bay and Kwun Tong Action Areas in KE.²

¹ More information about the EKE initiative is available on the website of the [EKE Office](#).

² More information about the Kowloon Bay and Kwun Tong Action Areas is available in [LC Paper No. CB\(1\)599/11-12\(03\)](#).

3. According to the Administration, the existing Kowloon Bay VEC and New Kowloon Bay VEC are located within the Kowloon Bay Action Area, which is planned under the EKE initiative to be developed into a commercial/office hub to provide about 480 000 square metres of commercial floor space. Relocating the above two VECs would release the development potential and facilitate comprehensive development of the Kowloon Bay Action Area. The relocation of the existing To Kwa Wan VEC is to make way for the planned development at Kai Tak, including a continuous waterfront promenade providing quality open space for public enjoyment.

The re-provisioning project

4. The Administration submitted a proposal to relocate the existing Kowloon Bay, New Kowloon Bay and To Kwa Wan VECs to Sai Tso Wan, Tsing Yi to DEV Panel for deliberation at its meeting on 24 May 2016.

5. The scope of the re-provisioning project comprises:

- (a) construction of a new 4-storey VEC at Sai Tso Wan, Tsing Yi;
- (b) road widening works of approximately 485 metres in length along the eastern side of Sai Tso Wan Road; and
- (c) decontamination and demolition of the three existing VECs.

6. The new VEC site occupies an area of about 34 050 square metres at Sai Tso Wan, Tsing Yi. A site plan showing the proposed new VEC is in **Appendix I**. Details of the facilities and operation of the proposed new VEC are set out in **Appendix II**.

7. Most DEV Panel members present at the discussion on the re-provisioning project on 24 May 2016 did not support the Administration's submission of the relevant funding proposal to the Public Works Subcommittee ("PWSC") for consideration. At the Panel's request, the Administration provided supplementary information on the project ([LC Paper No. CB\(1\)1125/15-16\(01\)](#)) in July 2016. The Administration did not submit the funding proposal to PWSC within the 2015-2016 legislative session.

Major views and concerns expressed by members

8. The major views and concerns expressed by members at the meeting on 24 May 2016 are summarized in the ensuing paragraphs.

Justifications for the proposed relocation

9. There were concerns among members about the relocation of the existing three VECs at various locations to a single VEC at Tsing Yi. Some members opined that the present arrangement for providing VECs at multiple locations had its merits because motorists might choose to use the services of the VEC of which the location was more convenient to them. The relocation proposal had disregarded the need of the residents in KE for services provided by VECs in their locality. Moreover, maintaining three VECs would allow the Transport Department to continue its vehicle examination services in the event that the service of any of the VECs was interrupted.

10. The Administration advised that the proposed site at Tsing Yi was selected having regard to the findings of a territory-wide site search exercise. The site would be accessible to and convenient for motorists. The proposal to re-provide all the existing vehicle examination facilities in Kowloon Bay and To Kwa Wan at a single VEC would not only enhance operational efficiency and flexibility, but also allow a better utilization of land resources. To ensure service continuity, the new VEC would provide 30 inspection lanes, with a daily handling capacity of 1 000 vehicles, which exceeded the estimated daily patronage of the three VECs of 800.

Traffic impact of the new Vehicle Examination Centre

11. Some members expressed concerns about the impact of the commissioning of the new VEC on the road network in the vicinity, taking into consideration that many vehicles would have to go to Tsing Yi in future in order to access the services for vehicle examination.

12. The Administration advised that a Traffic Impact Assessment ("TIA") had been conducted in early 2014 in respect of the development of the proposed new VEC at Tsing Yi. Given that the maximum handling capacity of the new VEC would be 1 000 and it would provide services through advance booking, the arrivals and departures of vehicles were expected to be spread out during the day, with an estimated hourly patronage of about 100 vehicles. The TIA had recommended necessary mitigation measures in order to minimize the possible traffic impact on the

neighbourhood and to enhance the operation efficiency of the new VEC. These measures included widening the eastern section of Sai Tso Wan Road and providing a temporary vehicle queuing area adjoining the new VEC site to cater for vehicles which might arrive earlier than scheduled.

Effectiveness of the proposed traffic mitigation measures

13. Some members questioned the effectiveness of the proposed traffic mitigation measures, and requested the Administration to provide more information on the TIA in respect of the proposed project, the justifications for the proposed traffic mitigation measures and how the implementation of the proposed measures could mitigate the traffic impact generated upon the commissioning of the new VEC on the roads nearby. The Administration provided supplementary information in July 2016 ([LC Paper No. CB\(1\)1125/15-16\(01\)](#)).

Re-provisioning of the existing temporary parking spaces at the project site

14. According to the survey conducted by the Administration in 2015, there were about 250 vehicles parking on the temporary parking site currently provided at the proposed project site. Some members opined that the re-provisioning arrangement for the temporary parking site might not be able to cater for the parking demand of the vehicles (including container trucks) affected by the project.

15. The Administration advised that a suitable site in the vicinity had been identified for the re-provision of about 110 temporary parking spaces. In addition, two other temporary parking sites at Tsing Yi South would have spare parking spaces, which could cater for the parking of about 140 vehicles. The Administration undertook to keep in view the demand for parking spaces after the commissioning of the new VEC, and would consider in due course whether part of the temporary vehicle queuing area adjoining the new VEC site could be used for providing parking spaces.

Latest development

16. At the meeting of the DEV Panel to be held on 16 December 2016, the Administration will brief the Panel on a proposal on the re-provisioning of Transport Department's VECs at Tsing Yi.

Relevant papers

17. A list of relevant papers with their hyperlinks is in **Appendix III**.

Council Business Division 1
Legislative Council Secretariat
9 December 2016

擬議新驗車中心的工地平面圖
Site plan of the proposed new Vehicle Examination Centre at Tsing Yi

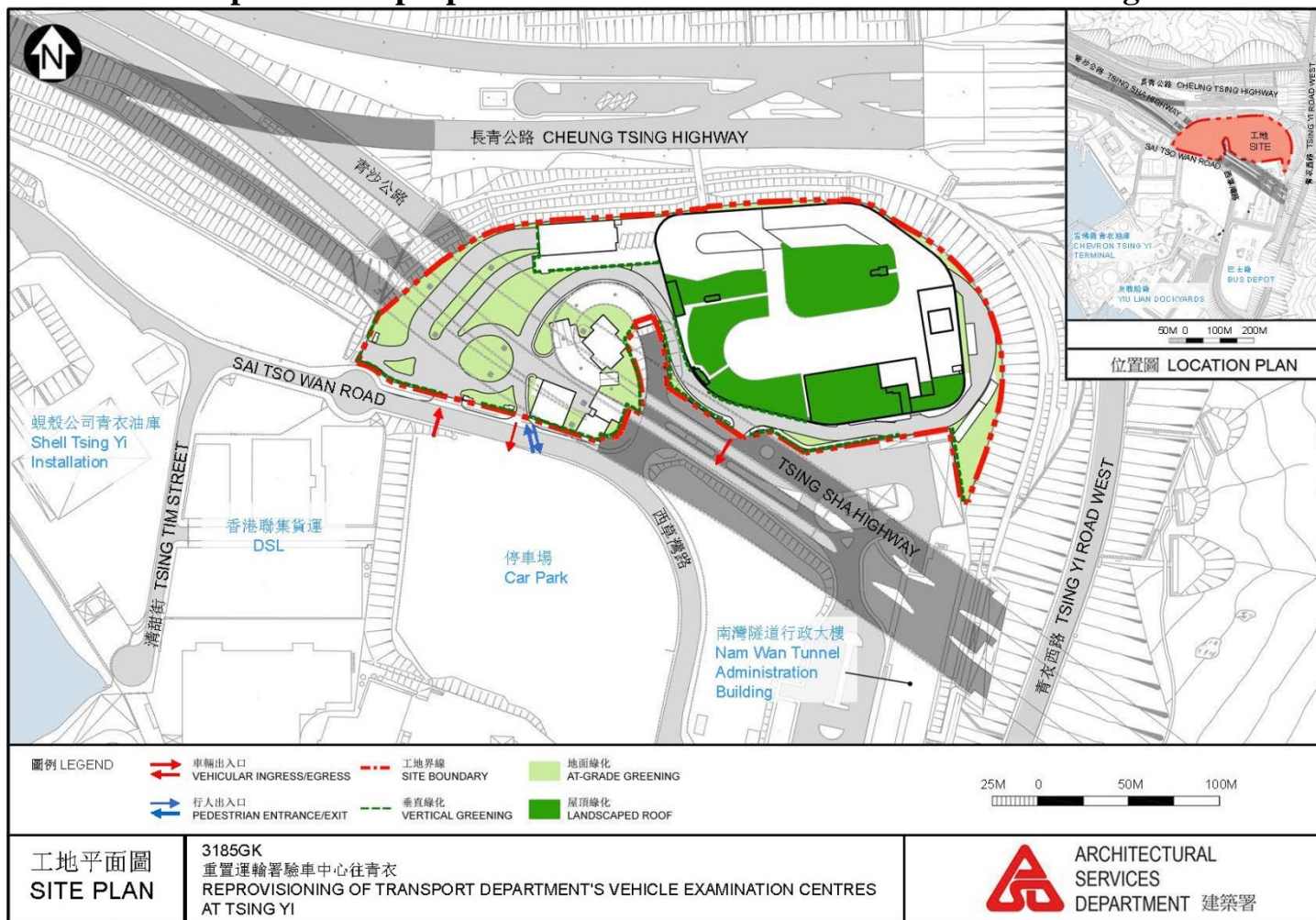

資料來源：[立法會CB\(1\)930/15-16\(03\)號文件](#)
 Source: [LC Paper No. CB\(1\)930/15-16\(03\)](#)

Details of the Facilities and Operation of the Proposed New Vehicle Examination Centre in Tsing Yi

1. Services currently provided by the three existing VECs will be reprovisioned in the new VEC at Tsing Yi are as follows:

- (i) annual vehicle examination for commercial vehicles (including taxis, light buses, non-franchised buses, goods vehicles, trailers, special-purpose vehicles);
- (ii) pre-registration vehicle examination for parallel-import vehicles and vehicles with non-factory-built bodies; and
- (iii) other vehicle examinations such as call-up inspections, type approval inspections (for new vehicle types), vehicle alteration inspections, etc.

Facilities of the proposed new VEC

2. The new VEC will be equipped with the following facilities:

Inspection Lanes

- 30 inspection lanes to serve different classes of vehicles, organized in 10 lanes per floor. Types include goods vehicle inspection lanes, trailer inspection lanes, bus inspection lanes, taxi inspection lanes, parallel-import vehicle inspection lanes, type approval inspection lanes and motorcycle inspection lanes.

Vehicle Testing Facilities

- 10 chassis dynamometers for emission testing of commercial vehicles;
- 1 tilting stability test platform for tilt testing of buses during type-approval examinations;
- brake testing lane and test ramps for different types of vehicles; and
- other ancillary facilities for vehicle examination such as swept-circle test area, axle weigh bridges and four-post hoists.

Others

- Vehicle waiting and queuing spaces;
- office accommodation (including appointment offices);
- plant rooms, parking spaces for visitors, etc.; and

- electronic and information technology systems related to vehicle examination, security and operational surveillance, vehicle circulation management, etc.

Operation of the new VEC

3. The new VEC at Tsing Yi will accommodate 30 vehicle inspection lanes on different floors, together with other necessary vehicle testing facilities (such as chassis dynamometers, tilting stability test platform, etc.), capable of serving all vehicle classes such as taxi, light bus, bus, goods vehicle, trailer, etc. The design maximum handling capacity of the proposed new VEC is 1 000 vehicles per day.

4. A vehicle to undergo examination/inspection is required to make prior appointment. The vehicle owner or his/her agent can make the appointment through internet, or in person at the appointment office of the VEC. Specific date and time will be assigned for the vehicle examination appointment.

5. At the date of appointment, the vehicle will go into the VEC and wait at the available queuing spaces, and then go through different stages of inspection along the inspection lane, including visual check, lamp test, brake test, exhaust emission test, under-carriage inspection and any other inspections as required. Some vehicles will have to undergo certain tests at the vehicle testing facilities.

6. There will be about 200 staff in the new VEC including staff under outsourced services such as security, cleaning, etc. The Transport Department will arrange suitable transport to/from the nearest public transport points for government employees.

7. The normal opening hours of the new VEC is 8:30 to 18:00 on Monday to Friday and 8:30 to 13:00 on Saturday. The new VEC will open the entry gate earlier (i.e. about an hour before normal operation hours) to allow vehicles to queue inside the new VEC site, when necessary.

**Re-provisioning of Transport Department's
Vehicle Examination Centres at Tsing Yi**

List of relevant papers

Committee	Date of meeting	Paper
Panel on Development	24 May 2016	<p>Administration's paper on "Re-provisioning of Transport Department's Vehicle Examination Centres at Tsing Yi" [LC Paper No. CB(1)930/15-16(03)]</p> <p>Minutes of meeting [LC Paper No. CB(1)1194/15-16]</p> <p>Follow-up paper [LC Paper No. CB(1)1125/15-16(01)]</p>