

**立法會**  
**Legislative Council**

立法會 CB(1)982/98-99 號文件

檔 號 : CBI/BC/9/98  
電 話 : 2509 4189  
日 期 : 1999 年 3 月 8 日  
發 文 者 : 法案委員會秘書  
受 文 者 : 李華明議員 (主席)  
          何鍾泰議員  
          夏佳理議員  
          陳鑑林議員  
          單仲偕議員

---

**《1999 年電力 (修訂) 條例草案》委員會**

在法案委員會 1999 年 2 月 12 日的會議席上，委員要求政府當局提供由兩家電力公司向有關工程的承建商或其他負責各方提供的樣本圖則，供議員參閱。現附上由兩家電力公司提供的樣本圖則，供閣下參閱。

法案委員會秘書

(許兆廣代行)

連附件

副本致：助理秘書長 1  
          資料研究及圖書館服務部主管 —— 3 份  
          助理法律顧問 2

**立法會**  
**Legislative Council**

LC Paper No. CB(1)982/98-99

Ref : CB1/BC/9/98

Tel : 2509 4189

Date : 8 March 1999

From : Clerk to Bills Committee

To : Hon Fred LI Wah-ming (Chairman)  
Dr Hon Raymond HO Chung-tai, JP  
Hon Ronald ARCULLI, JP  
Hon CHAN Kam-lam  
Hon SIN Chung-kai

---

**Bills Committee on  
Electricity (Amendment) Bill 1999**

At the Bills Committee Meeting held on 12 February 1999 members requested the Administration to provide for members' reference sample plans which could be made available by the two power companies to contractors or other responsible parties for the works concerned. The sample plans provided by the two power companies are now attached for members' reference.

(Daniel HUI)  
for Clerk to Bills Committee

Encl.

c.c. ASG1  
H(RL) – with three copies  
ALA2

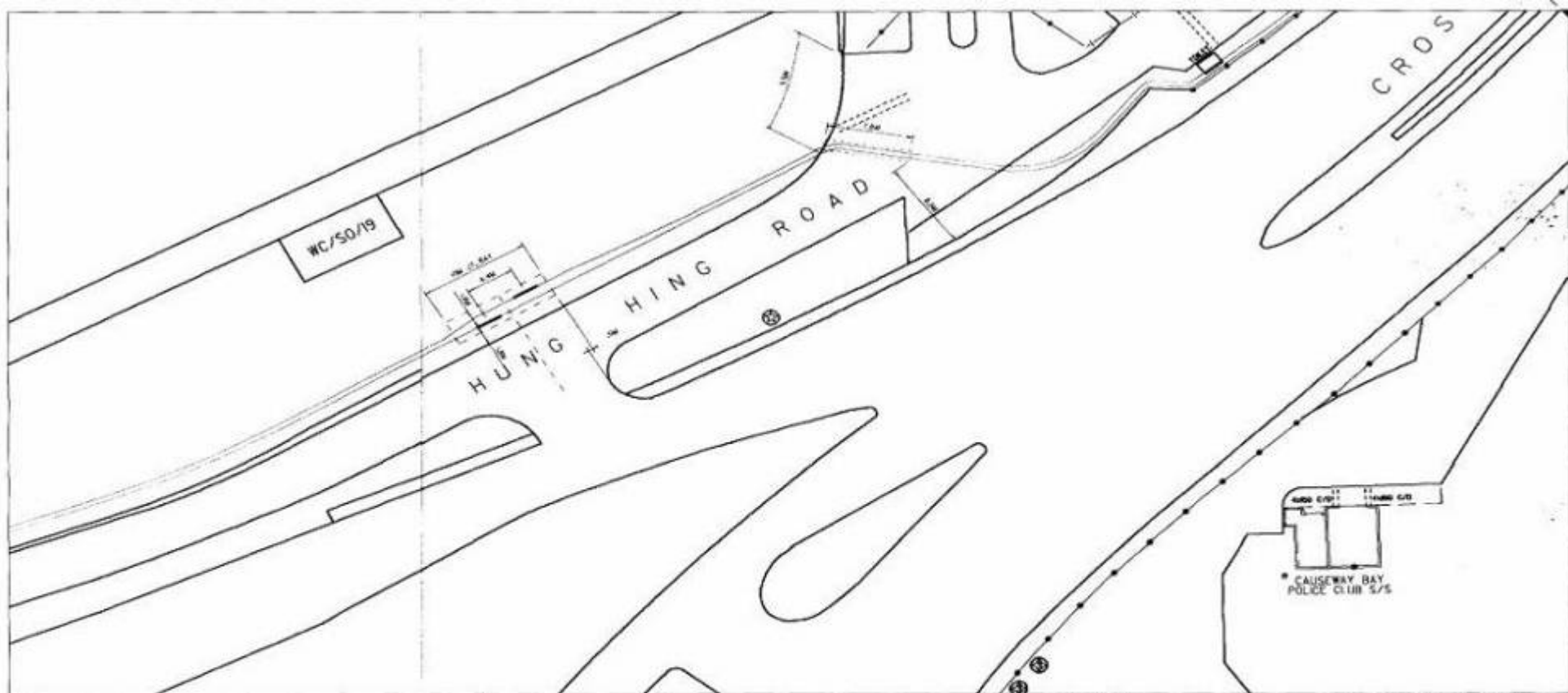

Notes :

1. THE POSITION OF HEC CABLES AND D/H LINES ON THE PLAN ARE APPROXIMATE ONLY AND THE HATCHED AREAS WITH REFERENCE "SD" INDICATE AREAS MORE PRONE TO SHALLOW COVER. AS THESE CABLES ARE EMERGED, EXTREME CARE MUST BE EXERCISED WHEN EXCAVATION OR ANY KIND OF CONSTRUCTION WORKS ARE MADE IN PROXIMITY TO OUR CABLES.
2. HV JOINTS ARE MARKED WITH ⊗ OR ⊙ ON THE PLAN. FOR THE SAKE OF SAFETY, WHEN YOUR EXCAVATION OR ANY KIND OF CONSTRUCTION WORK IS UNDERTAKEN IN CLOSE PROXIMITY TO SUCH JOINTS, YOU MUST INFORM HEC AT TELEPHONE 28143443 TO ARRANGE INSPECTION AND NECESSARY ACTION BEFORE COMMENCING SUCH WORKS.
3. FOR EXCAVATION OR ANY KIND OF CONSTRUCTION WORK THAT IS UNDERTAKEN IN CLOSE PROXIMITY TO OUR 275KV/132/66KV CABLES OR JOINTS OR 132KV D/H LINES, YOU ARE REQUIRED TO CONTACT THE RESPONSIBLE ENGINEER IN OUR CONSTRUCTION & MAINTENANCE DEPARTMENT, F & C DIVISION BEFORE COMMENCING SUCH WORKS.
4. CONFIDENTIAL - EXCEPT FOR YOUR AUTHORIZED CONTRACTORS/EMPLOYERS, THIS DRAWING MUST NOT BE RELEASED TO THIRD PARTY WITHOUT HEC'S WRITTEN APPROVAL.

備註 1

1. 此圖所示之電纜及電力線之位置僅供參考，且圖中標有「SD」之斜線區域，表示該處電纜埋藏較淺，在進行挖掘或任何建築工程時，必須格外小心，以免損壞電纜。
2. 圖中標有 ⊗ 或 ⊙ 之符號，表示電力接頭。為安全起見，若您的挖掘或任何建築工程在該等接頭附近進行，必須先通知 HEC 電話 28143443 安排檢查及必要之行動，方可開始工程。
3. 若您的挖掘或任何建築工程在 275KV/132/66KV 電纜或電力線或 132KV 電力線附近進行，必須先與我們之工程及維修部工程師聯絡，方可開始工程。
4. 此圖之內容屬機密，除獲本公司之書面許可外，不得向任何第三者披露。

Legend :

	275KV CABLE ROUTE	275 千伏電纜路線
	132KV D/H LINE ROUTE	132 千伏電力線路線
	132KV CABLE ROUTE	132 千伏電纜路線
	66KV CABLE ROUTE	66 千伏電纜路線
	HV CABLE ROUTE	1 萬伏電纜路線
	TEL./PILOT CABLE ROUTE	1 萬伏電纜路線
	LV CABLE ROUTE	1 萬伏電纜路線
	S/L CABLE ROUTE	1 萬伏電纜路線
	LV D/H LINE ROUTE	1 萬伏電力線路線

THE PART PLAN SHOWING THE ABOVE MENTIONED CABLE ROUTE IS IN SCALE 1:500  
此部分圖則顯示上述電纜路線之比例尺為 1:500

Ref. No. : _____	
Date : 26/02/1999	
THE HONGKONG ELECTRIC CO. LTD. 香港電燈有限公司 DP & IT Drawing Office	

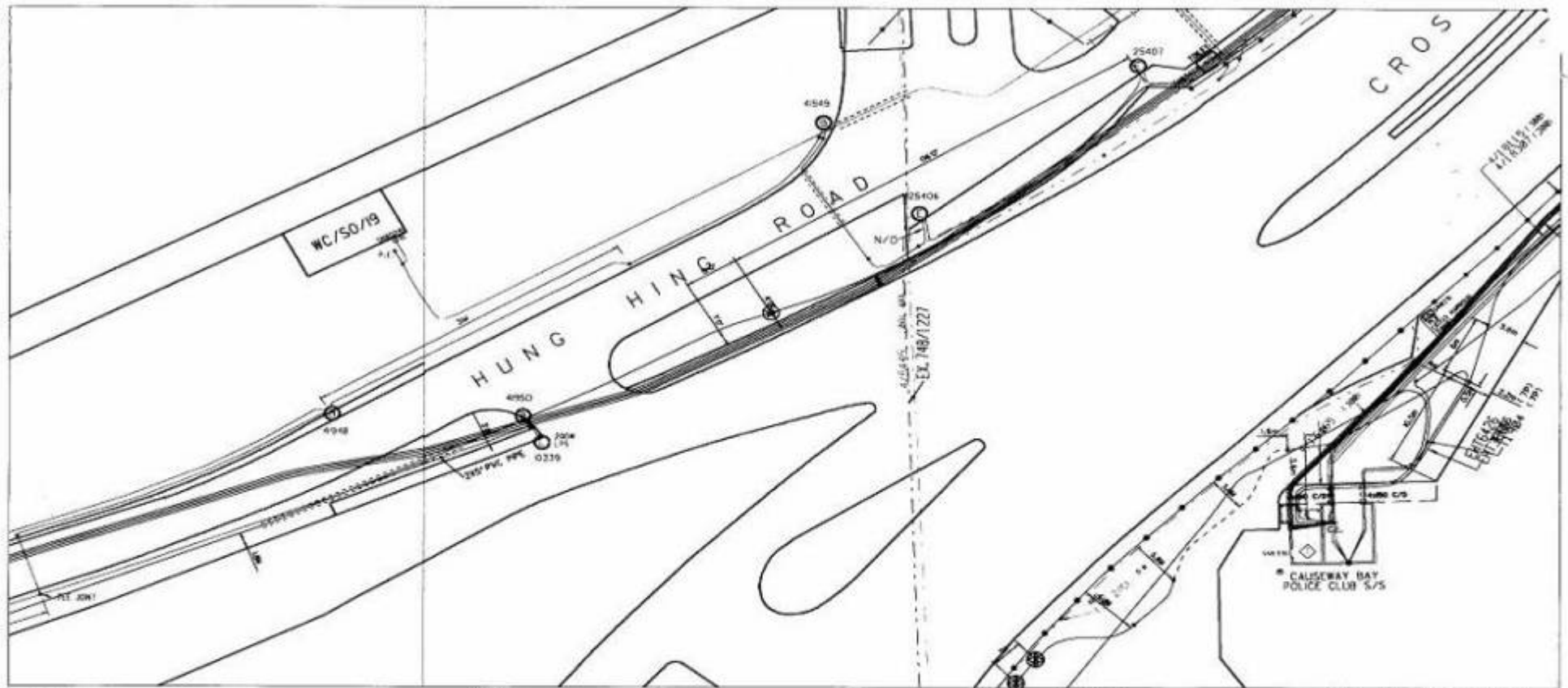

Notes :

1. THE POSITION OF HVC CABLES AND D/H LINES ON THE PLAN ARE APPROXIMATE ONLY AND THE HATCHED AREAS WITH REFERENCE 'SC' INDICATE AREAS MORE PRONE TO SWALLOW COVER AS THESE CABLES ARE ENERGISED. EXTREME CARE MUST BE EXERCISED WHEN EXCAVATION OR ANY KIND OF CONSTRUCTION WORKS ARE MADE IN PROXIMITY TO OUR CABLES.
2. HV JOINTS ARE MARKED WITH ⊕ OR ⊗ ON THE PLAN FOR THE SAKE OF SAFETY. WHEN YOUR EXCAVATION OR ANY KIND OF CONSTRUCTION WORK IS UNDERTAKEN IN CLOSE PROXIMITY TO SUCH JOINTS YOU MUST INFORM HEC AT TELEPHONE 28143443 TO ARRANGE INSPECTION AND NECESSARY ACTION BEFORE COMMENCING SUCH WORKS.
3. FOR EXCAVATION OR ANY KIND OF CONSTRUCTION WORK THAT IS UNDERTAKEN IN CLOSE PROXIMITY TO OUR 275/132/66KV CABLES OR JOINTS OR 132KV D/H LINES YOU ARE REQUESTED TO CONTACT THE RESPONSIBLE ENGINEER IN OUR CONSTRUCTION & MAINTENANCE DEPARTMENT, T & O DIVISION BEFORE COMMENCING SUCH WORKS.
4. CONFIDENTIAL : EXCEPT FOR YOUR AUTHORIZED CONTRACTORS/EMPLOYERS, THIS DRAWING MUST NOT BE RELEASED TO THIRD PARTY WITHOUT HEC'S WRITTEN APPROVAL.

備註 :

1. 此圖只顯示本公司之電力設施，包括 275KV、132KV、66KV 及 132KV D/H 線路之位置。由於這些電纜在運作時，其上方之泥土容易鬆動，故在這些電纜附近之區域，其土質較脆弱。在進行任何挖掘或建造工程時，必須特別小心，以免損壞電纜。
2. 圖中標有 ⊕ 或 ⊗ 之符號，表示高壓接頭之位置。為安全起見，若您的挖掘或建造工程與這些接頭之距離很近，請先通知本公司，以便派員到場檢查及採取必要之措施。
3. 若您的挖掘或建造工程與本公司之 275/132/66KV 電纜或接頭，或 132KV D/H 線路之距離很近，請先與本公司之工程及維修部之負責工程師聯絡，在開始工程前，必須先獲得該工程師之批准。
4. 此圖僅供本公司之合約商/僱主參考，未經本公司書面同意，不得向任何第三方洩露。

Legend :

—●—	CABLE POT-END	電纜井頭
—	275KV CABLE ROUTE	(275 千伏電纜線路)
—	132KV D/H LINE ROUTE	(132 千伏電纜線路)
—	132KV CABLE ROUTE	(132 千伏電纜線路)
—	66KV CABLE ROUTE	(66 千伏電纜線路)
—	HV CABLE ROUTE	(高壓電纜線路)
—	TEL./PILOT CABLE ROUTE	(電話電纜線路)
—	LV CABLE ROUTE	(低壓電纜線路)
—	S/A CABLE ROUTE	(新設電纜線路)
—	LV D/H LINE ROUTE	(低壓電纜線路)

THE PART PLAN SHOWING THE ABOVE MENTIONED CABLE ROUTE IS IN SCALE 1:500  
此圖之比例尺為 1:500

Ref. No. : \_\_\_\_\_  
Date : 26/02/1999

THE HONGKONG ELECTRIC CO. LTD.  
香港電燈有限公司  
DIP & ET  
Drawing Office

# PAK KOK KAU TSUEN



- Notes :**
- THE POSITION OF HEC CABLES AND O&H LINES ON THE PLAN ARE APPROXIMATE ONLY AND THE HATCHED AREAS WITH REFERENCE "SY" INDICATE AREAS MORE PRONE TO SHALLOW COVER, AS THESE CABLES ARE ENERGISED, EXTREME CARE MUST BE EXERCISED WHEN EXCAVATION OR ANY KIND OF CONSTRUCTION WORKS ARE MADE IN PROXIMITY TO OUR CABLES.
  - HV JOINTS ARE MARKED WITH Ⓟ OR Ⓢ ON THE PLAN FOR THE SAKE OF SAFETY, WHEN YOUR EXCAVATION OR ANY KIND OF CONSTRUCTION WORK IS UNDERTAKEN IN CLOSE PROXIMITY TO SUCH JOINTS, YOU MUST INFORM HEC AT TELEPHONE 2814443 TO ARRANGE INSPECTION AND NECESSARY ACTION BEFORE COMMENCING SUCH WORKS.
  - FOR EXCAVATION OR ANY KIND OF CONSTRUCTION WORK THAT IS UNDERTAKEN IN CLOSE PROXIMITY TO OUR 275/132/66KV CABLES OR JOINTS OR 132KV O&H LINES, YOU ARE REQUIRED TO CONTACT THE RESPONSIBLE ENGINEER BY OUR CONSTRUCTION & MAINTENANCE DEPARTMENT, T & O DIVISION BEFORE COMMENCING SUCH WORKS.
  - CONFIDENTIAL: EXCEPT FOR YOUR AUTHORIZED CONTRACTORS/EMPLOYERS, THIS DRAWING MUST NOT BE RELEASED TO THIRD PARTY WITHOUT HEC'S WRITTEN APPROVAL.

- 備註：**
- 此有蛇在  
尺C'場近  
2814 3443
  - 圖中  
2814 3443
  - 在附近  
圖中
  - 保習一

**Legend :**

Symbol	Description	中文描述
—●—	CABLE PGT-END	電纜終端
—●—	275KV CABLE ROUTE	(275 千伏電纜路線)
—●—	132KV O/H LINE ROUTE	(132 千伏電纜路線)
—●—	132KV CABLE ROUTE	(132 千伏電纜路線)
—●—	66KV CABLE ROUTE	(66 千伏電纜路線)
—●—	HN CABLE ROUTE	(高壓電纜路線)
—●—	TEL./PILOT CABLE ROUTE	(電話電纜路線)
—●—	LV CABLE ROUTE	(低壓電纜路線)
—●—	S/L CABLE ROUTE	(新裝電纜路線)
—●—	LY O/H LINE ROUTE	(超超等電纜路線)

THE PART PLAN SHOWING THE ABOVE MENTIONED CABLE ROUTE IS IN SCALE 1:200

以上電纜/超超等電纜路線圖之比例為 1:200

Ref. No.: \_\_\_\_\_  
 Date: 26/02/1999

THE HONGKONG ELECTRIC CO., LTD.  
 香港電燈有限公司  
 DP & IT  
 Drawing Office