

立法會
Legislative Council

LC Paper No. PWSC60/03-04

Ref : CB1/F/2/5

Tel : 2525 3331

Date : 15 April 2004

From : Clerk to the Public Works Subcommittee

To : Members of the Public Works Subcommittee

Public Works Subcommittee

**Supplementary information on
259ES - Second secondary school in Area 104, Tin Shui Wai and
322EP - Second primary school in Area 104, Tin Shui Wai**

At the Public Works Subcommittee (PWSC) meeting on 3 March 2004, when members considered paper PWSC(2003-04)70 on the above item, members enquired whether it was feasible to provide 100m-running tracks in the school site to better facilitate physical training of students. The information is now attached.

2. The recommendation of PWSC on the item will be considered by the Finance Committee at its meeting on 30 April 2004.

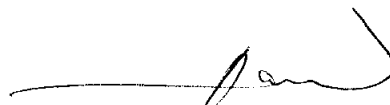

(Ms Anita SIT)

Clerk to the Public Works Subcommittee

Encl.

c.c. Other members of the Finance Committee



教育署
Education Department

本署檔號 Our ref: (17) in EMB(SB) L/M No. 42/SB/2004
來函檔號 Your ref:
電話 Tel. No.: 2892 6665
圖文傳真 Fax No.: 2573 3467

Infrastructure & Research
Support Division
Rm. 1431A, 14/F
Wu Chung House
213 Queen's Road East
Wan Chai, Hong Kong

13 April 2004

Ms. Anita SIT
Clerk to Public Works Subcommittee
Legislative Council Secretariat
Legislative Council Building
8 Jackson Road
Central, Hong Kong

Dear Ms. SIT,

Public Works Subcommittee
Follow-up to meeting on 3 March 2004

In considering the paper referenced PWSC(2003-04)70 for the construction of one secondary school and one primary school under **259ES** and **322EP** respectively, Members enquired whether it was feasible to provide 100m-running tracks in the school site to better facilitate physical training of students.

To provide space for extending the tracks to cover a full length of 100 metres, the Director of Architectural Services has revisited the design of the projects and plans to make some slight changes. The Director of Architectural Services' proposed changes would have insignificant cost and time implications for the two school projects. A revised site plan is attached herewith for reference.

We have discussed the above proposal with the school sponsoring body (SSB) of **322EP** (as **259ES** has not yet been allocated). The SSB has agreed to the proposed extension.

教育統籌局與教育署已於二零零三年一月一日合併為新的教育統籌局。為免浪費，我們繼續使用舊文具存貨。

We are the new Education and Manpower Bureau formed by the merger of the old Bureau and the Education Department. To minimize waste, we are using our old stationery while stock lasts.

 服務市民
SERVING THE COMMUNITY

I should be most grateful if you could inform Members of our above response.

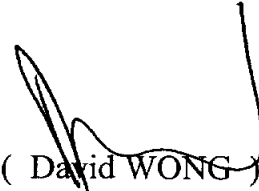

(David WONG)
for Secretary for Education and Manpower

c.c.

D Arch S (Attn: Mr. C H YUE)

Fax 2801 4711



位置圖 LOCATION PLAN

SCALE 1 : 5000

擬建公共屋邨
PROPOSED PUBLIC HOUSING ESTATE

INSULATED WINDOWS AND AIR-CONDITIONING FOR 6 SPECIAL ROOMS FROM THE 2/F TO 7/F AND 3 SMALL GROUP TEACHING ROOMS FROM THE 5/F TO 7/F AT THE WESTERN FACADE OF THE SPECIAL ROOM BLOCK
在特別室大樓向西一面2樓至7樓的6間特別室及5樓至7樓的3間小組教學室裝置隔音窗及空調

CONSTRUCTION OF 3-METRE HIGH BOUNDARY WALL AT THE NORTHERN SIDE OF THE SITE
在校址北面建造三米高的圍牆

INSULATED WINDOWS AND AIR-CONDITIONING FOR 12 CLASSROOMS FROM THE 1/F TO 6/F AT THE EASTERN FACADE OF THE CLASSROOM BLOCK
在課室大樓向東一面1樓至6樓的12間課室裝置隔音窗及空調

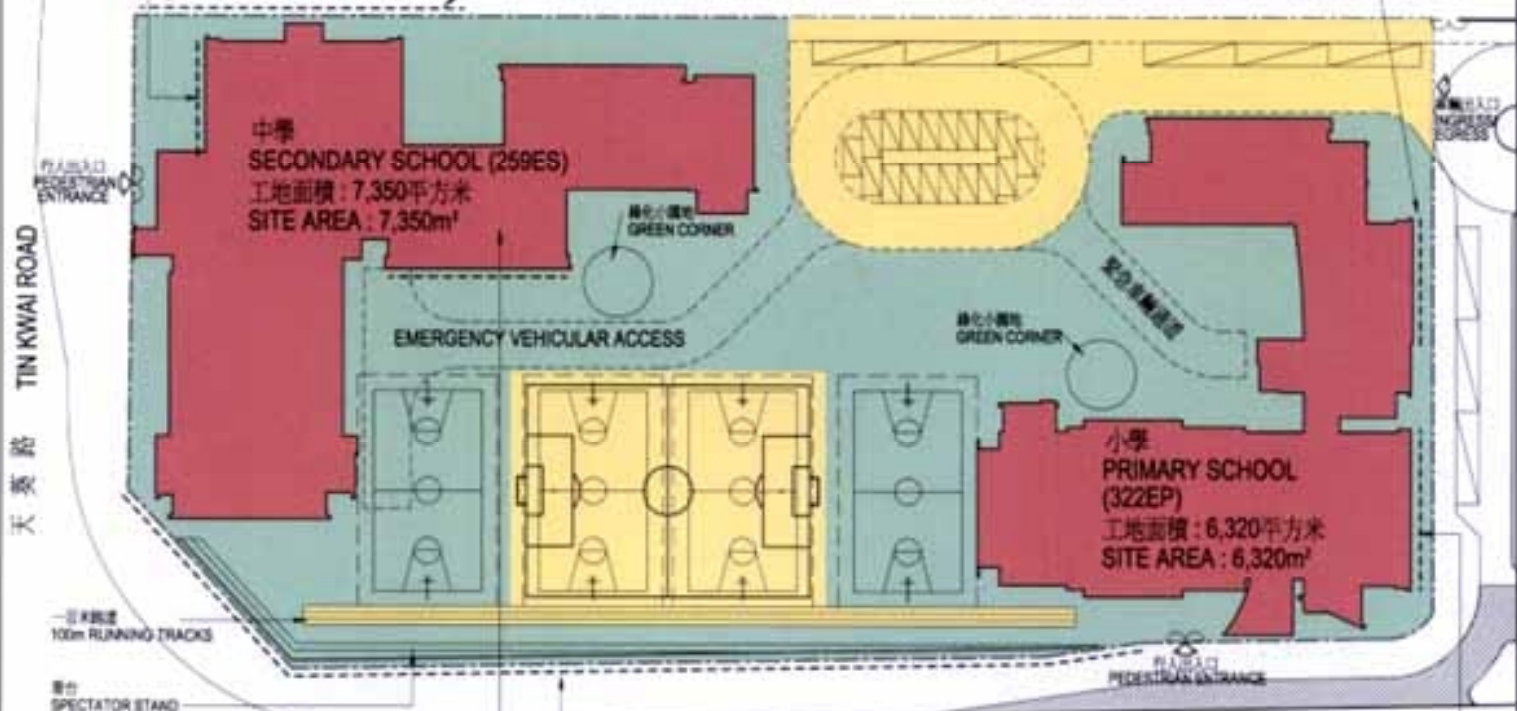

中學
SECONDARY SCHOOL (259ES)
工地面積：7,350平方米
SITE AREA : 7,350m²

小學
PRIMARY SCHOOL (322EP)
工地面積：6,320平方米
SITE AREA : 6,320m²

INSULATED WINDOWS AND AIR-CONDITIONING FOR 12 CLASSROOMS FROM THE 2/F TO 5/F AT THE SOUTHERN FACADE OF THE CLASSROOM BLOCK
在課室大樓向南一面2樓至5樓的12間課室裝置隔音窗及空調

CONSTRUCTION OF A 3-METRE HIGH BOUNDARY WALL AT THE SOUTHERN SIDE OF THE SITE
在校址南面建造三米高的圍牆

INSULATED WINDOWS AND AIR-CONDITIONING FOR 4 SPECIAL ROOMS ON THE 3/F, 4/F AND 6/F AT THE EASTERN FACADE OF THE SPECIAL ROOM BLOCK
在特別室大樓向東一面3樓、4樓及6樓的4間特別室裝置隔音窗及空調

美湖居
MAY WOOD COURT

title 259ES AND 322EP
天水圍第104區的
第2所中學和第2所小學
SECOND SECONDARY SCHOOL AND
SECOND PRIMARY SCHOOL
IN AREA 104, TIN SHUI WAI

drawn by
林恩哲 LAM YAN CHIT
approved
黎紹堅 REMBERT S.K. LAI
office
ARCHITECTURAL BRANCH

date
18.01.04
date
18.01.04

drawing no.
AB/6482/NM-01
scale
1 : 1000



ARCHITECTURAL
SERVICES
DEPARTMENT