

CB(1)2236/05-06(03)

Preserving Star Ferry and Queens Piers

The Conservancy Association



圖4.2
Figure 4.2

主要路段及路口的位置
Locations of Major Road Sections and Junctions

Reasons for demolition of Star Ferry and Queen's Pier

- P2 road
- Airport Railway Extended Overrun Tunnel (EOT)
- An extension of drainage box culvert

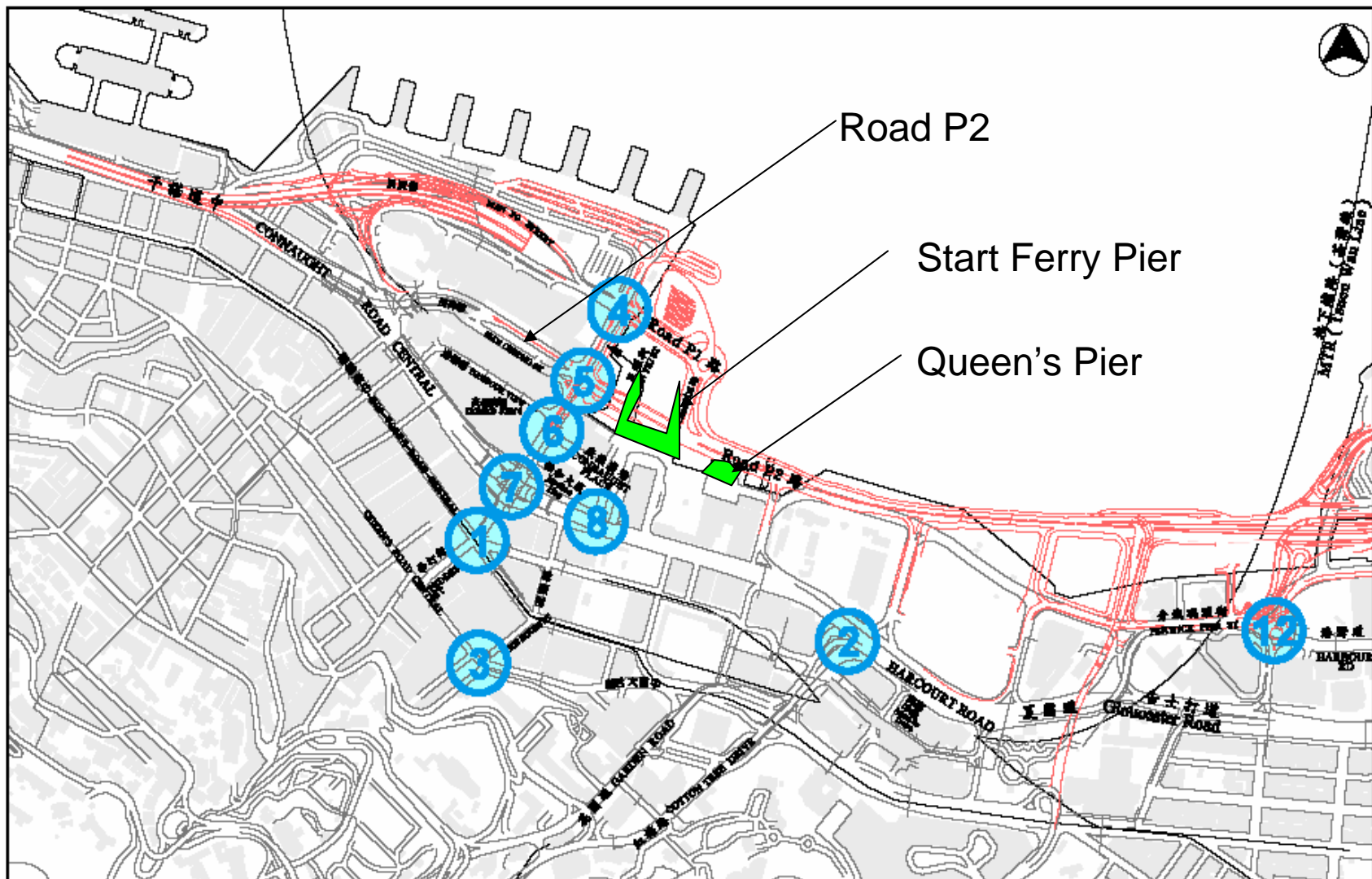
Government Proposal

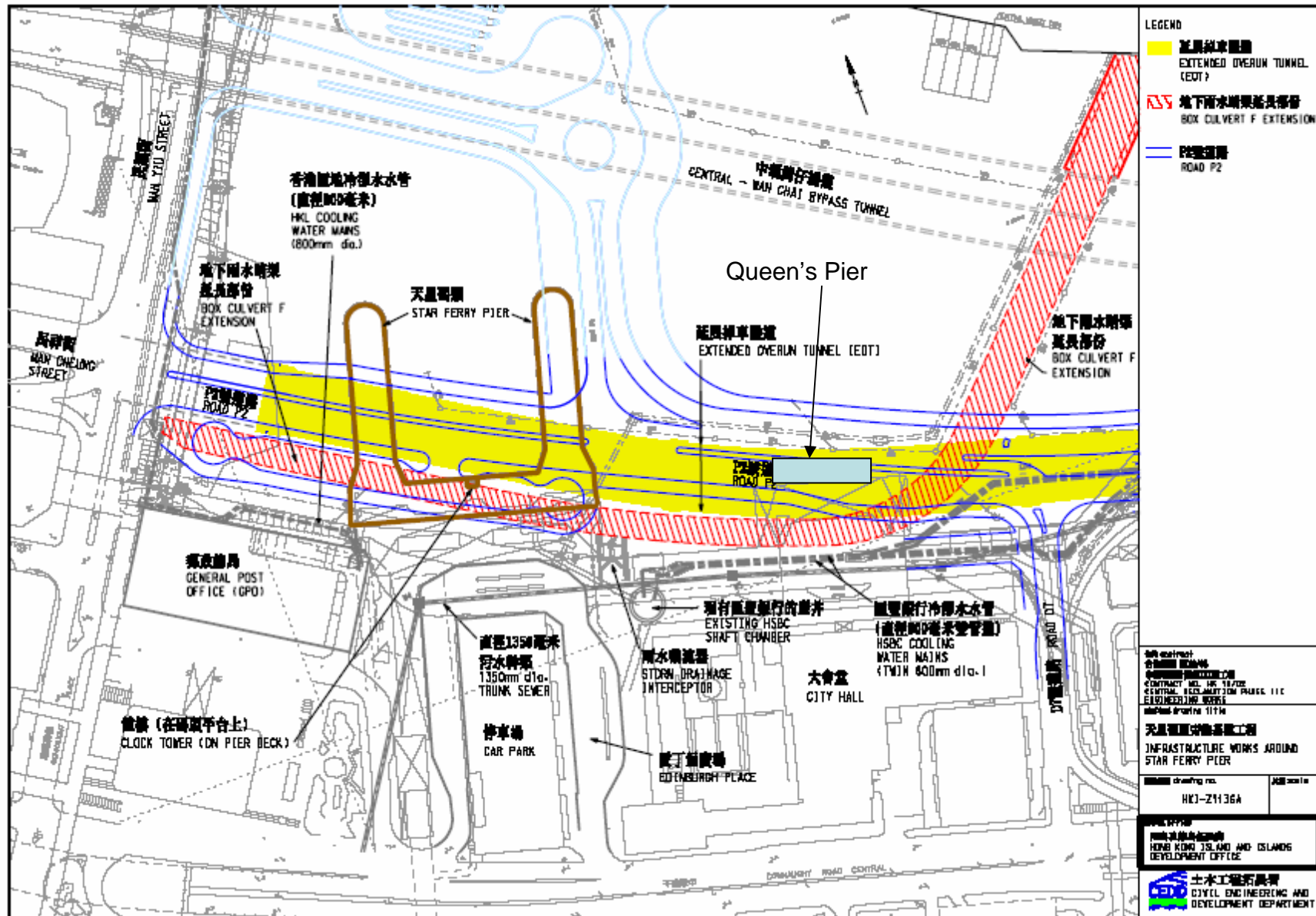

Our Proposal

- Demolish the finger piers of the piers;
- Retain the main building and canopy of start ferry pier and queen's pier

Thus, forming a historical corridor linking the waterfront – vital to heritage conservation, trace of our shore line, collective memory and tourist attraction

Impacts

- Fine tuning of the alignment of P2, and underground drainage box culvert to the north
- AR overturn should be unaffected as it is at least 10m underground.

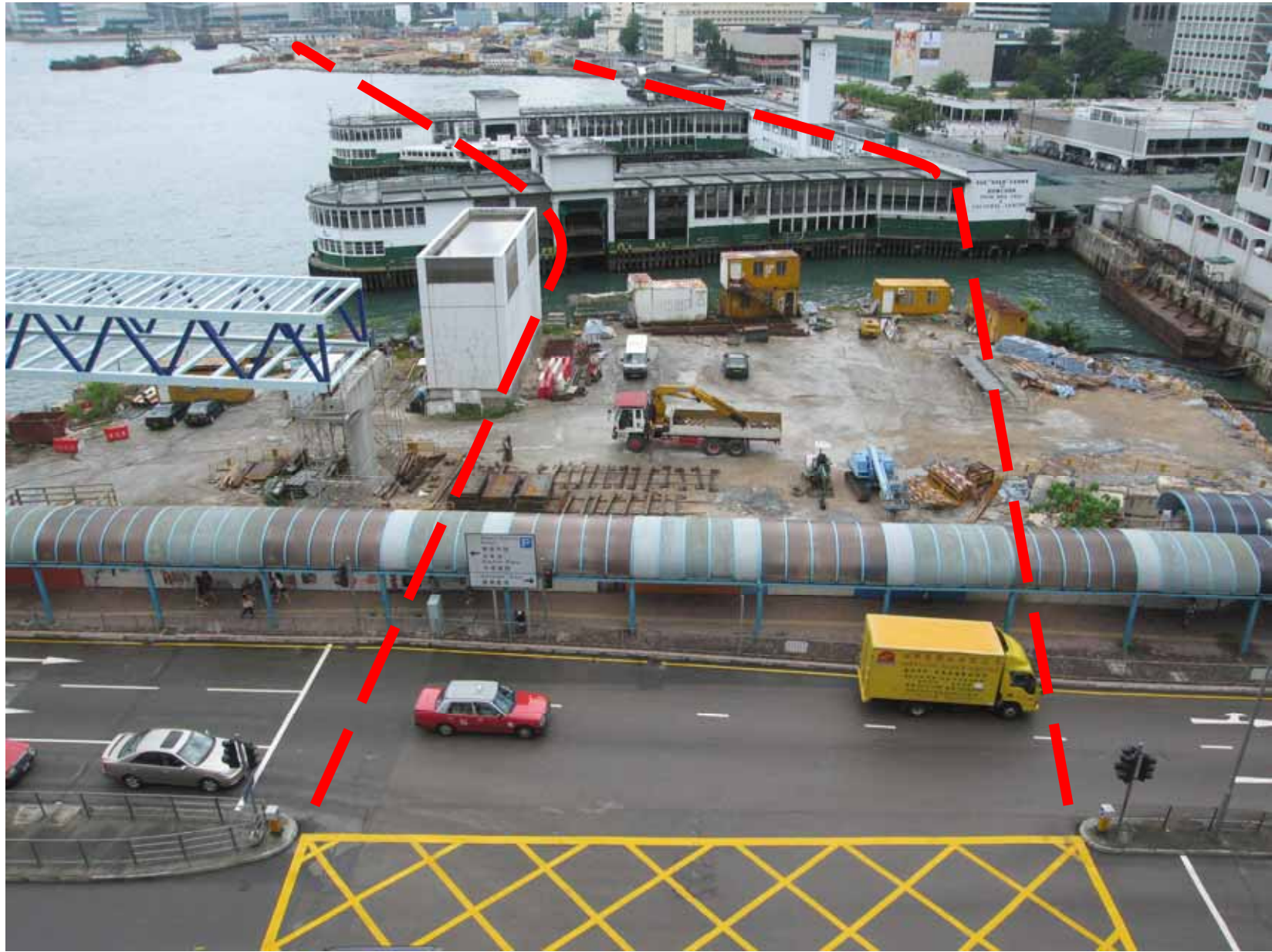

Proposed alignment for P2 Road

It may have impact on the proposed CDA but should not be un-surmountable

