



南港島綫(東段)  
立法會鐵路事宜小組委員會會議

South Island Line (East)  
Subcommittee on Matters Relating to Railways

2009年9月17日  
17 September 2009

# 南港島線(東段)的進度報告

## SIL (E) Progress Update

1. 政府於二零零九年七月二十四日及三十一日將南港島線(東段)鐵路方案刊登憲報  
The railway scheme was gazetted on 24 & 31 July 2009
2. 港鐵公司已展開詳細設計  
The detailed design of the SIL(E) has commenced
3. 港鐵公司展開土地勘察  
The detailed design ground investigation works has commenced
4. 政府及港鐵公司繼續與居民及地區人士保持密切聯繫  
Continue to discuss the concerns of the residents and related organizations

# 南港島綫 (東段)走綫 Alignment of South Island Line ( East )



# 金鐘站擴建部分 Admiralty Station Extension

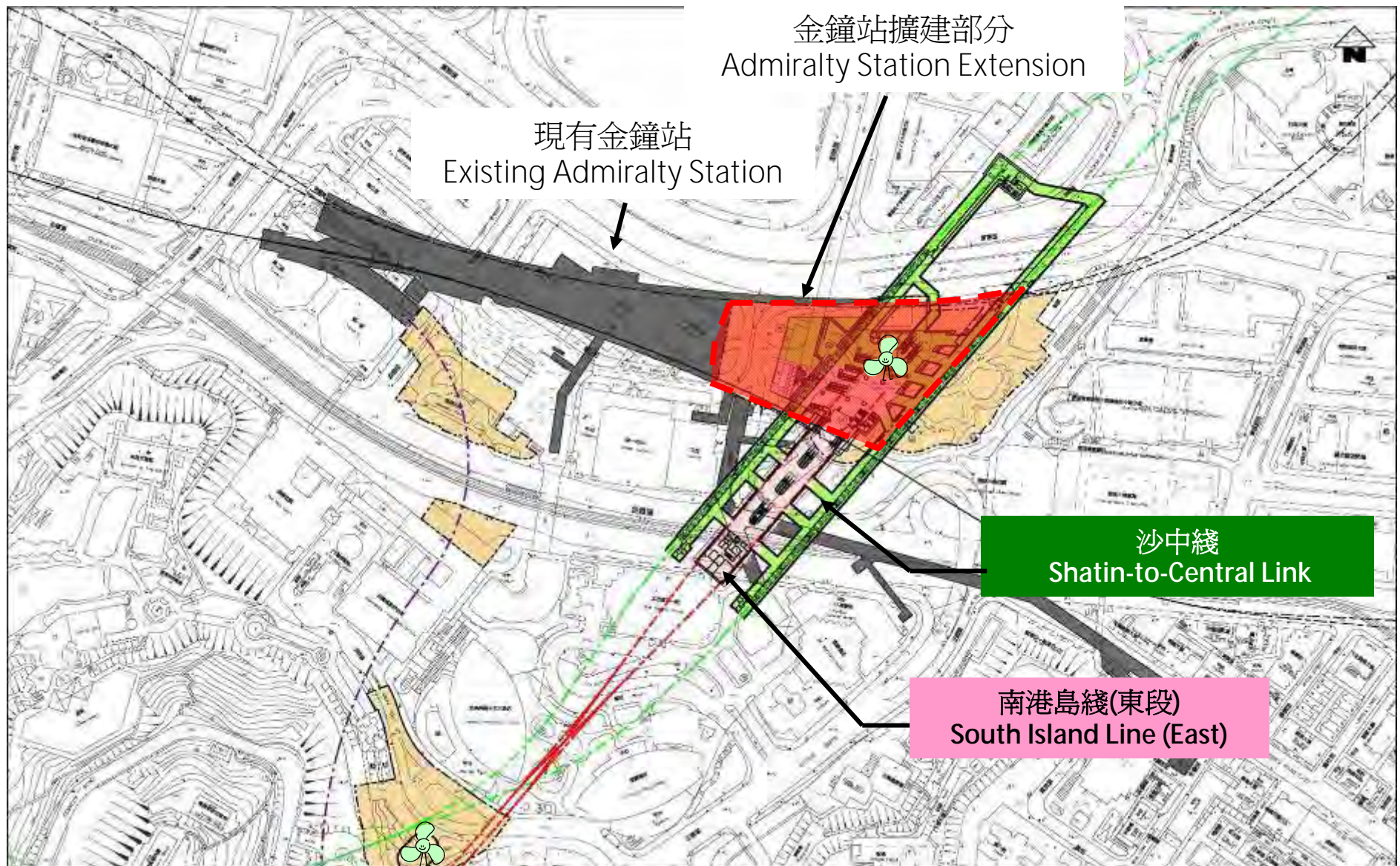

# 切面圖（金鐘站擴建部分） Section (Admiralty Station Extension)

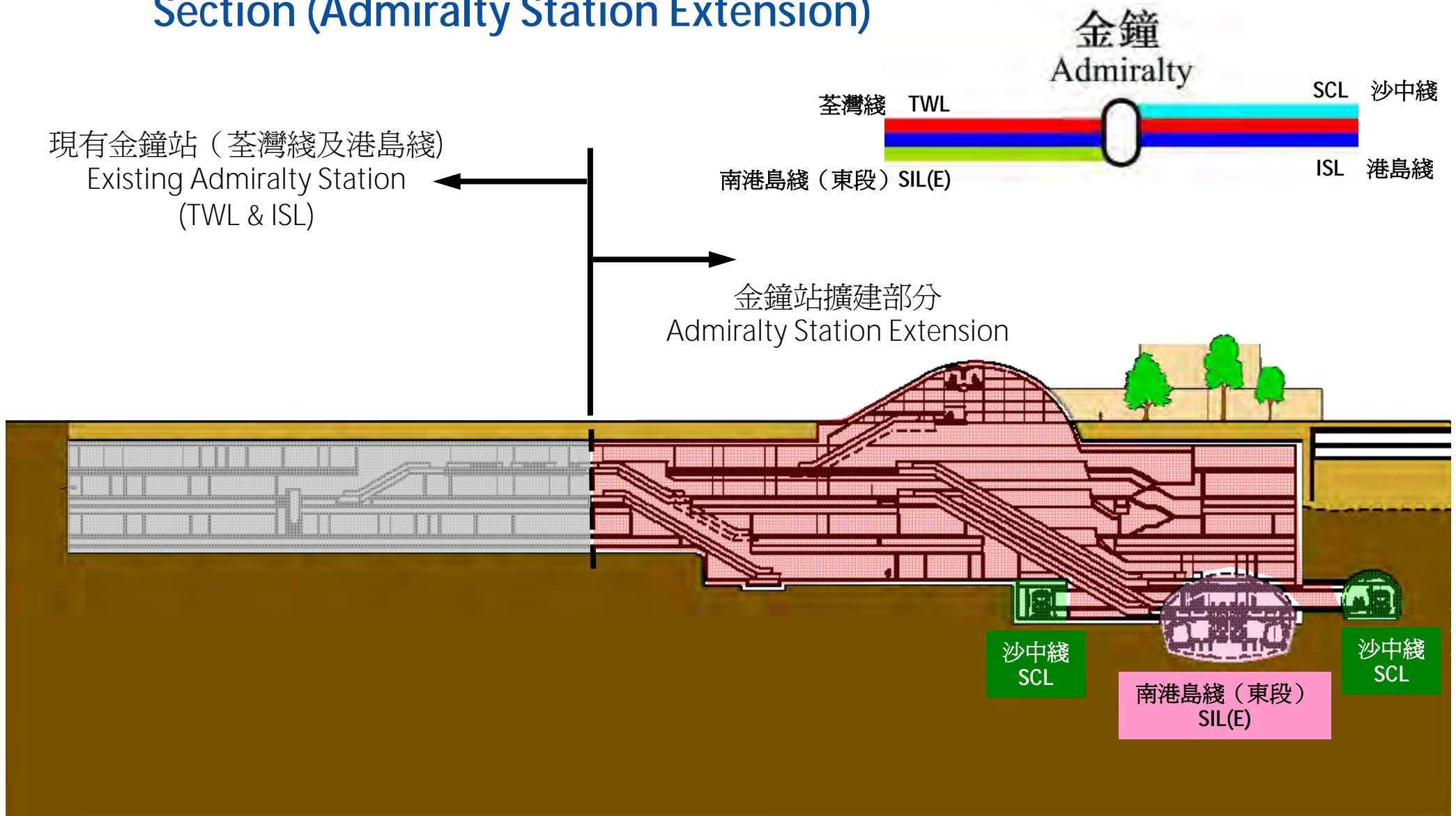

# 隧道 - 金鐘至南風段

## Tunnel between Admiralty and Nam Fung Section

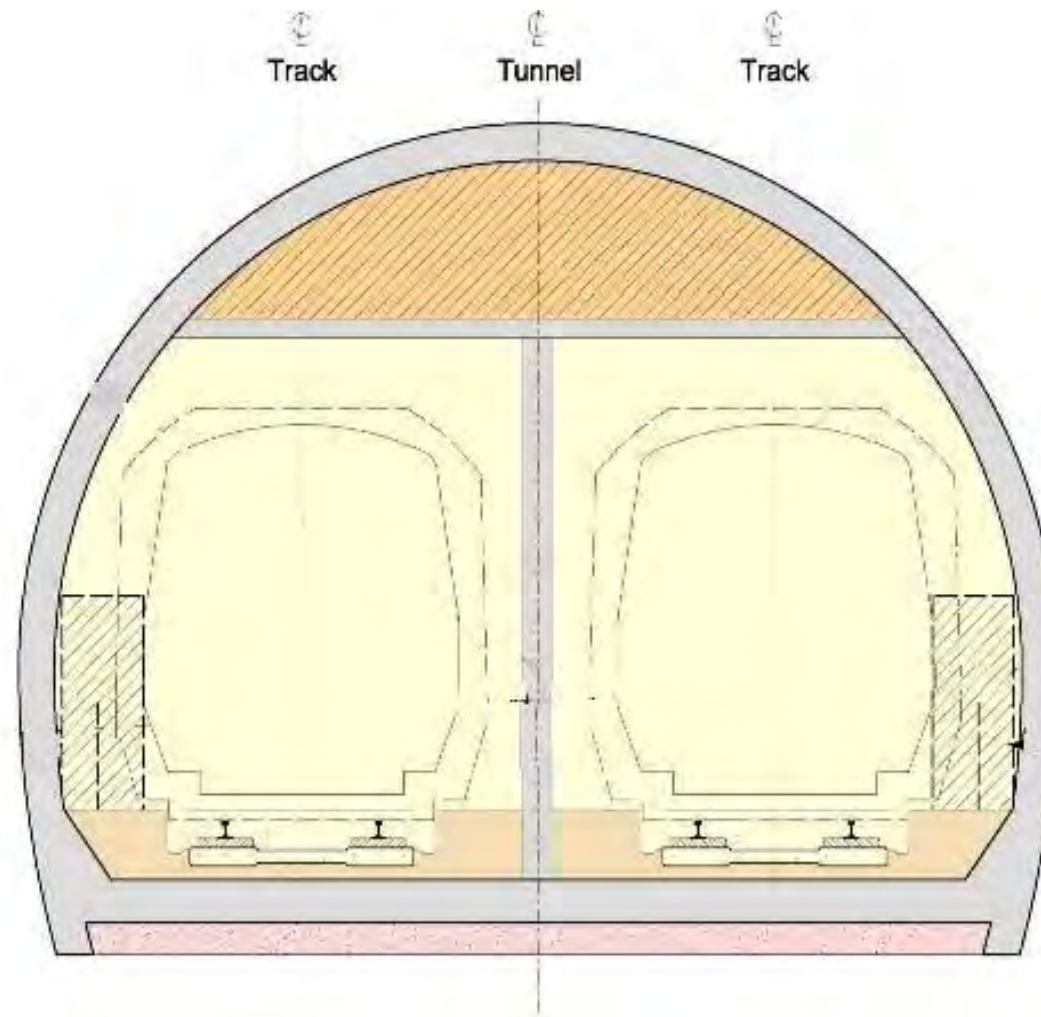

# 南風段 Nam Fung Section



# 南風段 Nam Fung Section





# 海洋公園站 Ocean Park Station



# 黃竹坑站 Wong Chuk Hang Station

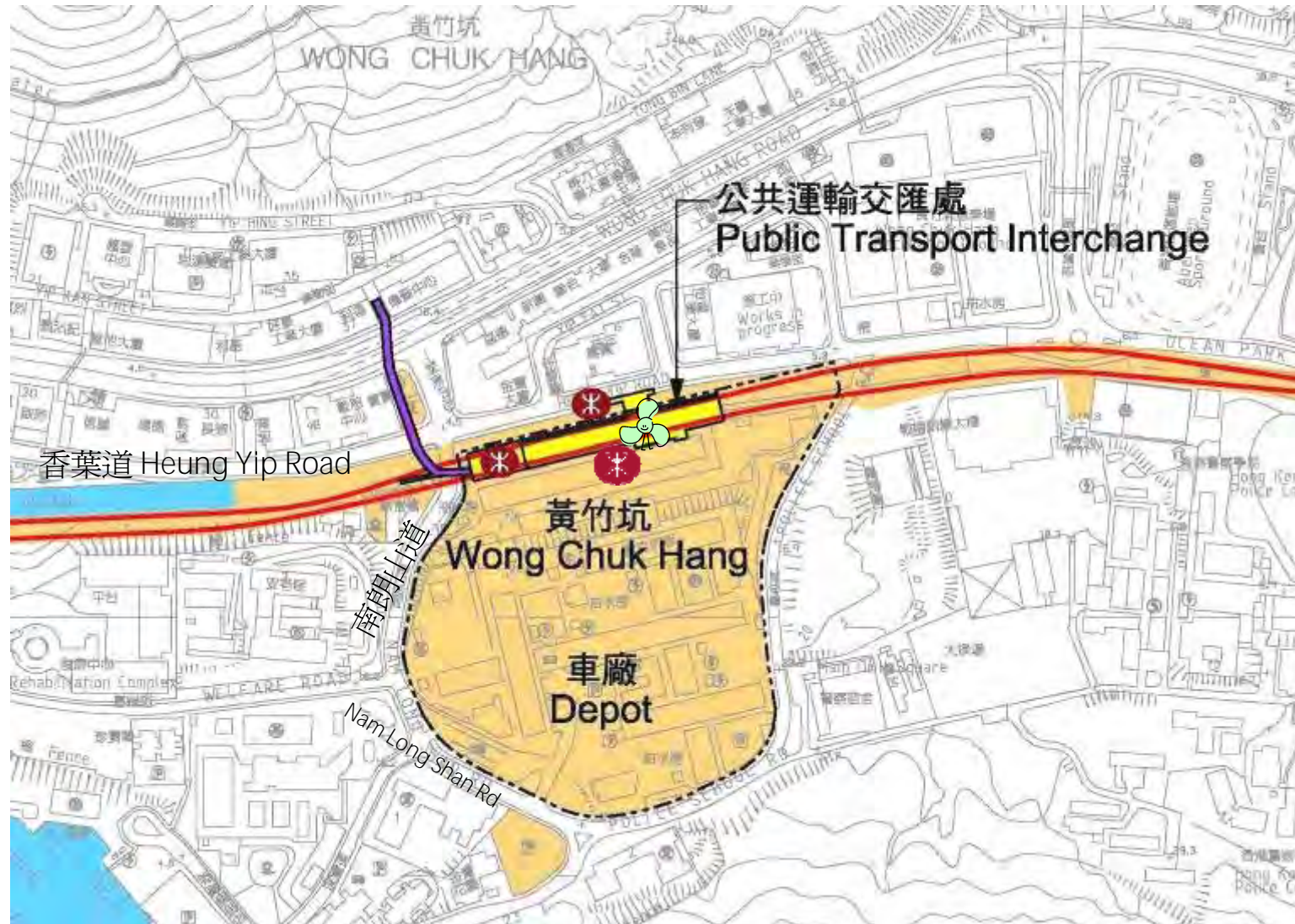

# 橫跨香港仔海峽 Aberdeen Channel Crossing

與現有鴨脷洲大橋融合的鐵路橋設計

Designing the bridge to blend with the existing Ap Lei Chau Bridge



# 利東段 Lei Tung Section

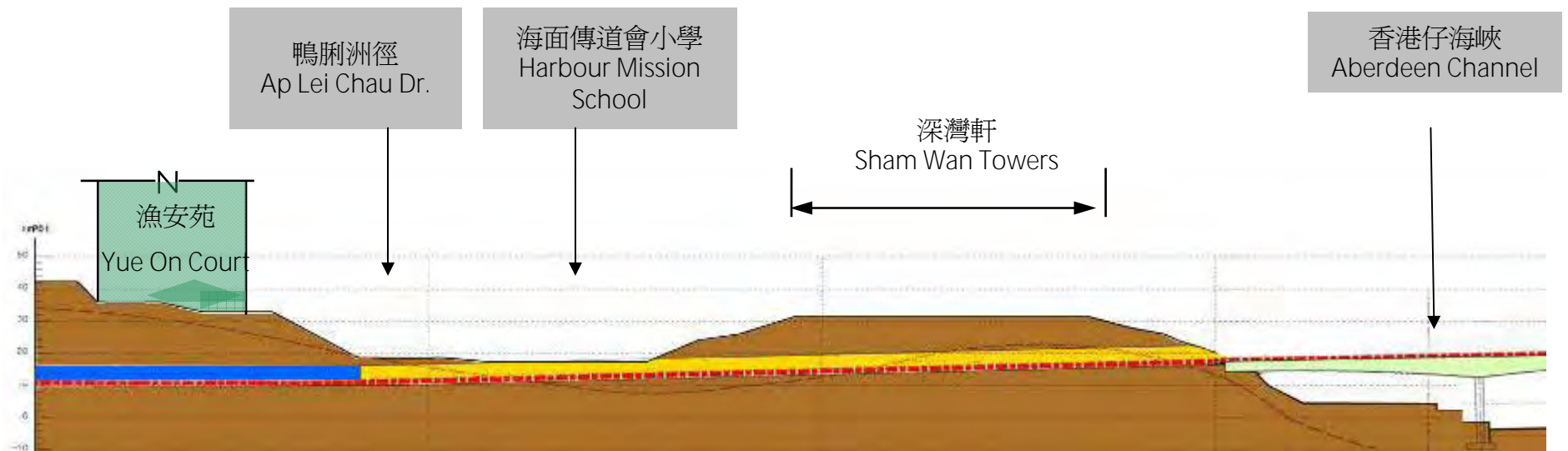

# 利東站 Lei Tung Station



# 海怡半島站 South Horizons Station



# 收回私人土地 Private Land Resumption

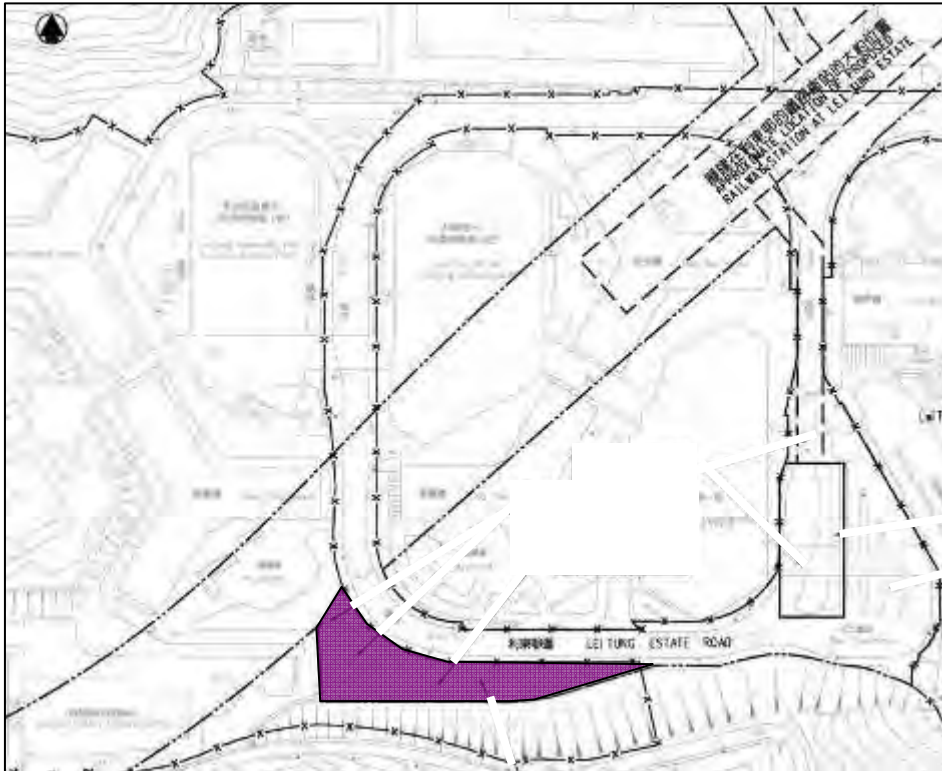

利東邨  
Lei Tung Estate

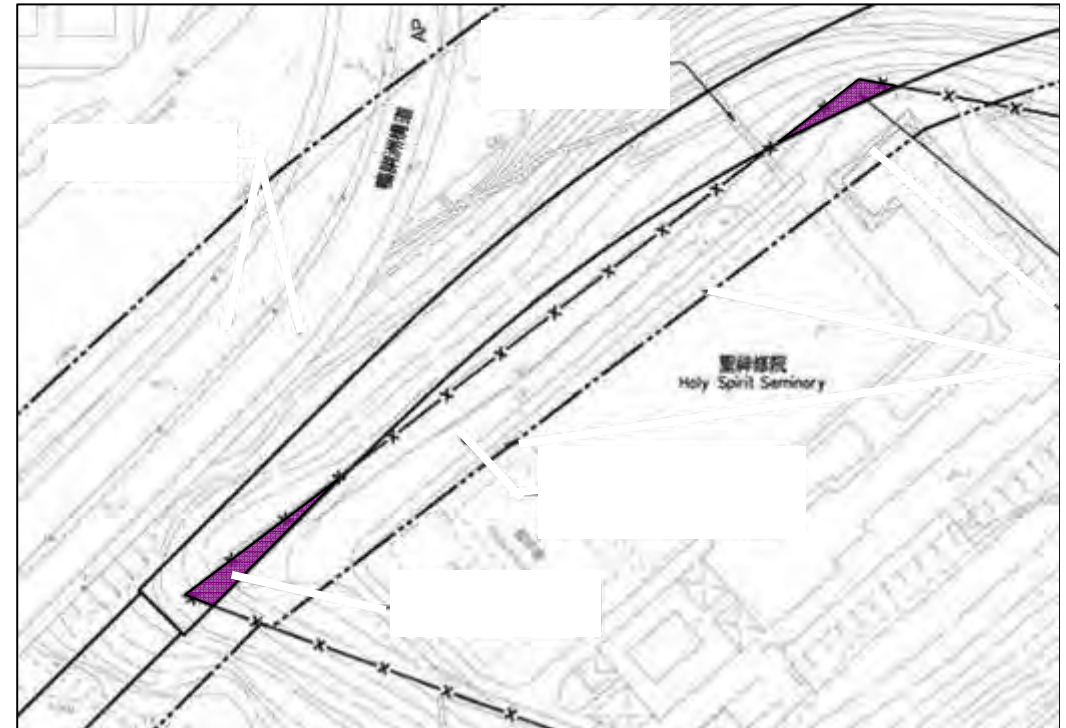

聖神修院  
Holy Spirit Seminary



# Proposed Temporary Barging Points

## 臨時拆建物料躉船轉運站



# 臨時拆建物料躉船轉運站的需求

## The Need for Barging Points for SIL(E)

建造工地 Construction Site	建造高峰期 Peak of Construction
黃竹坑及南風段 Wong Chuk Hang & Nam Fung	約 500車／每日 approx. 500 trucks per day
鴨脷洲 Ap Lei Chau	約 120車／每日 approx. 120 trucks per day [另每日280車次由運輸帶經建造隧道運走] [Spoils equivalent to 280 trucks per day will be disposed by conveyor belt through the construction adit]

### 原因 Reasons :

- 減少對交通負荷  
Minimizing the traffic impact on the local community
- 減少對環境影響  
Minimizing the impact on the environment

# 臨時拆建物料躉船轉運站(1) - 鴨脷洲利南道 Barging Point (1) – Lee Nam Road in Ap Lei Chau



臨時躉船轉運站 Temporary Barging Point

# 臨時拆建物料躉船轉運站(2)-奇力灣田灣海旁道 Barging Point (2) – Tin Wan Praya Road in Kellet Bay

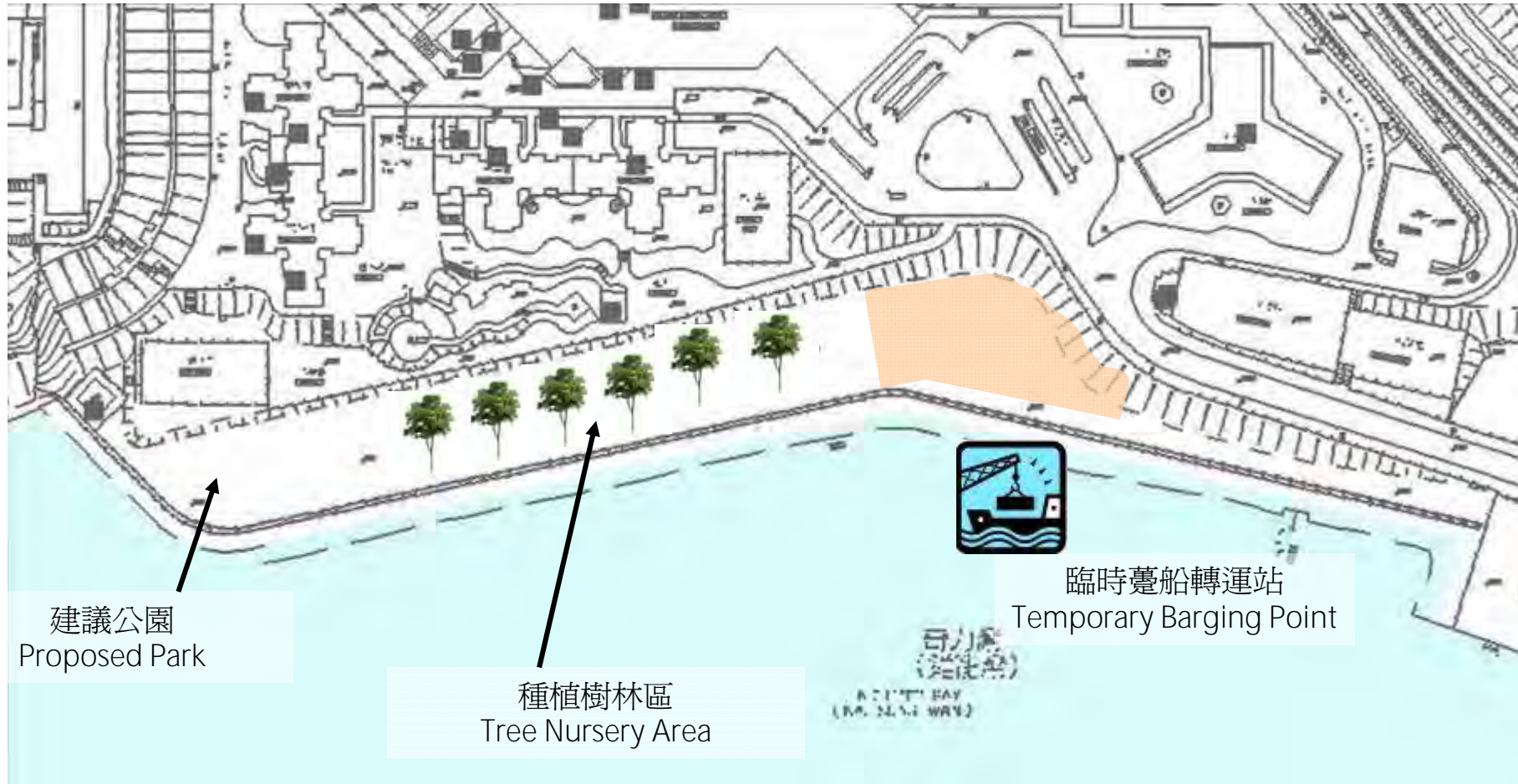

建議公園  
Proposed Park

種植樹林區  
Tree Nursery Area

臨時躉船轉運站  
Temporary Barging Point



# Proposed Magazine Site at Chung Hom Shan 春坎山臨時爆炸品倉庫

## 爲何需要臨時爆炸品倉庫？ The Need for Magazine Site

- 爲配合南港島綫（東段）工程，需要每天進行兩次爆破  
2 blasts everyday are needed to meet the programme of SIL(E)
- 按《危險品條例》規定，不能在晚上在海港範圍內進行水路運送炸藥  
According to Dangerous Goods Ordinance, marine delivery of explosives cannot be carried out at night within the harbour area
- 因法例的規限，以水路運送炸藥未能趕及早上的爆破工程  
Due to the limit, marine delivery of explosives cannot meet the schedule of blasting work in the morning
- 需要一個臨時爆炸品倉庫，於晚上儲存炸藥以進行早上的爆破工程  
A magazine site is required for overnight storage of explosives for the morning blast

# 臨時爆炸品倉庫的選址要求

## Selection Criteria of Magazine Site

- 儘量遠離民居  
Away from the nearby residents
- 可提供車輛直達通道  
Direct vehicular access
- 有足夠的儲存量  
Sufficient storage capacity
- 儘量接近爆破工程地點  
Adjacent to the blasting work areas

# 臨時爆炸品倉庫-春坎山 Magazine Site – Chung Hom Shan



# 爆破週期 Blasting Cycle

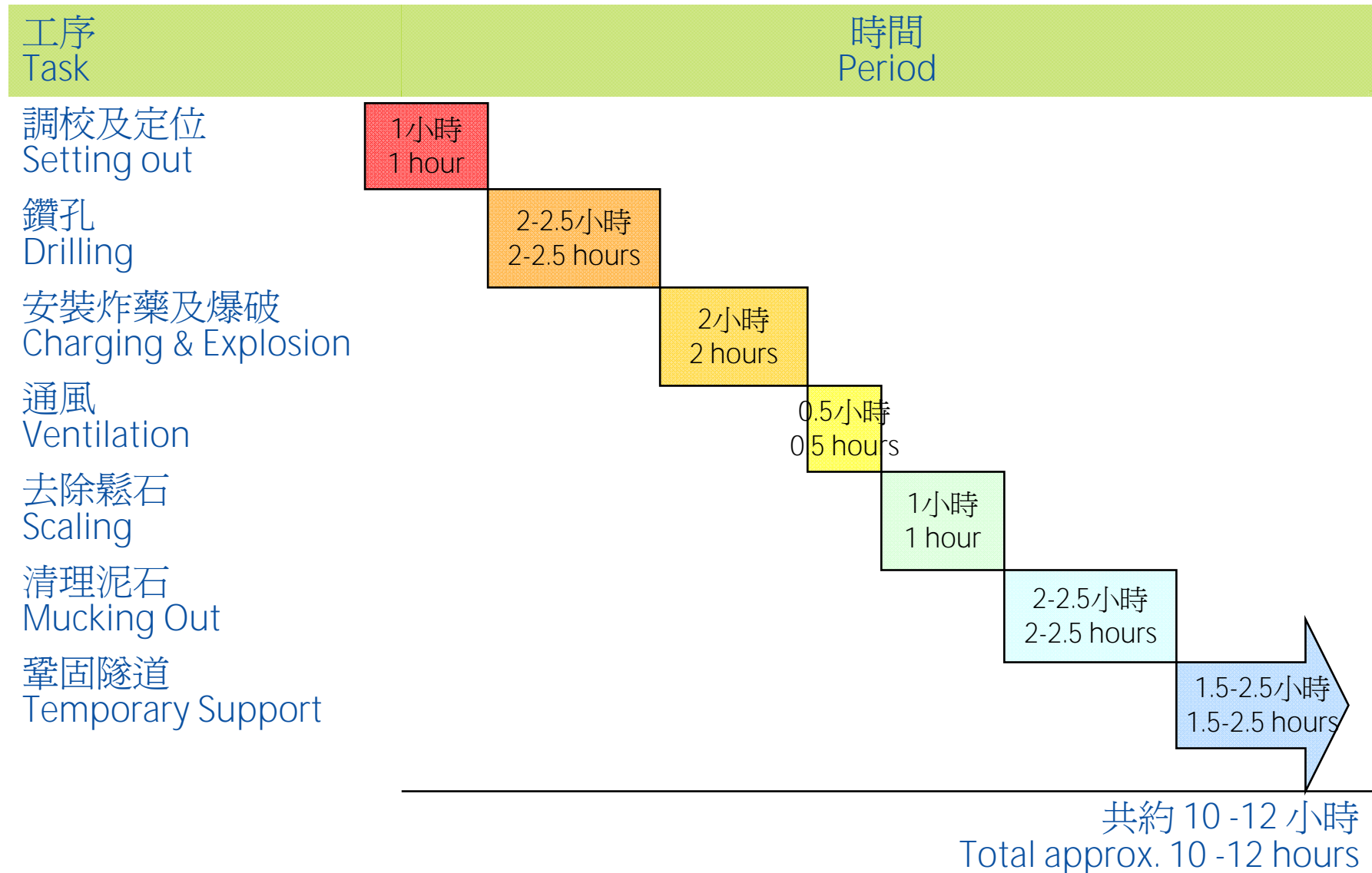





**Tung Wah Group of Hospitals Jockey Club  
Rehabilitation Complex**  
東華三院賽馬會復康中心

# 初步設計 Preliminary Design

東華三院賽馬會復康中心A座  
TWGHs Jockey Club Rehabilitation Complex Block A

- 復康中心的主要關注：噪音、高度及距離  
Main Concerns of JCRC: Noise, track level and distance
- 設計隊伍正研究復康中心的關注  
Design team is investigating means to address the concerns

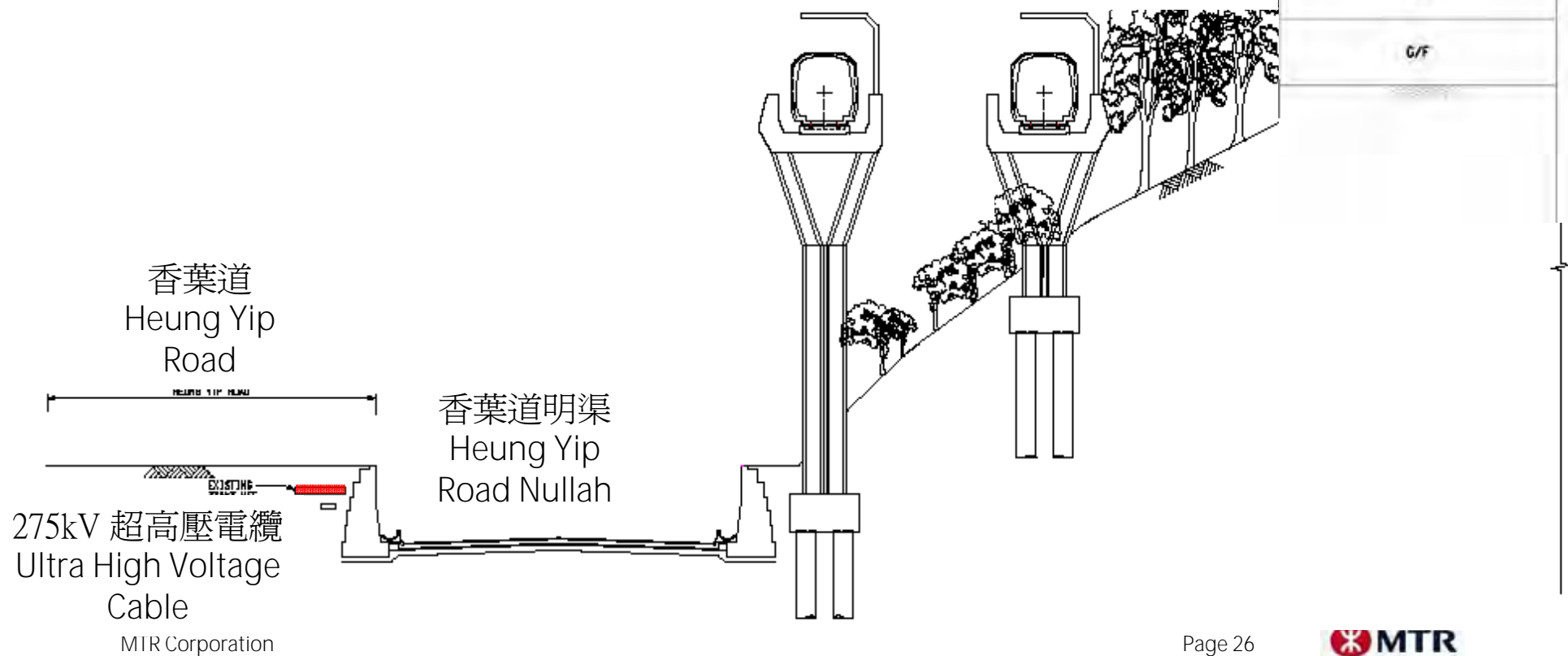

# 將橋墩移到明渠的影響 Impact of Nullah Widening in Accommodating Viaduct Foundation

東華三院賽馬會復康中心A座  
TWGHs Jockey Club Rehabilitation Complex Block A

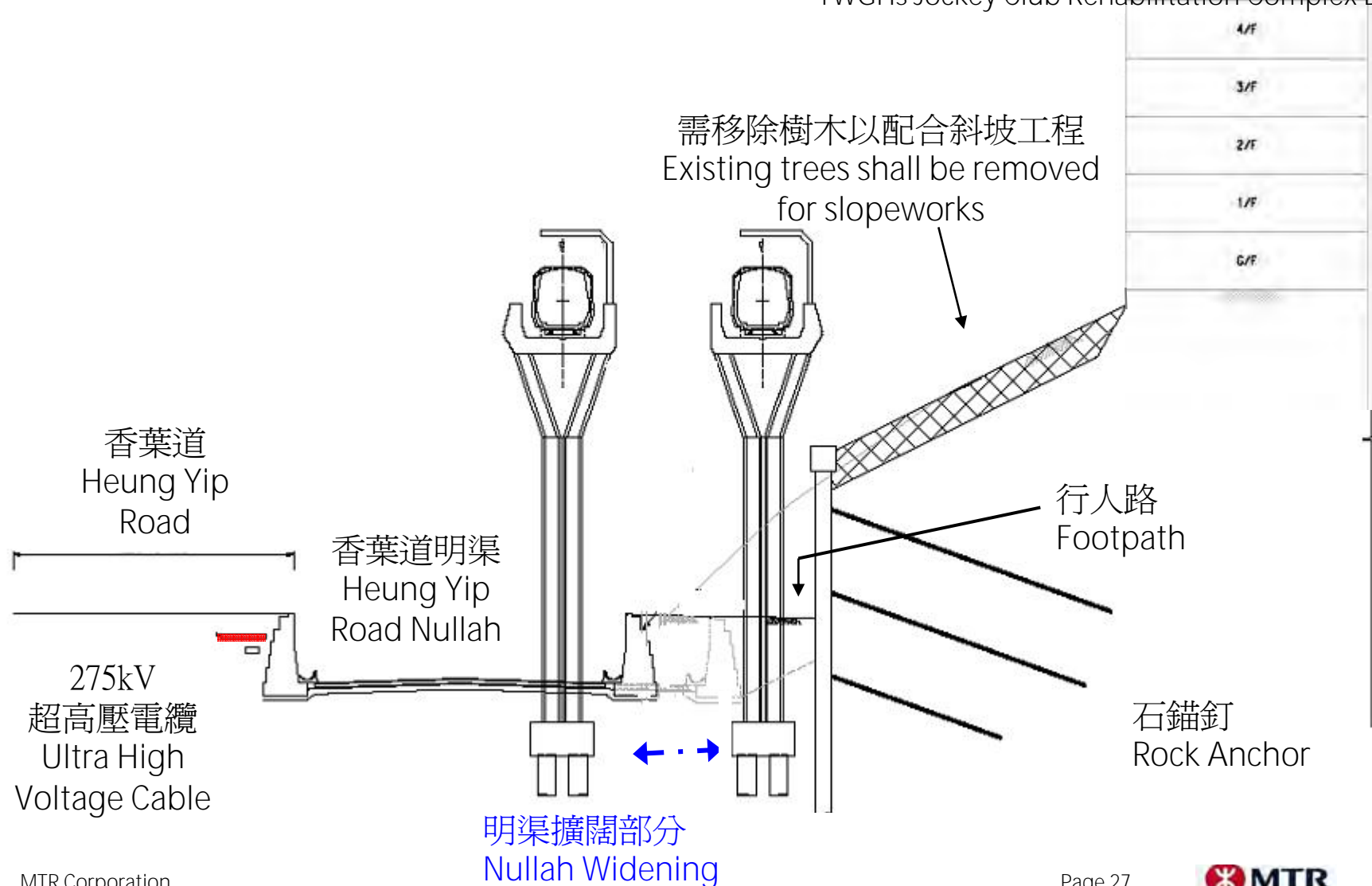

# 工程時間表 Programme

<ul style="list-style-type: none"> <li>按《鐵路條例》刊憲 Railways Ordinance Gazette</li> </ul>	2009年7月 Jul 2009
<ul style="list-style-type: none"> <li>展開詳細設計 Detailed Design Commencement</li> </ul>	2009年7月 Jul 2009
<ul style="list-style-type: none"> <li>按《鐵路條例》批准方案 Scheme Authorization</li> </ul>	2010年底前 Before End of 2010
<ul style="list-style-type: none"> <li>展開建設工程 Construction Commencement</li> </ul>	2011年 2011
<ul style="list-style-type: none"> <li>南港島綫(東段)項目落成啓用 Opening</li> </ul>	2015年 2015



完  
End