

# West Kowloon Law Courts Building

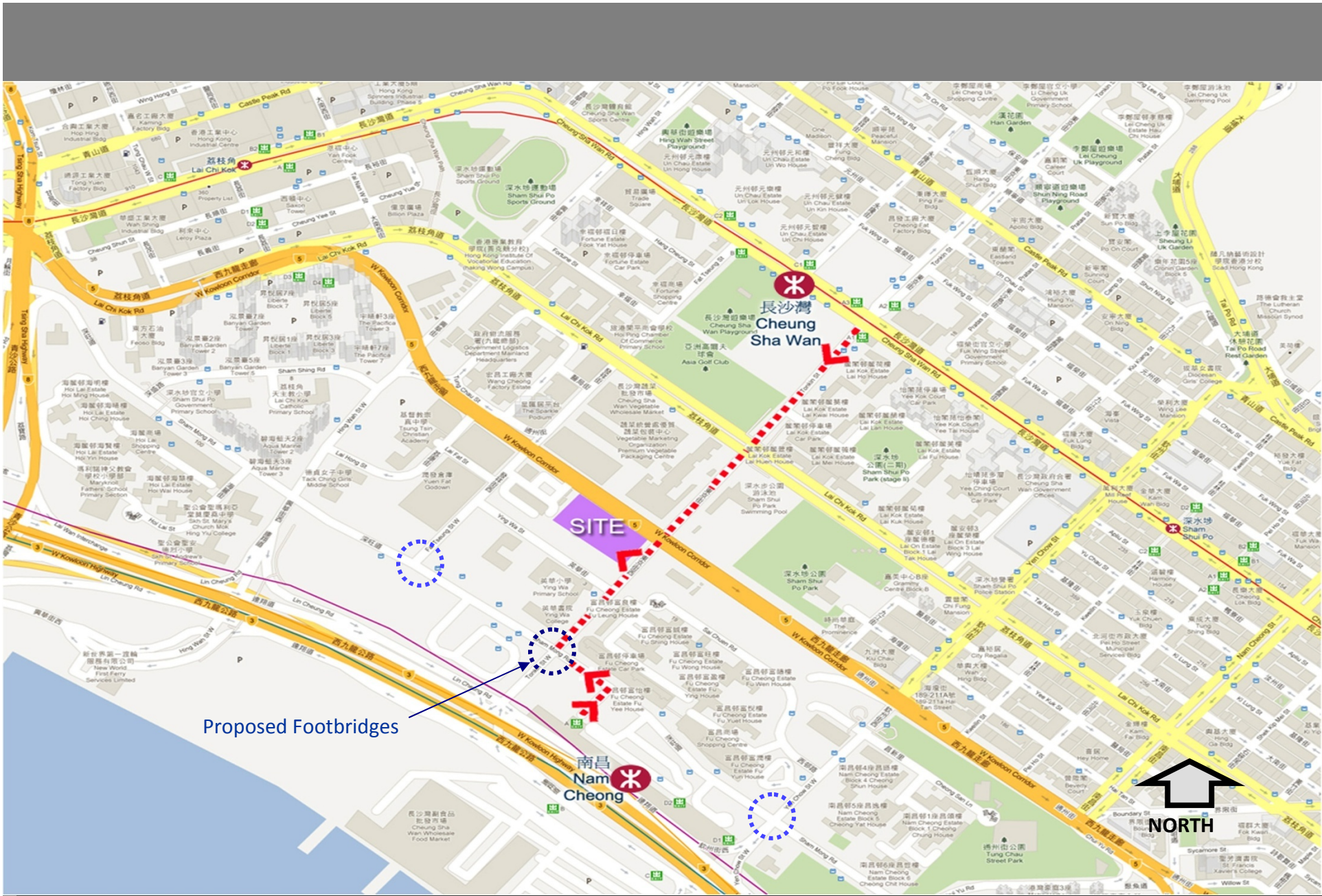

Proposed Footbridges

南昌  
Cheung Sha Wan



# Location Plan



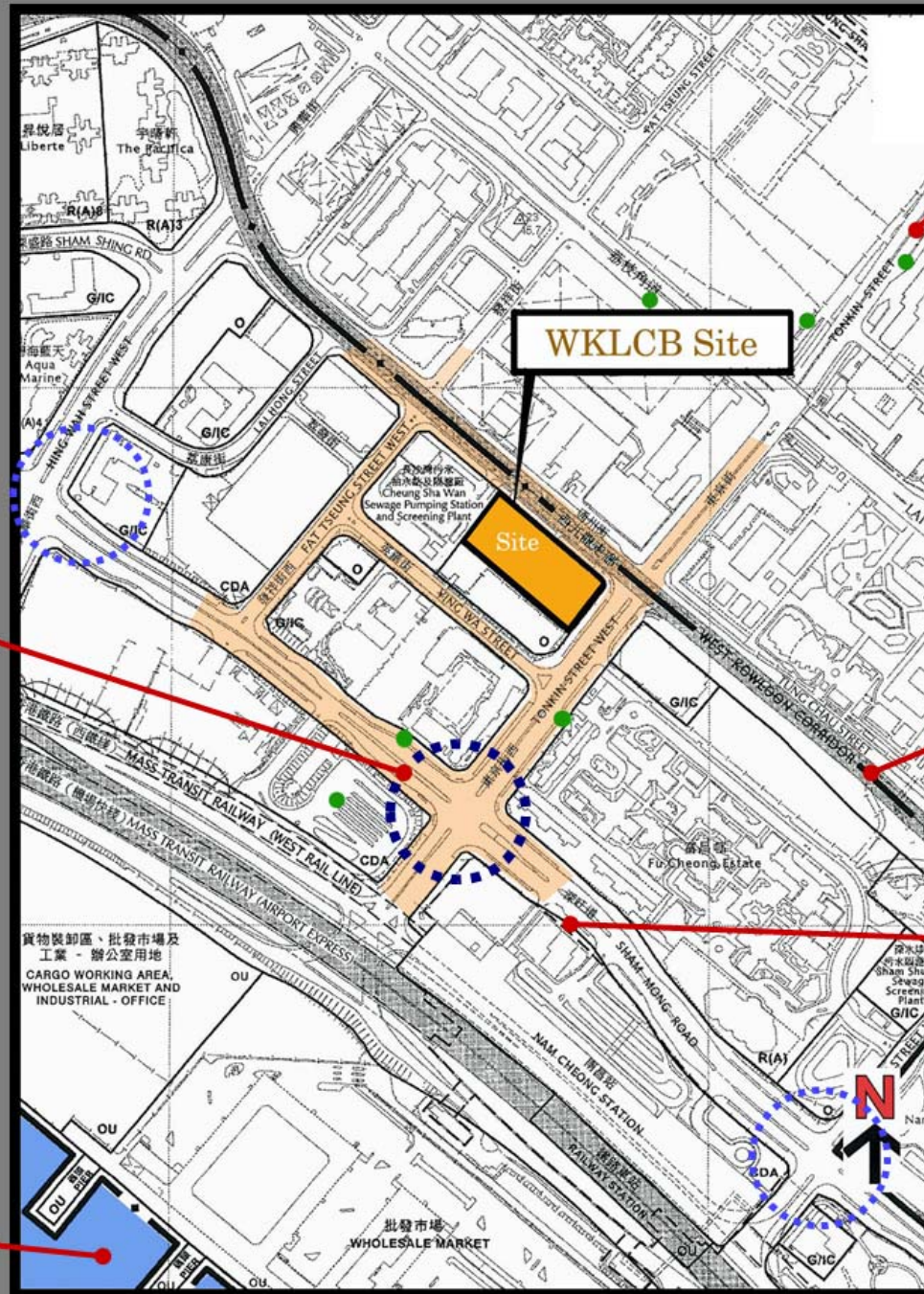

Cheung Sha Wan  
360m

WKLCB Site

Site

Proposed Footbridges

West Kowloon  
Corridor



Nam Cheong - 320m

Victoria Harbour

Bus Stops







Building Image from West Kowloon Corridor



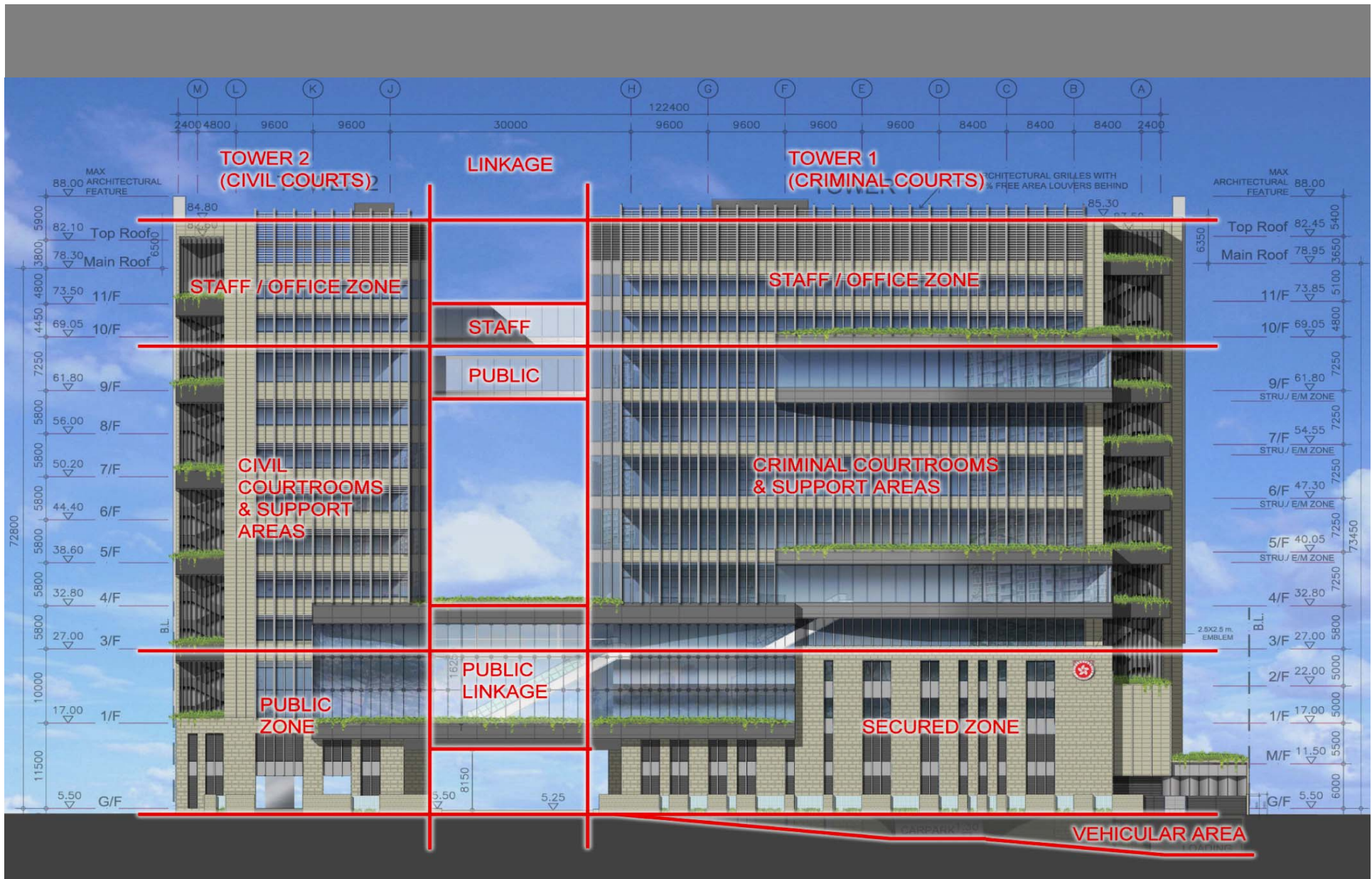

Functional Zoning

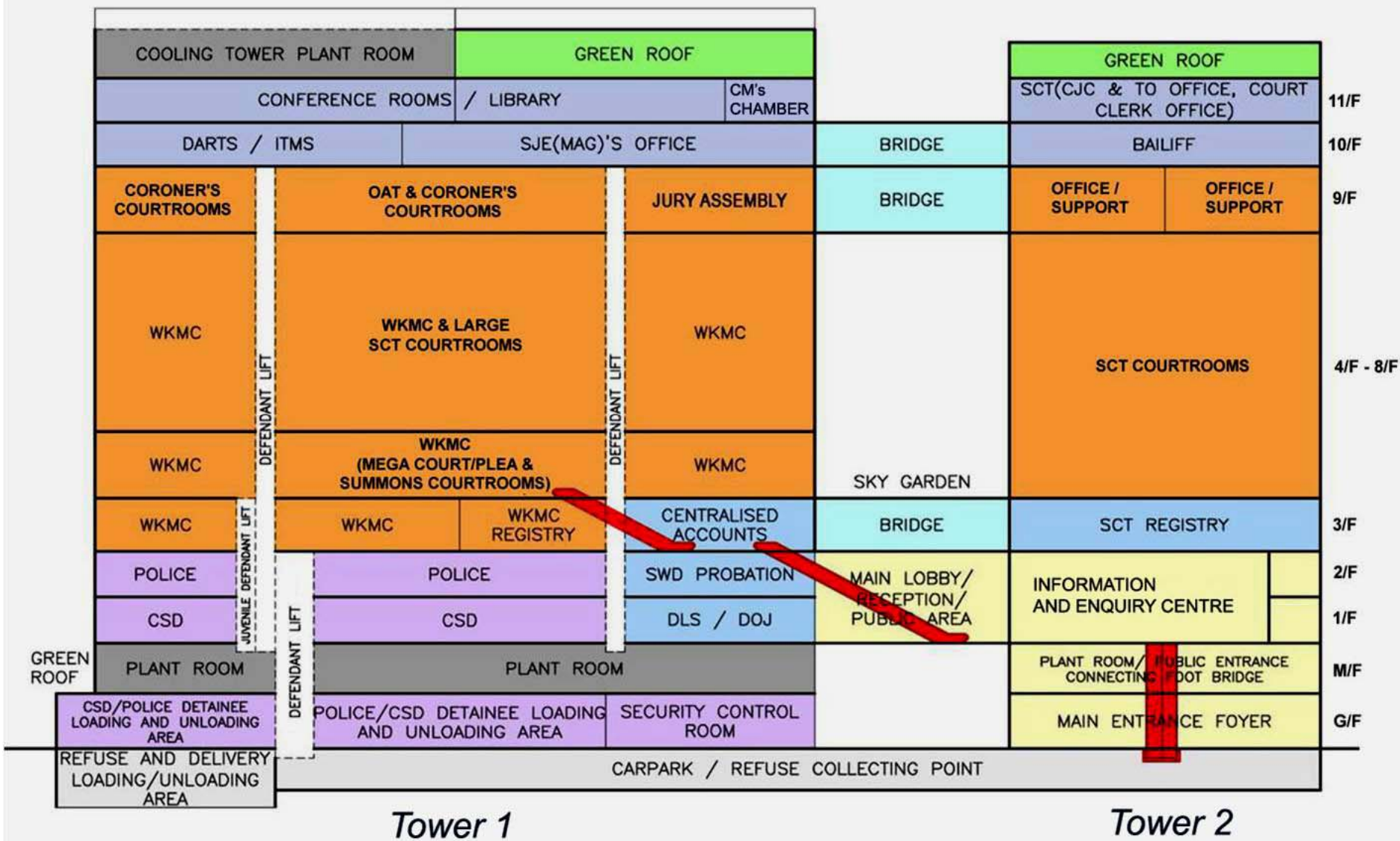

# Functional Zoning



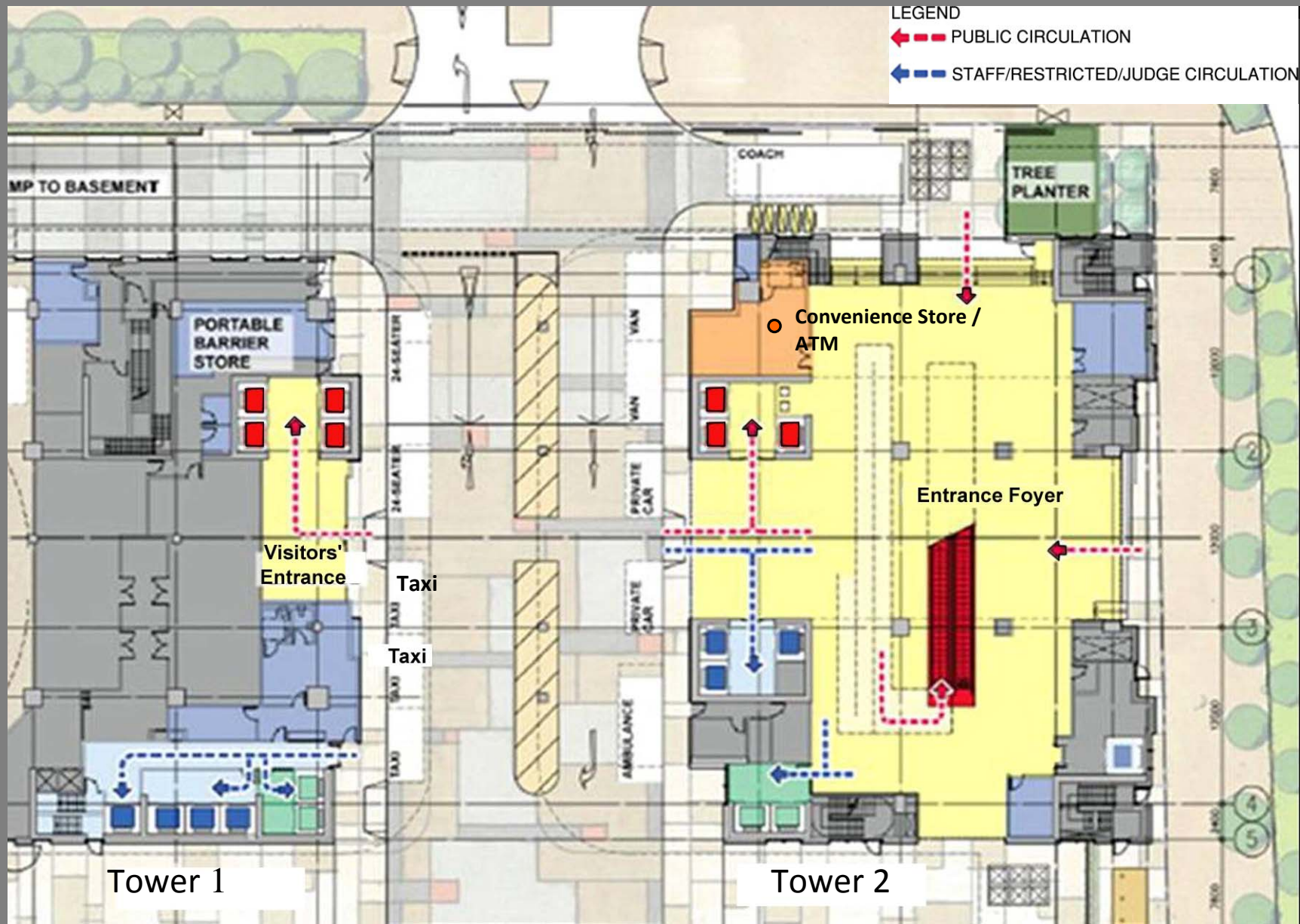

Internal Circulation (Public/Staff) – G/F

Tower 1

Tower 2

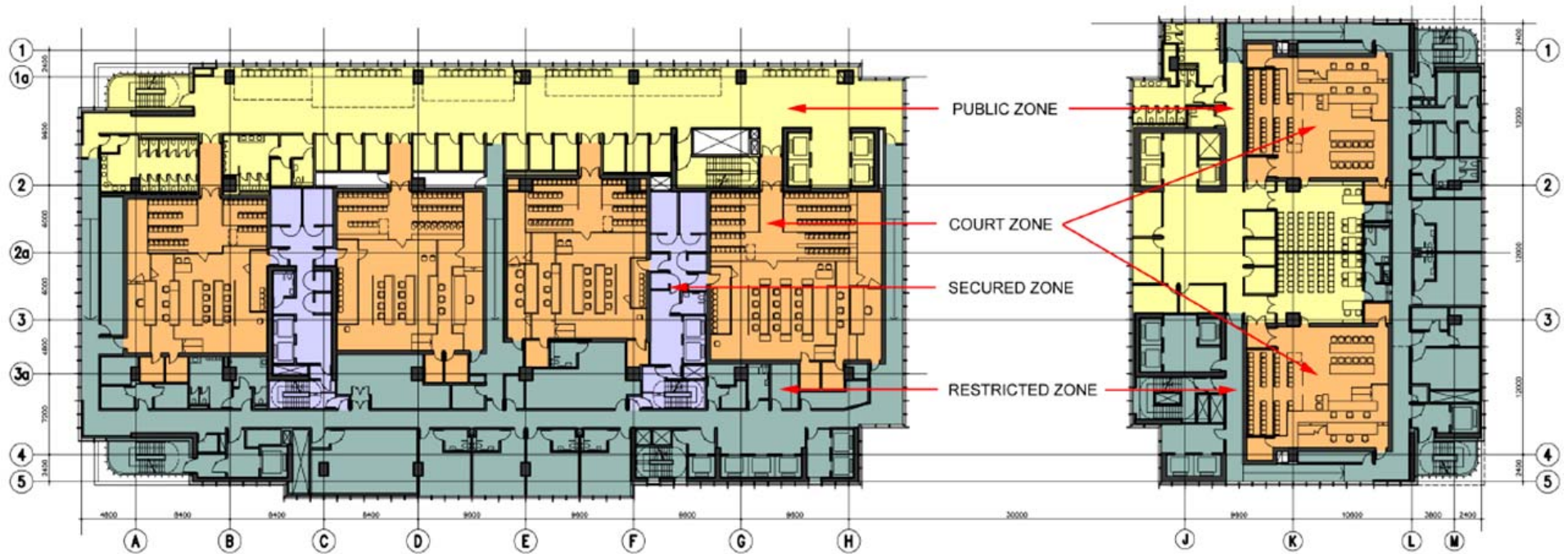

Typical Floor Zoning





Main Pedestrian Entrance at Tonkin Street West









Main Lobby



Tower 1

Tower 2

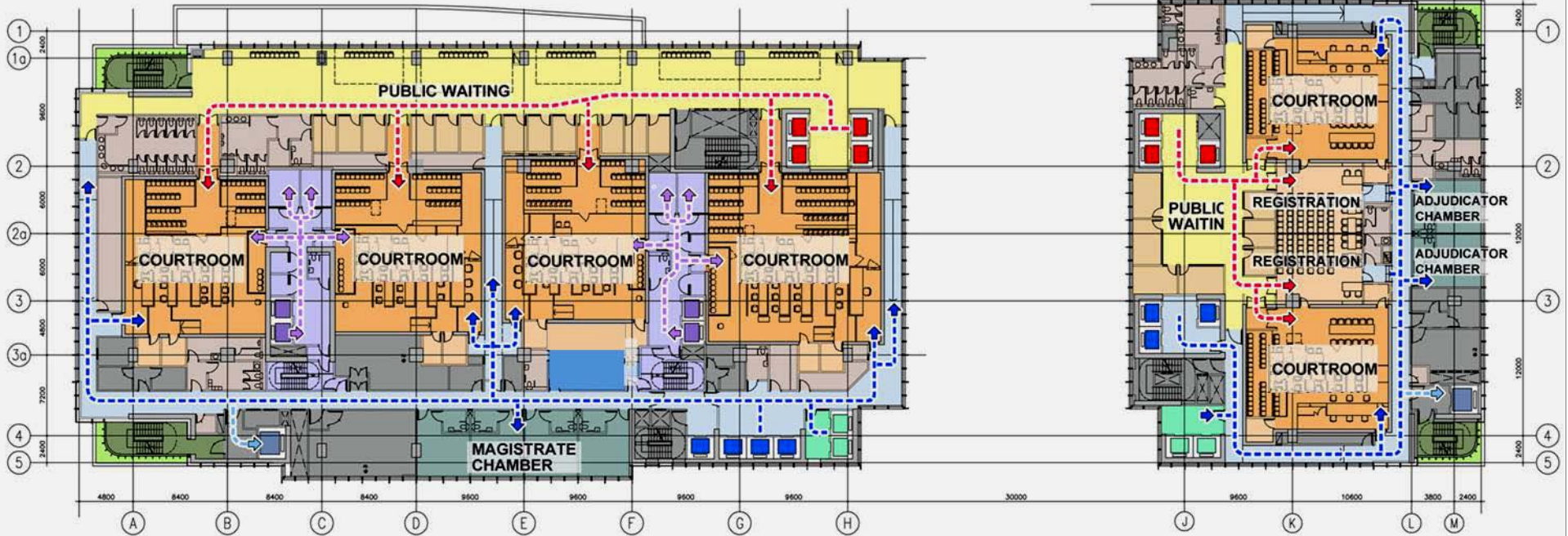

Typical Floor Plan





Typical Interior of Judge Chambers



render time: 1h 19m 8.2s

Mega Court



Tower 1

Tower 2

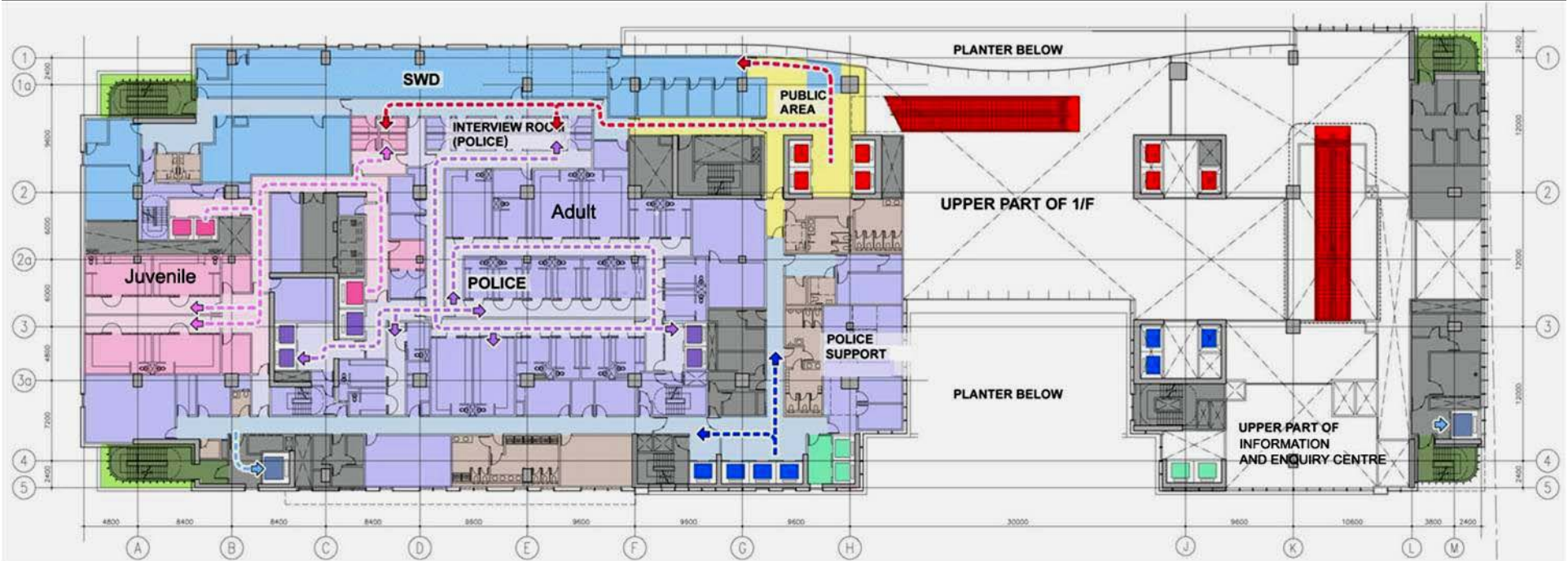

LEGEND

- ← - - - PUBLIC CIRCULATION
- ← - - - STAFF/RESTRICTED/JUDGE CIRCULATION
- ← - - - DEFENDANT CIRCULATION (ADULT)
- ← - - - DEFENDANT CIRCULATION (JUVENILE)

Internal Circulation - 2/F

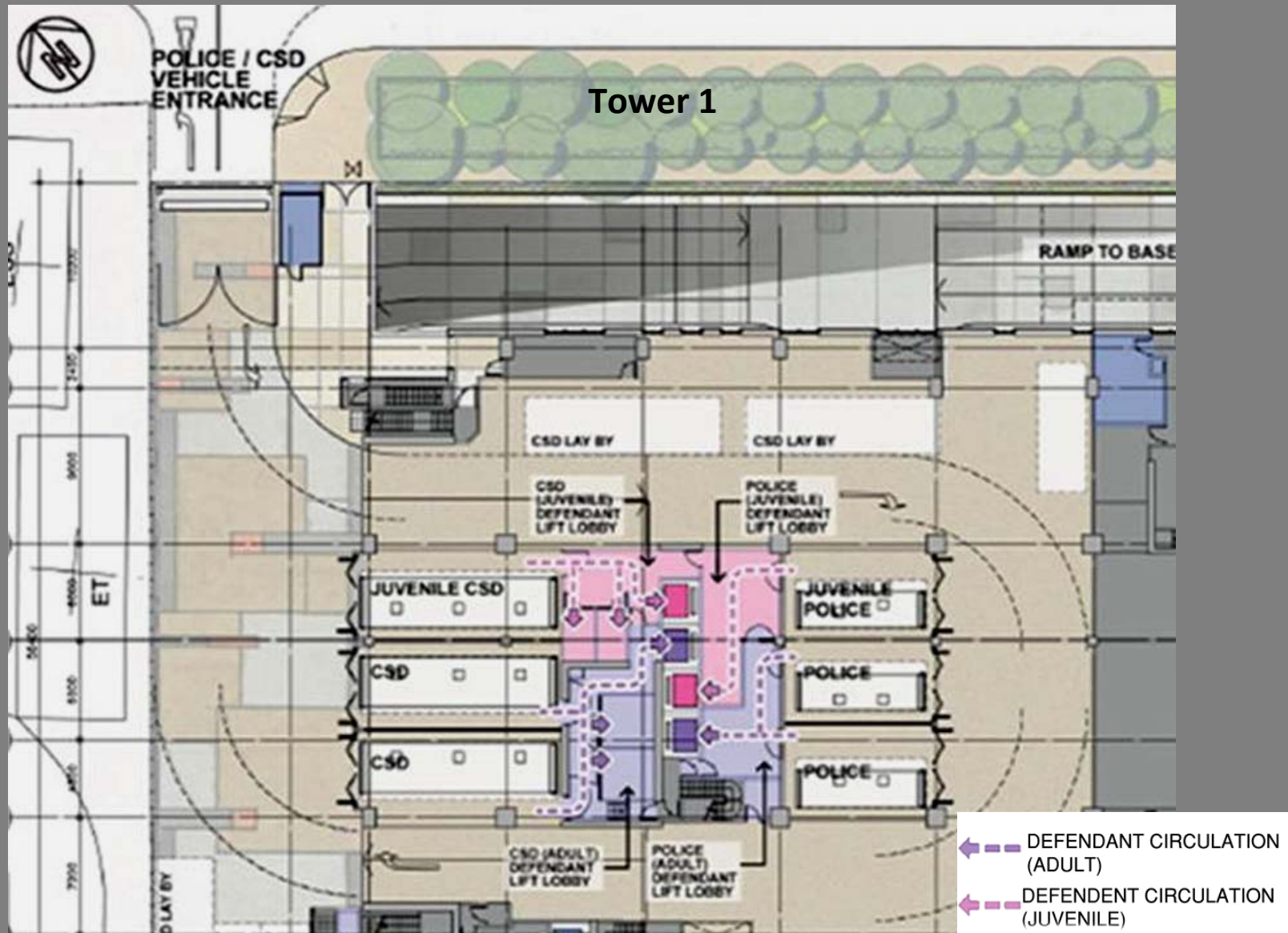

Defendant Circulation at CSD/Police Loading Bay  
G/F, Tower 1



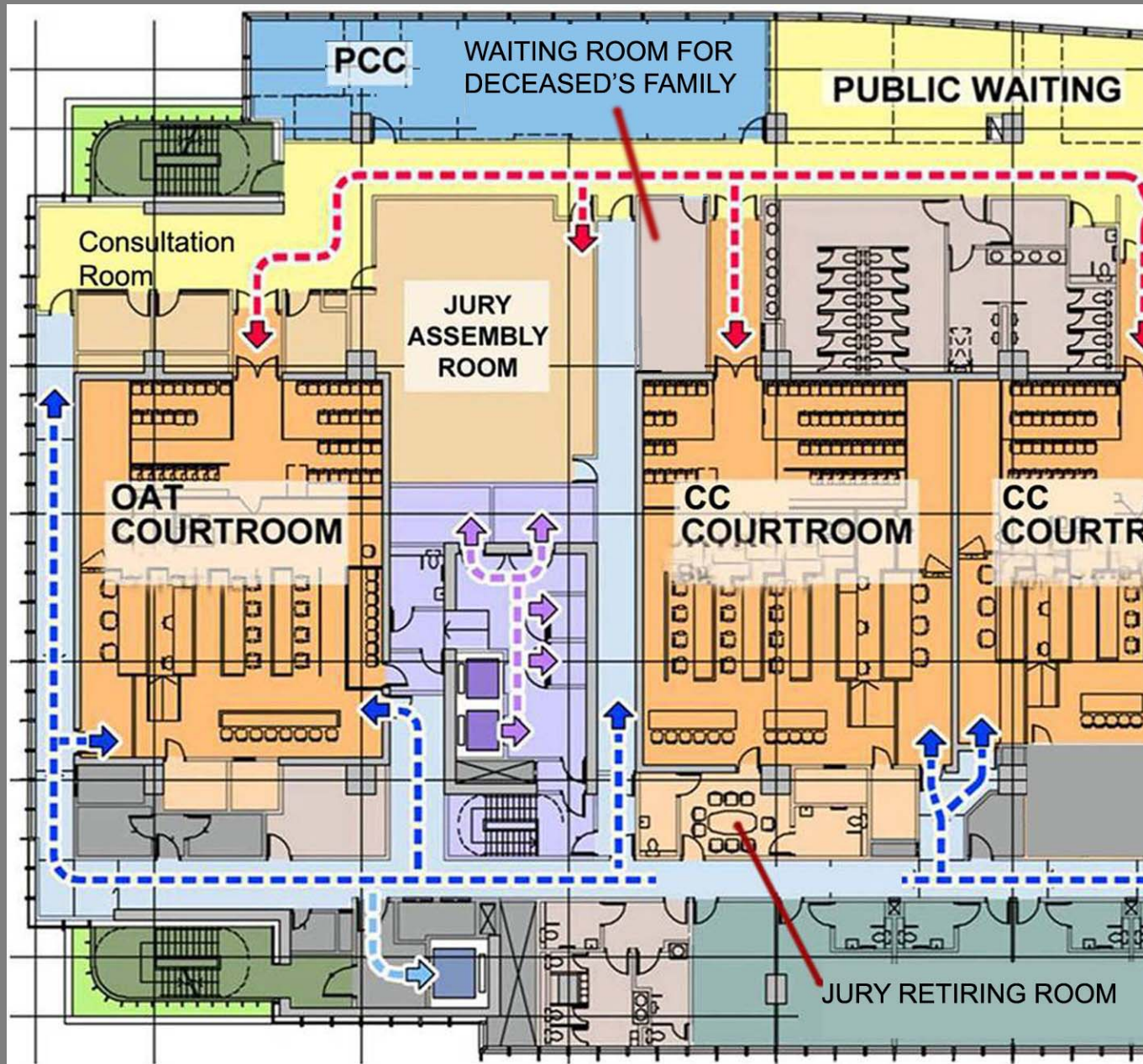

OAT and Coroner's Courtroom – 9/F, Tower 1

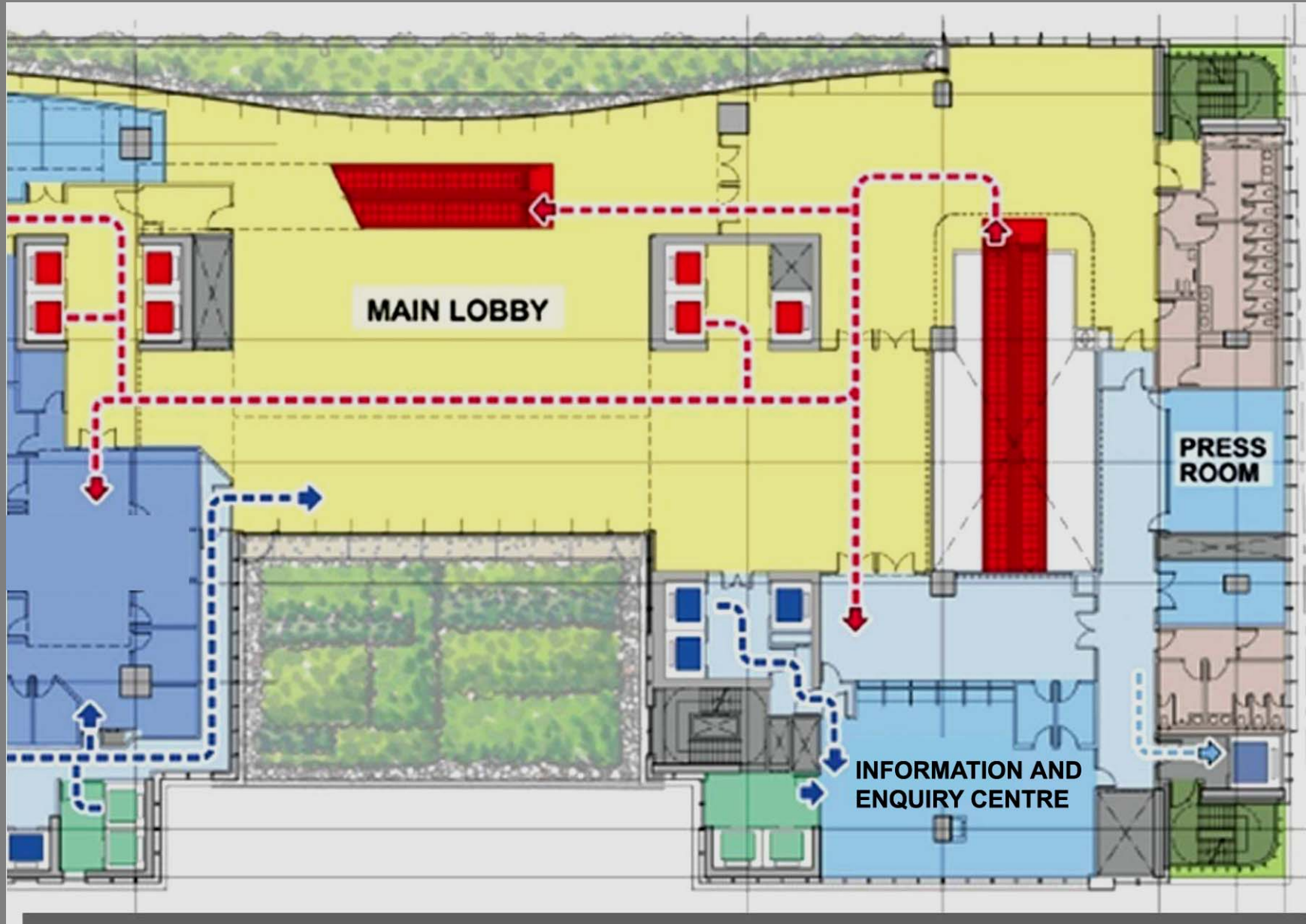

Information and Enquiry Centre / Press Room - 1/F, Tower 2



Tower 1

Tower 2

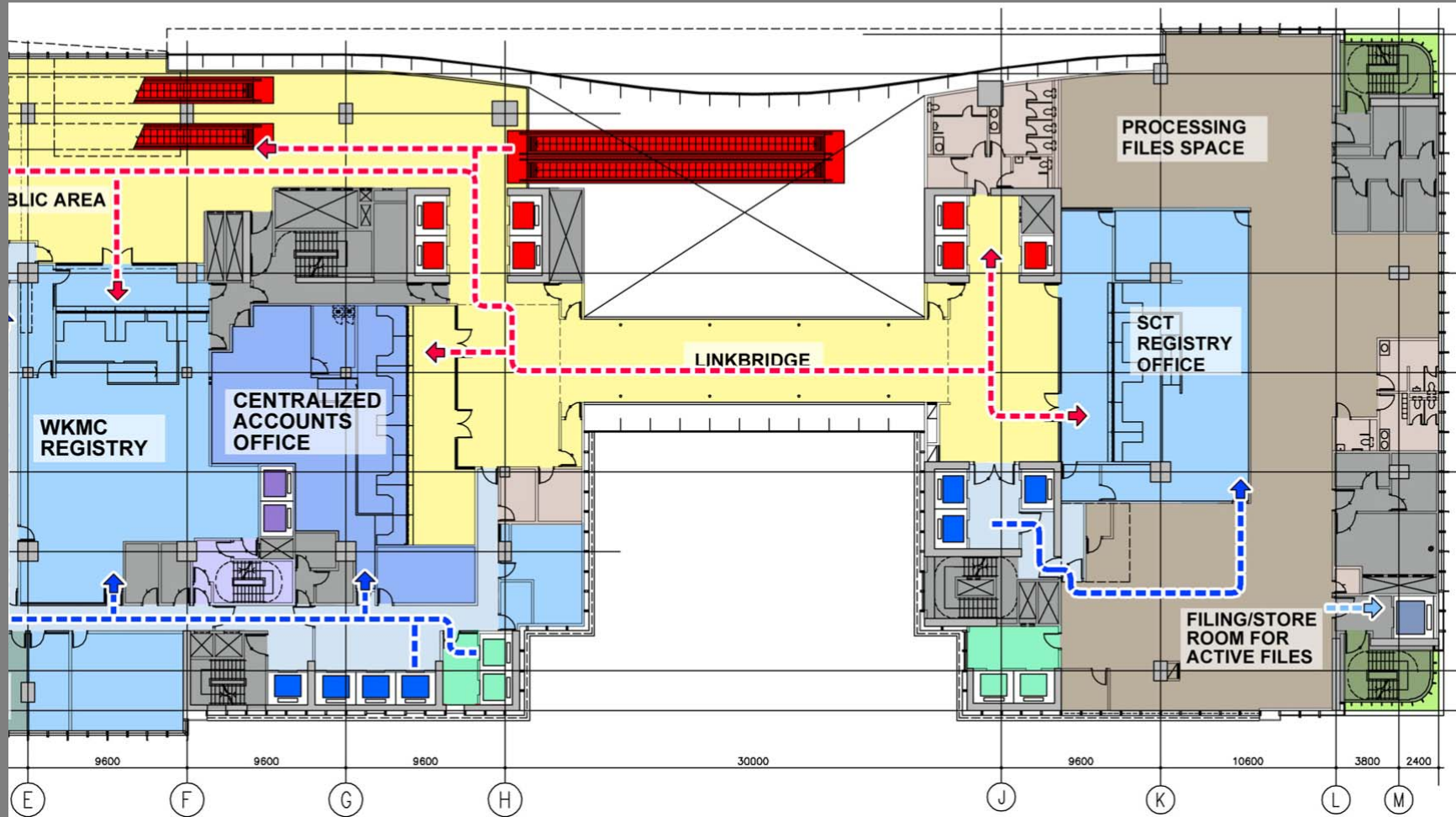

SCT Registry Office – 3/F, Tower 2

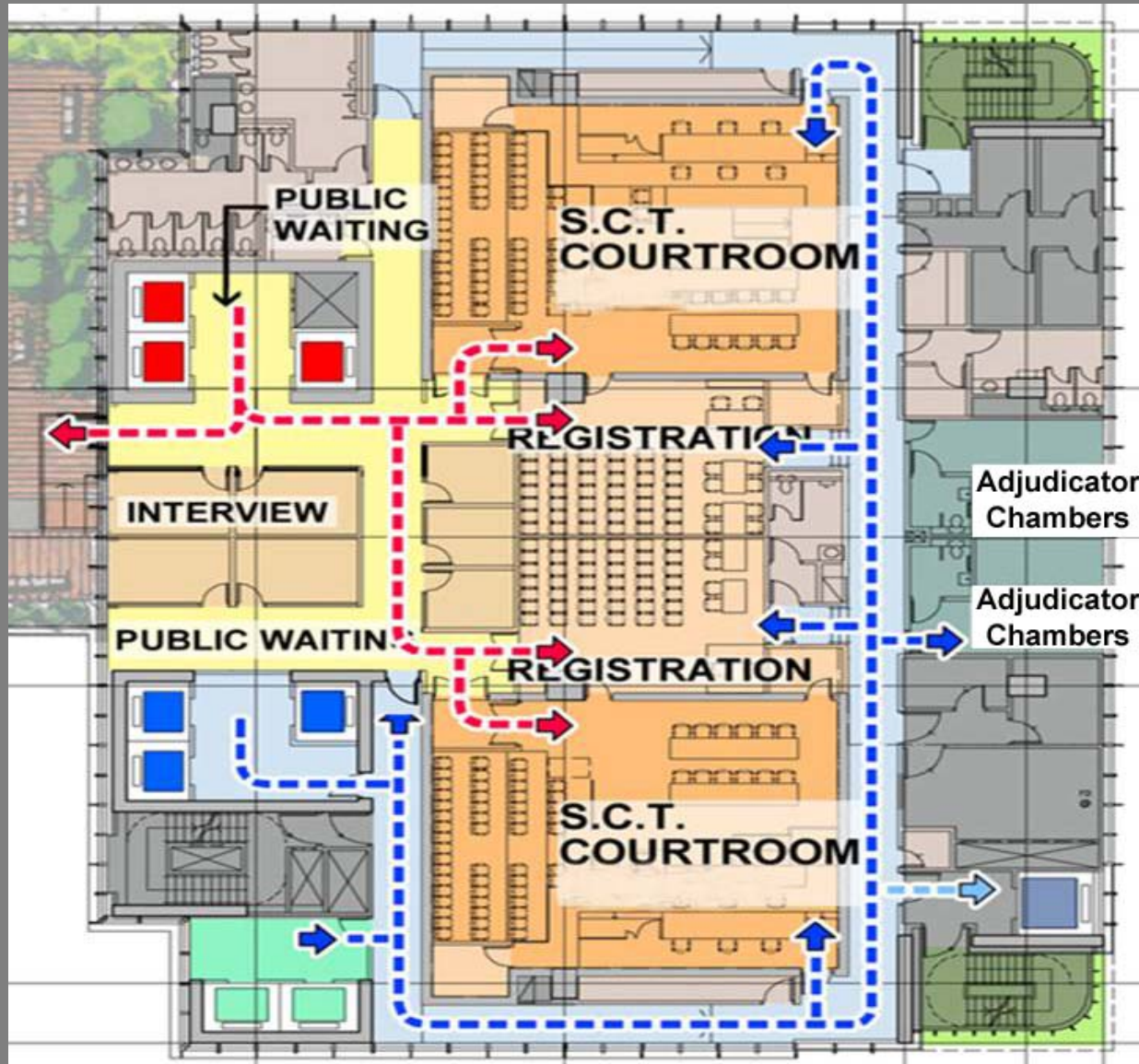

SCT Courtrooms – 4/F, Tower 2



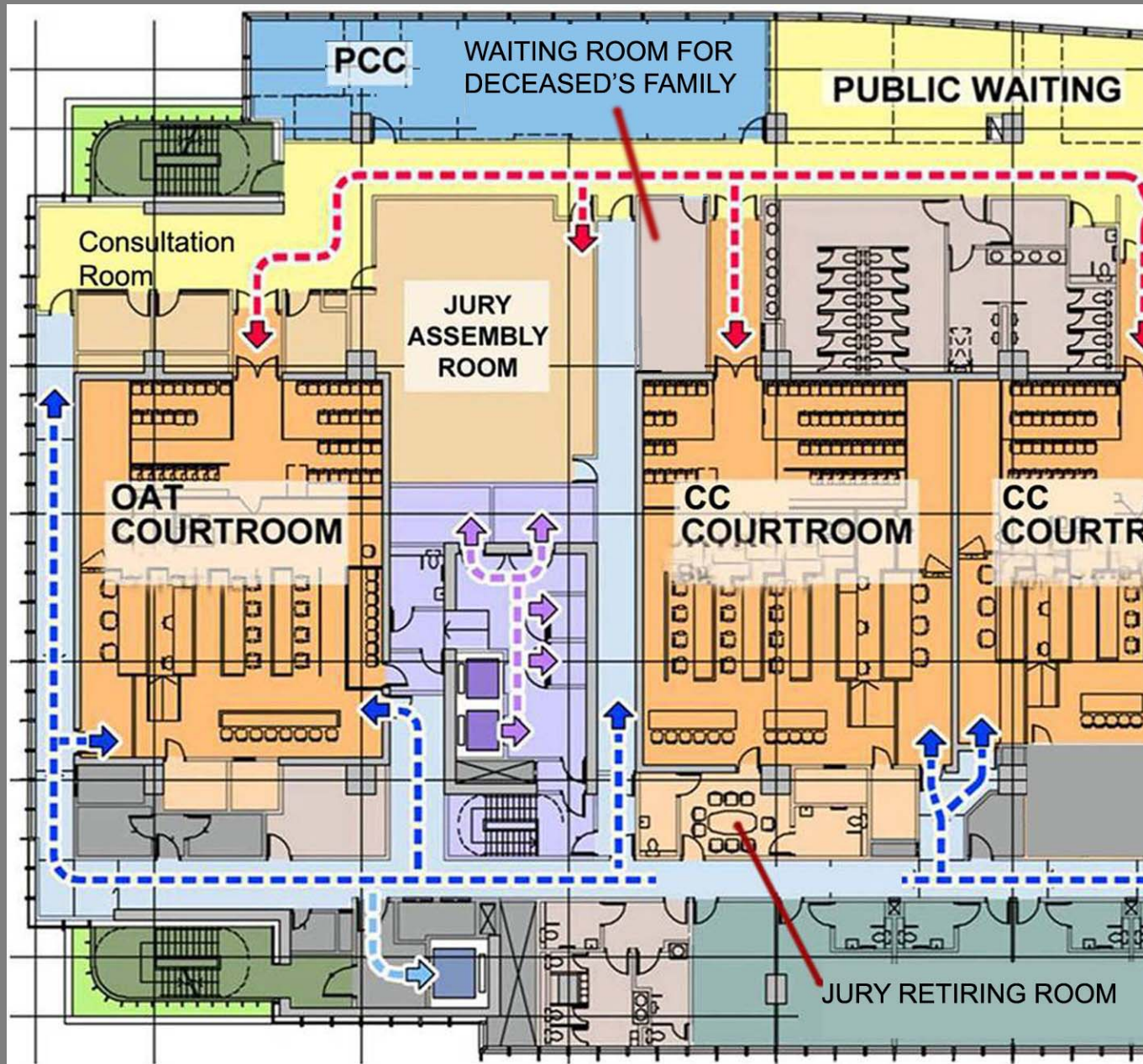

OAT and Coroner's Courtroom – 9/F, Tower 1

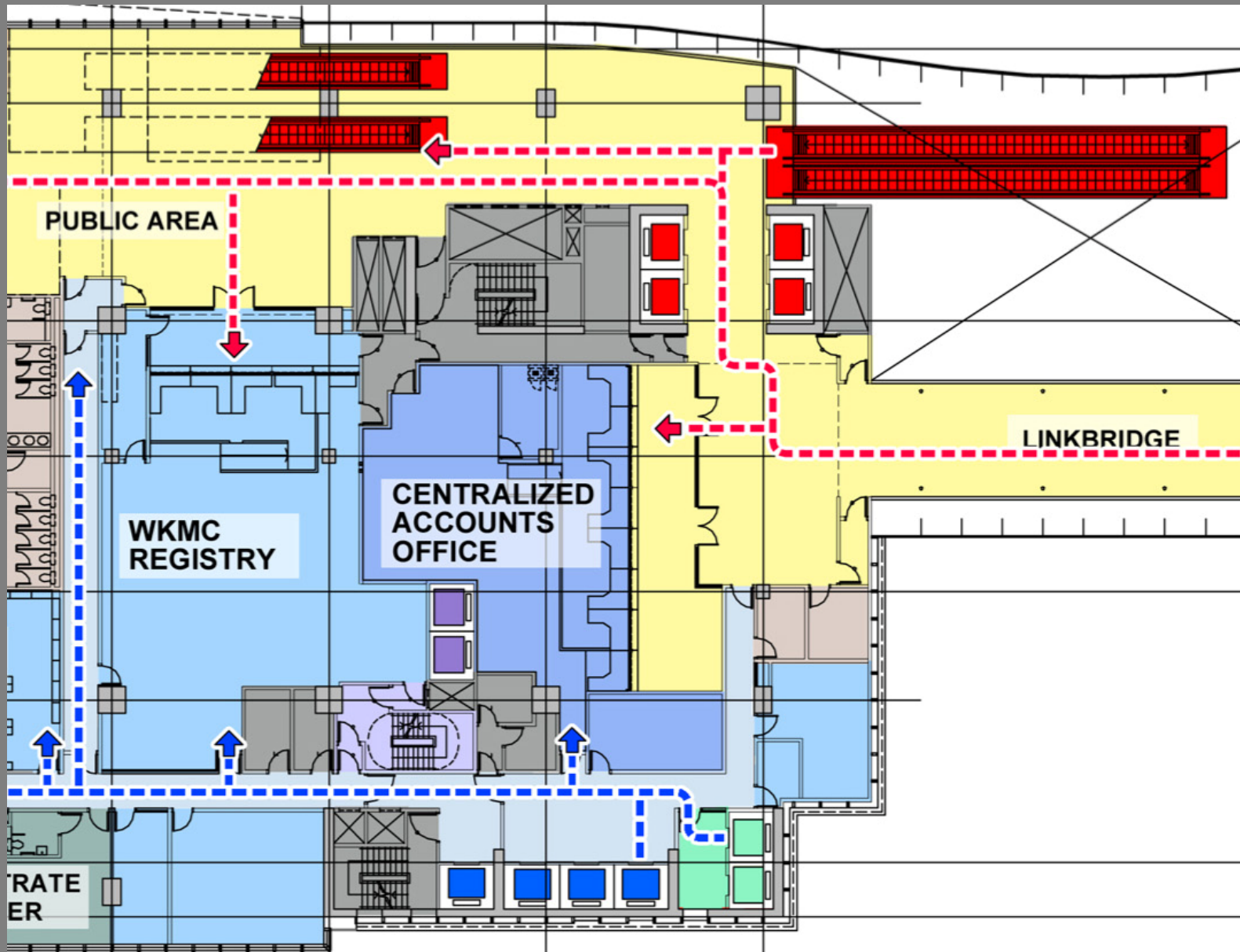

Centralized Accounts Office – 3/F, Tower 1



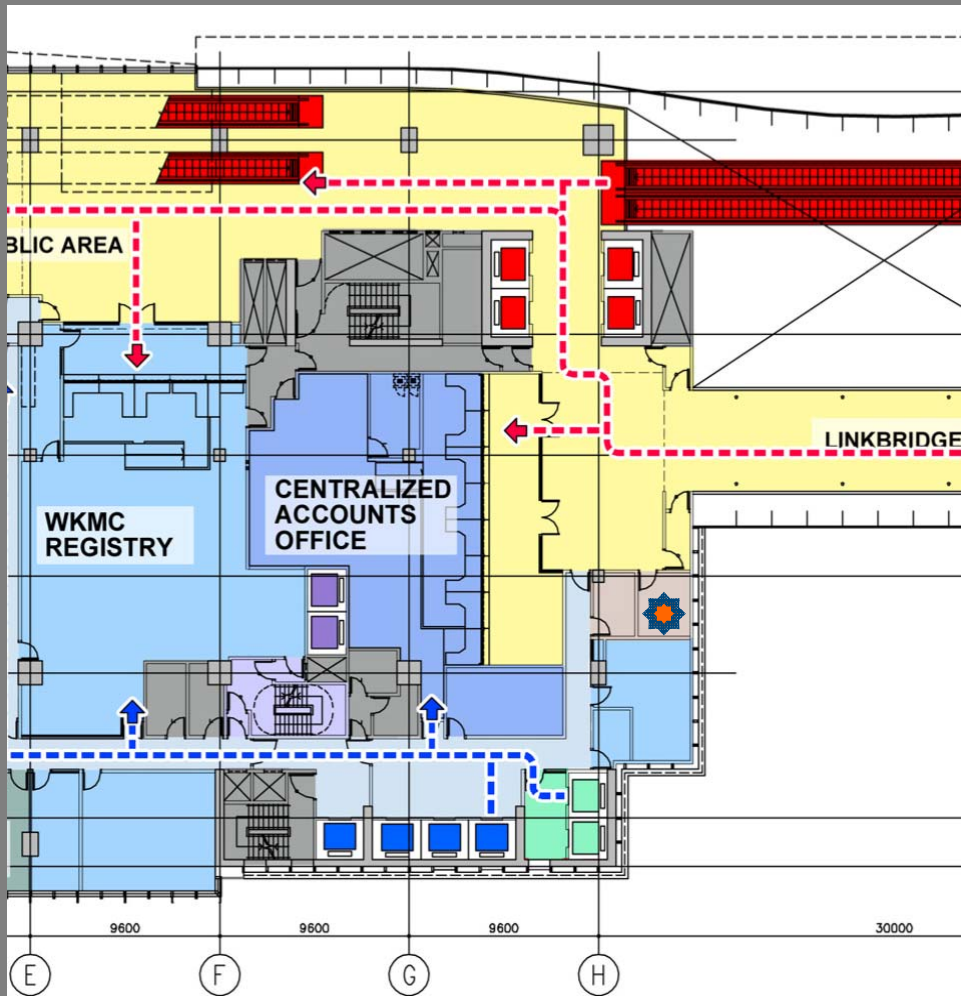

Linkbridge – 3/F Tower 1

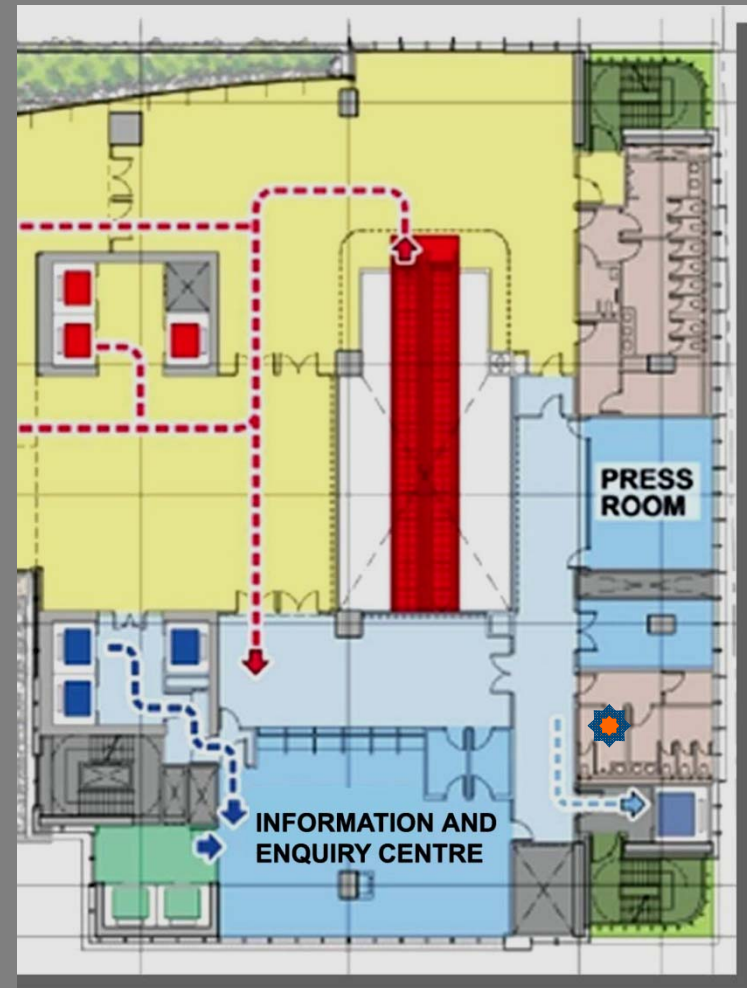

Main Lobby – 1/F Tower 2

 Babycare Room

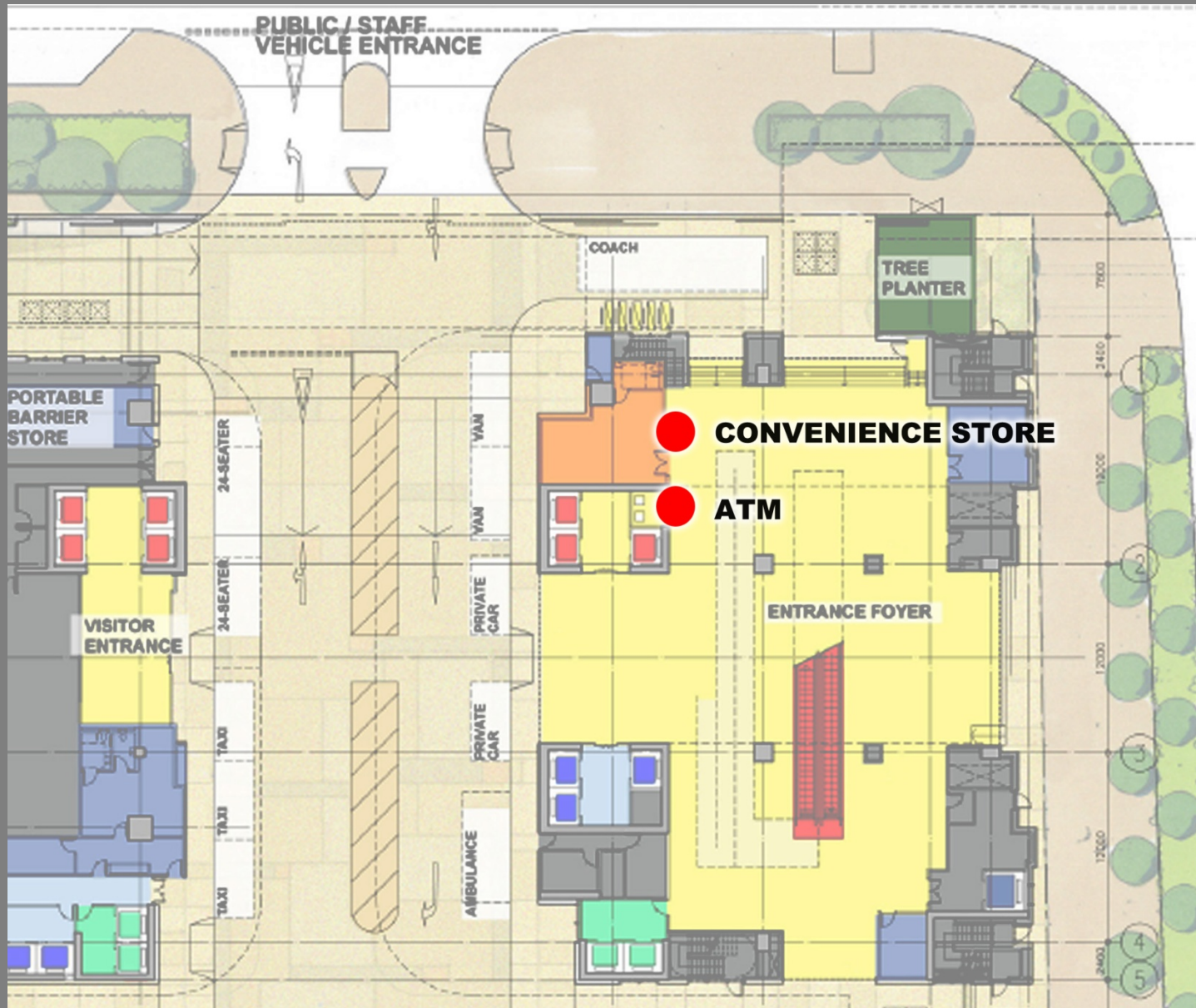

Public Facilities – G/F, Tower 2



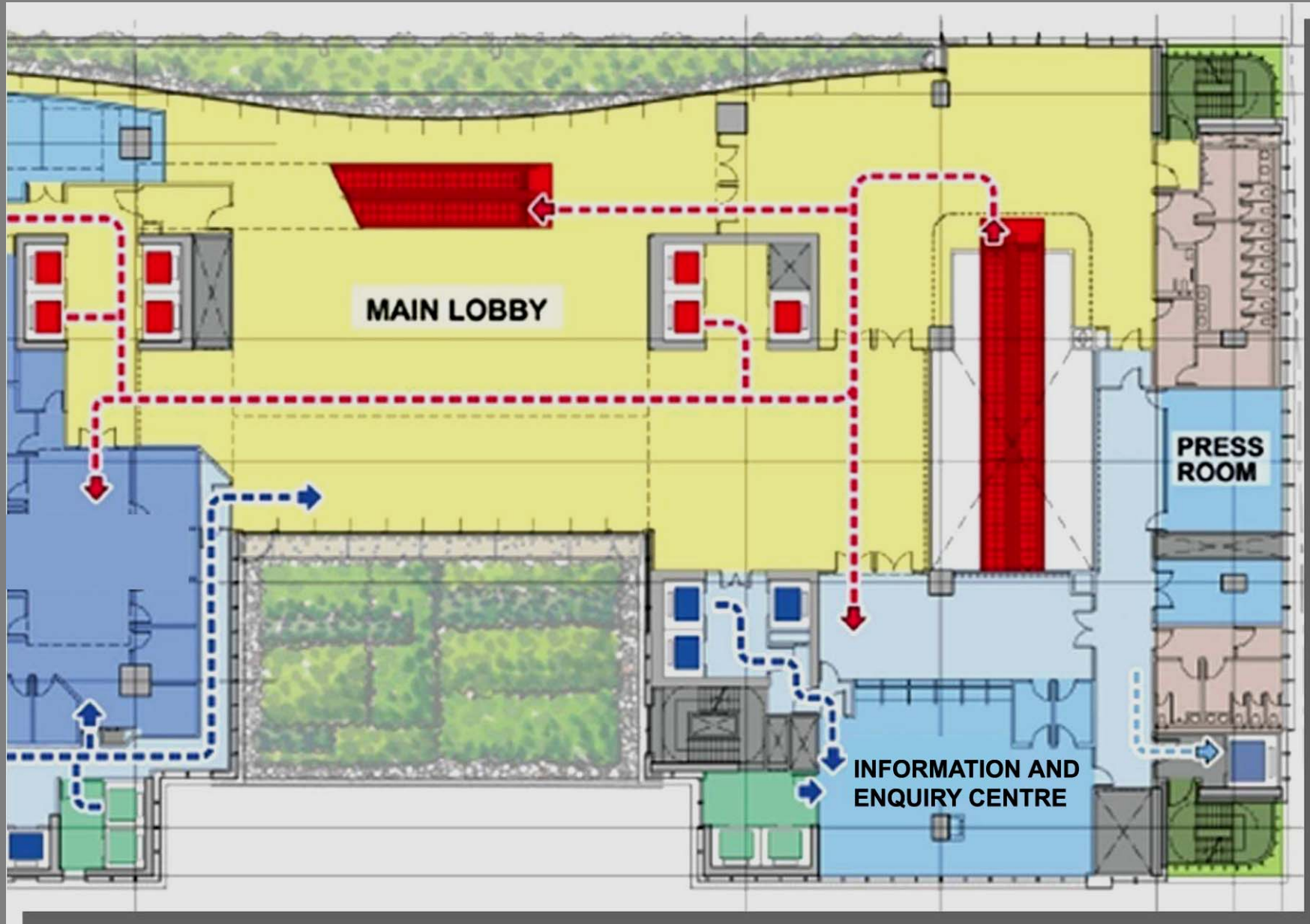

Information and Enquiry Centre / Press Room - 1/F, Tower 2

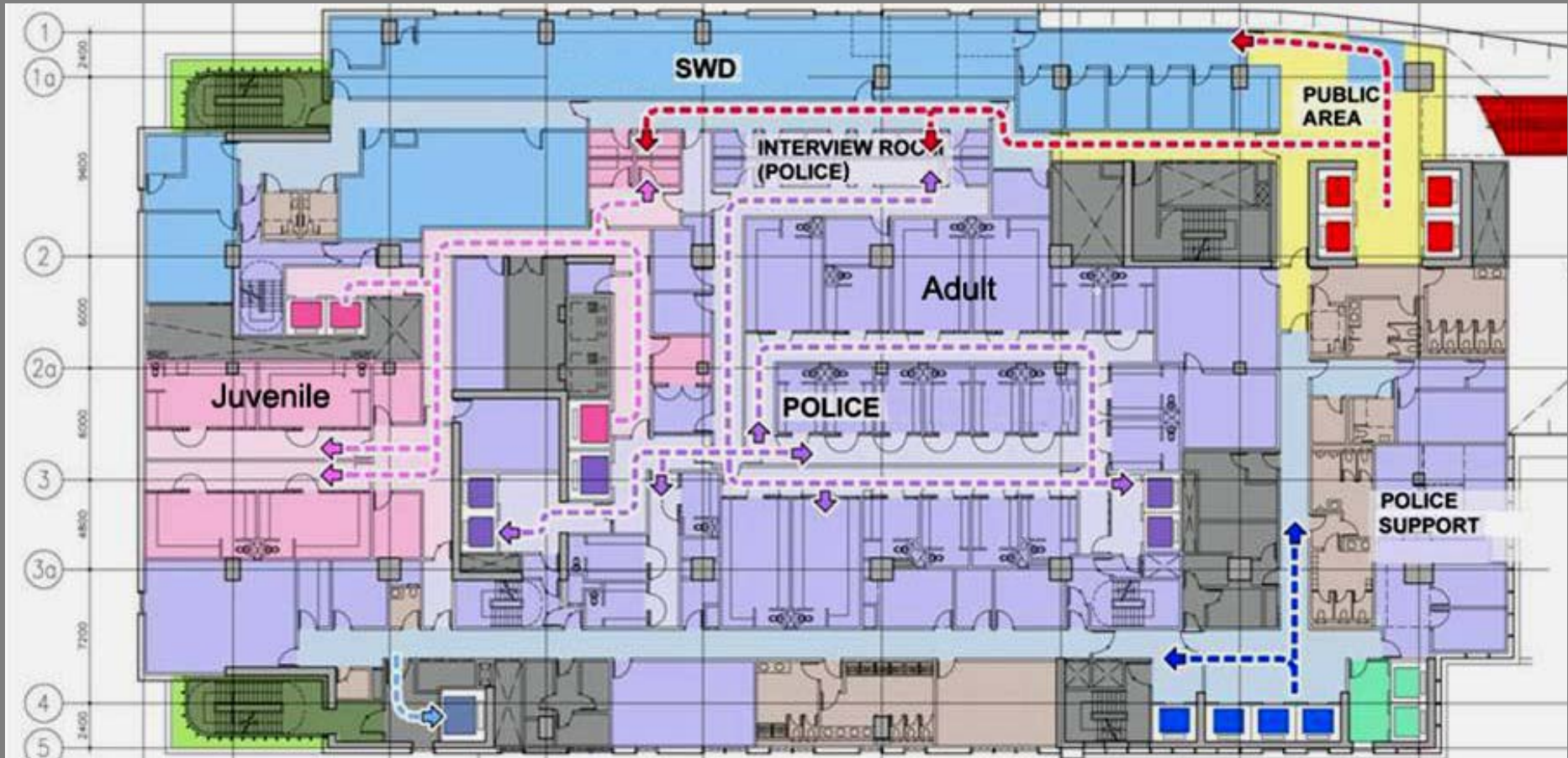

**LEGEND**

- ← - - - PUBLIC CIRCULATION
- ← - - - STAFF/RESTRICTED/JUDGE CIRCULATION
- ← - - - DEFENDANT CIRCULATION (ADULT)
- ← - - - DEFENDANT CIRCULATION (JUVENILE)

Internal Circulation - 2/F, Tower 1





Building Image from Tonkin Street West

# West Kowloon Law Courts Building