

**Legislative Council
Panel on Home Affairs and Panel on Development
Joint Subcommittee to Monitor the Implementation of the
West Kowloon Cultural District Project**

Follow-up to meetings on 10 June, 3 July and 10 July 2013

1. Development of M+

The Administration/West Kowloon Cultural District Authority (WKCD) was requested to –

- (a) explain the scope of and strategy for the collection of M+, in particular whether it would focus mainly on artworks of Hong Kong visual culture to be acquired both locally and from abroad, or whether it would comprise a mix of Hong Kong, Chinese, Asian and global visual culture; and**

In response to the recommendations by the Consultative Committee on the Core Arts and Cultural Facilities of the West Kowloon Cultural District (WKCD) in 2007, M+ aims to build a world-class collection focusing on the 20th and 21st century visual culture from a Hong Kong perspective with a global vision, expanding to other regions of China, Asia and the rest of the world, and encompassing genres from visual art, ink art, design, architecture to moving image.

In terms of geographical priorities, the M+ Collection can be viewed as a number of concentric circles with Hong Kong Art at the very centre, meaning that Hong Kong Art will always be the core of the collection and be well represented in the collection. Since the Interim Acquisition Committee was established in June 2012, M+ has been actively looking for quality Hong Kong Art and around 70% of the approved acquisitions (excluding the Sigg Collection) is Hong Kong Art as at October 2013.

- (b) respond to a member's concern that with only a small number of curators from Hong Kong in its curatorial team, how M+ could achieve its mission to develop content from a Hong Kong perspective and promote Hong Kong visual culture.**

In view of M+'s mission, it is crucial that M+ has the expertise in visual culture from Hong Kong as well as from other parts of Asia and the world.

Currently, about half of the M+ curatorial team is from Hong Kong. This number corresponds with the recruitment plan of M+, which aims to recruit at least 50% of the curatorial staff from Hong Kong, with 25% from other parts of Asia and the world respectively. When recruiting new staff, M+ always tries to recruit locally and make sure that there is a balance of expertise within M+ to reflect its ambition to be a world-class museum as well as to achieve its mission in developing content from a Hong Kong perspective with a global vision and promoting Hong Kong's visual culture.

2. Communication and cooperation with the arts community

The Administration/WKCDA was requested to respond to the following views that –

(a) the communication between WKCDA and the arts community was ineffective; and

To ensure the future arts and cultural facilities in the WKCD meet the public's and users' aspirations, WKCDA conducts ongoing discussions with the public and stakeholders to collect their views and update them on the latest development of the WKCD project.

WKCDA conducted a total of 87 stakeholder engagement meetings with 91 arts and cultural groups / institutions, and held a total of 125 student, youth, public and expert forums, focus group meetings, roundtable discussions, presentation as well as seminars during the three-stage Public Engagement Exercise from 2009 to 2011. The proposed mix, size, location, phasing and artistic positioning of the facilities in the Development Plan are the result of close discussions with the arts community.

Following the approval sought on the Development Plan in January 2013, WKCDA has completed the design competitions for the landmark facilities in WKCD and targeted to commence the construction works from 2013 to 2014. WKCDA has continued communications with stakeholders from the arts sector and other relevant disciplines to gather their requirements and

expectations for the future venues and update them on the latest development of the project and beyond.

WKCD will continue to communicate with local artists, practitioners and relevant professionals, individuals, groups and institutions, through its different programmes and other means. Examples include engaging local artists/practitioners/professionals to participate in WKCD's exhibitions and activities; collaborating with local art and cultural groups/organizations to produce quality projects; and hosting symposiums, talks, workshops and public forums both to listen to stakeholders' views as well as to share the developing vision of WKCD.

Apart from official programmes and events, the communication takes the form of attending local art and cultural events; giving lectures in different institutions and universities; participating in public panel as well as intellectual discussions; one-on-one and small group meetings with members of the arts community; and interviews with local as well as international media etc..

- (b) **given that the Consultation Panel (CP) of WKCD formed under the West Kowloon Cultural District Authority Ordinance (Cap. 601) was intended to provide a platform for consulting regularly and openly and building consensus among stakeholders and the general public on major matters relating to the work of WKCD, the Administration/WKCD should critically review the work and enhance the role of CP to ensure that it would fully and properly discharge its intended functions.**

CP plays the role of a bridge between the WKCD and the public. It is also a platform to reflect public expectations/views to the WKCD, as well as to promote WKCD with a view to enhancing public's understanding of the project.

Under the leadership of the new CP Chairman Professor John LEONG Chi-yan, the CP is critically reviewing its roles and functions, and has formed a task force led by the Chairman of CP to devise an engagement plan for gauging public views on the use and management of the Park.

The WKCD will continue to communicate with CP members on the progress of the project and solicit their views through both formal and informal channels as appropriate.

3. Financial situation of and arrangements for the WKCD project

At the Joint Subcommittee's request, WKCDA undertook to provide a copy of its audited statements of accounts for the past two financial years for the Joint Subcommittee's reference.

The audited statements of accounts are included in the Annual Reports which are available at WKCDA's website.

- Statement of Accounts for 2012/13:
http://wkcd-production.s3-website-ap-southeast-1.amazonaws.com/media/file/12_wkcd_eng_p_76_103.pdf
- Statement of Accounts for 2011/12:
http://wkcd-production.s3-website-ap-southeast-1.amazonaws.com/media/file/wkcd_eng_p112_135_chapter_10.pdf

4. Integration and connectivity of WKCD with its neighbouring districts

The Administration/WKCDA was requested to –

- (a) advise on its consultation plan (in particular the timetable)/mechanism with the Yau Tsim Mong (YTM) District Council as well as community leaders and/or residents of YTM District on matters relating to the connectivity of WKCD with its nearby areas;**

WKCDA plans to present the latest development of the WKCD project and its connectivity plan to YTM District Council in the first quarter of 2014. In addition, another connectivity workshop will also be arranged by WKCDA in the same quarter for the community leaders and/or residents of YTM District.

- (b) provide information on the pedestrian traffic forecasts of different planning horizons of WKCD (including when activities/performances were held at the arts and cultural facilities, e.g. the Xiqu Centre and the Mega Performance Venue), and a map showing the flows of visitors (with indication of directions of their flows) accessing/leaving various venues/facilities in WKCD; and**

The traffic consultant of WKCDA carried out a traffic study to project the pedestrian forecasts in WKCD for years 2020 and 2031. Figures 1 and 2 enclosed at **Annex** show the forecast peak pedestrian flows on various pedestrian corridors and footbridges assuming that the crowd will be dispersed within 30 minutes after events. It is indicated that all pedestrian corridors and footbridges will operate within capacity.

- (c) **advise whether consideration had been/would be given to providing full noise enclosure for the section of Nga Cheung Road adjacent to residential buildings (e.g. Sorrento) to mitigate the noise nuisance caused to nearby residents.**

The results of Environmental Impact Assessments conducted under the Environmental Impact Assessment Ordinance for the WKCD project and the road improvement project in West Kowloon indicated that the traffic noise impacts to the residents of the residential buildings along Nga Cheung Road (e.g. Sorrento) arising from these projects are not significant. Hence, no traffic noise impact mitigation measure is proposed under the above projects.

**Home Affairs Bureau
West Kowloon Cultural District Authority
November 2013**

Figure 1 2020 Forecast Pedestrian Flows during Dispersal Situation

圖一 2020年散場時人流預測

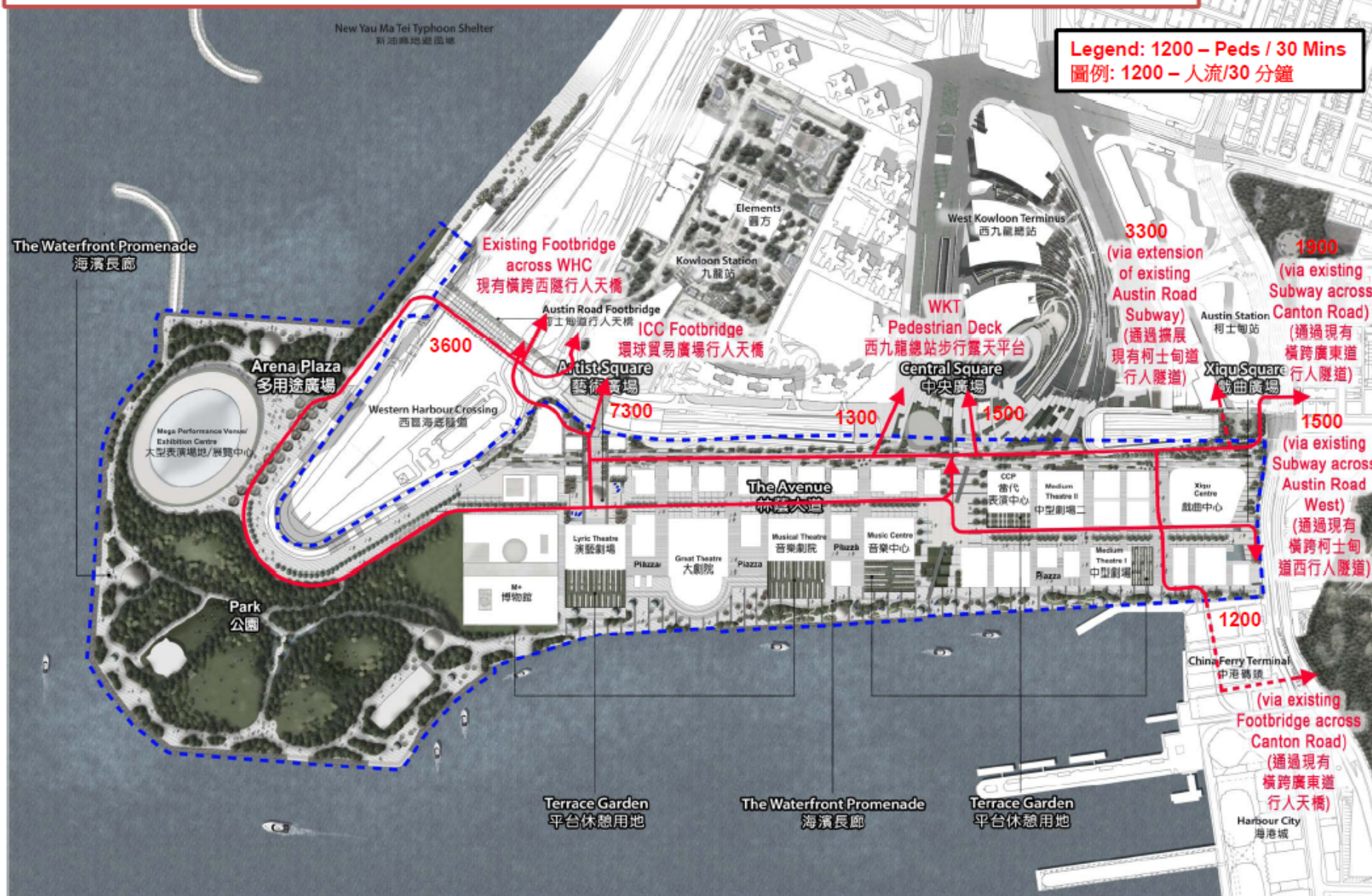

Figure 2 2031 Forecast Pedestrian Flows during Dispersal Situation

圖二 2031年散場時人流預測

