

WEST  
KOWLOON  
CULTURAL  
DISTRICT

西九文化區管理局  
West Kowloon Cultural District Authority

# Progress on Arts Pavilion

## 小型藝術展館的進展

24.01.2014

# Design Competition Process 建築設計比賽過程

- **Competition was launched on 27 September 2013.**  
設計比賽於2013年9月27日展開。
- **114 teams successfully registered.**  
114隊成功登記參賽。
- **100 submissions were received before the closing time at 12:00noon on 22 November 2013.**  
西九管理局於截止前，即2013年11月22日中午12時，共收到100份作品。
- **Design teams from local practices: 57 nos.**  
**Design teams of international composition: 43 nos.**  
來自本港的設計團隊：57隊。  
由香港及國際組成的設計團隊：43隊。

# Design Competition Process 建築設計比賽過程

- **Adjudication was held on 5 December 2013, with support of independent Quantity Surveying Consultant and WKCDA Management, and witness and support of the Independent Professional Advisor (Honorary), Professor Bernard LIM Wan-fung.**  
評審工作在獨立工料測量顧問及西九管理層支援下，於2013年12月5日進行，評審過程亦獲得獨立專業顧問（名譽）林雲峰教授提供見證和支援。

# Advisory / Adjudication Panel 顧問 / 評審委員會

## Co-Chairman 聯席主席

**Mr. Rocco YIM**  
嚴迅奇先生

Architect  
建築師

**Dr. Lars NITTVÉ**  
李立偉博士

Executive Director, M+, WKCDA  
西九文化區管理局M+行政總監

## Members 成員

**Mrs. Elizabeth CHENG**  
鄭曾靜英女士

Representative from the Hong Kong Institute of Architects  
香港建築師學會代表

**Mr. Raymond FUNG**  
馮永基先生

Member of Development Committee, WKCDA  
西九文化區管理局發展委員會成員

**Mr. LEUNG Chi Wo**  
梁志和先生

Member of Museum Committee, WKCDA  
西九文化區管理局博物館委員會成員

**Mr. WAN Man Leung**  
尹萬良先生

Representative from Home Affairs Bureau  
民政事務局代表

**Mr. Aric CHEN**  
陳伯康先生

Curator (Design and Architecture), M+, WKCDA  
西九文化區管理局M+策展人 (設計及建築)

## Reserve Juror 後備評審

**Dr. CHAN Man Wai**  
陳文偉博士

Executive Director, Project Delivery, WKCDA  
西九文化區管理局項目推展行政總監

# Winning Entries 冠、亞、季軍



## First Prize 冠軍

VPANG architects ltd + JET Architecture Inc + Lisa Cheung  
彭耀輝建築師事務所 (VPANG) + JET 建築事務所 + 張勵繡

# 1<sup>st</sup> Prize 冠軍

VPANG architects ltd + JET Architecture Inc + Lisa Cheung  
彭耀輝建築師事務所 (VPANG) + JET 建築事務所 + 張勵繡

## FLOATING ART PLATFORM 藝術浮萍



# 1<sup>st</sup> Prize 冠軍

VPANG architects ltd + JET Architecture Inc + Lisa Cheung  
彭耀輝建築師事務所 (VPANG) + JET 建築事務所 + 張勵繡

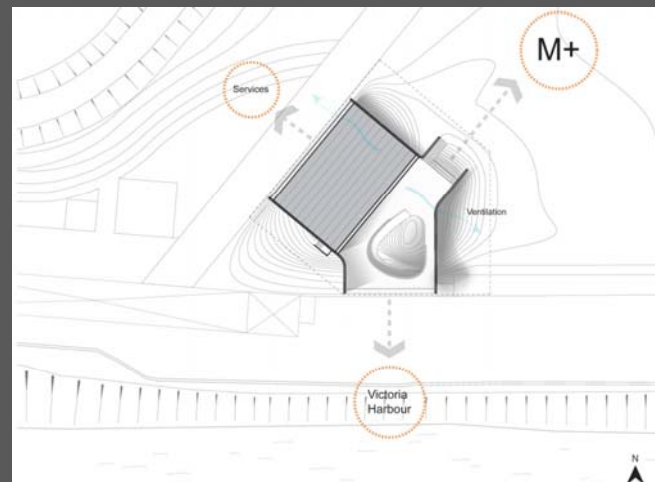

# 1<sup>st</sup> Prize 冠軍

VPANG architects ltd + JET Architecture Inc + Lisa Cheung  
彭耀輝建築師事務所 (VPANG) + JET 建築事務所 + 張勵繡

*“The winning pavilion is designed to offer a respite from hectic city life, and impressed the judges with a smart simplistic approach, which allows the Pavilion to blend into its surroundings.”*

*“獲選的展館設計平衡城市的繁囂，評審特別欣賞其巧妙及簡約的創意，使展館與周邊環境融和。”*

*“Mirrored external walls camouflage the architecture, reflecting the surrounding expanses of greenery and immersing the building within its Park setting. To further this experience, the pavilion’s main exhibition space is elevated, allowing it to float above the foliage, creating the opportunity for artwork to be appreciated against a backdrop of the Hong Kong Island skyline with spectacular views out over Victoria Harbour. The building is designed to be surrounded by natural light, away from noise. Inside, gallery spaces are created by polished concrete floors and white walls – a flexible backdrop for multidisciplinary art exhibitions and performances.”*

*“設計運用鏡面外牆，反映周邊園林，把建築主體融入自然環境中。設計同時把主要展覽空間升高，令建築空間懸浮在樹葉叢中，多一點陽光，少一點噪音，並讓訪客可在香港維多利亞港的景色前欣賞藝術品。內部的展覽空間以拋光混凝土樓板及白牆組成，可靈活地配合跨界別藝術展覽及表演。”*

*“The way the first prize winning design fitted into the landscape and frames the views of Hong Kong, creating an outdoor space, which easily flows into a well proportioned space, are merits of the design. It also allows for certain design flexibility and consideration, essential for a small-scale exhibition space like this.”*

*“冠軍設計的優勝之處在於設計與環境融合，其戶外空間將香港的景色盡收其中，空間處理恰到好處。設計亦兼顧功能上的考慮，使用者可靈活運用空間，這對於此類小型展覽場地至為重要。”*



# 2<sup>nd</sup> Prize 亞軍

ROGERSPARTNERS and Arthur C. S. Kwok Architects & Associates



# 3<sup>rd</sup> Prize 季軍

Hestia & Vish Limited

M+OAP M+Open Art Pavilion

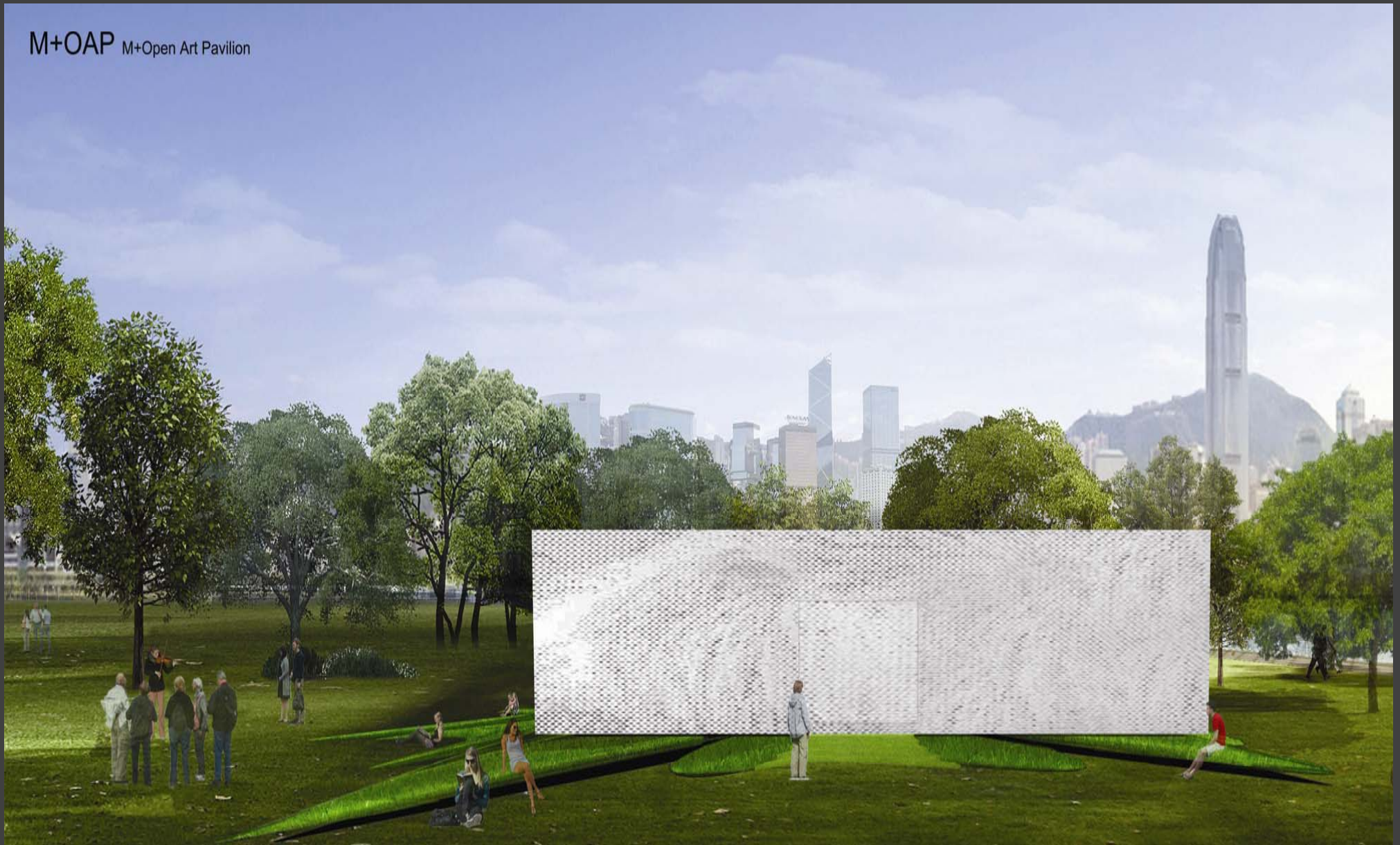

# Commendation Entries 優異獎



# Commendations 優異獎

Above: View from North-West to waterfront (artist: Choi Jeong Hwa)  
Middle: Ground Plan (1:200)  
Below: Section (1:200)



Matheson Whiteley and Andrew Lee King Fun  
& Associates Architects Ltd

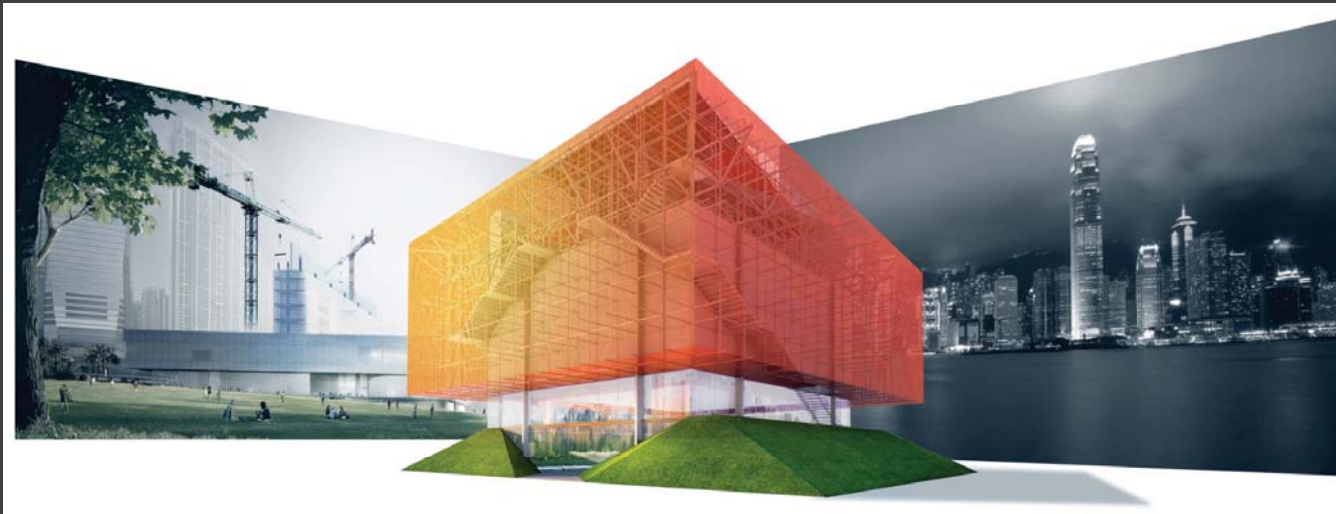

ESKYIU and LEAD

# Commendations 優異獎



O Studio Architects Limited  
with ARCA Limited



Jägnefält Milton with  
Leigh & Orange Ltd

# Commendations 優異獎

## The Raw and the Cooked

The perimeter wall is heavy in-situ concrete, planted with succulents. A distinctive triangular entrance, that can be seen across the bay, delivers visitors into the cooler garden courtyards and finally into the refined white spaces of the interior galleries. The full range raw natural environment to abstract idealised space is offered to artists and curators to work with whilst providing excellent security.

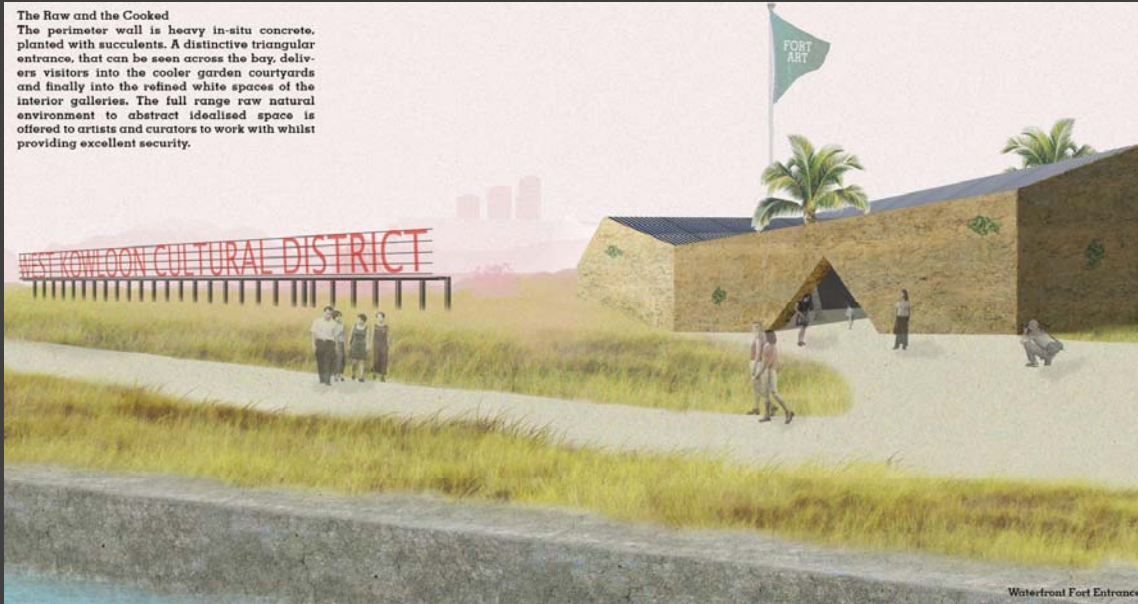

David Kohn Architects  
with TFP Farrells



Nina Lesser, Michel Chung,  
Man Hok Wai, Nic Banks, Glory Wang

**THANK YOU 謝謝**

West Kowloon Cultural District Authority