

WEST KOWLOON CULTURAL DISTRICT

西九文化區管理局

West Kowloon Cultural District Authority

Update on the Development of Xiqu Centre

戲曲中心發展的最新進展

28.03.2014

WKCD
XIQU CENTRE

西九文化區
戲曲中心







BT

A



RONALD LU
& PARTNERS

WKCD XIQU CENTRE
西九文化區戲曲中心

XIQU CENTRE
WEST KOWLOON CULTURAL DISTRICT

PHILOSOPHY BEHIND XIQU CENTRE DESIGN

戲曲中心的四大設計理念

- GATEWAY/PERFORMANCE PAVILION 大門與表演亭臺
- CHINESE COURTYARD 中式庭院
- NATURE AND URBAN LANDSCAPE 自然與城市景觀
- JOURNEY OF FLOW/QI 氣的流轉

GATEWAY/PERFORMANCE PAVILION

大門與表演亭臺



Amphitheatre along the river

沿河露天劇場



Pavilion/Courtyard

亭子/庭院

CHINESE COURTYARD

中式庭院



NATURE AND URBAN LANDSCAPE

自然與城市景觀



JOURNEY OF FLOW/QI

氣的流轉



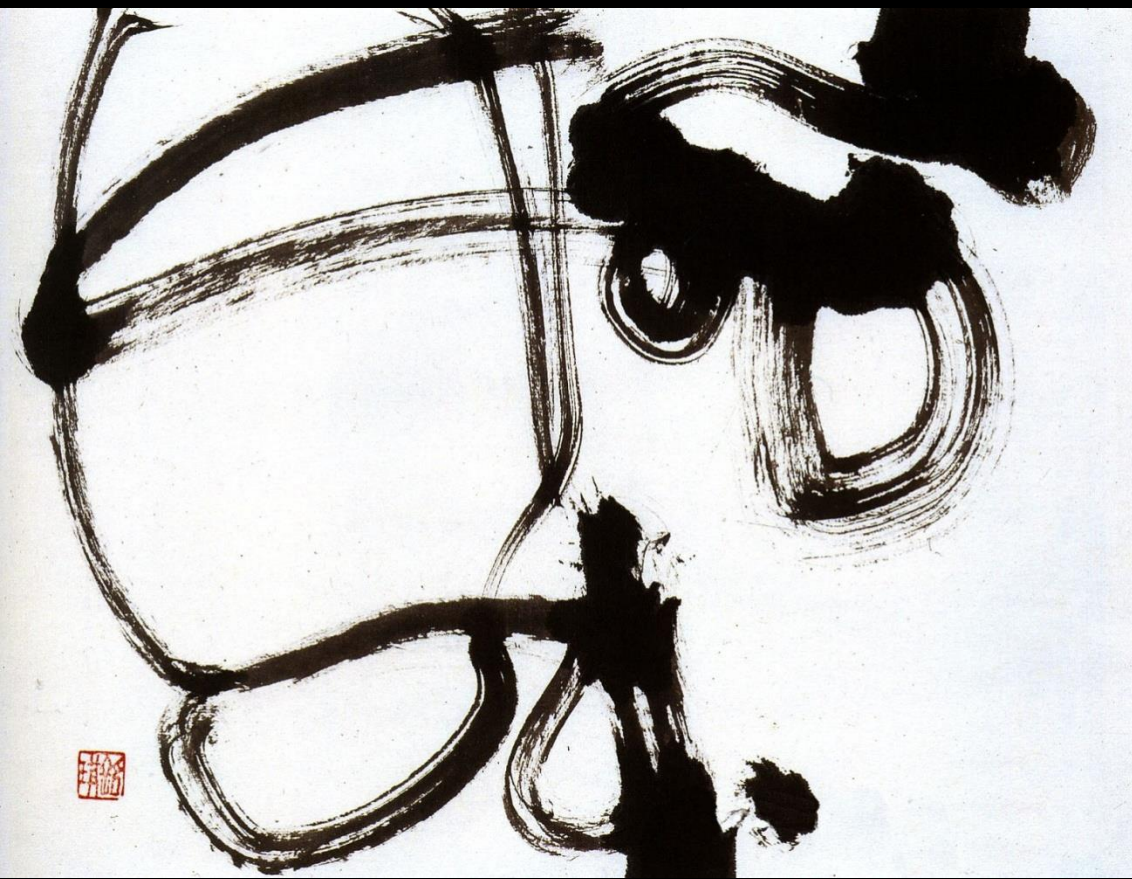

FACILITIES OF XIQU CENTRE 戲曲中心設施

- THEATRE/TEAHOUSE 戲曲劇場及茶館
- ARTS EDUCATION FACILITIES 藝術教育設施
- REHEARSAL & TRAINING SPACE 綵排及訓練空間
- ADMINISTRATION SPACE 行政辦公空間
- RETAIL/DINING/ENTERTAINMENT FACILITIES 零售/餐飲/消閒設施

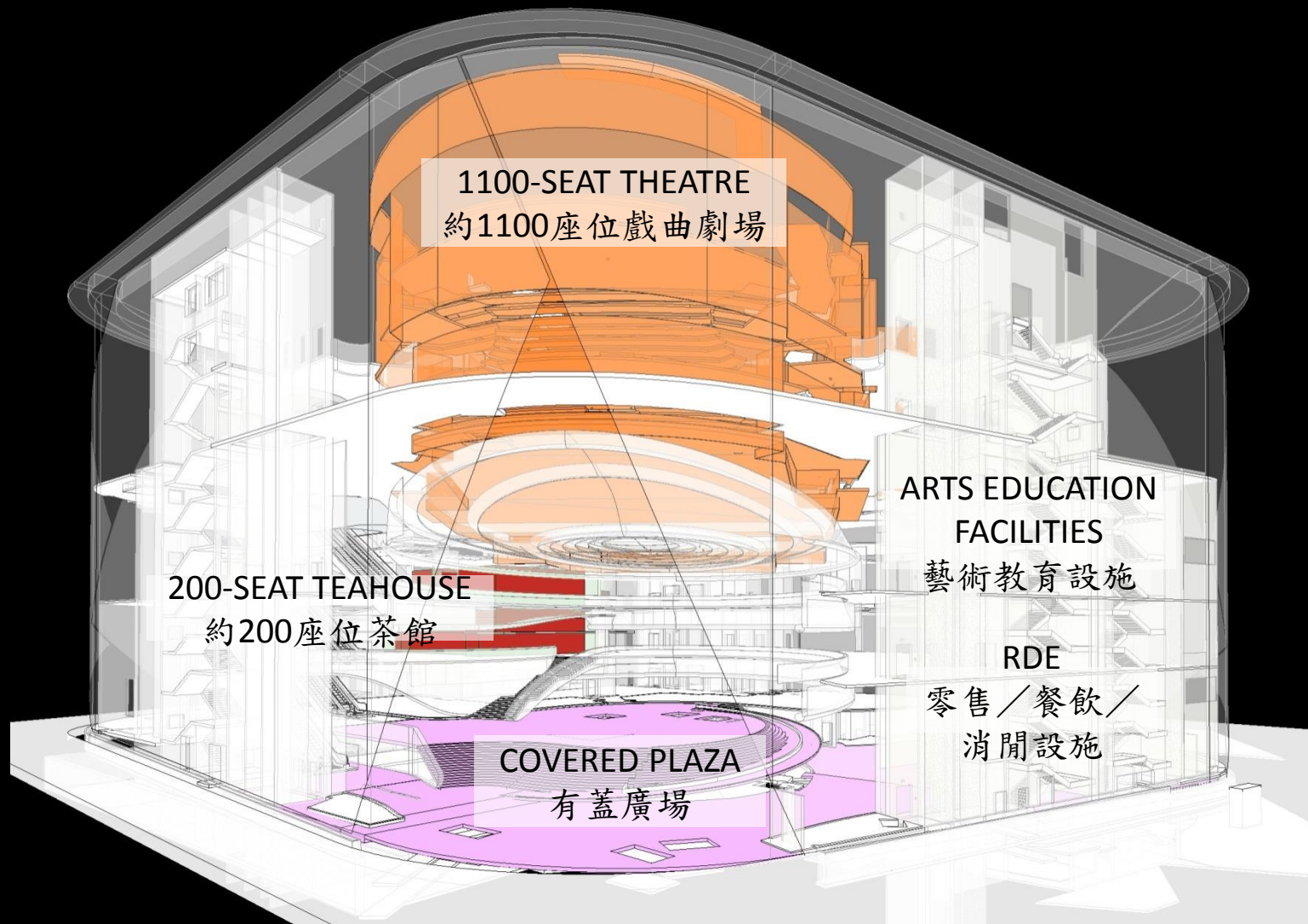

1100-SEAT THEATRE
約1100座位戲曲劇場

200-SEAT TEAHOUSE
約200座位茶館

COVERED PLAZA
有蓋廣場

ARTS EDUCATION
FACILITIES
藝術教育設施

RDE
零售／餐飲／
消閒設施

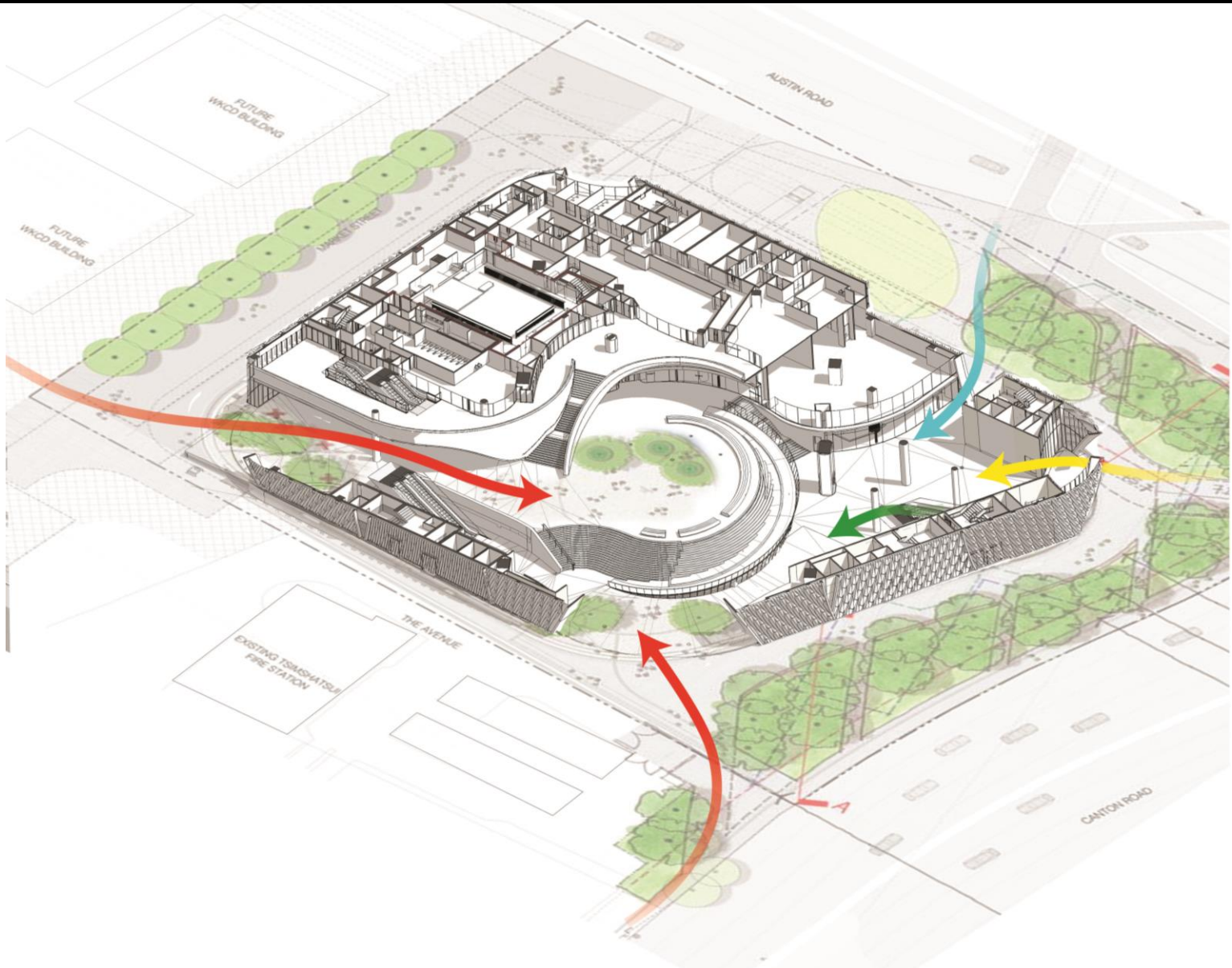





Retaining Wall

EVA Route

Seatwall

Tree Flush with Surface

Planting Flush with Surface

Railing and Retaining Wall

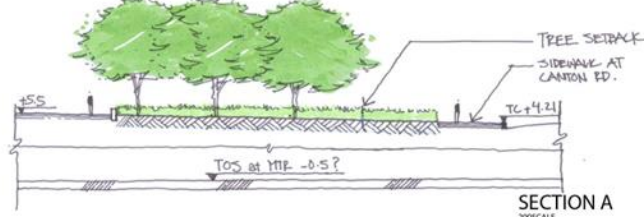

SECTION A
200SCALE

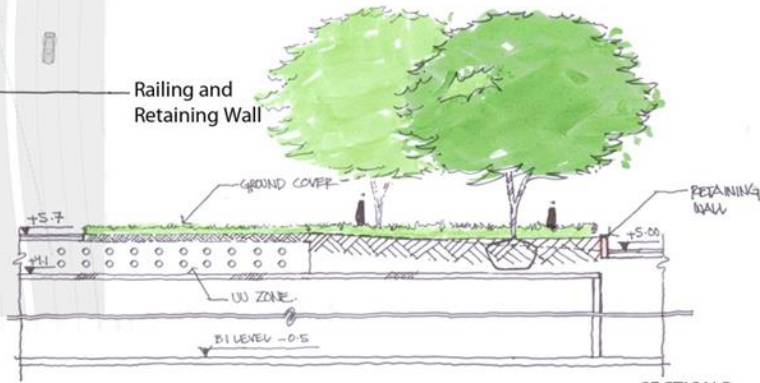

SECTION B
100SCALE

PLAN
400 SCALE

URBAN DESIGN OPTION 1
131104













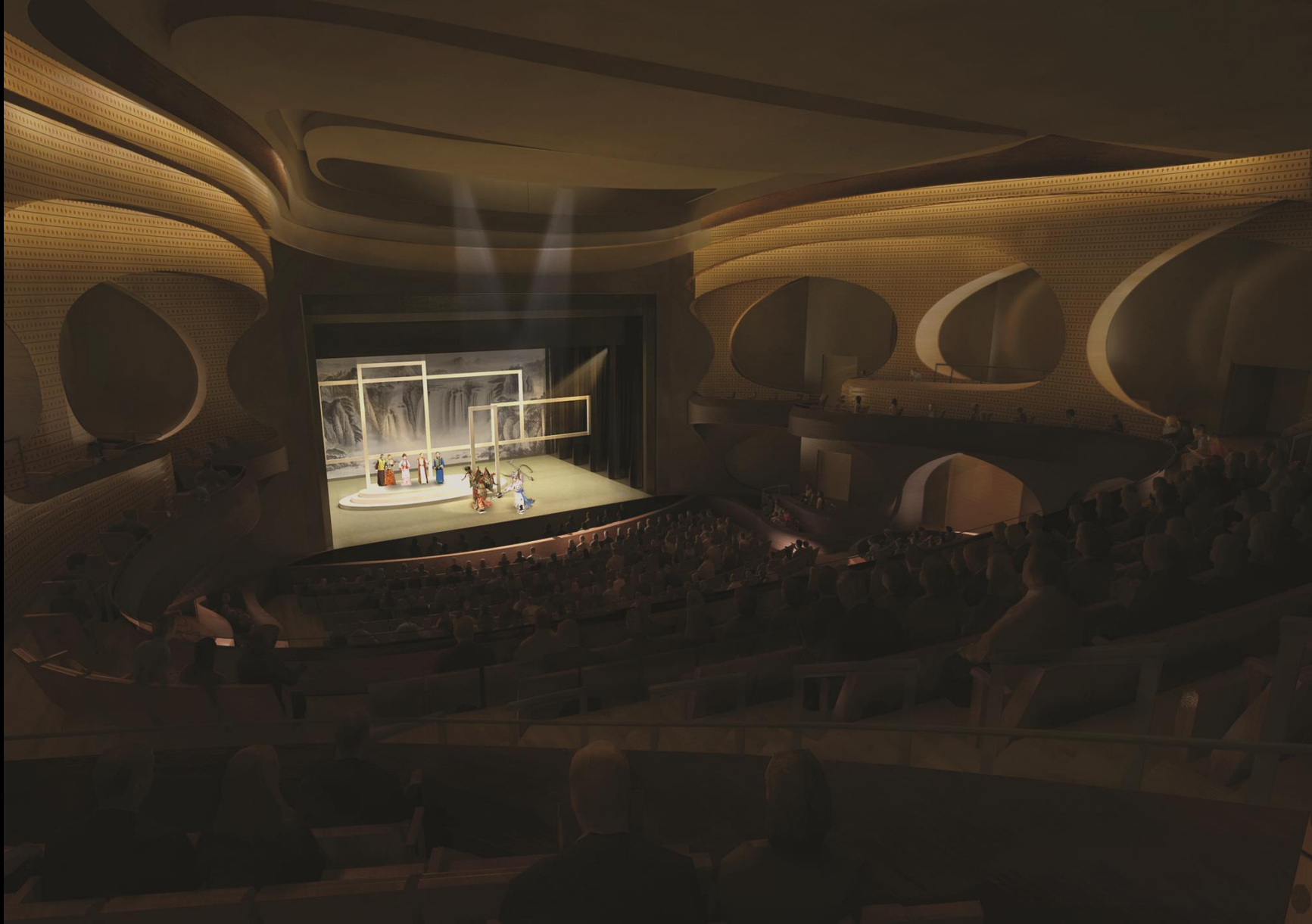

TEA HOUSE MOCK-UP 茶館劇場模擬體驗

6-7.3.2014



TEA HOUSE MOCK-UP 茶館劇場模擬體驗

6-7.3.2014



THANK YOU

謝謝