



THE UNIVERSITY OF HONG KONG
Academic Building at No.3 Sassoon Road
香港大學 沙宣道3號教學樓

May 2017





Queen Mary Hospital

瑪麗醫院

HKU Student Hostels

香港大學學生宿舍

Site 工地

HK Jockey Club Building for
Interdisciplinary Research

香港賽馬會跨學科研究大樓

Dexter H.C. Man Building

文洪磋大堂

Queen Mary Hospital 瑪麗醫院



HKU Student Hostels 香港大學學生宿舍



HK Jockey Club Building for
Interdisciplinary Research
香港賽馬會跨學科研究大樓



Dexter H.C. Man Building
文洪磋大堂

SITE PLAN 工地平面圖

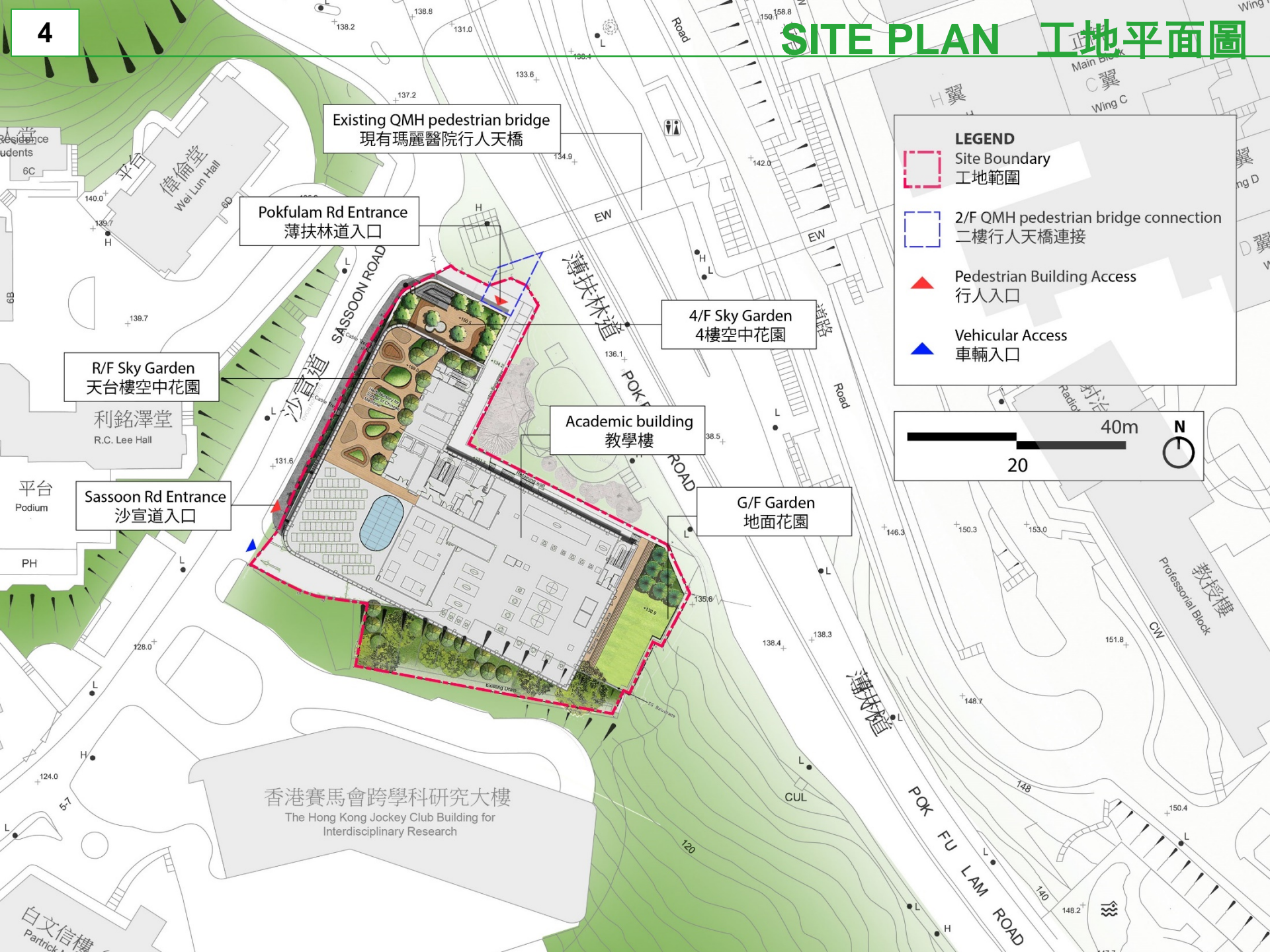

LEGEND

- Site Boundary
工地範圍
- 2/F QMH pedestrian bridge connection
二樓行人天橋連接
- ▲ Pedestrian Building Access
行人入口
- ▲ Vehicular Access
車輛入口

40m
20

N

R/F Sky Garden
天台樓空中花園

利銘澤堂
R.C. Lee Hall

Sassoon Rd Entrance
沙宣道入口

Existing QMH pedestrian bridge
現有瑪麗醫院行人天橋

Pokfulam Rd Entrance
薄扶林道入口

4/F Sky Garden
4樓空中花園

Academic building
教學樓

G/F Garden
地面花園

香港賽馬會跨學科研究大樓
The Hong Kong Jockey Club Building for
Interdisciplinary Research

白文信樓
Patrick

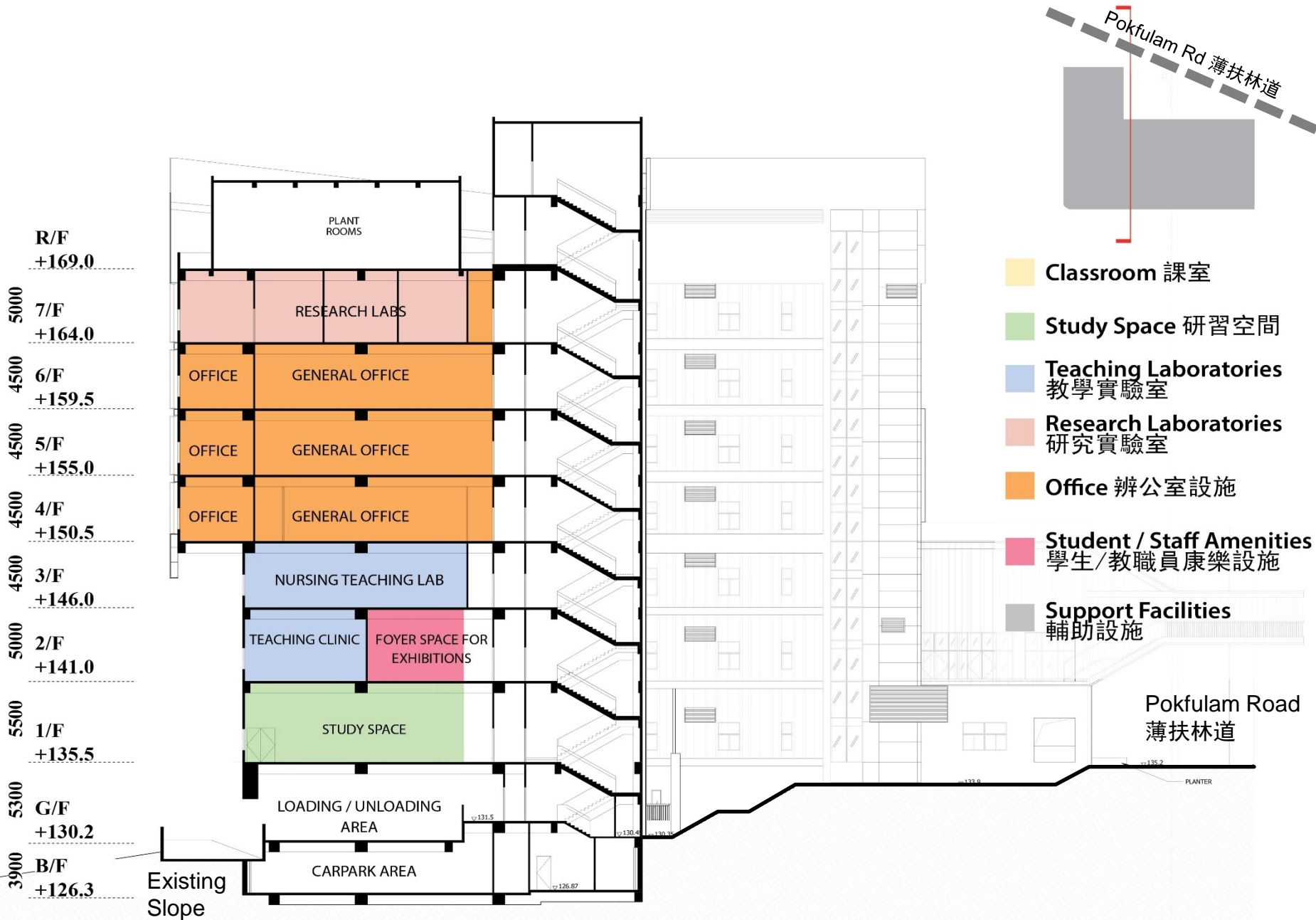

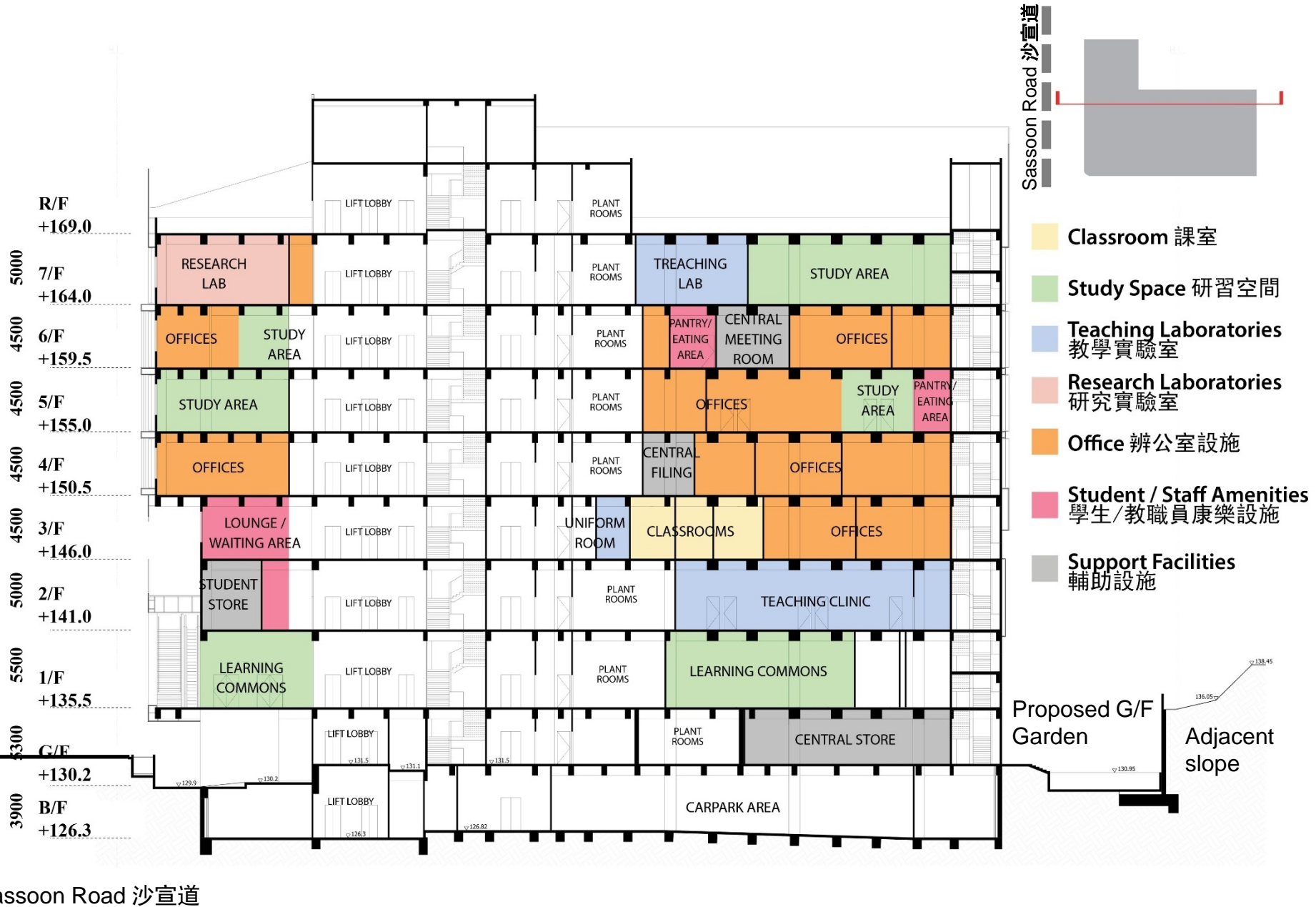

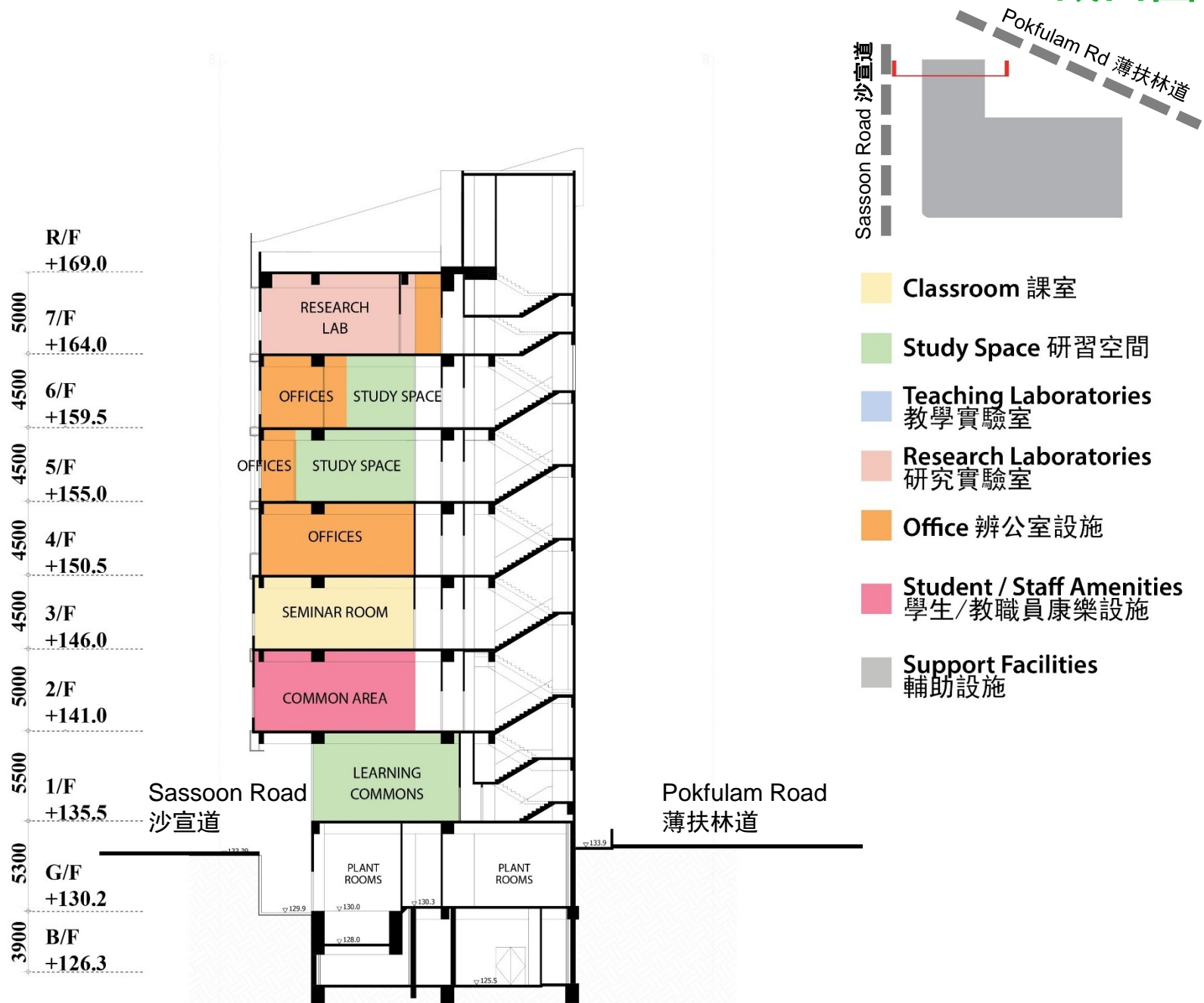

- To provide a new academic building for the Li Ka Shing (LKS) Faculty of Medicine currently stationed at the Patrick Manson Building, Pauline Chan Building and Estates Building along Sassoon Road.
為目前位於沙宣道的白文信樓，陳蕉琴樓及物業處大樓的李嘉誠醫學院提供一個新教學樓。
- To support the substantial growth in staff and student populations
支持大幅增長的員工及學生的需要
- To provide proliferation and advancement of research programmes and activities
推動科研及相關活動發展

- To meet the demand for space and infrastructure to support teaching and research which has far outgrown the capacity of these low-rise low-density buildings now equipped with outdated building systems.

現時的低密度建築群層數較少，設計不合時宜，且使用量已飽和。新教學樓可提供足夠的空間及基礎設施，以滿足教學及研究需求。

- To align with current and future development of the LKS Faculty of Medicine Building's needs, new buildings with updated provisions will be required.

為配合李嘉誠醫學院的長遠發展和空間的需求，須提供教學及研究所需的設施。

Entrances at Sassoon Road and Pokfulam Road

位於沙宣道及薄扶林道的地面入口

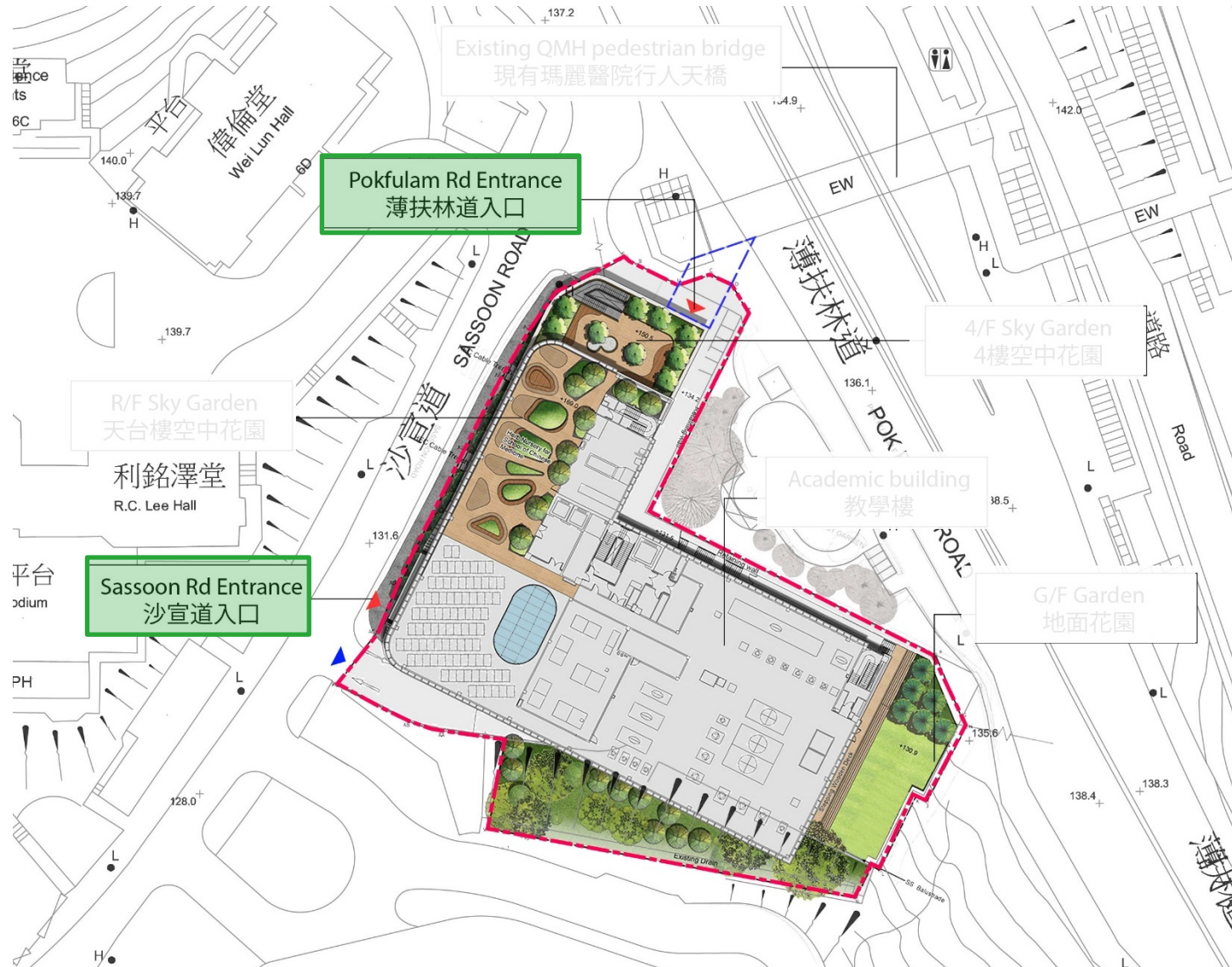

Link Bridge Connection providing connectivity between existing QMH bridge and 2/F of the proposed building.

連接橋提供從瑪麗醫院行人橋到教學樓二樓的行人連接。

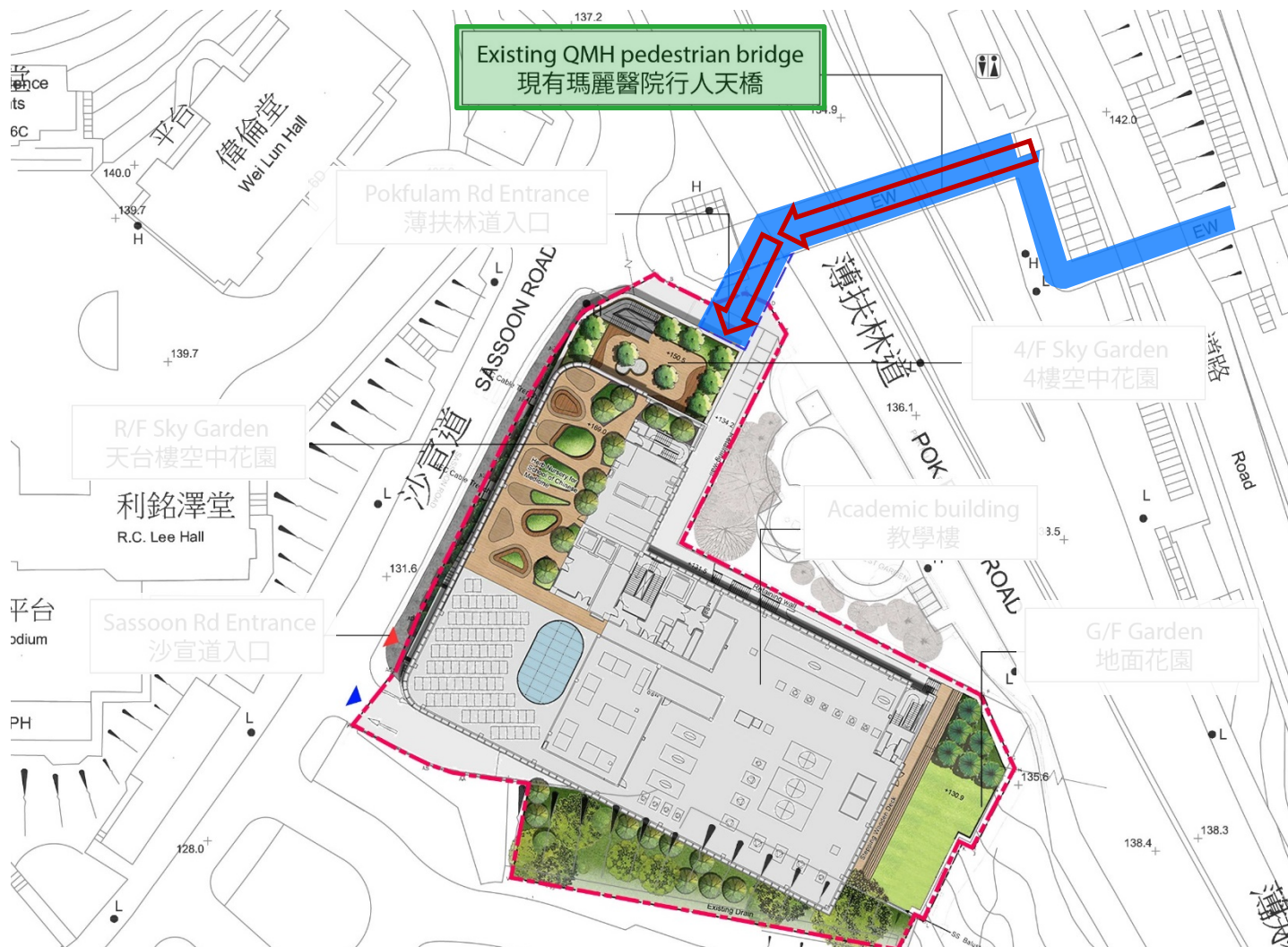



從西南面（沙宣道）望向教學樓
View of academic building from southwest (Sassoon Road)



從西北面（薄扶林道）望向教學樓
View of academic building from northwest (Pokfulam Road)



從東北面（薄扶林道）望向教學樓
View of academic building from northeast (Pokfulam Road)

Garden and sky gardens are provided at G/F, 4/F and R/F
 在地面，四樓及天台的花園及空中花園

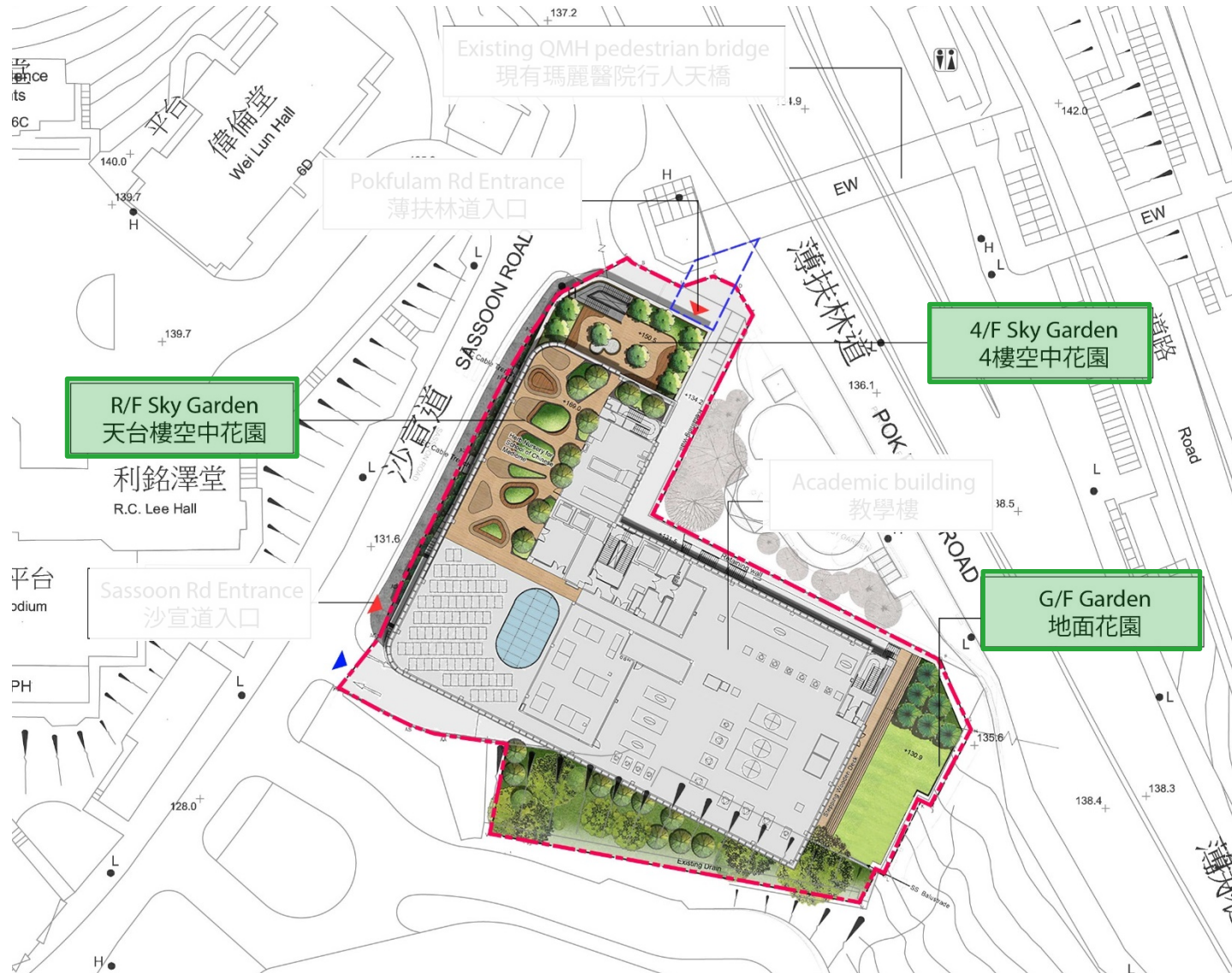

Wall climbers are proposed along key facades to soften the outlook of the building and to complement surrounding environment

善用垂直綠化以軟化建築的外觀及融合周邊自然環境

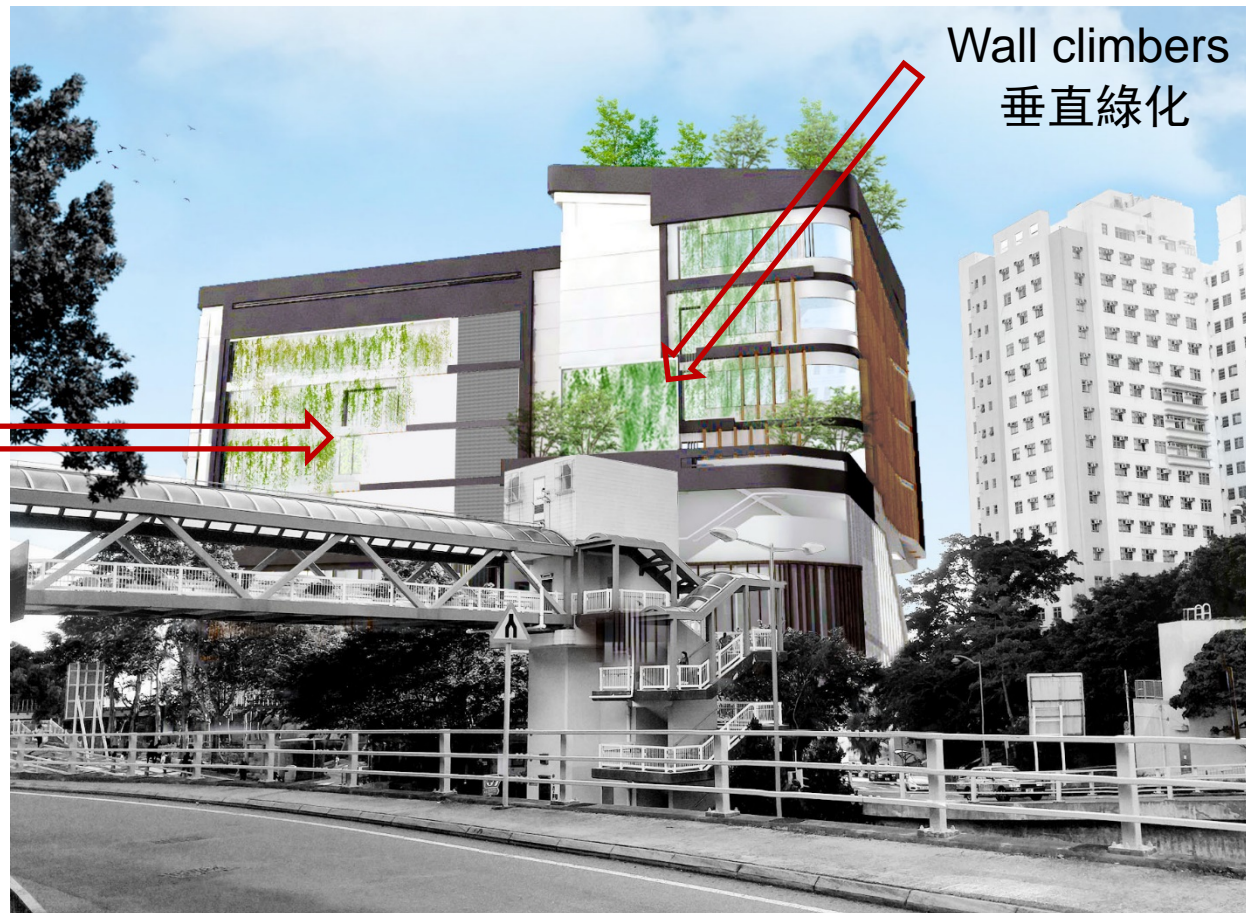

Wall climbers
垂直綠化

Wall climbers
垂直綠化

The latest estimated cost of the project is \$840.1 million in money-of-the-day prices.

整項工程計劃的最新估計費用為8.401億元(以付款當日價格計算)

Education Panel

15 May 2017

立法會教育事務委員會審議

PWSC and FC

Mid 2017

立法會工務小組委員會及財務委員會審議

Anticipated Main Contract Award and Project Commencement

September 2017

計劃工程展開

Anticipated Project Completion1st Quarter 2021計劃工程完成



THE UNIVERSITY OF HONG KONG
Academic Building at No.3 Sassoon Road
香港大學 沙宣道3號教學樓

May 2017