

Legislative Council
Panel on Development and Panel on Home Affairs
Joint Subcommittee to Monitor the Implementation of the
West Kowloon Cultural District Project

Implementation of the Infrastructure Works for
West Kowloon Cultural District, Phase 1

立法會發展事務委員會與民政事務委員會
監察西九文化區計劃推行情況聯合小組委員會

推展西九文化區基礎建設工程第一期

754CL(part) Infrastructure Works for WKCD, phase 1 – Second Construction Package

754CL工程計劃(部分)西九文化區基礎建設工程第一期 – 第二組建造工程

Existing Austin Road Pedestrian Subway
現有柯士甸道行人隧道

Proposed Covered Footbridge
擬議有蓋行人天橋



Kowloon
Station
九龍站

Austin
Station
柯士甸站

Artist Square
Development Area
藝術廣場發展區

Art Park
藝術公園

Xiqu Centre
戲曲中心

754CL(part) Infrastructure Works for WKCD, phase 1 – Second Construction Package

754CL工程計劃(部分)西九文化區基礎建設工程第一期 – 第二組建造工程

	Scope of Works 工程範圍
(a)	Main section of Artist Square Bridge of about 69 metres (m) long, with a clear width of about 7 m, with two lifts and two covered staircases, spanning across Austin Road West 藝術廣場天橋主段工程，包括一段橫跨柯士甸道西長約69米、淨闊度約7米的有蓋行人天橋、兩部升降機及兩條有蓋樓梯
(b)	Beautification works for existing pedestrian subway at junction of Austin Road West and Canton Road 位於柯士甸道西和廣東道交界處現有行人隧道的美化工程
(c)	Associated road works and ancillary works 相關道路工程和附屬工程

Main section of Artist Square Bridge

藝術廣場天橋主段工程



圖例 LEGEND :

- 施工區界限 LIMIT OF WORKS AREA
- 酒店 辦公室及住宅發展及其他文化藝術設施 HOTEL, OFFICE AND RESIDENTIAL DEVELOPMENT AND OTHER ARTS AND CULTURAL FACILITIES

主段 MAIN SECTION

- 擬建有蓋行人天橋 PROPOSED COVERED FOOTBRIDGE
- 擬建有蓋樓梯 PROPOSED COVERED STAIRCASE
- 擬建升降機 PROPOSED LIFT
- 擬建水平(約數) PROPOSED LEVEL (APPROXIMATE)
- 連接現有發展項目 CONNECTIONS TO THE EXISTING DEVELOPMENT
- 連接現有行人路 CONNECTIONS TO THE EXISTING FOOTPATH

餘段 REMAINING SECTION

- 擬建有蓋行人天橋 PROPOSED COVERED FOOTBRIDGE
- 擬建有蓋樓梯 PROPOSED COVERED STAIRCASE
- 擬建有蓋自動扶梯 PROPOSED COVERED ESCALATOR
- 連接將來發展項目 CONNECTIONS TO THE FUTURE DEVELOPMENT

鄰近發展項目提供的24小時開放現有通道
EXISTING ROUND-THE-CLOCK ACCESS PROVIDED BY ADJOINING DEVELOPMENT

鄰近發展項目提供的現有升降機
EXISTING LIFT PROVIDED BY ADJOINING DEVELOPMENT

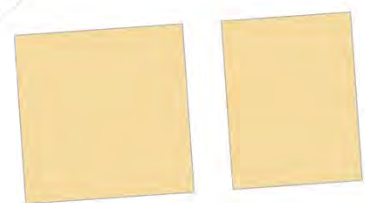

M+ 博物館

西九文化區(藝術廣場發展區)
WEST KOWLOON CULTURAL DISTRICT
(ARTIST SQUARE DEVELOPMENT AREA)

演藝綜合劇場
LYRIC THEATRE COMPLEX

大劇院
GREAT THEATRE

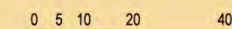

754CL(part) Infrastructure Works for WKCD, phase 1 – Second Construction Package

754CL工程計劃(部分)西九文化區基礎建設工程第一期 – 第二組建造工程



擬建行人天橋西立面構想圖 VIEW OF WESTERN SIDE OF PROPOSED FOOTBRIDGE

754CL(part) Infrastructure Works for WKCD, phase 1 – Second Construction Package

754CL工程計劃(部分)西九文化區基礎建設工程第一期 – 第二組建造工程



擬建行人天橋東立面構想圖 VIEW OF EASTERN SIDE OF PROPOSED FOOTBRIDGE

754CL(part) Infrastructure Works for WKCD, phase 1 – Second Construction Package

754CL工程計劃(部分)西九文化區基礎建設工程第一期 – 第二組建造工程



天橋內部構想圖VIEW FROM DECK LEVEL

754CL(part) Infrastructure Works for WKCD, phase 1 – Second Construction Package

754CL工程計劃(部分)西九文化區基礎建設工程第一期 – 第二組建造工程

Beautification works for existing Austin Road Pedestrian Subway

現有柯士甸道行人隧道的美化工程

圖例 LEGEND:

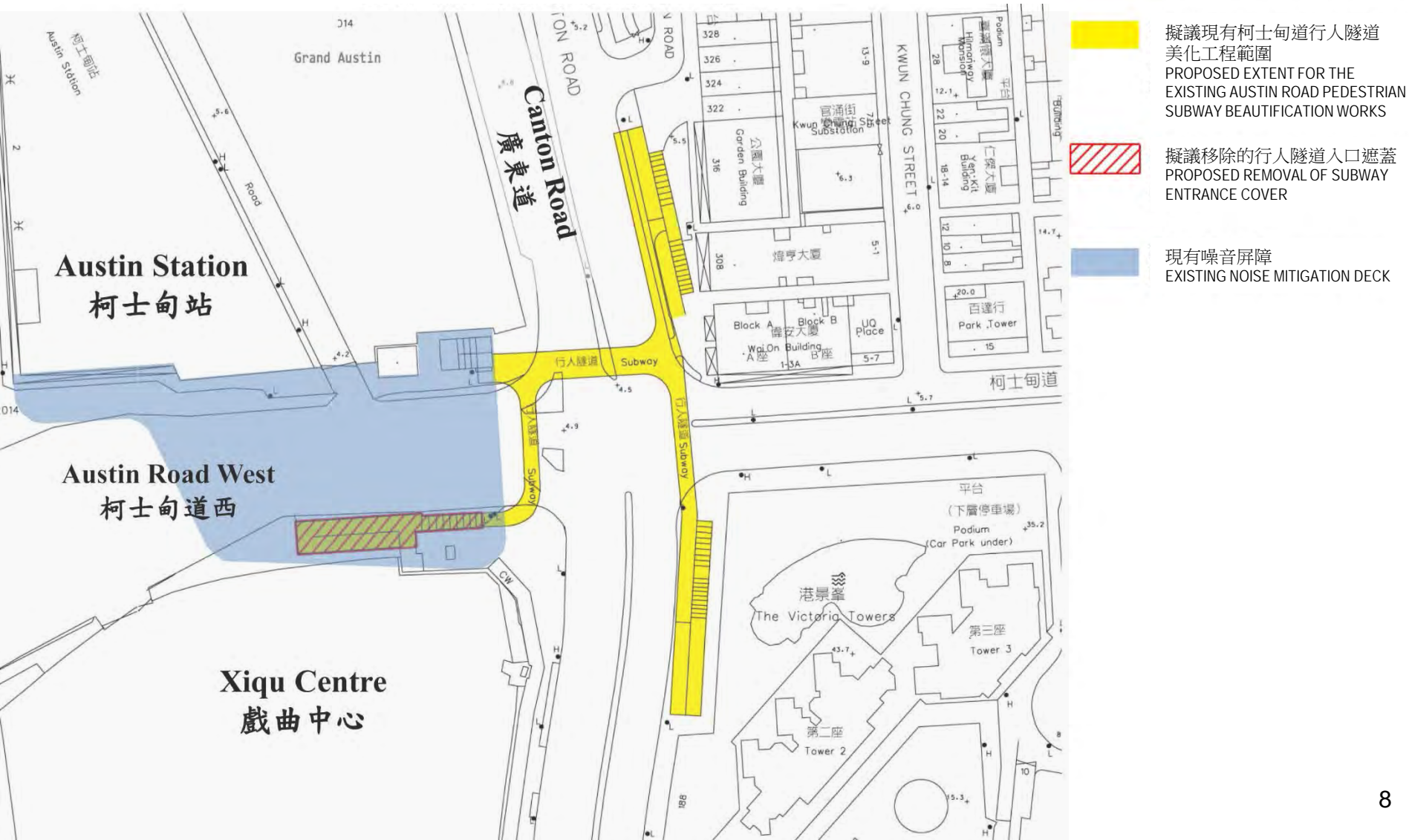

WKCD
Coastline
西九文化區的
海岸線

Silhouette of
windows
窗戶剪影

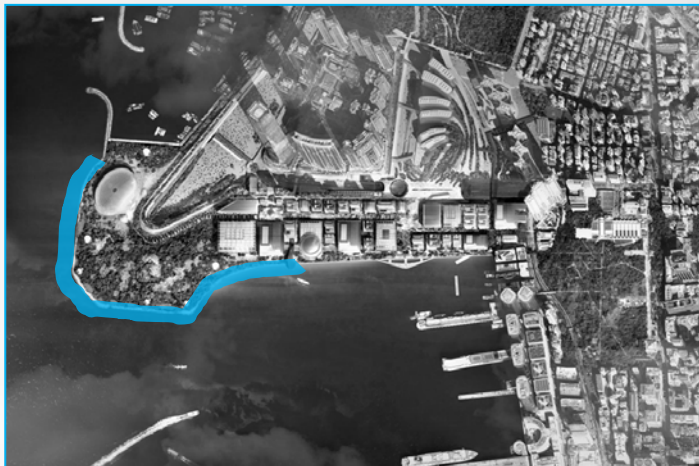

The metaphor of the WKCD Coastline,
overlaid with silhouette of windows from
high-rise building blocks
象徵西九文化區的海岸線及
高層建築物窗戶的剪影重疊

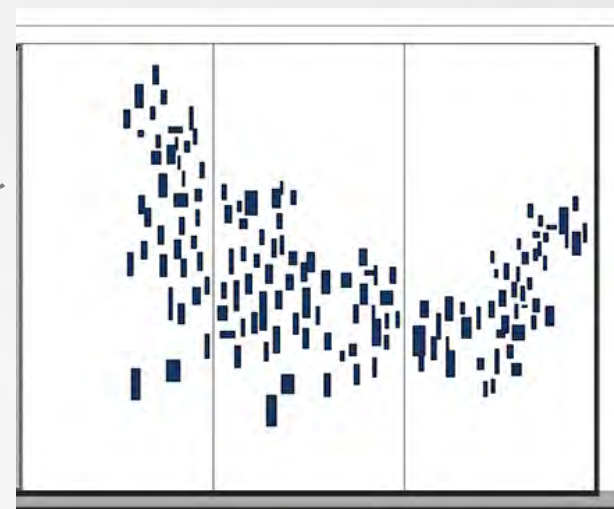

Elevation of thematic cladding
特色飾面板的立面

Identity Design Concept 特色設計概念

Interior of Austin Road Pedestrian Subway – Existing Condition

柯士甸道行人隧道內-現時狀況



Interior of Austin Road Pedestrian Subway – After Beautification Works

柯士甸道行人隧道內-美化工程完成後



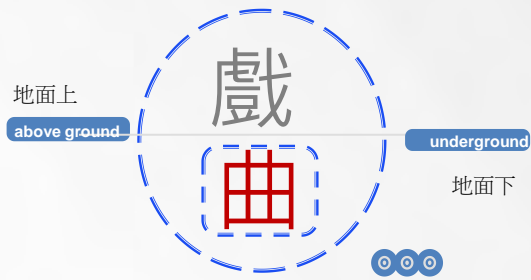

參考廣泛用於戲曲「序幕」的敲擊樂器為隧道設計的主題。
Using percussion musical instruments as the identity of the subway. Percussion instruments are usually used as a prologue into a Chinese Opera.



木魚 Muyu
大鑼 Gong
鼓 Drum
鈸 Cymbal

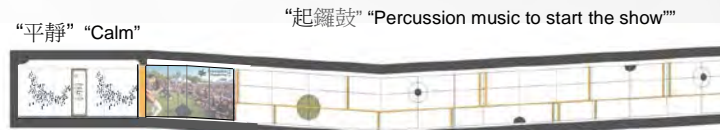

柯士甸道行人隧道
Austin Road Pedestrian Subway

隧道連接戲曲中心
Subway to Xiqu Centre

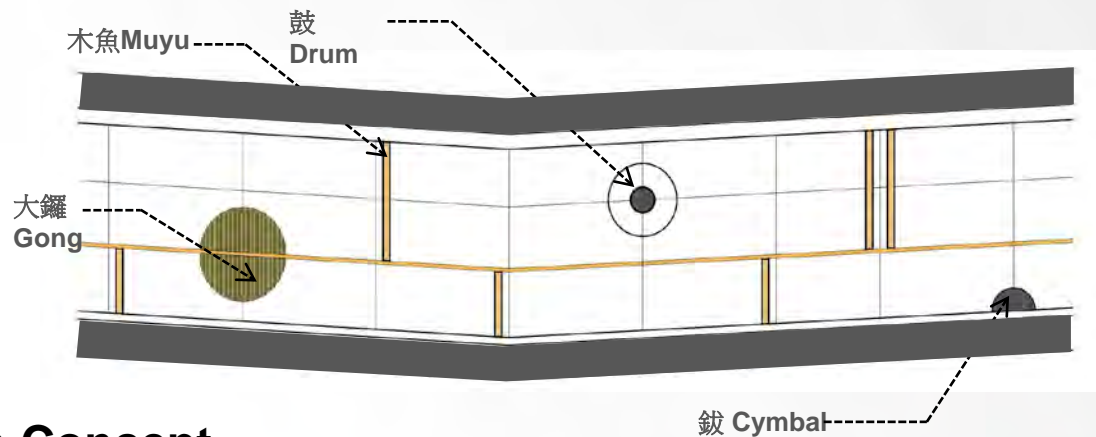

Identity Design Concept 特色設計概念

Interior of Austin Road Pedestrian Subway – Existing Condition

柯士甸道行人隧道內-現時狀況



Interior of Austin Road Pedestrian Subway – After Beautification Works

柯士甸道行人隧道內-美化工程完成後

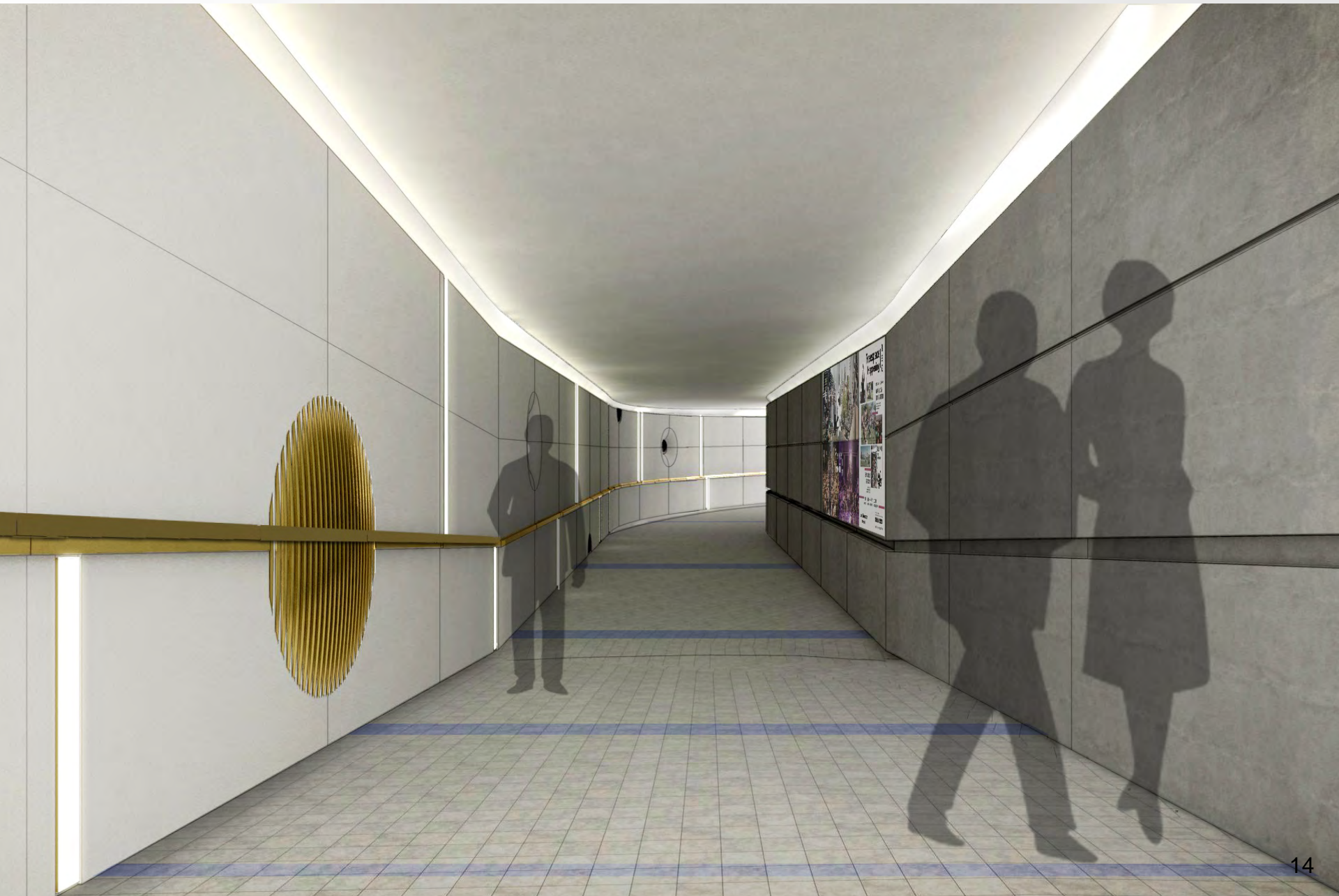

Austin Road Pedestrian Subway Entrance near The Victoria Towers – Existing Condition

柯士甸道行人隧道近港景峯入口-現時狀況



Austin Road Pedestrian Subway Entrance near The Victoria Towers – After Beautification Works

柯士甸道行人隧道近港景峯入口-美化工程完成後



Austin Road Pedestrian Subway Entrance near KGV Memorial Park, Kowloon – Existing Condition

柯士甸道行人隧道近九龍佐治五世紀念公園入口-現時狀況



Austin Road Pedestrian Subway Entrance near KGV Memorial Park, Kowloon – After Beautification Works
柯士甸道行人隧道近九龍佐治五世紀念公園入口-美化工程完成後



Austin Road Pedestrian Subway Entrance at Xiqu Centre – Existing Condition

柯士甸道行人隧道戲曲中心入口-現時狀況



Austin Road Pedestrian Subway Entrance at Xiqu Centre – After Beautification Works

柯士甸道行人隧道戲曲中心入口-美化工程完成後



- Members of the Traffic and Transport Committee and the Food, Environmental Hygiene and Public Works Committee of the Yau Tsim Mong District Council supported in principle the proposed works
- 油尖旺區議會的交通運輸委員會和食物環境衛生及工務委員會的委員原則上支持擬議工程
- The aesthetic design of the proposed works has been accepted by the Advisory Committee on the Appearance of Bridges and Associated Structures (ACABAS)
- 擬議工程的外觀設計已獲得橋樑及有關建築物外觀諮詢委員會接納

Estimated Cost

預計費用

Second construction package of infrastructure works under **754CL(part)**
754CL工程計劃(部分)基礎建設工程第二組建造工程

項目 Items	預計費用* (百萬元) Estimated Cost* (\$ million)
藝術廣場天橋主段工程 Artist Square Bridge main section	290
行人隧道的美化工程 Beautification works for existing subway	35
相關的道路工程、附屬工程及環境緩解措施 Associated road works, ancillary works and environmental mitigation measures	20
管理局的內部管理費用、顧問費及駐工地人員薪酬 WKCDA's in-house management cost, Consultants' fees and Remuneration of RSS	35
應急費用價格調整準備 Contingencies and Price adjustment	110
合共Total	490

* 除「價格調整準備」和「合共」兩數值按付款當日價格計算外，上述數值以2016年9月價格計算
Except "Price adjustment" and "Total" above which are in money-of-the-day prices, figures above are in Sep-16 prices

Advice Sought

徵求意見

Members are invited to note and provide views on the proposed part-upgrading of **754CL** to Category A

請委員備悉提升部分**754CL**為甲級的建議，並歡迎委員提供意見