

LEGISLATIVE COUNCIL BRIEF

Shipping and Port Control Regulations (Cap. 313A)

and

Merchant Shipping (Local Vessels) (General) Regulation (Cap. 548F)

Legislative Amendments for Imposing Conditions on Vessels Navigating in the Vicinity of the Hong Kong-Zhuhai-Macao Bridge

INTRODUCTION

With the completion of the Hong Kong-Zhuhai-Macao Bridge (“HZMB”), we need to take measures to regulate the nearby marine traffic by amending the Shipping and Port Control Regulations (Cap. 313A) (“SAPCR”) and the Merchant Shipping (Local Vessels) (General) Regulation (Cap. 548F)¹.

2. At the meeting of the Executive Council on 9 May 2017, the Council ADVISED and the Chief Executive ORDERED that, under section 80 of the Shipping and Port Control Ordinance (Cap. 313), the Shipping and Port Control (Amendment) Regulation 2017, at **Annex A**, should be made to impose restrictions on the height, length and navigational direction of vessels passing through the navigation channels of the two link roads of HZMB.

¹ SAPCR applies to all vessels (except local vessels) in Hong Kong or Hong Kong waters. The Merchant Shipping (Local Vessels) (General) Regulation applies to local vessels.

3. To extend the aforementioned restrictions to local vessels, the Secretary for Transport and Housing has made the Merchant Shipping (Local Vessels) (General) (Amendment) Regulation 2017, at **Annex B**, under section 89 of the Merchant Shipping (Local Vessels) Ordinance (Cap. 548).

4. The Director of Marine has made the Shipping and Port Control Regulations (Amendment of Fifth Schedule) Notice 2017, at **Annex C**, under section 72(1) of the SAPCR, to reflect the updated boundaries of the Hong Kong International Airport Approach Areas (“HKIAAAs”) within which vessels exceeding the stipulated height restrictions are not allowed.

JUSTIFICATIONS

5. HZMB links Hong Kong, Zhuhai and Macao. It consists of a Main Bridge in Mainland waters together with boundary crossing facilities and link roads in the three places. There are two link roads in Hong Kong waters, i.e. the Hong Kong Link Road (“HKLR”) connecting the Hong Kong Boundary Crossing Facilities (“HKBCF”) to the Main Bridge, and the Tuen Mun-Chek Lap Kok Link (“TM-CLKL”) linking HKBCF with Northwest New Territories and North Lantau. A map showing the two link roads of HZMB is at **Annex D**.

6. Underneath these two link roads, there are a number of navigation channels for vessels to pass through. To ensure navigation safety, restrictions on the dimensions of vessels sailing through are necessary.

7. In addition, eight HKIAAAs have been set up to regulate the vessels navigating in the vicinity of the Hong Kong International Airport (“HKIA”). Restrictions on the height of vessels in areas that can pass through range from 15 metres to 30 metres. Due to the construction of the HZMB, part of the waters

near the HKIA has been reclaimed for constructing the HKLR and the HKBCF. The coordinates thus need to be amended to reflect the updated boundaries of the HKIAAs.

LEGISLATIVE PROPOSALS

8. For TM-CLKL, three groups of restricted areas will be established along its Southern Connection. The proposed height limits of the three groups are 21, 12 and 6 metres respectively. Details of the proposed restricted areas are shown at **Annex E**.

9. For HKLR, four groups of restricted areas will be established. Having regard to marine traffic and the height of the viaduct, the proposed height limits for the four groups are 41, 12, 10 and 5 metres respectively. Details of the proposed restricted areas of HKLR are shown at **Annex F** (portion in Western waters) and **Annex G** (portion adjacent to the Airport) respectively.

10. Within the restricted area with height restriction of 41 metres along HKLR (i.e. the navigation channels underneath the three highest arches), three special areas will be set up to segregate the vessels travelling in opposite directions. Special Area No. 1 will be designated for southbound traffic while Special Area No. 2 for northbound traffic. Special Area No. 3 will be set up between these two areas to separate the two one-way channels. Only small vessels not exceeding 10 metres in length can sail through Special Area No. 3. This arrangement is modelled on the one-way traffic measure adopted for Kap Shui Mun Bridge.

THE REGULATIONS

Shipping and Port Control (Amendment) Regulation 2017

11. The Regulation will amend the SAPCR to impose restrictions on the height, length and navigational direction of vessels passing through the navigation channels of the two link roads.

Merchant Shipping (Local Vessels) (General) (Amendment) Regulation 2017

12. The Regulation will amend the Merchant Shipping (Local Vessels) (General) Regulation (Cap. 548F) to impose restrictions on the height, length and navigational direction of local vessels passing through the navigation channels of the two link roads.

Shipping and Port Control Regulations (Amendment of Fifth Schedule) Notice 2017

13. The Notice will amend the SAPCR to effect changes on the coordinates of the boundaries of HKIAAAs Nos. 2, 3, 5 and 7.

LEGISLATIVE TIMETABLE

14. The regulations and notice will be published in the Gazette on 19 May 2017 and introduced into the Legislative Council on 24 May 2017.

IMPLICATIONS OF THE PROPOSAL

15. The proposals are necessary to ensure navigational safety and regulate marine traffic. The establishment of the proposed restricted areas and special areas along the HKLR and the Southern Connection of TM-CLKL with detailed and clear restrictions on vessels sailing through will enhance marine traffic order and prevent collision of tall vessels with the bridge while passing through.

16. The proposals have no financial, civil service, economic, productivity, competition, environmental, sustainability, gender or family implications. They are in conformity with the Basic Law, including the provisions concerning human rights. They will not affect the current binding effect of the Shipping and Port Control Ordinance, the Merchant Shipping (Local Vessels) Ordinance and their subsidiary legislation.

PUBLIC CONSULTATION

17. We consulted the Legislative Council Panel on Economic Development on the legislative proposals on 24 April 2017. Members supported the proposed amendments. The Local Vessels Advisory Committee, Port Operations Committee, Pilotage Advisory Committee and High Speed Craft Consultative Committee of the Marine Department, as well as the Traffic and Transport Committee of the Islands District Council were also consulted and they supported the proposal.

PUBLICITY

18. A press release will be issued on 19 May 2017. A spokesman will be available to answer enquires.

ENQUIRIES

19. Any enquiries on this brief can be addressed to Ms Louisa Yan, Principal Assistant Secretary for Transport and Housing (Transport) (Tel: 3509 8162), or Mr Cheuk Fan-lun, Assistant Director (Planning & Services), Marine Department (Tel: 2852 4403).

Transport and Housing Bureau

May 2017

Shipping and Port Control (Amendment) Regulation 2017

Contents

Section	Page
1. Commencement.....	1
2. Shipping and Port Control Regulations amended.....	1
3. Regulation 15 amended (failure of radiotelephone equipment).....	1
4. Regulation 23 amended (entry into restricted areas, etc.).....	1
5. Regulation 23A amended (supplementary provisions on entry into restricted areas, etc.).....	2
6. Regulation 23B amended (additional supplementary provisions on entry into restricted areas, etc.).....	2
7. Fifth Schedule amended (restricted areas, etc.).....	4

Shipping and Port Control (Amendment) Regulation 2017

(Made by the Chief Executive in Council under section 80 of the Shipping
and Port Control Ordinance (Cap. 313))

1. Commencement

This Regulation comes into operation on 1 December 2017.

2. Shipping and Port Control Regulations amended

The Shipping and Port Control Regulations (Cap. 313 sub. leg. A) are amended as set out in sections 3 to 7.

3. Regulation 15 amended (failure of radiotelephone equipment)

(1) Regulation 15(1), Chinese text—

Repeal

“盡早將該裝備或安排將該裝備修復至”

Substitute

“，盡早令或安排令該裝備恢復”。

(2) Regulation 15(3)(b), Chinese text—

Repeal

“已修復至”

Substitute

“，已恢復”。

4. Regulation 23 amended (entry into restricted areas, etc.)

After regulation 23(6D)—

Add

“(6E) Except with the permission of the Director—

- (a) a vessel must not enter the Hong Kong Link Road Special Area No. 1 specified in paragraph 29 of the Fifth Schedule by crossing over the south-western boundary of the Special Area specified in paragraph 32 of that Schedule; or
- (b) a vessel must not enter the Hong Kong Link Road Special Area No. 2 specified in paragraph 30 of the Fifth Schedule by crossing over the north-eastern boundary of the Special Area specified in paragraph 33 of that Schedule.”.

5. Regulation 23A amended (supplementary provisions on entry into restricted areas, etc.)

Regulation 23A, Chinese text—

Repeal

“橋梁” (wherever appearing)

Substitute

“橋樑”.

6. Regulation 23B amended (additional supplementary provisions on entry into restricted areas, etc.)

(1) After regulation 23B(3A)—

Add

“(3B) Except with the permission of the Director—

- (a) a vessel which has a height exceeding that specified in paragraph 22(a) of the Fifth Schedule must not enter or pass through the Tuen Mun-Chek Lap Kok Link Area No. 1 specified in paragraph 22(b) of that Schedule;
- (b) a vessel which has a height exceeding that specified in paragraph 23(a) of the Fifth Schedule

must not enter or pass through the Tuen Mun-Chek Lap Kok Link Area No. 2 specified in paragraph 23(b) of that Schedule; or

- (c) a vessel which has a height exceeding that specified in paragraph 24(a) of the Fifth Schedule must not enter or pass through the Tuen Mun-Chek Lap Kok Link Area No. 3 specified in paragraph 24(b) of that Schedule.

(3C) Except with the permission of the Director—

- (a) a vessel which has a height exceeding that specified in paragraph 25(a) of the Fifth Schedule must not enter or pass through the Hong Kong Link Road Area No. 1 specified in paragraph 25(b) of that Schedule;
- (b) a vessel which has a height exceeding that specified in paragraph 26(a) of the Fifth Schedule must not enter or pass through the Hong Kong Link Road Area No. 2 specified in paragraph 26(b) of that Schedule;
- (c) a vessel which has a height exceeding that specified in paragraph 27(a) of the Fifth Schedule must not enter or pass through the Hong Kong Link Road Area No. 3 specified in paragraph 27(b) of that Schedule; or
- (d) a vessel which has a height exceeding that specified in paragraph 28(a) of the Fifth Schedule must not enter or pass through the Hong Kong Link Road Area No. 4 specified in paragraph 28(b) of that Schedule.

(3D) Except with the permission of the Director, a vessel which has an overall length exceeding 10 metres must not enter or pass through the Hong Kong Link Road

Special Area No. 3 specified in paragraph 31 of the Fifth Schedule.”.

- (2) Regulation 23B(5)—

Repeal everything before paragraph (a)

Substitute

“(5) Without prejudice to paragraph (1), (2), (3), (3A), (3B), (3C) or (3D), if a vessel is involved in a collision with any bridge within any of the Areas referred to in those paragraphs—”.

7. Fifth Schedule amended (restricted areas, etc.)

- (1) Fifth Schedule, after paragraph 21—

Add

“22. TUEN MUN-CHEK LAP KOK LINK AREA NO. 1

- (a) 21 metres above sea level;
- (b) the area of the waters of Hong Kong bounded by straight lines joining the following positions—
- (i) latitude 22°18.625′ north,
longitude 113°57.607′ east;
 - (ii) latitude 22°18.592′ north,
longitude 113°57.660′ east;
 - (iii) latitude 22°18.513′ north,
longitude 113°57.578′ east;
 - (iv) latitude 22°18.546′ north,
longitude 113°57.523′ east;
 - (v) latitude 22°18.625′ north,
longitude 113°57.607′ east.

23. TUEN MUN-CHEK LAP KOK LINK AREA NO. 2

- (a) 12 metres above sea level;
- (b) the areas of the waters of Hong Kong respectively bounded by—
- (i) the shore and straight lines joining the following positions—
 - (A) latitude 22°18.670′ north,
longitude 113°57.555′ east;
 - (B) latitude 22°18.625′ north,
longitude 113°57.607′ east;
 - (C) latitude 22°18.546′ north,
longitude 113°57.523′ east;
 - (D) latitude 22°18.638′ north,
longitude 113°57.370′ east;
 - (ii) straight lines joining the following positions—
 - (A) latitude 22°18.592′ north,
longitude 113°57.660′ east;
 - (B) latitude 22°18.468′ north,
longitude 113°57.871′ east;
 - (C) latitude 22°18.377′ north,
longitude 113°57.808′ east;
 - (D) latitude 22°18.513′ north,
longitude 113°57.578′ east;
 - (E) latitude 22°18.592′ north,
longitude 113°57.660′ east.

24. TUEN MUN-CHEK LAP KOK LINK AREA NO. 3

- (a) 6 metres above sea level;
- (b) the area of the waters of Hong Kong bounded by the

shore and straight lines joining the following positions—

- (i) latitude 22°17.995' north,
longitude 113°58.147' east;
- (ii) latitude 22°18.172' north,
longitude 113°58.151' east;
- (iii) latitude 22°18.377' north,
longitude 113°57.808' east;
- (iv) latitude 22°18.468' north,
longitude 113°57.871' east;
- (v) latitude 22°18.263' north,
longitude 113°58.215' east;
- (vi) latitude 22°18.132' north,
longitude 113°58.466' east.

25. HONG KONG LINK ROAD AREA NO. 1

- (a) 41 metres above sea level;
- (b) the area of the waters of Hong Kong bounded by straight lines joining the following positions—
 - (i) latitude 22°16.635' north,
longitude 113°51.756' east;
 - (ii) latitude 22°16.615' north,
longitude 113°51.810' east;
 - (iii) latitude 22°16.581' north,
longitude 113°51.921' east;
 - (iv) latitude 22°16.571' north,
longitude 113°51.978' east;
 - (v) latitude 22°16.453' north,
longitude 113°51.938' east;
 - (vi) latitude 22°16.465' north,

longitude 113°51.881' east;

- (vii) latitude 22°16.498' north,
longitude 113°51.770' east;
- (viii) latitude 22°16.518' north,
longitude 113°51.716' east;
- (ix) latitude 22°16.635' north,
longitude 113°51.756' east.

26. HONG KONG LINK ROAD AREA NO. 2

- (a) 12 metres above sea level;
- (b) the areas of the waters of Hong Kong respectively bounded by—
 - (i) straight lines joining the following positions—
 - (A) latitude 22°16.860' north,
longitude 113°51.160' east;
 - (B) latitude 22°16.635' north,
longitude 113°51.756' east;
 - (C) latitude 22°16.518' north,
longitude 113°51.716' east;
 - (D) latitude 22°16.745' north,
longitude 113°51.114' east;
 - (E) latitude 22°16.860' north,
longitude 113°51.160' east;
 - (ii) straight lines joining the following positions—
 - (A) latitude 22°17.067' north,
longitude 113°53.135' east;
 - (B) latitude 22°16.967' north,
longitude 113°53.211' east;
 - (C) latitude 22°16.595' north,

- longitude 113°52.648' east;
- (D) latitude 22°16.494' north,
longitude 113°52.441' east;
- (E) latitude 22°16.443' north,
longitude 113°52.216' east;
- (F) latitude 22°16.453' north,
longitude 113°51.938' east;
- (G) latitude 22°16.571' north,
longitude 113°51.978' east;
- (H) latitude 22°16.565' north,
longitude 113°52.201' east;
- (I) latitude 22°16.609' north,
longitude 113°52.395' east;
- (J) latitude 22°16.695' north,
longitude 113°52.572' east;
- (K) latitude 22°17.067' north,
longitude 113°53.135' east;
- (iii) straight lines joining the following positions—
 - (A) latitude 22°17.675' north,
longitude 113°54.701' east;
 - (B) latitude 22°17.649' north,
longitude 113°54.650' east;
 - (C) latitude 22°17.648' north,
longitude 113°54.587' east;
 - (D) latitude 22°17.674' north,
longitude 113°54.645' east;
 - (E) latitude 22°17.675' north,
longitude 113°54.701' east.

- 27. HONG KONG LINK ROAD AREA NO. 3
 - (a) 10 metres above sea level;
 - (b) the area of the waters of Hong Kong bounded by straight lines joining the following positions—
 - (i) latitude 22°17.597' north,
longitude 113°54.124' east;
 - (ii) latitude 22°17.575' north,
longitude 113°54.130' east;
 - (iii) latitude 22°17.567' north,
longitude 113°54.103' east;
 - (iv) latitude 22°17.589' north,
longitude 113°54.096' east;
 - (v) latitude 22°17.597' north,
longitude 113°54.124' east.
- 28. HONG KONG LINK ROAD AREA NO. 4
 - (a) 5 metres above sea level;
 - (b) the areas of the waters of Hong Kong respectively bounded by—
 - (i) straight lines joining the following positions—
 - (A) latitude 22°16.903' north,
longitude 113°51.029' east;
 - (B) latitude 22°16.860' north,
longitude 113°51.160' east;
 - (C) latitude 22°16.745' north,
longitude 113°51.114' east;
 - (D) latitude 22°16.787' north,
longitude 113°50.988' east;

- (E) latitude 22°16.903' north,
longitude 113°51.029' east;
- (ii) the shore and straight lines joining the following positions—
- (A) latitude 22°17.244' north,
longitude 113°53.658' east;
- (B) latitude 22°16.967' north,
longitude 113°53.211' east;
- (C) latitude 22°17.067' north,
longitude 113°53.135' east;
- (D) latitude 22°17.511' north,
longitude 113°53.809' east;
- (iii) the shore and straight lines joining the following positions—
- (A) latitude 22°17.469' north,
longitude 113°53.839' east;
- (B) latitude 22°17.514' north,
longitude 113°53.911' east;
- (C) latitude 22°17.561' north,
longitude 113°54.012' east;
- (D) latitude 22°17.589' north,
longitude 113°54.096' east;
- (E) latitude 22°17.567' north,
longitude 113°54.103' east;
- (F) latitude 22°17.547' north,
longitude 113°54.037' east;
- (G) latitude 22°17.505' north,
longitude 113°53.942' east;
- (H) latitude 22°17.457' north,

- longitude 113°53.861' east;
- (iv) straight lines joining the following positions—
- (A) latitude 22°17.649' north,
longitude 113°54.650' east;
- (B) latitude 22°17.640' north,
longitude 113°54.633' east;
- (C) latitude 22°17.613' north,
longitude 113°54.563' east;
- (D) latitude 22°17.602' north,
longitude 113°54.492' east;
- (E) latitude 22°17.604' north,
longitude 113°54.355' east;
- (F) latitude 22°17.595' north,
longitude 113°54.230' east;
- (G) latitude 22°17.575' north,
longitude 113°54.130' east;
- (H) latitude 22°17.597' north,
longitude 113°54.124' east;
- (I) latitude 22°17.618' north,
longitude 113°54.236' east;
- (J) latitude 22°17.626' north,
longitude 113°54.358' east;
- (K) latitude 22°17.626' north,
longitude 113°54.487' east;
- (L) latitude 22°17.632' north,
longitude 113°54.539' east;
- (M) latitude 22°17.648' north,
longitude 113°54.587' east;
- (N) latitude 22°17.649' north,

- longitude 113°54.650' east;
- (v) the shore and straight lines joining the following positions—
- (A) latitude 22°17.714' north,
longitude 113°54.751' east;
- (B) latitude 22°17.696' north,
longitude 113°54.757' east;
- (C) latitude 22°17.684' north,
longitude 113°54.718' east;
- (D) latitude 22°17.675' north,
longitude 113°54.701' east;
- (E) latitude 22°17.674' north,
longitude 113°54.645' east;
- (F) latitude 22°17.714' north,
longitude 113°54.725' east.

29. HONG KONG LINK ROAD SPECIAL AREA NO. 1

The area of the waters of Hong Kong bounded by straight lines joining the following positions—

- (a) latitude 22°16.635' north,
longitude 113°51.756' east;
- (b) latitude 22°16.615' north,
longitude 113°51.810' east;
- (c) latitude 22°16.498' north,
longitude 113°51.770' east;
- (d) latitude 22°16.518' north,
longitude 113°51.716' east;
- (e) latitude 22°16.635' north,
longitude 113°51.756' east.

30. HONG KONG LINK ROAD SPECIAL AREA NO. 2

The area of the waters of Hong Kong bounded by straight lines joining the following positions—

- (a) latitude 22°16.581' north,
longitude 113°51.921' east;
- (b) latitude 22°16.571' north,
longitude 113°51.978' east;
- (c) latitude 22°16.453' north,
longitude 113°51.938' east;
- (d) latitude 22°16.465' north,
longitude 113°51.881' east;
- (e) latitude 22°16.581' north,
longitude 113°51.921' east.

31. HONG KONG LINK ROAD SPECIAL AREA NO. 3

The area of the waters of Hong Kong bounded by straight lines joining the following positions—

- (a) latitude 22°16.615' north,
longitude 113°51.810' east;
- (b) latitude 22°16.581' north,
longitude 113°51.921' east;
- (c) latitude 22°16.465' north,
longitude 113°51.881' east;
- (d) latitude 22°16.498' north,
longitude 113°51.770' east;
- (e) latitude 22°16.615' north,
longitude 113°51.810' east.

32. SOUTH-WESTERN BOUNDARY OF THE HONG KONG LINK ROAD SPECIAL AREA NO. 1

The boundary indicated by straight lines joining the following positions—

- (a) latitude 22°16.547' north,
longitude 113°51.787' east;
- (b) latitude 22°16.498' north,
longitude 113°51.770' east;
- (c) latitude 22°16.518' north,
longitude 113°51.716' east;
- (d) latitude 22°16.567' north,
longitude 113°51.733' east.

33. NORTH-EASTERN BOUNDARY OF THE HONG KONG LINK ROAD SPECIAL AREA NO. 2

The boundary indicated by straight lines joining the following positions—

- (a) latitude 22°16.532' north,
longitude 113°51.904' east;
- (b) latitude 22°16.581' north,
longitude 113°51.921' east;
- (c) latitude 22°16.571' north,
longitude 113°51.978' east;
- (d) latitude 22°16.521' north,
longitude 113°51.961' east.”.

(2) Fifth Schedule, Note—

Repeal

“21”

Substitute

“33”.

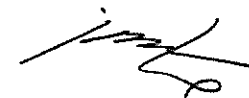

Clerk to the Executive Council

COUNCIL CHAMBER

9th May, 2017

Explanatory Note

This Regulation amends the Shipping and Port Control Regulations (Cap. 313 sub. leg. A) (*Regulations*)—

- (a) to specify the geographical co-ordinates defining—
 - (i) the Tuen Mun-Chek Lap Kok Link Area No. 1;
 - (ii) the Tuen Mun-Chek Lap Kok Link Area No. 2;
 - (iii) the Tuen Mun-Chek Lap Kok Link Area No. 3;
 - (iv) the Hong Kong Link Road Area No. 1;
 - (v) the Hong Kong Link Road Area No. 2;
 - (vi) the Hong Kong Link Road Area No. 3;
 - (vii) the Hong Kong Link Road Area No. 4;
 - (viii) the Hong Kong Link Road Special Area No. 1;
 - (ix) the Hong Kong Link Road Special Area No. 2;
 - (x) the Hong Kong Link Road Special Area No. 3;
 - (xi) the South-Western Boundary of the Hong Kong Link Road Special Area No. 1; and
 - (xii) the North-Eastern Boundary of the Hong Kong Link Road Special Area No. 2;
- (b) to prohibit vessels exceeding certain heights from entering or passing through the areas mentioned in subparagraph (a)(i) to (vii);
- (c) to prohibit vessels from entering the area mentioned in subparagraph (a)(viii) by crossing over the boundary mentioned in subparagraph (a)(xi);
- (d) to prohibit vessels from entering the area mentioned in subparagraph (a)(ix) by crossing over the boundary mentioned in subparagraph (a)(xii);

- (e) to prohibit vessels of an overall length exceeding 10 metres from entering or passing through the area mentioned in subparagraph (a)(x); and
- (f) to make minor textual amendments to the Chinese text of the Regulations.

Merchant Shipping (Local Vessels) (General) (Amendment) Regulation 2017

(Made by the Secretary for Transport and Housing under section 89 of the Merchant Shipping (Local Vessels) Ordinance (Cap. 548))

1. Commencement

This Regulation comes into operation on 1 December 2017.

2. Merchant Shipping (Local Vessels) (General) Regulation amended

The Merchant Shipping (Local Vessels) (General) Regulation (Cap. 548 sub. leg. F) is amended as set out in sections 3, 4 and 5.

3. Sections 18A and 18B added

After section 18—

Add

“18A. Prohibition of entry into Tuen Mun-Chek Lap Kok Link Areas

Except with the permission of the Director—

- (a) a local vessel with a height exceeding 21 m above sea level must not enter the Tuen Mun-Chek Lap Kok Link Area No. 1 specified in paragraph 22(b) of the Fifth Schedule to the SAPCR;
- (b) a local vessel with a height exceeding 12 m above sea level must not enter the Tuen Mun-Chek Lap Kok Link Area No. 2 specified in paragraph 23(b) of the Fifth Schedule to the SAPCR; or

- (c) a local vessel with a height exceeding 6 m above sea level must not enter the Tuen Mun-Chek Lap Kok Link Area No. 3 specified in paragraph 24(b) of the Fifth Schedule to the SAPCR.

18B. Prohibition of entry into Hong Kong Link Road Areas and restriction on entry into Hong Kong Link Road Special Areas

(1) Except with the permission of the Director—

- (a) a local vessel with a height exceeding 41 m above sea level must not enter the Hong Kong Link Road Area No. 1 specified in paragraph 25(b) of the Fifth Schedule to the SAPCR;
- (b) a local vessel with a height exceeding 12 m above sea level must not enter the Hong Kong Link Road Area No. 2 specified in paragraph 26(b) of the Fifth Schedule to the SAPCR;
- (c) a local vessel with a height exceeding 10 m above sea level must not enter the Hong Kong Link Road Area No. 3 specified in paragraph 27(b) of the Fifth Schedule to the SAPCR; or
- (d) a local vessel with a height exceeding 5 m above sea level must not enter the Hong Kong Link Road Area No. 4 specified in paragraph 28(b) of the Fifth Schedule to the SAPCR.

(2) Except with the permission of the Director—

- (a) a local vessel must not enter the Hong Kong Link Road Special Area No. 1 specified in paragraph 29 of the Fifth Schedule to the SAPCR by crossing over the south-western boundary of the Special Area specified in paragraph 32 of that Schedule; or

(b) a local vessel must not enter the Hong Kong Link Road Special Area No. 2 specified in paragraph 30 of the Fifth Schedule to the SAPCR by crossing over the north-eastern boundary of the Special Area specified in paragraph 33 of that Schedule.

(3) Except with the permission of the Director, a local vessel exceeding 10 m in length overall must not enter the Hong Kong Link Road Special Area No. 3 specified in paragraph 31 of the Fifth Schedule to the SAPCR.”

4. **Section 20 amended (offences relating to restricted areas, etc.)**

(1) Section 20(1), after “18”—

Add

“, 18A, 18B(1), (2) or (3)”.

(2) Section 20(3), after “18(a)—

Add

“, 18A, 18B(1) and (3)”.

(3) Section 20(3), Chinese text—

Repeal

“與在該等條文所提述的區域內的任何橋梁發生碰撞”

Substitute

“碰撞在該等條文提述的區域內的任何橋樑”。

5. **“橋樑” substituted for “橋梁”**

The following provisions, Chinese text—

(a) Section 17(a);

(b) Section 18(a)—

Repeal

“橋梁” (wherever appearing)

Substitute

“橋樑”。

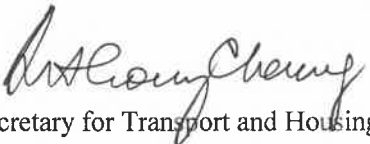
Secretary for Transport and Housing

11 May 2017

Explanatory Note

This Regulation amends the Merchant Shipping (Local Vessels) (General) Regulation (Cap. 548 sub. leg. F) (*principal Regulation*)—

- (a) to prohibit local vessels exceeding certain heights from entering—
 - (i) the Tuen Mun-Chek Lap Kok Link Area No. 1;
 - (ii) the Tuen Mun-Chek Lap Kok Link Area No. 2;
 - (iii) the Tuen Mun-Chek Lap Kok Link Area No. 3;
 - (iv) the Hong Kong Link Road Area No. 1;
 - (v) the Hong Kong Link Road Area No. 2;
 - (vi) the Hong Kong Link Road Area No. 3; or
 - (vii) the Hong Kong Link Road Area No. 4;
- (b) to prohibit local vessels from entering the Hong Kong Link Road Special Area No. 1 by crossing over the south-western boundary of the Special Area;
- (c) to prohibit local vessels from entering the Hong Kong Link Road Special Area No. 2 by crossing over the north-eastern boundary of the Special Area;
- (d) to prohibit local vessels exceeding 10 m in length overall from entering the Hong Kong Link Road Special Area No. 3; and
- (e) to make minor textual amendments to the Chinese text of the principal Regulation.

Shipping and Port Control Regulations (Amendment of Fifth Schedule) Notice 2017

(Made by the Director of Marine under regulation 72(1) of the Shipping and Port Control Regulations (Cap. 313 sub. leg. A))

1. Commencement

This Notice comes into operation on 1 August 2017.

2. Shipping and Port Control Regulations amended

The Shipping and Port Control Regulations (Cap. 313 sub. leg. A) are amended as set out in section 3.

3. Fifth Schedule amended (restricted areas, etc.)

(1) Fifth Schedule—

Repeal paragraph 6

Substitute

“6. HONG KONG INTERNATIONAL AIRPORT APPROACH AREA No. 2

The area of the waters of Hong Kong bounded by the shore and straight lines joining the following positions—

- (a) latitude 22°18'38" north,
longitude 113°56'26" east;
- (b) latitude 22°18'39" north,
longitude 113°56'29" east;
- (c) latitude 22°18'35" north,
longitude 113°56'31" east;
- (d) latitude 22°18'33" north,
longitude 113°56'23" east.”.

(2) Fifth Schedule—

Repeal paragraph 7

Substitute

“7. HONG KONG INTERNATIONAL AIRPORT APPROACH AREA No. 3

The area of the waters of Hong Kong bounded by the shore and straight lines joining the following positions—

- (a) latitude 22°18'24" north,
longitude 113°53'47" east;
- (b) latitude 22°18'06" north,
longitude 113°52'50" east;
- (c) latitude 22°18'30" north,
longitude 113°52'40" east;
- (d) latitude 22°18'40" north,
longitude 113°53'13" east;
- (e) latitude 22°19'01" north,
longitude 113°53'41" east;
- (f) latitude 22°19'38" north,
longitude 113°55'36" east;
- (g) latitude 22°19'39" north,
longitude 113°56'19" east;
- (h) latitude 22°19'50" north,
longitude 113°56'51" east;
- (i) latitude 22°19'36" north,
longitude 113°56'56" east;
- (j) latitude 22°19'22" north,
longitude 113°56'51" east;
- (k) latitude 22°19'20" north,
longitude 113°56'46" east.”.

- (3) Fifth Schedule, Chinese text, paragraph 8—

Repeal

“海岸及”.

- (4) Fifth Schedule—

Repeal paragraph 9**Substitute**

- “9. HONG KONG INTERNATIONAL AIRPORT APPROACH AREA
-
- No. 5

The area of the waters of Hong Kong bounded by the shore and straight lines joining the following positions (a) to (c), and (d) to (f)—

- (a) latitude 22°18'52" north,
longitude 113°56'33" east;
- (b) latitude 22°18'57" north,
longitude 113°56'50" east;
- (c) latitude 22°18'56" north,
longitude 113°56'51" east;
- (d) latitude 22°18'49" north,
longitude 113°56'53" east;
- (e) latitude 22°18'33" north,
longitude 113°56'59" east;
- (f) latitude 22°18'22" north,
longitude 113°56'25" east.”.

- (5) Fifth Schedule, Chinese text, paragraph 10—

Repeal

“海岸及”.

- (6) Fifth Schedule—

Repeal paragraph 11**Substitute**

- “11. HONG KONG INTERNATIONAL AIRPORT APPROACH AREA
-
- No. 7

The area of the waters of Hong Kong bounded by the shore and straight lines joining the following positions (a) to (f), (g) to (i), and (j) to (k)—

- (a) latitude 22°17'15" north,
longitude 113°53'40" east;
- (b) latitude 22°16'53" north,
longitude 113°52'32" east;
- (c) latitude 22°17'55" north,
longitude 113°52'00" east;
- (d) latitude 22°18'32" north,
longitude 113°52'00" east;
- (e) latitude 22°20'10" north,
longitude 113°57'19" east;
- (f) latitude 22°19'19" north,
longitude 113°57'38" east;
- (g) latitude 22°19'07" north,
longitude 113°57'42" east;
- (h) latitude 22°18'36" north,
longitude 113°57'54" east;
- (i) latitude 22°18'08" north,
longitude 113°56'27" east;
- (j) latitude 22°17'42" north,
longitude 113°55'04" east;
- (k) latitude 22°17'31" north,
longitude 113°54'30" east.”.

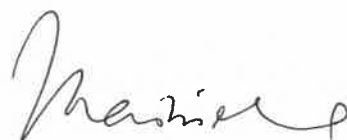

Director of Marine

27 April 2017

Explanatory Note

This Notice amends the Fifth Schedule to the Shipping and Port Control Regulations (Cap. 313 sub. leg. A) to—

- (a) make adjustments to the boundaries of 4 Hong Kong International Airport Approach Areas; and
- (b) make certain minor textual amendments.

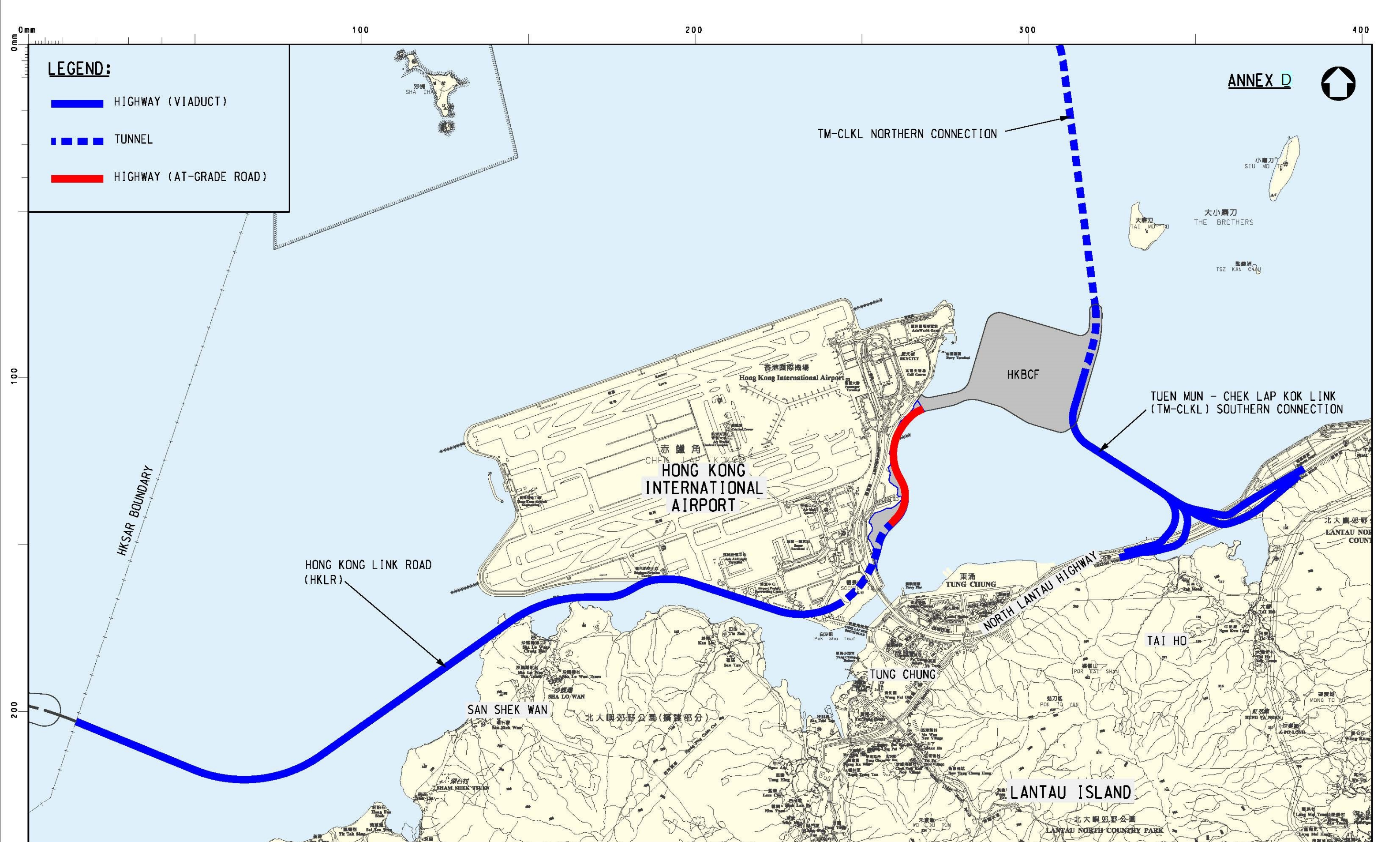

LEGEND:

- HIGHWAY (VIADUCT)
- TUNNEL
- HIGHWAY (AT-GRADE ROAD)

ANNEX D

drawing title <p style="text-align: center;">THE LAYOUT OF HONG KONG LINK ROAD (HKLR) AND TUEN MUN-CHEK LAP KOK LINK (TM-CLKL)</p>	designed W Y IP 16/03/17 checked	drawn C K AU 16/03/17 approved	drawing no. HZM6844TH-SK0088	scale 1:37500
HONG KONG - ZHUHAI - MACAO BRIDGE HONG KONG PROJECT MANAGEMENT OFFICE			© COPYRIGHT RESERVED HIGHWAYS DEPARTMENT HONG KONG	

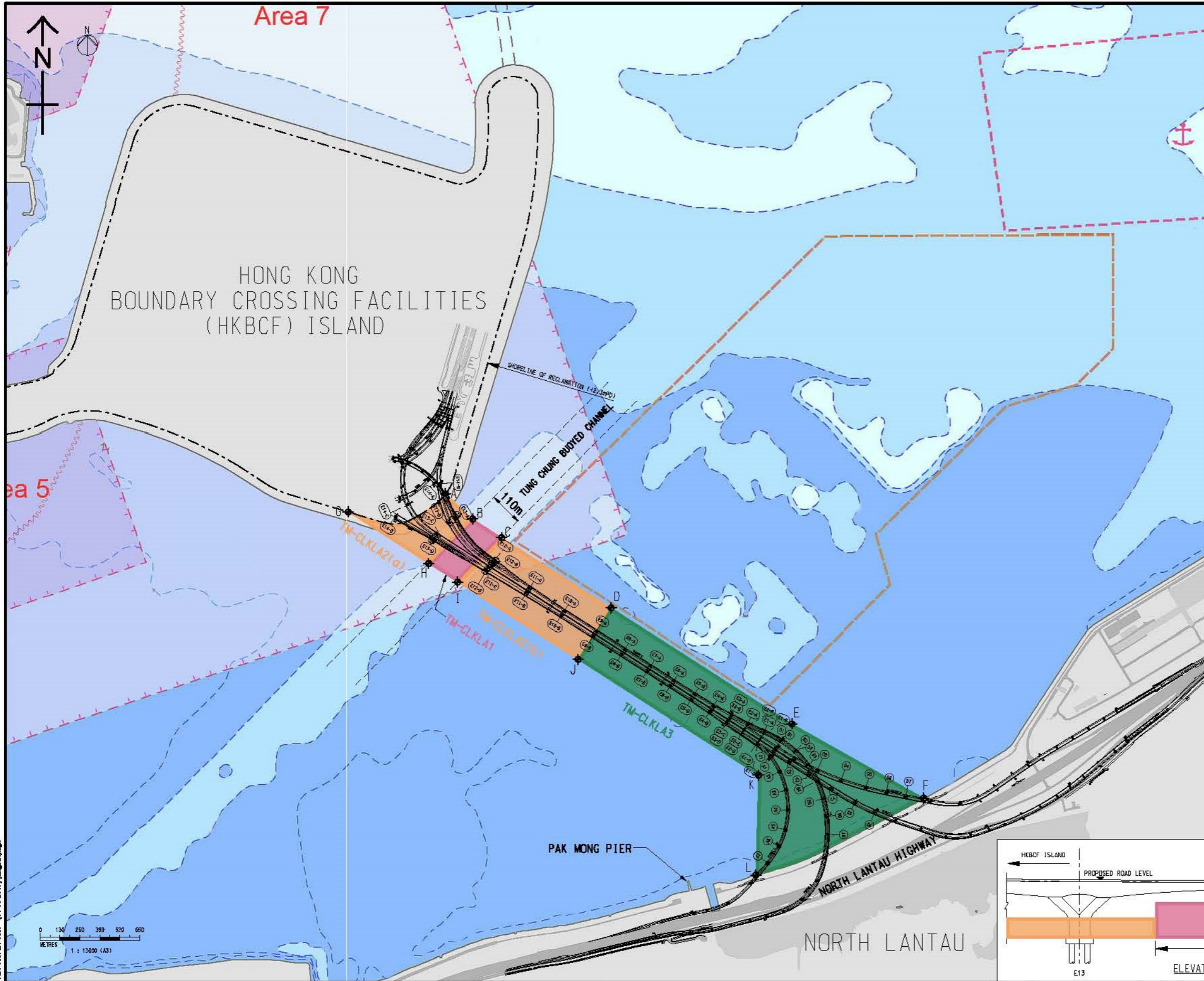

Annex E
RESTRICTED AREAS IN THE FIFTH SCHEDULE OF THE SHIPPING AND PORT CONTROL REGULATIONS (CAP 313A)

TM-CLKL AREA NO.	COORDINATES OF THE BOUNDARIES (REPRESENTED BY THE WGS 84)	RESTRICTIONS		
1 TM-CLKL A1	THE AREA OF THE WATERS OF HONG KONG BOUNDED BY STRAIGHT LINES JOINING THE FOLLOWING POSITIONS-	NO VESSEL WHICH HAS A HEIGHT EXCEEDING 21m ABOVE SEA LEVEL SHALL ENTER OR PASS THROUGH.		
	B		22°18.625'N 113°57.607'E	
	C		22°18.592'N 113°57.660'E	
	J		22°18.513'N 113°57.578'E	
	H		22°18.546'N 113°57.523'E	
2 TM-CLKL A2	THE AREA OF THE WATERS OF HONG KONG BOUNDED BY THE SHORE AND STRAIGHT LINES JOINING THE FOLLOWING POSITIONS A, B, H, G (i.e. 2(a))-	NO VESSEL WHICH HAS A HEIGHT EXCEEDING 12m ABOVE SEA LEVEL SHALL ENTER OR PASS THROUGH.		
	A		22°18.670'N 113°57.555'E	
	B		22°18.625'N 113°57.607'E	
	H		22°18.546'N 113°57.523'E	
	G		22°18.638'N 113°57.370'E	
	THE AREA OF THE WATERS OF HONG KONG BOUNDED BY STRAIGHT LINES JOINING THE FOLLOWING POSITIONS G, D, J, I (i.e. 2(b))-			
	C			22°18.592'N 113°57.660'E
	D			22°18.468'N 113°57.871'E
	J			22°18.377'N 113°57.808'E
	I			22°18.513'N 113°57.578'E
3 TM-CLKL A3	THE AREA OF THE WATERS OF HONG KONG BOUNDED BY THE SHORE AND STRAIGHT LINES JOINING THE FOLLOWING POSITIONS-	NO VESSEL WHICH HAS A HEIGHT EXCEEDING 6m ABOVE SEA LEVEL SHALL ENTER OR PASS THROUGH.		
	L		22°17.995'N 113°58.147'E	
	K		22°18.172'N 113°58.151'E	
	J		22°18.377'N 113°57.808'E	
	D		22°18.468'N 113°57.871'E	
	E		22°18.263'N 113°58.215'E	
	F		22°18.132'N 113°58.466'E	

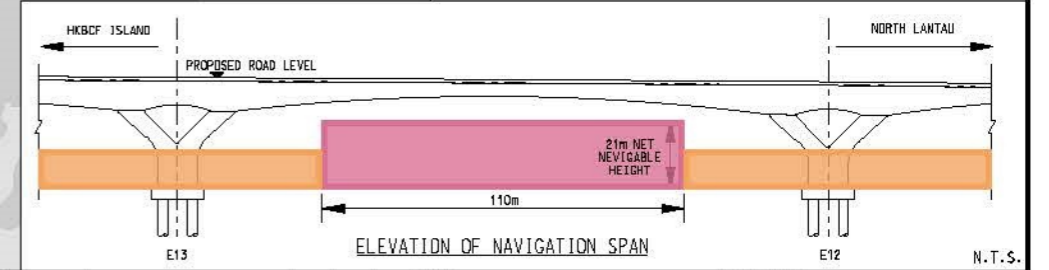

Plot File by: RSTDC1
 PATH: K:\STODRAWINGS\DRAMA\TDF0637\DF0637_01-03-2017 (English).dgn
 01-Mar-17

TITLE

THE LOCATIONS OF TUEN MUN - CHEK LAP KOK LINK (TM-CLKL) AREAS NO. 1-3

SCALE	1:13000 (A3)	ISSUED DATE	01-03-2017
DRAWN	GC	PREPARED	TC
DRAWING REFERENCE	APPROVED SYN		
	NIL		
SKETCH NO.	DF0637		
REV.	DATE	DESCRIPTION	APP.
-	21/02/17	THE LOCATIONS OF TUEN MUN - CHEK LAP KOK LINK (TM-CLKL) AREAS NO. 1-3	GC TC SYN

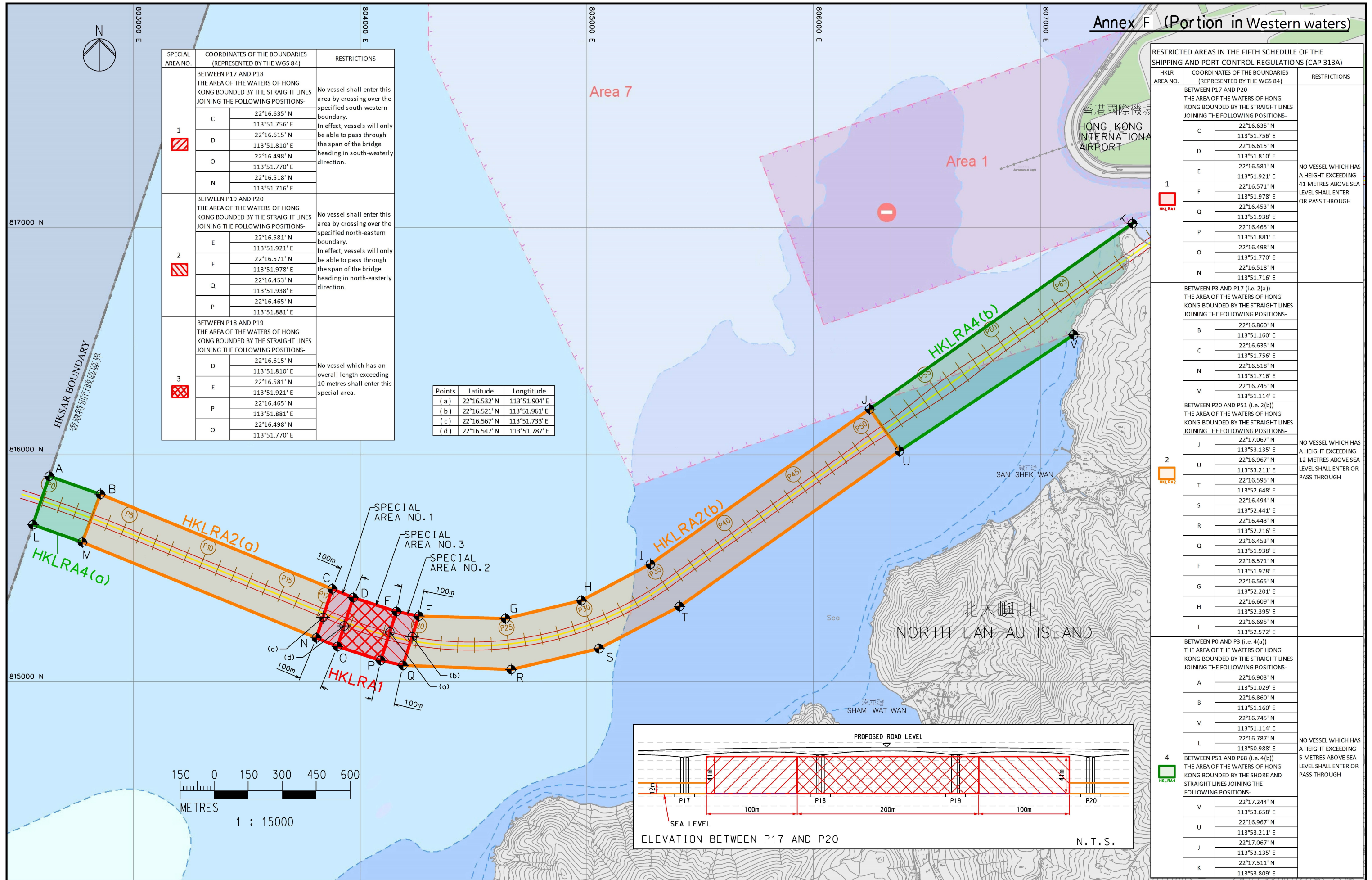

SPECIAL AREA NO.	COORDINATES OF THE BOUNDARIES (REPRESENTED BY THE WGS 84)	RESTRICTIONS	
1	BETWEEN P17 AND P18 THE AREA OF THE WATERS OF HONG KONG BOUNDED BY THE STRAIGHT LINES JOINING THE FOLLOWING POSITIONS-	No vessel shall enter this area by crossing over the specified south-western boundary. In effect, vessels will only be able to pass through the span of the bridge heading in south-westerly direction.	
	C		22°16.635' N 113°51.756' E
	D		22°16.615' N 113°51.810' E
	O		22°16.498' N 113°51.770' E
	N		22°16.518' N 113°51.716' E
2	BETWEEN P19 AND P20 THE AREA OF THE WATERS OF HONG KONG BOUNDED BY THE STRAIGHT LINES JOINING THE FOLLOWING POSITIONS-	No vessel shall enter this area by crossing over the specified north-eastern boundary. In effect, vessels will only be able to pass through the span of the bridge heading in north-easterly direction.	
	E		22°16.581' N 113°51.921' E
	F		22°16.571' N 113°51.978' E
	Q		22°16.453' N 113°51.938' E
	P		22°16.465' N 113°51.881' E
			22°16.581' N 113°51.810' E
3	BETWEEN P18 AND P19 THE AREA OF THE WATERS OF HONG KONG BOUNDED BY THE STRAIGHT LINES JOINING THE FOLLOWING POSITIONS-	No vessel which has an overall length exceeding 10 metres shall enter this special area.	
	D		22°16.615' N 113°51.810' E
	E		22°16.581' N 113°51.921' E
	P		22°16.465' N 113°51.881' E
	O		22°16.498' N 113°51.770' E
			22°16.615' N 113°51.810' E

Points	Latitude	Longitude
(a)	22°16.532' N	113°51.904' E
(b)	22°16.521' N	113°51.961' E
(c)	22°16.567' N	113°51.733' E
(d)	22°16.547' N	113°51.787' E

HKLR AREA NO.	COORDINATES OF THE BOUNDARIES (REPRESENTED BY THE WGS 84)	RESTRICTIONS	
1	BETWEEN P17 AND P20 THE AREA OF THE WATERS OF HONG KONG BOUNDED BY THE STRAIGHT LINES JOINING THE FOLLOWING POSITIONS-	NO VESSEL WHICH HAS A HEIGHT EXCEEDING 41 METRES ABOVE SEA LEVEL SHALL ENTER OR PASS THROUGH	
	C		22°16.635' N 113°51.756' E
	D		22°16.615' N 113°51.810' E
	E		22°16.581' N 113°51.921' E
	F		22°16.571' N 113°51.978' E
	Q		22°16.453' N 113°51.938' E
	P		22°16.465' N 113°51.881' E
	O		22°16.498' N 113°51.770' E
	N		22°16.518' N 113°51.716' E
			22°16.581' N 113°51.810' E
	2		BETWEEN P3 AND P17 (i.e. 2(a)) THE AREA OF THE WATERS OF HONG KONG BOUNDED BY THE STRAIGHT LINES JOINING THE FOLLOWING POSITIONS-
B		22°16.860' N 113°51.160' E	
C		22°16.635' N 113°51.756' E	
N		22°16.518' N 113°51.716' E	
M		22°16.745' N 113°51.114' E	
		22°17.067' N 113°53.135' E	
J		22°16.967' N 113°53.211' E	
U		22°16.595' N 113°52.648' E	
T		22°16.494' N 113°52.441' E	
S		22°16.443' N 113°52.216' E	
R		22°16.453' N 113°51.938' E	
Q	22°16.571' N 113°51.978' E		
F	22°16.565' N 113°52.201' E		
G	22°16.609' N 113°52.395' E		
H	22°16.695' N 113°52.572' E		
I	22°16.903' N 113°51.029' E		
4	BETWEEN P0 AND P3 (i.e. 4(a)) THE AREA OF THE WATERS OF HONG KONG BOUNDED BY THE STRAIGHT LINES JOINING THE FOLLOWING POSITIONS-	NO VESSEL WHICH HAS A HEIGHT EXCEEDING 5 METRES ABOVE SEA LEVEL SHALL ENTER OR PASS THROUGH	
	A		22°16.860' N 113°51.160' E
	B		22°16.745' N 113°51.114' E
	M		22°16.787' N 113°50.988' E
	L		22°17.244' N 113°53.658' E
			22°16.967' N 113°53.211' E
	V		22°17.067' N 113°53.135' E
	U		22°17.511' N 113°53.809' E
	J		22°17.067' N 113°53.135' E
	K		22°17.511' N 113°53.809' E

Annex G (Portion adjacent to the Airport)

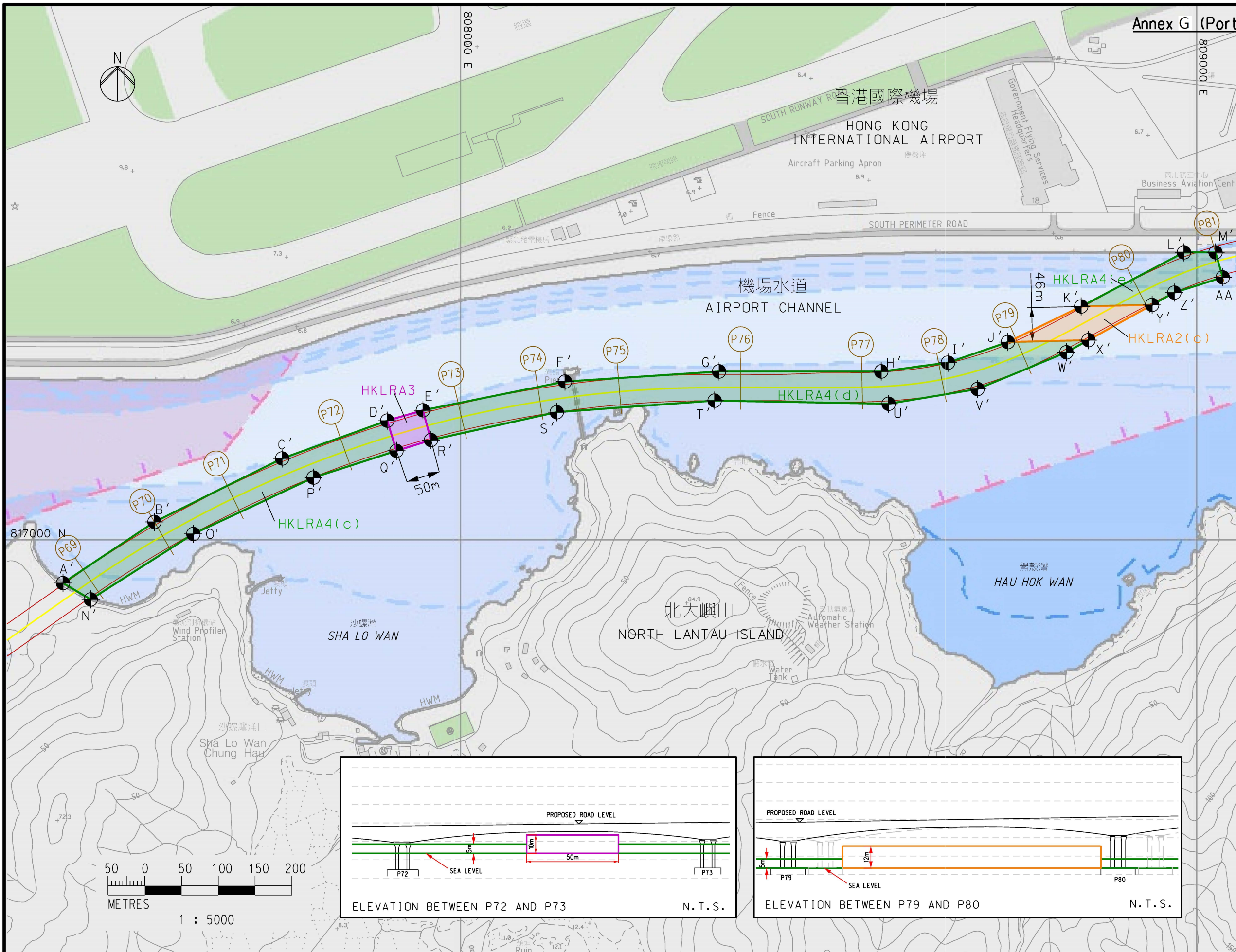

HKLR AREA NO.	COORDINATES OF THE BOUNDARIES (REPRESENTED BY THE WGS 84)	RESTRICTIONS
2 HKLRA2	BETWEEN P79 AND P80 (i.e. 2(c)) THE AREA OF THE WATERS OF HONG KONG BOUNDED BY THE STRAIGHT LINES JOINING THE FOLLOWING POSITIONS:-	
	Y'	22°17.675' N 113°54.701' E
	X'	22°17.649' N 113°54.650' E
	J'	22°17.648' N 113°54.587' E
	K'	22°17.674' N 113°54.645' E
3 HKLRA3	BETWEEN P72 AND P73 THE AREA OF THE WATERS OF HONG KONG BOUNDED BY THE STRAIGHT LINES JOINING THE FOLLOWING POSITIONS:-	
	E'	22°17.597' N 113°54.124' E
	R'	22°17.575' N 113°54.130' E
	Q'	22°17.567' N 113°54.103' E
	D'	22°17.589' N 113°54.096' E
4 HKLRA4	BETWEEN P69 AND P72 (i.e. 4(c)) THE AREA OF THE WATERS OF HONG KONG BOUNDED BY THE SHORE AND STRAIGHT LINES JOINING THE FOLLOWING POSITIONS:-	
	A'	22°17.469' N 113°53.839' E
	B'	22°17.514' N 113°53.911' E
	C'	22°17.561' N 113°54.012' E
	D'	22°17.589' N 113°54.096' E
	Q'	22°17.567' N 113°54.103' E
	P'	22°17.547' N 113°54.037' E
	O'	22°17.505' N 113°53.942' E
	N'	22°17.457' N 113°53.861' E
	BETWEEN P73 AND P79 (i.e. 4(d)) THE AREA OF THE WATERS OF HONG KONG BOUNDED BY THE STRAIGHT LINES JOINING THE FOLLOWING POSITIONS:-	
	X'	22°17.649' N 113°54.650' E
	W'	22°17.640' N 113°54.633' E
	V'	22°17.613' N 113°54.563' E
	U'	22°17.602' N 113°54.492' E
	T'	22°17.604' N 113°54.355' E
	S'	22°17.595' N 113°54.230' N
	R'	22°17.575' N 113°54.130' E
E'	22°17.597' N 113°54.124' E	
F'	22°17.618' N 113°54.236' E	
G'	22°17.626' N 113°54.358' E	
H'	22°17.626' N 113°54.487' E	
I'	22°17.632' N 113°54.539' E	
J'	22°17.648' N 113°54.587' E	
BETWEEN P80 AND P81 (i.e. 4(e)) THE AREA OF THE WATERS OF HONG KONG BOUNDED BY THE STRAIGHT LINES JOINING THE FOLLOWING POSITIONS:-		
M'	22°17.714' N 113°54.751' E	
AA'	22°17.696' N 113°54.757' E	
Z'	22°17.684' N 113°54.718' E	
Y'	22°17.675' N 113°54.701' E	
K'	22°17.674' N 113°54.645' E	
L'	22°17.714' N 113°54.725' E	

Drawing Title
THE LOCATIONS OF HONG KONG LINK ROAD (HKLR) AREAS NO. 1 TO 4

(SHEET 2 OF 2)

Drawn JL	Date 26/01/2017	Drawing No. 09-SS-2749
Checked DC	Approved TS	
Scale 1:5000 IN A3	Rev Description	Status PRELIMINARY
Rev Description	Date	Rev C