



土木工程拓展署

Civil Engineering and Development
Department

西拓展處

West Development Office

Web site 網址 : <http://www.cedd.gov.hk>
E-mail 電子郵件 : chwong@cedd.gov.hk
Telephone 電話 : (852) 2417 6332
Facsimile 傳真 : (852) 2412 0358
Our ref 本署檔號 : () in CEDD WDO-30-4020-10117-1
Your ref 來函檔號 :
Date 日期 : 15 January 2019

西發展部 (2)
West Division (2)
新界荃灣西樓角路 38 號
荃灣政府合署 25 樓
25/F, Tsuen Wan Government Offices,
38 Sai Lau Kok Road, Tsuen Wan
New Territories, Hong Kong

BY EMAIL (dwyl@legco.gov.hk)

Clerk to Public Works Subcommittee
Legislative Council Secretariat
Legislative Council Complex
1 Legislative Council Road
Central, Hong Kong
(Attn: Ms Doris LO)

Dear Ms LO,

Re: Capital Works Reserve Fund Block Allocations for 2019-2020:
HEAD 701 Subhead 1100CA Cycle track between Tsuen Wan and Tuen Mun
(advance works)

Thank you for referring the enquiry of Hon CHU Hoi-dick on 11 January 2019 regarding the above matter. Our reply is as follows:

The cycle track section between Tsuen Wan and Tuen Mun is about 22 kilometres (km) in length. The alignment plan is at **Annex 1**.

The Advance Works comprise a cycle track section between Tsing Tsuen Bridge and Tsuen Wan Bayview Garden is about 2.3 km in length and about 4 metres (m) in width with footpath of about 2 m in width, details at **Annex 2**. The construction commenced in September 2018 for completion in 2020 Q4. We have regularly reported the latest progress to the Coastal Affairs Committee of Tsuen Wan District Council.

The proposed cycle track section between Bayview Garden and So Kwun Wat is about 15.2 km in length and about 4 m in width with footpath of about 2 m in width. The proposed cycle track alignment will in general run along the shoreline. We consulted the District Councils, residents and relevant stakeholders about the proposed alignment. We are currently assessing and reviewing the feasibility of different alignment options taking into consideration comments received, the existing site conditions and technical considerations. When the proposed alignment is available, we shall commence the next phase of consultation as early as possible.

.../2

The proposed cycle track section between Tuen Mun and So Kwun Wat is about 4.5 km in length and about 4 m in width with footpath of about 2 m in width. We have all along maintained close liaison with relevant local district councilors and stakeholders, and consulted the Environment, Hygiene and District Development Committee of Tuen Mun District Council about the proposed alignment options. We recently reported the latest proposed cycle track alignment option on 23 November 2018, and we are currently reviewing the relevant alignment options taking into consideration comments from the Committee Members.

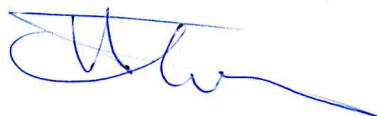

(WONG Chi Hung)
for Director of Civil Engineering and
Development Department

Encl.

c.c.

DEVB Works Branch (Attn: Mr. KWOK Chun Wai, Stephen) Fax: 2810 8502

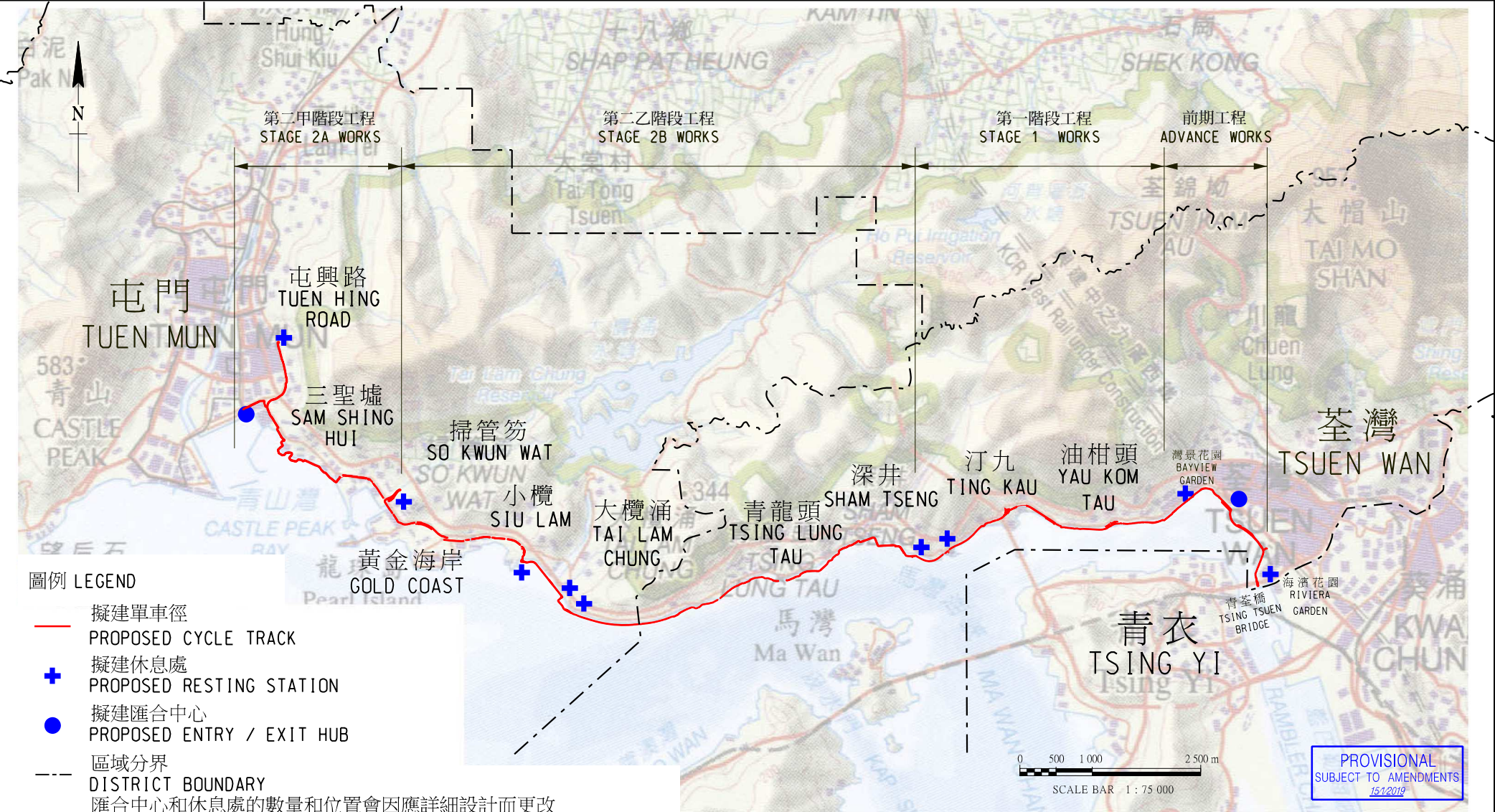

圖則名稱 drawing title 工務計劃項目第7268RS號 - 荃灣至屯門單車徑 - 走線圖 PWP ITEM 7268RS - CYCLE TRACK BETWEEN TSUEN WAN AND TUEN MUN ALIGNMENT PLAN	編號 no.	日期 date	內容摘要 description	核對 checked	核准 approved
	修訂 REVISION				
	繪圖 drawn W.L. SUEN	簽署 initial 日期 date 15.01.19	項目編號 item no. 7268RS	辦事處 office 西拓展處 WEST DEVELOPMENT OFFICE	
	核對 checked W.K. HO	簽署 initial 日期 date 15.01.19	比例 scale 1:75 000		
	核准 approved L.K. TSANG	簽署 initial 日期 date 15.01.19	圖則編號 drawing no. WDOTW-Z0061	土木工程拓展署 CIVIL ENGINEERING AND DEVELOPMENT DEPARTMENT	

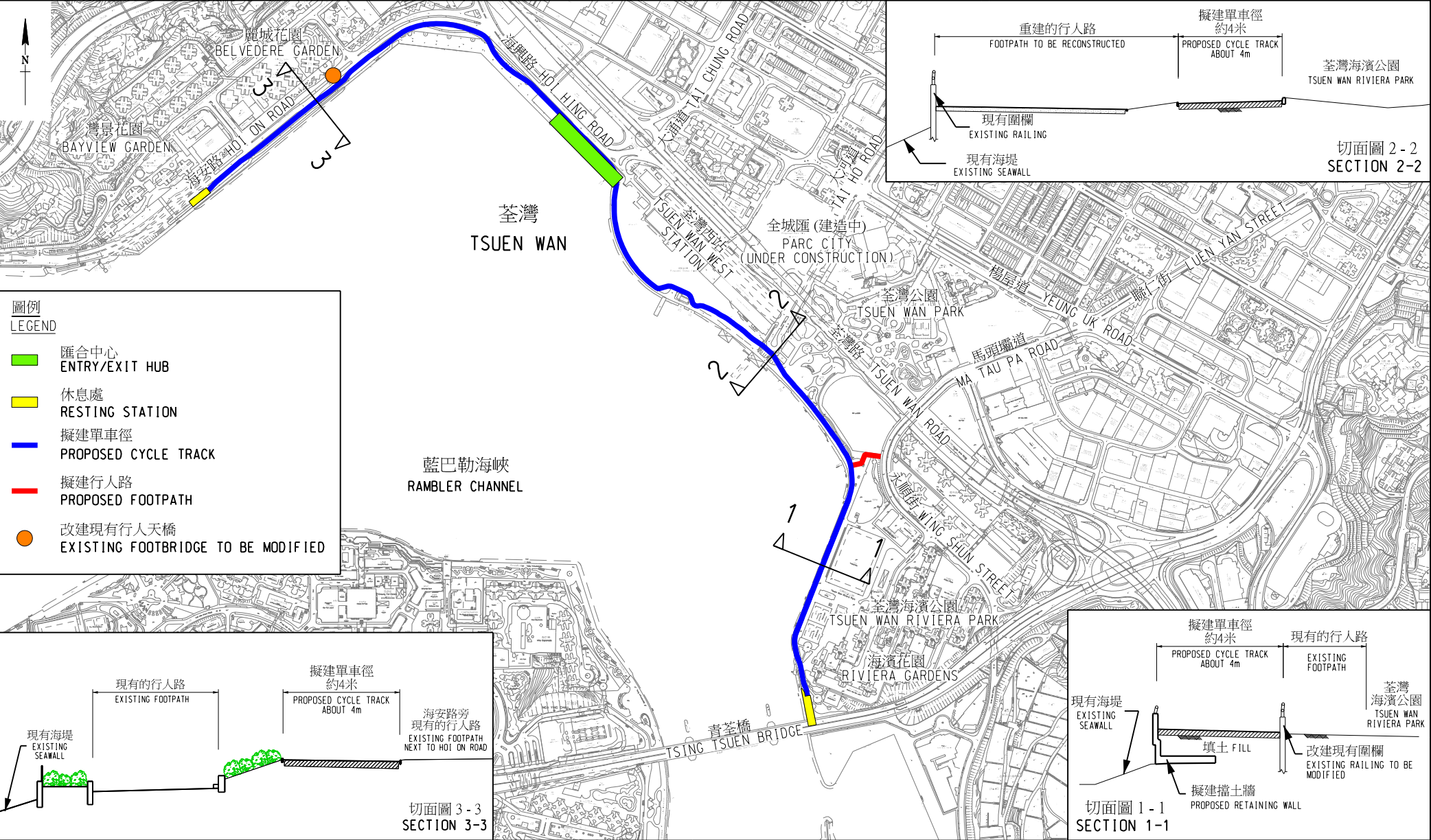

圖則名稱 drawing title

7268RS號(部分) - 荃灣至屯門單車徑 - 前期工程 走線圖
7268RS(PART) - ALIGNMENT PLAN : CYCLE TRACK BETWEEN TSUEN WAN AND
TUEN MUN - ADVANCE WORKS

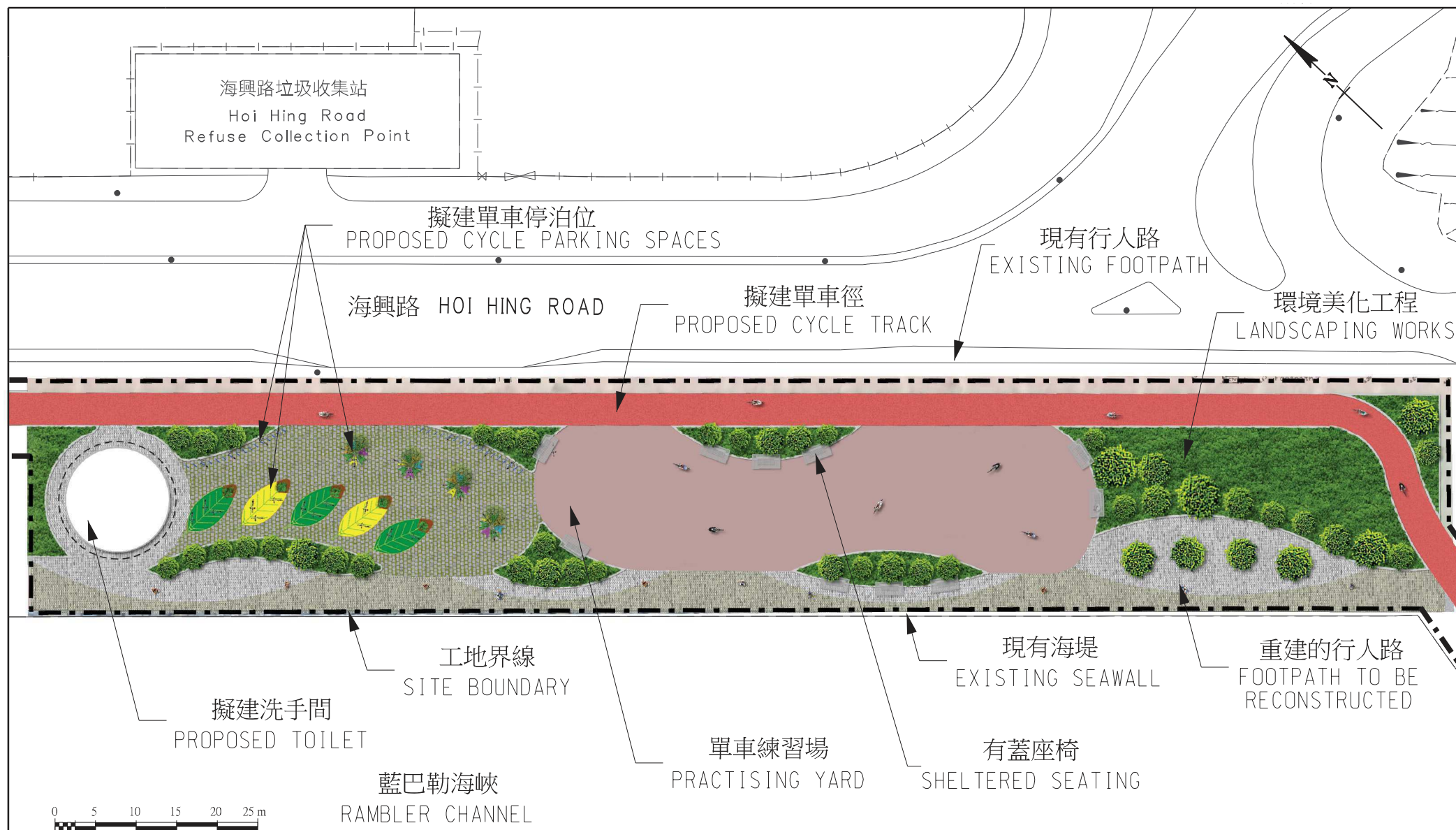

圖則名稱 drawing title

7268RS號(部分)

7268RS(PART)

- 港鐵荃灣西站附近的匯合中心 平面圖

- LAYOUT OF THE ENTRY / EXIT HUB NEAR MTR TSUEN WAN WEST STATION

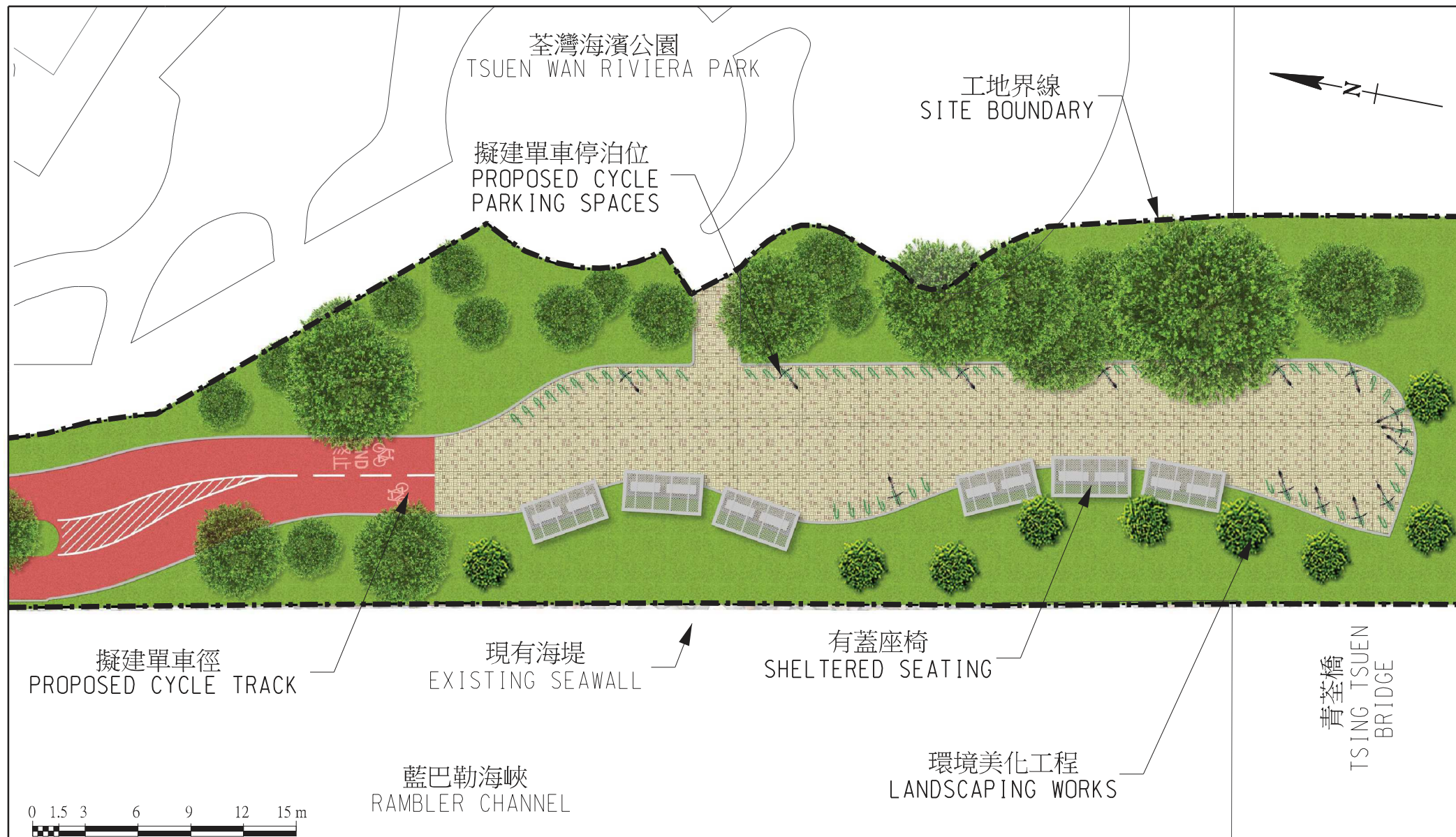

圖則名稱 drawing title

7268RS號(部分)

7268RS(PART)

- 青荃橋附近休息處 平面圖

- LAYOUT OF THE RESTING STATION NEAR TSING TSUEN BRIDGE

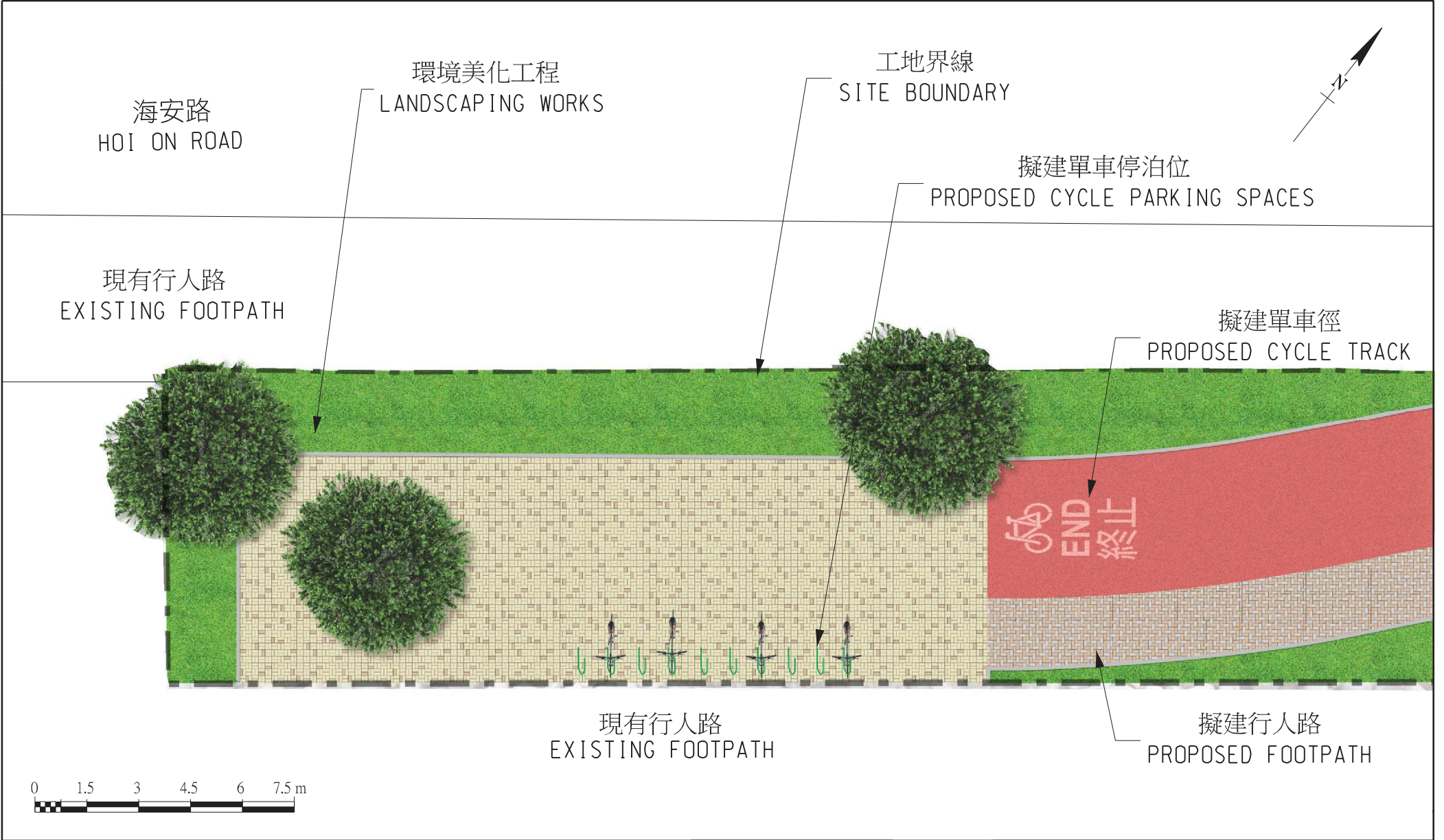

圖則名稱 drawing title

灣景花園附近休息處 平面圖
LAYOUT OF THE RESTING STATION NEAR BAYVIEW GARDEN



圖則名稱 drawing title

7268RS號(部分)

7268RS(PART)

- 改建的現有行人天橋及建造的升降機構思圖

- ARTIST'S IMPRESSION SHOWING THE MODIFIED FOOTBRIDGE AND LIFT INSTALLED