

**For discussion
on 30 March 2021**

Legislative Council Panel on Education

**8097EB – In-situ Redevelopment of Wa Ying College
at 8 Sheung Wo Street, Kowloon**

PURPOSE

There is redevelopment need of Wa Ying College (WYC) to improve its learning and teaching environment. This paper briefs Members on the scope and timeline for the implementation of the proposed in-situ redevelopment project.

PROJECT SCOPE AND NATURE

2. The project scope includes the demolition of the existing buildings of the School and construction of a 30-classroom secondary school premises on the cleared site at an estimated cost of about \$473.3 million in money-of-the-day prices to provide the following facilities –

- (a) 30 classrooms;
- (b) three small group teaching rooms;
- (c) six special rooms, comprising a music room, a visual arts room, a computer assisted learning room, a multi-purpose room and two integrated science laboratories;
- (d) 11 equipment-based multi-purpose rooms, comprising a biology laboratory, a preparation room for biology laboratory¹, a physics laboratory, a chemistry laboratory, a preparation room for physics and chemistry laboratory, a dark room for physics, a design and technology workshop, a needlework room, a home management room, a

¹ The preparation room for biology laboratory is made up of two rooms to suit the floor layout.

geography room and a computer room;

- (e) a library-cum-language room;
- (f) a guidance activity room;
- (g) two interview rooms;
- (h) a staff room and a staff common room;
- (i) a conference room;
- (j) an assembly hall;
- (k) a student activity centre;
- (l) covered playgrounds;
- (m) multi-purpose areas;
- (n) two basketball courts; and
- (o) ancillary facilities including an accessible/fireman's lift, facilities for the disabled, a tuck shop-cum-central portioning area, stores and toilets, etc.

3. The proposed new school premises located at 8 Sheung Wo Street with a site area of about 4 533 square metres (m²) will meet the planning target of providing 2 m² of open space per student. The site and location plan, and an artist's impression of the new school premises are at **Enclosures 1 and 2** respectively.

JUSTIFICATION

4. It is the Government's plan to, based on the needs of individual schools, improve the physical conditions and facilities of school premises not built according to the prevailing standards through re-provisioning and

redevelopment projects. WYC is a co-educational aided secondary school with 24 operating classes. The main school building of WYC was built in 1971. Although the school has benefited from the School Improvement Programme (SIP) previously, it still lacks certain standard facilities such as small group teaching room, computer assisted learning room, student activity centre. In addition, some of its existing facilities such as classrooms, music room, laboratories, visual arts room, library and language room are under-sized according to prevailing standards. The proposed redevelopment project will upgrade the facilities of the school to meet the prevailing standards, and improve the teaching and learning environment.

5. During redevelopment, WYC will be temporarily accommodated at the ex-premises of Cognitio College (Kowloon) at 96 King Fuk Street, San Po Kong.

6. Upon completion of the proposed capital works project, WYC may operate up to 30 classes in the new school premises, subject to the actual enrolment and operational needs.

IMPLEMENTATION PLAN

7. We will seek the endorsement and funding approval of the Public Works Subcommittee and the Finance Committee (FC) of the Legislative Council respectively on the proposed project in accordance with the established mechanism. WYC plans to commence the proposed works upon obtaining funding approval from the FC for target completion in around three years.

PUBLIC CONSULTATION

8. We provided the Social Services Committee of the Kowloon City District Council with an information paper on the latest details of the proposed in-situ redevelopment project in December 2020. Members of the Committee did not raise any concern about the project.

Education Bureau
March 2021

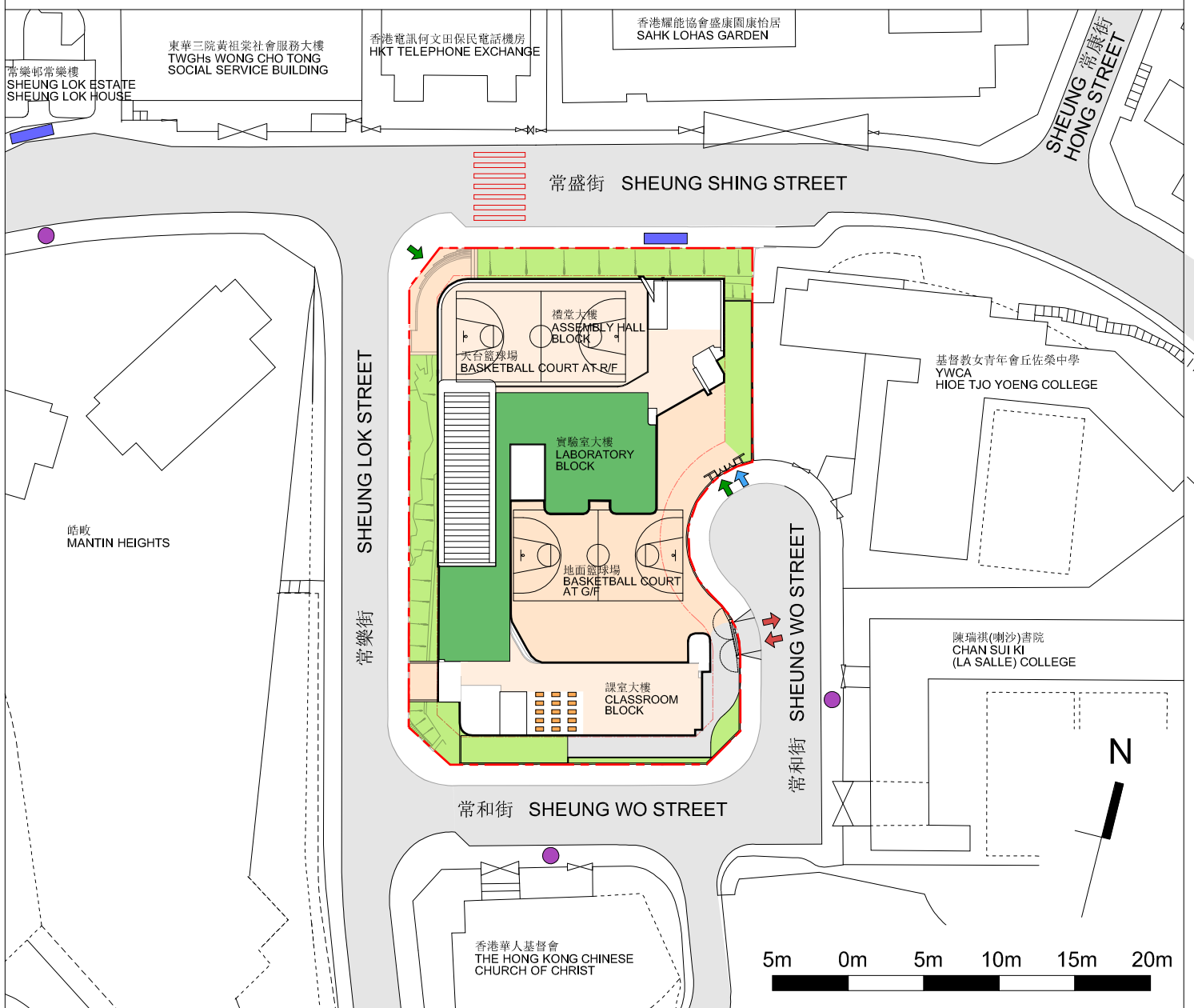
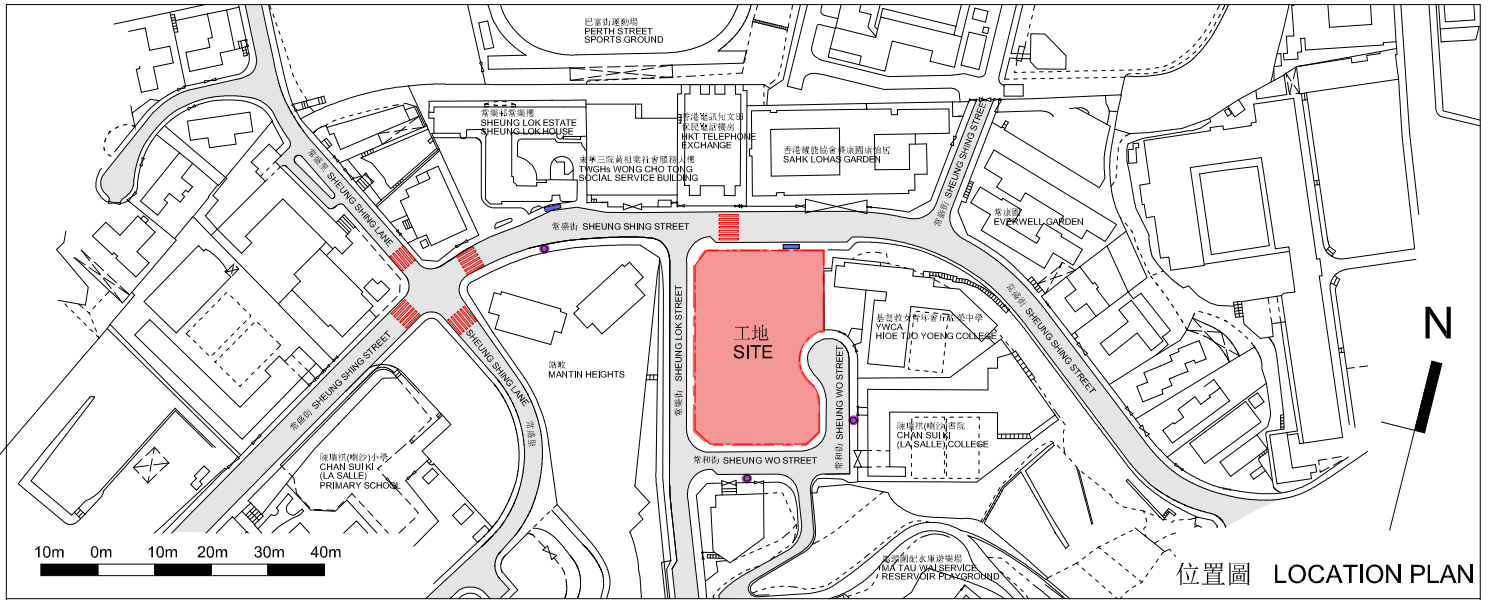

- | | | | | | | | |
|----------------------------|--|--|-------------------------------------|-------------------------------------|---------------------------|-------------------------|---------------------------------------|
| 工地界線
SITE BOUNDARY | 現有行人過路處
EXISTING AT-GRADE PEDESTRIAN CROSSING | 太陽能光伏板
PHOTOVOLTAIC PANEL | 行人出入口
PEDESTRIAN ENTRANCE / EXIT | 車輛出入口
VEHICULAR INGRESS / EGRESS | 地面綠化
AT-GRADE GREENING | 天台綠化
LANDSCAPED ROOF | 通道 / 露天場地
CIRCULATION / OPEN SPACE |
| 現有巴士站
EXISTING BUS STOP | 現有小巴士站
EXISTING MINIBUS STOP | 無障礙出入口
BARRIER-FREE ENTRANCE / EXIT | | | | | |

8097EB
九龍常和街8號華英中學重建計劃
IN-SITU REDEVELOPMENT OF WA YING COLLEGE AT 8 SHEUNG WO STREET, KOWLOON



從西面望向中學的構思透視圖
PERSPECTIVE VIEW FROM WESTERN DIRECTION



從東面望向中學的構思透視圖
PERSPECTIVE VIEW FROM EASTERN DIRECTION

構思圖
ARTIST'S IMPRESSION

8097EB
九龍常和街8號華英中學重建計劃
IN-SITU REDEVELOPMENT OF WA YING COLLEGE AT
8 SHEUNG WO STREET, KOWLOON