

**For discussion
on 12 March 2021**

Legislative Council Panel on Health Services

**Three Projects under the First Ten-year Hospital Development Plan and
An Update on the First Ten-year Hospital Development Plan**

Purpose

This paper invites Members' comments on the following three projects under the First Ten-year Hospital Development Plan (HDP) and briefs Members on an update on the First Ten-year HDP –

- (a) main works for the construction of New Acute Hospital at Kai Tak Development Area at an estimated cost of \$36,860.0 million in money-of-the-day (MOD) prices;
- (b) site formation and foundation works for the expansion of North District Hospital at an estimated cost of \$2,141.0 million in MOD prices; and
- (c) site formation and foundation works for the expansion of Lai King Building in Princess Margaret Hospital at an estimated cost of \$408.4 million in MOD prices.

_____ The total commitment sought is \$39,409.4 million. Details of the above three HDP projects and the update on the First Ten-year HDP are at **Enclosures 1 to 4** respectively.

Background

2. In the 2016 Policy Address, the Government announced that \$200 billion would be set aside for the Hospital Authority to implement the First Ten-year HDP. The First Ten-year HDP covers the redevelopment and expansion of 11 hospitals, the construction of a new acute hospital, three community health centres and one supporting services centre. Upon completion of all the projects under the First Ten-year HDP, it will provide more than 6 000 additional bed

spaces, 94 additional operating theatres and increased capacity of specialist outpatient clinics and general outpatient clinics.

3. To date, the Government has upgraded the following HDP projects (involving 12 hospitals, one community health centre and one supporting services centre) to Category A –

(a) seven projects in full –

- (i) the extension of Operating Theatre Block for Tuen Mun Hospital;
- (ii) the expansion of Haven of Hope Hospital;
- (iii) the redevelopment of Queen Mary Hospital, phase 1 – main works;
- (iv) the redevelopment of Kwai Chung Hospital;
- (v) the expansion of United Christian Hospital;
- (vi) the construction of a community health centre cum social welfare facilities at Pak Wo Road, North District; and
- (vii) the construction of Hospital Authority Supporting Services Centre; and

(b) seven projects in part (involving 11 items) –

- (i) the redevelopment of Kwong Wah Hospital, phase 1 – demolition and substructure works;
- (ii) the redevelopment of Kwong Wah Hospital, phase 1 – superstructure and associated works;
- (iii) New Acute Hospital at Kai Tak Development Area – preparatory works;
- (iv) New Acute Hospital at Kai Tak Development Area – foundation, excavation and lateral support, and basement excavation works;
- (v) the redevelopment of Prince of Wales Hospital, phase 2 (stage 1) – preparatory works;
- (vi) the redevelopment of Prince of Wales Hospital, phase 2 (stage 1) – demolition and foundation works;
- (vii) the redevelopment of Our Lady of Maryknoll Hospital – preparatory works;
- (viii) the redevelopment of Grantham Hospital, phase 1 – preparatory works;
- (ix) the redevelopment of Grantham Hospital, phase 1 – demolition, site formation and foundation works;
- (x) the expansion of North District Hospital – preparatory works; and
- (xi) the expansion of Lai King Building in Princess Margaret Hospital – preparatory works.

The total commitment approved for the items in paragraph 3(a) is \$47,967.6 million and that for paragraph 3(b) is \$22,173.0 million, totalling \$70,140.6 million or 35.1% of the \$200 billion. If the three proposed HDP projects in this submission are approved by the Finance Committee (FC), the cumulative commitment approved would amount to \$109,550.0 million or 54.8% of the \$200 billion.

Way Forward

4. Members are invited to note the current status and progress of the First Ten-year HDP as outlined in this paper. Subject to Members' comments on the three proposed HDP projects, we plan to seek funding support and approval for these projects from the Public Works Subcommittee and the FC respectively.

**Food and Health Bureau
Architectural Services Department
Hospital Authority
March 2021**

New Acute Hospital at Kai Tak Development Area

Proposed Project Scope and Timeline

We propose to carry out the main works of the construction project of New Acute Hospital (NAH) at Kai Tak Development Area (KTDA), which mainly comprise superstructure and associated works as follows –

- (a) construction of an acute hospital comprising five building blocks;
- (b) provision of a rooftop helipad solely for medical emergency services;
- (c) provision of a continuous traffic-free pedestrian waterfront promenade at the strip of land adjoining the site of the NAH;
- (d) construction of link bridges between sites in the NAH and between the NAH and Hong Kong Children's Hospital (HKCH); and
- (e) consultancy services for contract administration and site supervision.

2. We plan to seek funding approval from the Finance Committee (FC) to upgrade the proposed project to Category A in the current legislative session. The estimated cost of the proposed project is about \$36,860.0 million in money-of-the-day (MOD) prices. The Hospital Authority (HA) will invite tenders for the proposed works in March 2021 tentatively. Subject to the funding approval from the FC, we plan to award the contract to the successful tenderer and commence the proposed works for target completion in about three and a half years.

3. A site and location plan showing the location of the proposed main works and an artist's impression of the NAH are at **Annexes 1 and 2 to Enclosure 1** respectively.

Background and Justifications

4. The population of the Kowloon region¹ is projected to increase by

¹ The Kowloon region refers to the catchment districts of three hospital clusters in the HA, namely Kowloon

about 5% from 3 752 200 in 2019 to 3 923 600 in 2028; whereas the elderly population aged 65 or above will rise by about 50% from 664 300 in 2019 to 995 200 in 2028². To meet the long-term rising demand for healthcare services and facilities in Kowloon arising from the growing and ageing population, the Government has reserved sites in the KTDA for hospital development.

5. The Kai Tak Development is a major development project covering the ex-airport site, together with adjoining districts of Kowloon City, Wong Tai Sin and Kwun Tong. The KTDA will have a mix of housing, community, business, tourism and infrastructural uses. There is hence a pressing need for strengthening the provision of public hospital services by building a new acute hospital accessible to the population of the Kowloon region. In the 2015 Policy Address, the Government confirmed its commitment to pursue the construction of a new acute hospital in the KTDA. Subsequently, the NAH project was included as one of the projects under the First Ten-year Hospital Development Plan (HDP).

6. The HA formulated the Clinical Services Plan (CSP) for the Kowloon Central Cluster (KCC)³ in 2016, providing an overarching clinical development strategy and delineated the roles of individual hospitals within the cluster. According to the CSP, the NAH will take a leading role in coordinating care across the KCC. Hospitals and institutions in the KCC will adopt a collaborative approach to ensure comprehensive care and enhance service linkage for patients from various districts, including the KTDA, Kowloon City, Wong Tai Sin, Kwun Tong and Yau Tsim Mong, etc. In particular, Our Lady of Maryknoll Hospital, Wong Tai Sin Hospital and Hong Kong Buddhist Hospital will form a service network with the NAH while Kowloon Hospital will provide convalescent and rehabilitation services for patients transferred from Kwong Wah Hospital, another acute hospital in the KCC.

7. As guided by the CSP and taking into account the roles of various hospitals in the Kowloon region, the NAH will be established as an acute hospital delivering a comprehensive range of healthcare services. The hospital will operate with modern service models and advanced technology and facilities. The NAH will provide 24-hour accident and emergency, in-patient, out-patient,

Central, Kowloon East and Kowloon West Clusters, which include Yau Tsim Mong, Kowloon City, Wong Tai Sin, Kwun Tong, Sai Kung, Sham Shui Po, Kwai Tsing, Tsuen Wan and Lantau Island.

² According to the population estimates published by the Census and Statistics Department and the report of “Projections of Population Distribution 2019-2028” compiled by the Planning Department.

³ The catchment districts of the KCC cover Yau Tsim Mong, Wong Tai Sin and Kowloon City.

ambulatory and rehabilitation services. In addition to being a designated trauma centre, the NAH will set up a neuroscience centre to maximise synergy through multi-specialty cooperation and shared use of high technology facilities while offering research and education to facilitate service development to improve the quality of care.

8. The services provided by the NAH will be complementary to that of the adjacent HKCH. We aim to comprehensively and adequately meet the long-term healthcare needs of local residents through the provision of the NAH at the KTDA, together with other hospitals and healthcare facilities in the KCC.

Proposed Development of the NAH at the KTDA

9. The proposed project involves the construction of a new acute hospital in the south apron of the KTDA and adjoining section of the waterfront promenade. The development of the NAH comprises five building blocks situated in two hospital sites. The five blocks include Acute Block, Administration Block, Education Block, Oncology Block and Specialist Out-patient Clinic Block. Link bridges and associated facilities connecting hospital sites and the HKCH will also be covered under the proposed project. Upon completion of the NAH, most of the services of Queen Elizabeth Hospital (QEH) will be relocated to the NAH, and the planning of the development at the vacated King's Park site will commence as appropriate, and in alignment with the timetable of the Second Ten-year HDP.

10. The proposed NAH construction project is being implemented in three works stages, namely (a) preparatory works; (b) foundation, excavation and lateral support, and basement excavation works; and (c) main works. The preparatory works of the project were deliberated at this Panel on 15 May 2017 (Paper Ref.: LC Paper No. CB(2)1352/16-17(03)) and the relevant funding application was approved by the FC on 19 July 2017 at an estimated cost of \$769.3 million in MOD prices covering site investigations and minor studies, and consultancy services for outline sketch plans, detailed design as well as tender documentation and assessment for the project. The preparatory works commenced in September 2017. The second stage of the project was submitted to this Panel on 19 March 2018 (Paper Ref.: LC Paper No. CB(2) 1022/17-18(05)) with the funding application approved by the FC on 18 May 2018 at an estimated cost of \$5,356.8 million in MOD prices. The scope included foundation works, excavation and lateral support works, basement excavation works, pile cap construction and basement slab works. The works have started since September 2018 and the piling works are in progress. Upon the completion of the whole construction project targeted for 2025, we aim to provide 2 400 in-

Enclosure 1







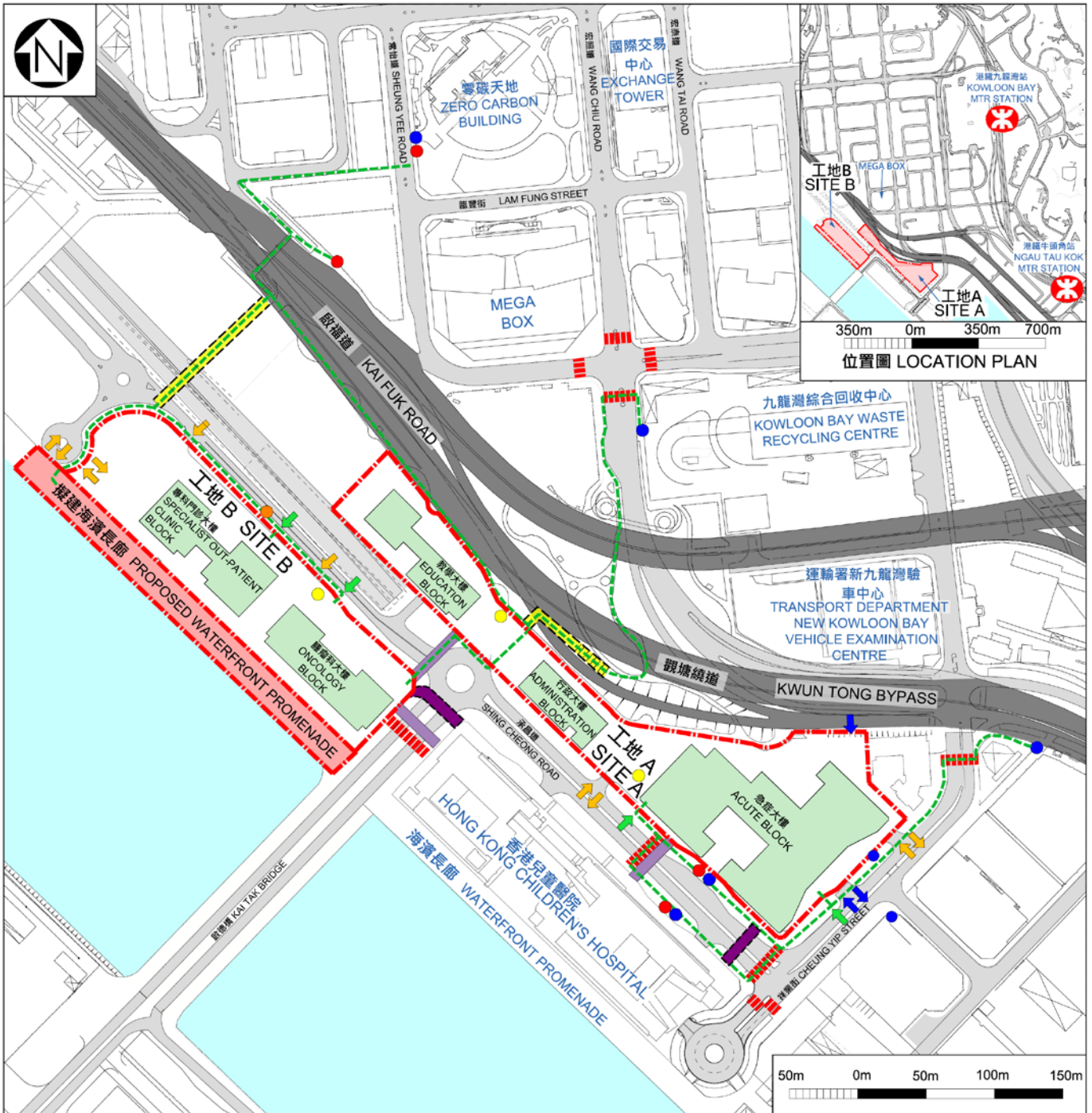







patient and day beds with associated medical and supporting facilities, 37 operating theatres, a neuroscience centre, an oncology centre, an annual capacity of specialist out-patient clinic attendance of 1 410 000, a community health centre, an oral maxillofacial surgery and dental unit, and a helipad.

Public Consultation

11. The HA consulted the Kwun Tong District Council (DC) and the Wong Tai Sin DC on 3 November 2020, the Kowloon City DC on 26 November 2020 and the Yau Tsim Mong DC on 29 December 2020 in respect of the project. Members of these four DCs in general supported the proposed project.



圖例 LEGEND

- | | | |
|--|--|--|
|  工地界線
SITE BOUNDARY |  現有行人過路處
EXISTING AT-GRADE PEDESTRIAN CROSSING |  行人/無障礙出入口
PEDESTRIAN / BARRIER-FREE ENTRANCE / EXIT |
|  擬建醫院連接橋
PROPOSED HOSPITAL LINK BRIDGE |  現有巴士站
EXISTING BUS STOP |  擬建車輛出入口
PROPOSED VEHICULAR INGRESS / EGRESS |
|  現有地下設施管道
EXISTING SERVICE TUNNEL |  現有小巴站
EXISTING MINIBUS STOP |  擬建救護車出入口
PROPOSED AMBULANCE INGRESS / EGRESS |
|  擬建新大樓
PROPOSED NEW BUILDINGS |  擬建巴士站
PROPOSED BUS STOP |  無障礙通道
BARRIER-FREE ACCESS |
|  擬建海濱長廊
PROPOSED WATERFRONT PROMENADE |  擬建小巴站
PROPOSED MINIBUS STOP |  擬建公共連接橋(由土木工程拓展署興建)
PROPOSED PUBLIC LINK BRIDGE (BY CEDD) |

工地平面圖
SITE PLAN

87MM
在啟德發展區興建新急症醫院
NEW ACUTE HOSPITAL AT KAI TAK DEVELOPMENT AREA



總體立面概念圖
CAMPUS-WIDE FACADE CONCEPT

構思圖
ARTIST'S IMPRESSION

87MM
在啟德發展區興建新急症醫院
NEW ACUTE HOSPITAL AT KAI TAK DEVELOPMENT AREA

Expansion of North District Hospital

Proposed Project Scope and Timeline

We propose to carry out part of the expansion project of North District Hospital (NDH), which comprises site formation and foundation works and associated works as follows –

- (a) site formation works including tree felling and transplanting, demolition and associated slope stabilisation works, and related decanting works for the existing accident and emergency (A&E) outbuilding and its associated facilities;
- (b) foundation works, basement excavation and lateral support works, and pile cap and base slab construction works for the new acute block;
- (c) associated utilities diversion;
- (d) related access and road works in the NDH; and
- (e) consultancy services for contract administration and site supervision.

2. We plan to seek funding approval from the Finance Committee (FC) to upgrade the proposed part of the expansion project to Category A in the current legislative session. The estimated cost of the proposed works as described above is about \$2,141.0 million in money-of-the-day (MOD) prices. The Hospital Authority (HA) will invite tenders for the proposed works in March 2021 tentatively. Subject to the funding approval from the FC, we plan to award the contract to the successful tenderer and commence the proposed works for target completion in about two years.

3. A site and location plan showing the location of the proposed site formation and foundation works is at **Annex 1 to Enclosure 2**.

Background and Justifications

4. Established in 1998, the NDH is an acute hospital in the New Territories East Cluster of the HA, serving patients from Sha Tin, Tai Po and North districts with a planned capacity of about 600 beds. It provides 24-hour A&E service and a wide range of secondary care services with emphasis on ambulatory care as well as community outreach services.

5. The combined population in the three districts of Sha Tin, Tai Po and North District is projected to increase by about 12% from 1 318 700 in 2019 to 1 483 500 in 2028. In particular, the population in North District will increase by about 33% from 317 600 in 2019 to 421 500 in 2028. That aside, the elderly population aged 65 or above in North District is also projected to increase by about 70% from 54 700 in 2019 to 93 200 in 2028¹.

6. Over the years, the existing facilities at the NDH have become inadequate in terms of space, capacity and design to cope with the increasing service demands and modern quality standards and developments in service delivery. Key challenges faced by the NDH include (a) the increasing demand for emergency service has long outgrown the planned capacity of the A&E Department, with a perennial problem of overcrowding that poses risks to patient privacy, infection control and timeliness of care delivery; (b) there is a dire need to enhance the capability and capacity of the NDH in the management of infectious and communicable diseases through increased provision of specially designed isolation rooms and infection control facilities; (c) there is an urgent need for upgrading the diagnostic and treatment facilities and equipment to the prevailing standards; and (d) development of convalescent and rehabilitation services in the NDH is required to facilitate continuity of care and meet the healthcare needs of the local community.

Proposed Expansion of the NDH

7. We propose to expand the NDH in order to meet the healthcare needs in North District in the long term. The expansion of the NDH comprises construction of a new acute block; renovation and alterations of the existing hospital building and the provision of associated internal roadworks as well as external works and landscaping works. Implementation of the expansion project includes three works stages, namely (a) preparatory works; (b) site formation and foundation works; and (c) main works. The preparatory works of the expansion project were deliberated at this Panel on 18 March 2019 (Paper Ref.: LC Paper No. CB(2)964/18-19(03)) and the relevant funding application was approved by the FC on 22 November 2019 at an estimated cost of \$481.3 million in MOD prices covering site investigations and minor studies, demolition, re-provision and associated minor alteration works of existing buildings and facilities in the NDH,

¹ According to the report of “Projections of Population Distribution 2019-2028” compiled by the Planning Department.

Enclosure 2

and consultancy services for outline sketch design, detailed design, tender documentation and assessment for the whole project as well as contract administration, management of resident site staff (RSS) and remuneration of RSS for demolition and re-provisioning works. The preparatory works have commenced since December 2019. We plan to commence the site formation and foundation works upon obtaining approval from the FC. For the main works, separate funding approval will be sought at a later stage to dovetail with the implementation programme. Upon the completion of the whole expansion project targeted for 2028, we aim to provide around 1 500 additional beds in the NDH. The NDH will remain functional at all times during the works period and any disruption of services, if unavoidable, will be kept to a minimum.

Public Consultation

8. The HA consulted the North District Council (NDC) on 9 February 2021 in respect of the NDH expansion project. Members of the NDC in general supported the proposed project.

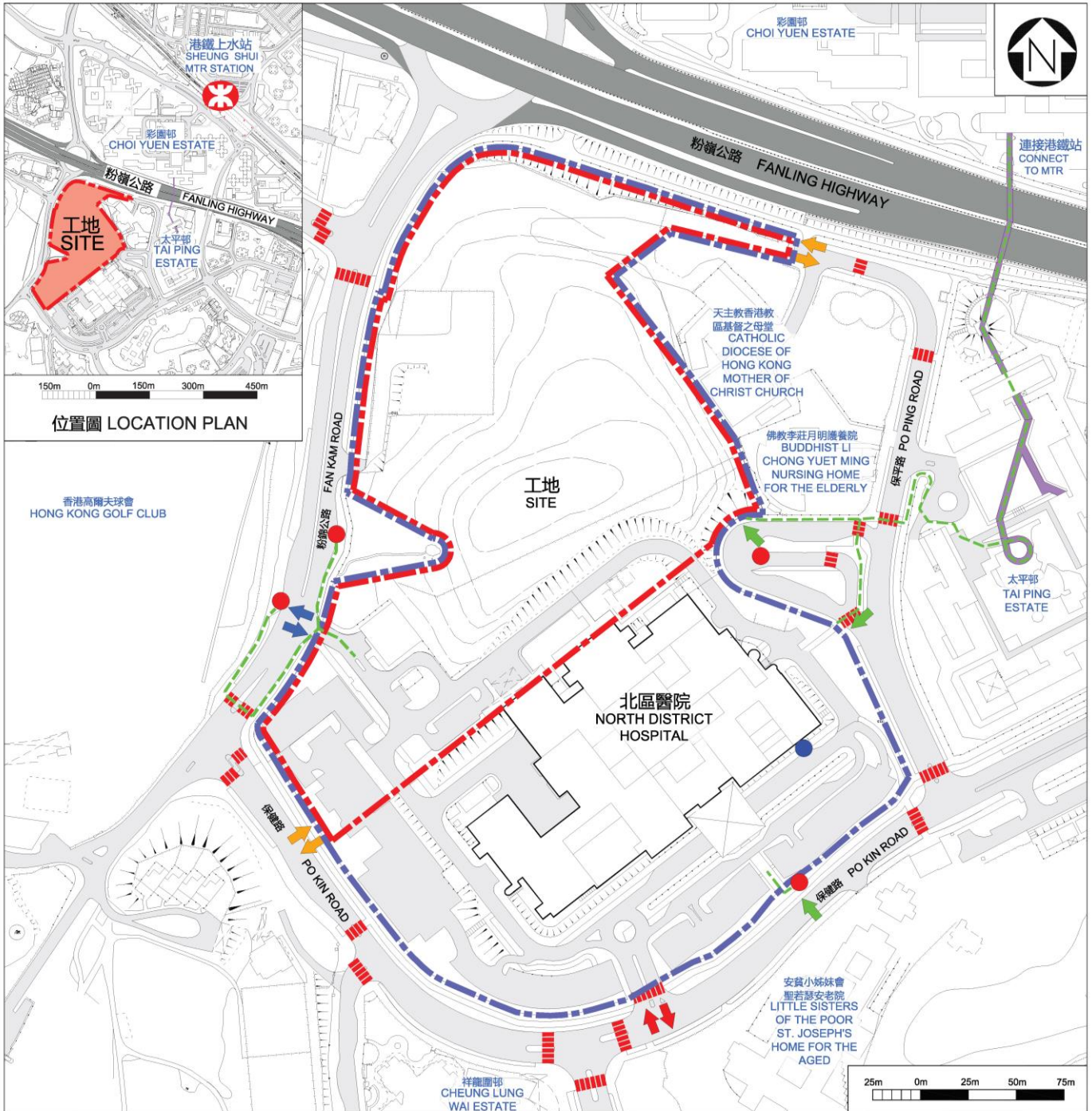

圖例 LEGEND

- | | | | | | |
|---|---|---|-------------------------------------|---|---|
|  | 醫院範圍
HOSPITAL BOUNDARY |  | 現有巴士站
EXISTING BUS STOP |  | 擬建車輛出入口
PROPOSED VEHICULAR
INGRESS / EGRESS |
|  | 工地界線
SITE BOUNDARY |  | 現有小巴士站
EXISTING MINIBUS STOP |  | 擬建救護車出入口
PROPOSED AMBULANCE
INGRESS / EGRESS |
|  | 現有行人過路處
EXISTING AT-GRADE PEDESTRIAN
CROSSING |  | 車輛出入口
VEHICULAR INGRESS / EGRESS |  | 行人 / 無障礙出入口
PEDESTRIAN / BARRIER-FREE
ENTRANCE / EXIT |
|  | 無障礙通道
BARRIER-FREE ACCESS |  | 有蓋行人道
COVERED WALKWAY | | |

工地平面圖
SITE PLAN

3MI
北區醫院擴建計劃
EXPANSION OF NORTH DISTRICT HOSPITAL

Expansion of Lai King Building in Princess Margaret Hospital

Proposed Project Scope and Timeline

We propose to carry out part of the expansion project of Lai King Building (LKB) in Princess Margaret Hospital (PMH), which comprises site formation and foundation works and associated works as follows –

- (a) site formation works including demolition of the existing structure at the rehabilitation garden and the transformer room, and tree felling and transplanting;
- (b) foundation works for the new extension block;
- (c) enabling works for basement, including excavation, lateral support works and support for the existing public sewer to be diverted;
- (d) diversion of underground utilities, installation of new sewer pipe along Lai Kong Street, provision of temporary transformer and generator set, and reprovision of the vacuum insulated evaporator tank; and
- (e) consultancy services for contract administration and site supervision.

2. We plan to seek funding approval from the Finance Committee (FC) to upgrade the proposed part of the expansion project to Category A in the current legislative session. The estimated cost of the proposed works as described above is about \$408.4 million in money-of-the-day (MOD) prices. The Hospital Authority (HA) will invite tenders for the proposed works in March 2021 tentatively. Subject to the funding approval from the FC, we plan to award the contract to the successful tenderer and commence the proposed works for target completion in about two years.

3. A site and location plan showing the location of the proposed site formation and foundation works is at **Annex 1 to Enclosure 3**.

Background and Justifications

4. Established in 1975, the PMH is a major acute hospital in the Kowloon West Cluster (KWC) of the HA, serving patients from Kwai Tsing

District and other districts in the KWC. It provides a comprehensive range of acute, specialist and ambulatory services, including 24-hour accident and emergency service. Apart from being a tertiary referral centre for infectious diseases, nephrology and urology, the PMH is also the cluster referral centre for oncology, trauma, renal transplant and dialysis, lithotripsy, pulmonary medicine and tuberculosis, high risk obstetrics care as well as paediatric and neonatal intensive care. The LKB, established in 2001, is an off-site facility of the PMH providing convalescent, rehabilitation and infirmary in-patient services.

5. Over the years, the population in the KWC has been growing considerably. The population in Sham Shui Po, Kwai Tsing, Tsuen Wan and Lantau Island areas or districts is projected to increase by about 5% from 1 403 300 in 2019 to 1 468 200 in 2028, whereas the elderly population aged 65 or above will surge from 244 500 in 2019 to 362 000 in 2028, representing a significant increase of about 48%¹. The ageing population contributed to the increasing demand for comprehensive medical care, especially convalescent and infirmary support.

6. The utilisation of the PMH's services has been consistently high. The bed occupancy rate in the PMH was about 90% in 2019-20, as compared with the HA average of about 86%. The total number of in-patient and day in-patient discharges and deaths in the PMH also escalated from 113 996 in 2009-10 to 155 012 in 2019-20, representing an increase of about 36% which outran the HA average of about 31%. The heavy service demand has aggravated the inadequacy in the existing capacity of the PMH.

7. The design of the PMH, which has a history of over 40 years, has become outdated and lagged behind the service requirements and workflow logistics of a modern tertiary acute hospital. The floor plates in clinical blocks are very small by current standards, rendering the advancement in medical technology difficult. In particular, the spacing between beds in wards is suboptimal from prevailing standard for quality patient care while nurse stations are provided at locations not convenient for close observation of patients. The physical conditions and structural capacity of the buildings are also exacerbated by heavy utilisation for decades, hindering the upgrading of building services systems to meet increasing operational needs.

8. Apart from space limitations, the piecemeal developments in the past have resulted in the clinical blocks of the PMH being scattered over the hospital site which impede the provision of co-ordinated services and efficient workflow

¹ According to the population estimates published by the Census and Statistics Department and the report of "Projections of Population Distribution 2019-2028" compiled by the Planning Department.

logistics conducive to optimal clinical outcomes. At present, the existing PMH compound is already packed with more than ten building blocks and there is no room for further expansion to meet the projected increase in service demands. The unsatisfactory geographical location and connectivity among the buildings have also undermined the development of the PMH.

Proposed Expansion of LKB in PMH

9. The HA has developed a master development plan for the redevelopment of PMH, which aims to renew the hospital to modernise its facilities to cope with the growing clinical service demand. To make available the redevelopment site, additional space and floor areas are required for decanting the existing services and supporting accommodation. In addition to facilitating the decanting of existing services in PMH, the proposed expansion of the LKB aims to enhance its ambulatory care services to reduce unnecessary hospitalisation and to ensure that its facilities comply with the infection control and service standards in modern health care settings.

10. The expansion of the LKB comprises the demolition of the existing structure at the rehabilitation garden and the transformer room at the LKB, construction of a new extension block, conversion/renovation of the existing building as well as construction of link bridges to connect the new extension block and the existing building. Implementation of the expansion project includes three works stages, namely (a) preparatory works; (b) site formation and foundation works; and (c) main works. The preparatory works of the expansion project were deliberated at this Panel on 18 March 2019 (Paper Ref.: LC Paper No. CB(2)964/18-19(03)) and the relevant funding application was approved by the FC on 22 November 2019 at an estimated cost of \$104.0 million in MOD prices covering site investigations, minor studies and associated service diversion and minor alteration works in the LKB, and consultancy services for outline sketch design, detailed design as well as tender documentation and assessment for the whole project. The preparatory works have commenced since December 2019. We plan to commence the site formation and foundation works upon obtaining funding approval from the FC. For the main works, separate funding approval will be sought at a later stage to dovetail with the implementation programme. Upon the completion of the whole expansion project targeted for 2026, we aim to provide 572 additional beds in the LKB. The LKB will remain functional at all times during the works period and any disruption of services, if unavoidable, will be kept to a minimum.

Public Consultation

11. The HA consulted the Kwai Tsing District Council (K&TDC) on 10 November 2020 in respect of the LKB expansion project. Members of the K&TDC in general supported the proposed project.

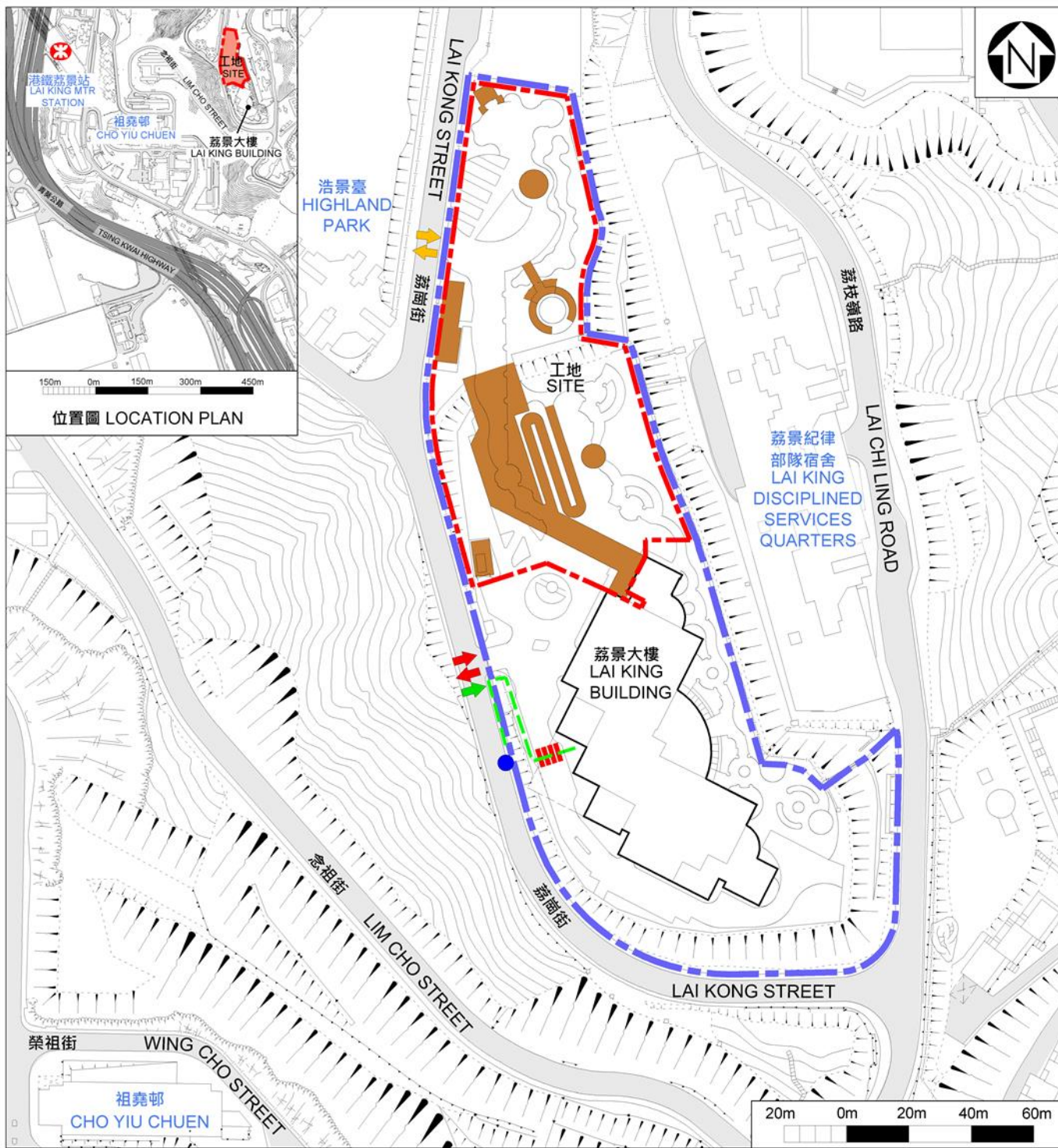

圖例 LEGEND

- | | | | | | |
|---|---|---|---|---|--|
|  | 醫院範圍
HOSPITAL BOUNDARY |  | 行人 / 無障礙出入口
PEDESTRIAN / BARRIER-FREE
ENTRANCE / EXIT |  | 車輛及救護車出入口
VEHICULAR AND AMBULANCE
INGRESS / EGRESS |
|  | 工地界線
SITE BOUNDARY |  | 無障礙通道
BARRIER-FREE ACCESS |  | 擬建車輛出入口
PROPOSED VEHICULAR
INGRESS / EGRESS |
|  | 現有行人過路處
EXISTING AT-GRADE PEDESTRIAN
CROSSING |  | 擬拆卸的樓宇及結構
BUILDINGS AND STRUCTURES TO
BE DEMOLISHED |  | 現有小巴士
EXISTING MINIBUS STOP |

工地平面圖
SITE PLAN

114MH
瑪嘉烈醫院荔景大樓擴建計劃
EXPANSION OF LAI KING BUILDING IN PRINCESS MARGARET HOSPITAL

An Update on the First Ten-year Hospital Development Plan

Introduction

In the 2016 Policy Address, the Government announced that \$200 billion would be set aside for the Hospital Authority (HA) to implement the First Ten-year Hospital Development Plan (HDP). The First Ten-year HDP comprises 16 projects, including the redevelopment and expansion of 11 hospitals, and the construction of a new acute hospital, three community health centres (CHCs) and one supporting services centre. Upon completion of all the projects under the First Ten-year HDP, it will provide more than 6 000 additional bed spaces, 94 additional operating theatres and increased capacity of specialist outpatient clinics and general outpatient clinics.

2. With the development and implementation of projects under the First Ten-year HDP over the past few years, we conducted a review to assess the current progress and scope of the projects under the First Ten-year HDP. The latest progress of the projects is set out in the ensuing paragraphs.

Overall Progress and Project Estimates

3. Since the implementation of the First Ten-year HDP, of the 16 projects, the Government has upgraded seven projects in full and seven projects in part to Category A at a total funding commitment of \$70,140.6 million, or 35.1% of the \$200 billion earmarked for the First Ten-year HDP.

4. In the 2020-21 legislative session, we plan to seek funding approval from the Legislative Council Finance Committee (FC) for three ongoing projects under the First Ten-year HDP¹. If the three proposed HDP projects are approved by the FC, the cumulative commitment approved would amount to \$109,550.0 million or 54.8% of the \$200 billion.

¹ The three projects include: (a) New Acute Hospital at Kai Tak Development Area – main works; (b) Expansion of North District Hospital – site formation and foundation works; and (c) Expansion of Lai King Building in Princess Margaret Hospital – site formation and foundation works. Details of these projects are at **Enclosures 1 to 3** respectively.

Update of Individual Projects under the First Ten-year HDP

5. In general, the HDP projects are in satisfactory progress and contained well within the approved project estimates. The summary of projects under the First Ten-year HDP with updated bed deliverables and estimated year of completion is at **Annex 1 to Enclosure 4**.

6. As there have been changes to some of the projects while the progress of some projects have been affected by other factors and will have their anticipated completion dates beyond 2025, we would like to provide more details of these individual projects for Members' information.

(a) Projects with changes

New Acute Hospital (NAH) at Kai Tak Development Area

7. To optimise the site utilisation of the NAH following the relaxation of maximum building height restriction in May 2018, additional floors of about 13 000 m² Net Operational Floor Area (NOFA) at the proposed Administration Block and Education Block will be constructed to provide clinical supporting services, requiring additional loading capacity to be incorporated as part of the foundation works. To mitigate the time impact for the additional loading as mentioned above and the time impact due to COVID-19, the HA plans to allow phased works commencement in the main works such that the construction of the Acute Block would start soonest possible, with an aim of completing the whole NAH project in 2025.

Redevelopment of Grantham Hospital (GH), Phase 1

8. The Town Planning Board (TPB) approved the HA's planning application to relax the building height restriction for the proposed Clinical Block of GH on 1 November 2019, thus allowing 100 additional beds and other clinical support areas to be provided upon redevelopment. The project is planned to be completed in 2025.

Redevelopment of Queen Mary Hospital (QMH), Phase 1

9. To suit the updated planning of Phase 2 redevelopment of the QMH under the Second Ten-year HDP involving the redevelopment of the existing Block K, various design changes for Phase 1 redevelopment are required, including omission of five link bridges and common entrance lobby connecting Block K, and addition of elevated walkway for future connection. In addition,

there will be an increase of about 2 650 m² NOFA for providing more clinical and supporting facilities and non-patient catering services. The design changes can be incorporated within the approved project estimate and the project is expected to be completed in 2024 as scheduled.

CHC in Shek Kip Mei and CHC at ex-Mong Kok Market site

10. Owing to the requirement of the historic building grading assessment on the existing Shek Kip Mei Health Centre, the project programme and the cost of the proposed CHC in Shek Kip Mei would be under review subject to the final grading assessment by the Antiquities and Monuments Office. In addition, the CHC project at ex-Mong Kok Market site will be tentatively replaced by a CHC project at Anderson Road. The Project Definition Statement of the project is being prepared.

(b) Projects with progress affected by other factors and with anticipated completion dates beyond 2025

Redevelopment of Our Lady of Maryknoll Hospital (OLMH)

11. The original estimated project completion date was 2024 (ref. PWSC(2018-19)4). The TPB approved the HA's planning application to relax the building height restriction for the proposed Clinical Block of the OLMH on 29 May 2020, thus allowing 145 additional beds to be provided upon completion of the redevelopment (on top of the additional 56 hospital beds under the original plan). The project is planned to be completed in 2026.

Redevelopment of Kwong Wah Hospital (KWH)

12. The original estimated project completion date was 2025 (ref. PWSC(2018-19)4). Owing to unforeseen underground conditions resulting in settlement of Tung Wah Museum, the basement excavation works of the KWH had been suspended since November 2018 for five months. Taking into account the impact of COVID-19 resulting in restriction of works and shortage in material supply and labour resources, the scheduled completion of the whole redevelopment project is revised to 2026.

Expansion of Lai King Building in Princess Margaret Hospital

13. The original estimated project completion date was 2024 (ref. PWSC(2019-20)7). The TPB approved the HA's planning application to relax the building height restriction for the proposed new extension block on

4 December 2020, thus allowing 172 additional beds and related clinical and supporting areas to be provided upon completion of the project (on top of the additional 400 hospital beds under the original plan). The project is planned to be completed in 2026.

Redevelopment of Prince of Wales Hospital, Phase 2 (Stage 1)

14. The decanting arrangements which are part of the preparatory works of the project have been completed, without the need for carrying out refurbishment to the existing Main Clinical Block and Trauma Centre. The original estimated project completion date was 2027 (ref. PWSC(2019-20)7). Demolition and foundation works commenced in December 2019 following funding approval by the FC in November 2019. Due to the impact of COVID-19 on the progress of detailed design, site works, as well as approval of various works-related submissions, the scheduled completion of the project is revised to 2028.

Expansion of North District Hospital

15. The original estimated project completion date was 2027 (ref. PWSC(2019-20)7). While funding approval for the preparatory works of the project was secured in November 2019, owing to the change in design in response to the revised site boundary after liaison with the local community, the project is planned to be completed in 2028.

Planning for Additional Isolation Facilities

16. The HA plans to provide about 320 additional Airborne Infection Isolation beds under the First Ten-year HDP. In addition, the HA will review the design of hospital projects under the First and the Second Ten-year HDPs taking into account the experience in combating COVID-19 and incorporate the required provisions for two to three general wards in each selected hospital to be readily converted into second-tier isolation wards for use in epidemic situations.

Way Forward

17. We will continue to exercise due diligence in taking forward the projects under the First Ten-year HDP to ensure timely delivery within the overall cost ceiling of \$200 billion. To ensure that future hospital developments can proceed expeditiously, the Government announced in the 2018 Policy Address

Enclosure 4

that in parallel with the implementation of projects under the First Ten-year HDP, the HA had been invited to commence planning for the Second Ten-year HDP in the next ten-year cycle (2026-2035) with a view to boosting its inpatient capacity, enhancing service quality, and renewing its building facilities. The initial planning and status of the projects under the Second Ten-year HDP were reported to this Panel on 15 April 2019 vide LC Paper No. CB(2)1167/18-19(07). A summary of the planned additional beds for each project under the Second Ten-year HDP is at **Annex 2 to Enclosure 4**. The HA targets to gradually commence preparatory works for the Second Ten-year HDP by 2026.

Summary of Projects under the First Ten-year Hospital Development Plan

Proposed Project	Planned Additional Beds ¹	Estimated Year of Completion
Expansion of Haven of Hope Hospital	160	2021
Extension of Operating Theatre Block for Tuen Mun Hospital	-	2022
Community health centre cum social welfare facilities at Pak Wo Road, North District	-	2023
Hospital Authority Supporting Services Centre	-	2024
Redevelopment of Queen Mary Hospital, Phase 1 – main works	-	2024
Expansion of United Christian Hospital – main works	560	2024 ²
Redevelopment of Kwai Chung Hospital	Phase 1	2025
	Phases 2 and 3	
New Acute Hospital at Kai Tak Development Area	2 400	2025
Redevelopment of Grantham Hospital, Phase 1	100	2025
Redevelopment of Our Lady of Maryknoll Hospital	201	2026
Redevelopment of Kwong Wah Hospital – main works	520	2026
Expansion of Lai King Building in Princess Margaret Hospital	572	2026
Expansion of North District Hospital	1 500	2028
Redevelopment of Prince of Wales Hospital, Phase 2 (Stage 1)	450	2028
Community Health Centre in Shek Kip Mei	-	- (Under review)
Community Health Centre at Anderson Road (Tentative)	-	- (To be confirmed)
Total	6 543	

¹ Actual number of additional beds of individual projects may be varied subject to detailed planning and design.

² The superstructure and refurbishment works and associated works are scheduled for completion in 2024, with the pedestrian linkages and associated works planned to be completed by 2025.

Summary of Projects under the Second Ten-year Hospital Development Plan

Hospital Cluster	Proposed Project	Planned Additional Beds ¹
Hong Kong East	Ambulatory Care Block at Pamela Youde Nethersole Eastern Hospital	500
Hong Kong West	Redevelopment of Grantham Hospital, Phase 2	550
	Redevelopment of Queen Mary Hospital, Phase 2	350
Kowloon East	Tseung Kwan O Hospital Extension	700
	Extension of United Christian Hospital	500
	Extension of Haven of Hope Hospital	340
Kowloon Central	New Hospital at King's Park Site ²	-
	Redevelopment of Wong Tai Sin Hospital	300
Kowloon West	Redevelopment of Princess Margaret Hospital	710
	Expansion of Caritas Medical Centre	500
	North Lantau Hospital, Phase 2	320
	Expansion of Yan Chai Hospital	300
New Territories East	Redevelopment of Prince of Wales Hospital, Phase 2 (Stage 2)	850
	Expansion of Tai Po Hospital / Alice Ho Miu Ling Nethersole Hospital	800
New Territories West	Redevelopment of Tuen Mun Hospital, Phase 1	-
	New Hospital in Hung Shui Kiu New Development Area	1 500
	Expansion of Tin Shui Wai Hospital	800
	Expansion of Pok Oi Hospital	300
	Community Health Centre in Yuen Long	-
Total		9 320

¹ Actual number of additional beds of individual projects may be varied subject to detailed planning and design.

² The current beds in Queen Elizabeth Hospital will be reprovided.