

L.N. 121 of 2025

**Hong Kong-Zhuhai-Macao Bridge Hong Kong Port and
Hong Kong Link Road Closed Area (Permission to
Enter) (Amendment) Notice 2025**

(Made by the Commissioner of Police under section 38A of the Public
Order Ordinance (Cap. 245))

1. Commencement

This Notice comes into operation on 1 August 2025.

**2. Hong Kong-Zhuhai-Macao Bridge Hong Kong Port and Hong
Kong Link Road Closed Area (Permission to Enter) Notice
amended**

The Hong Kong-Zhuhai-Macao Bridge Hong Kong Port and
Hong Kong Link Road Closed Area (Permission to Enter)
Notice (Cap. 245 sub. leg. M) is amended as set out in sections
3, 4 and 5.

3. Section 3 amended (permission to enter or leave)

Section 3—

Repeal

“the Schedule”

Substitute

“Schedule 1”.

4. Schedule amended (permission to enter or leave)

(1) The Schedule—

Renumber the Schedule as Schedule 1.

- (2) Schedule 1, Chinese text, Part 1, section 1, definition of **跨境**—

Repeal

“門。”

Substitute

“門；”。

- (3) Schedule 1, Part 1, section 1—

Add in alphabetical order

Airportcity Link (航天走廊) means the road system (consisting of a vehicular bridge with a pedestrian walkway and the Airportcity Link station platform), known as the Airportcity Link, delineated and shown edged red on Map 1;

Airportcity Link autonomous transportation system (航天走廊自動駕駛運輸系統) means the autonomous transportation system that is operated on the Airportcity Link;

Airportcity Link autonomous vehicle (航天走廊自動駕駛車輛) means an autonomous vehicle that is operated by the Airportcity Link autonomous transportation system;

Airportcity Link pedestrian walkway (航天走廊行人路) means the pedestrian walkway that forms part of the Airportcity Link;

Airportcity Link station platform (航天走廊車站平台) means the station platform of the Airportcity Link delineated and shown coloured blue on Map 1;

approved vehicle (獲准車輛) means a vehicle (other than an Airportcity Link autonomous vehicle) that is approved by the Airport Authority to be operated on the vehicular bridge of the Airportcity Link;

Map 1 (地圖1) means the map titled “MAP 1 - SECTION OF HONG KONG-ZHUHAI-MACAO BRIDGE HONG KONG LINK ROAD, HONG KONG-ZHUHAI-MACAO BRIDGE HONG KONG PORT AND ADJACENT AREAS”, numbered “ISM3745” and contained in Schedule 2;”.

(4) Schedule 1, Part 2—

Add

- “6. An intending passenger of an Airportcity Link autonomous vehicle leaving the Closed Area The passenger—
- (a) must not stay in any place other than the Airportcity Link station platform;
 - (b) may stay on the platform only for boarding the vehicle to leave the Closed Area; and
 - (c) must board the vehicle without undue delay.

Hong Kong-Zhuhai-Macao Bridge Hong Kong Port and Hong Kong Link Road
Closed Area (Permission to Enter) (Amendment) Notice 2025

L.N. 121 of 2025

B3907

Section 4

7. A passenger on an Airportcity Link autonomous vehicle leaving the Closed Area
- (a) Subject to paragraph (b), the passenger must not leave the immediate vicinity of the vehicle.
 - (b) In emergency circumstances, the passenger may leave the immediate vicinity of the vehicle—
 - (i) to board an approved vehicle deployed for rescue purposes; or
 - (ii) to otherwise get to safety.
8. A passenger on an Airportcity Link autonomous vehicle entering the Closed Area
- (a) Subject to paragraphs (b) and (c), the passenger must not leave the immediate vicinity of the vehicle.
 - (b) In emergency circumstances, the passenger may leave the immediate vicinity of the vehicle—

Hong Kong-Zhuhai-Macao Bridge Hong Kong Port and Hong Kong Link Road
Closed Area (Permission to Enter) (Amendment) Notice 2025

L.N. 121 of 2025
B3909

Section 4

- (i) to board an approved vehicle deployed for rescue purposes; or
- (ii) to otherwise get to safety.
- (c) After arriving at the Airportcity Link station platform, the passenger may leave the immediate vicinity of the vehicle, but must not stay in any place other than the platform.

9. A user or intending user of the Airportcity Link pedestrian walkway
- The user—
- (a) must not stay in any place other than the Airportcity Link station platform or Airportcity Link pedestrian walkway; and

(b) may stay on the platform or walkway only for using the walkway.

10. A person employed or otherwise engaged by the Airport Authority for the operation and maintenance of the Airportcity Link and Airportcity Link autonomous transportation system
- The person may stay in the Airportcity Link only for the operation and maintenance of the Airportcity Link and Airportcity Link autonomous transportation system.”.

5. **Schedule 2 added**
After Schedule 1—
Add

“Schedule 2

[Sch. 1]

Map 1

Hong Kong-Zhuhai-Macao Bridge Hong Kong Port and Hong Kong Link Road
Closed Area (Permission to Enter) (Amendment) Notice 2025

L.N. 121 of 2025
B3913

Section 5

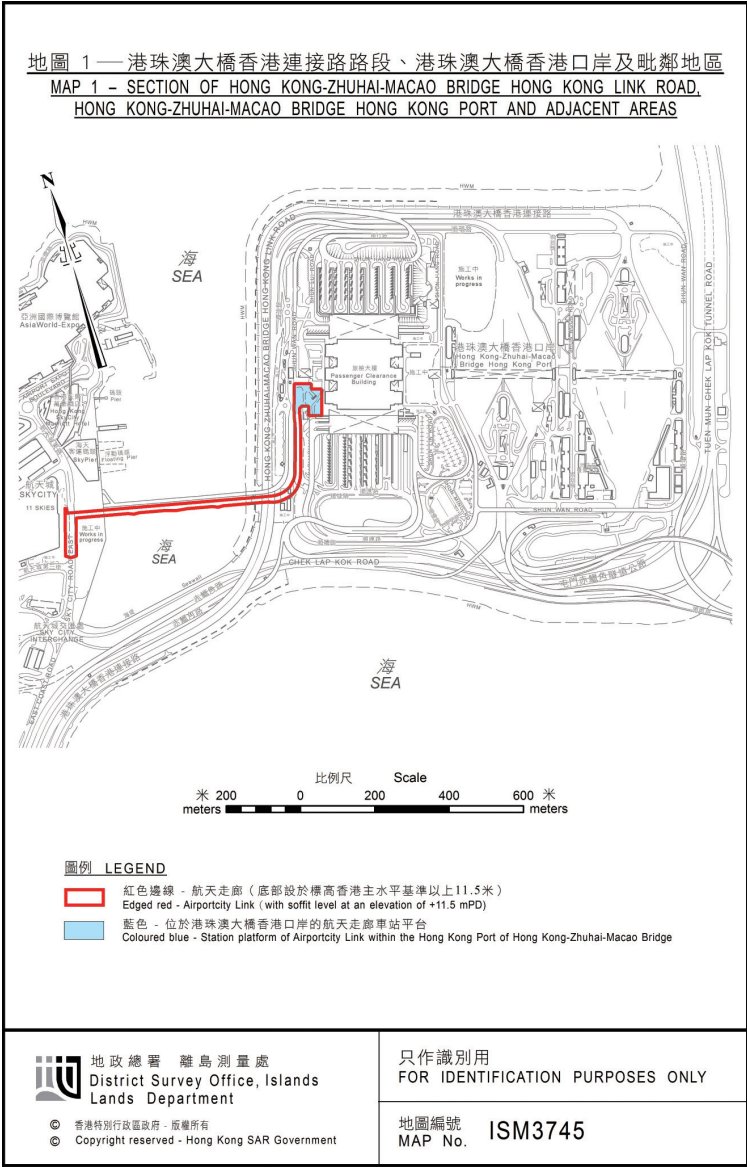

Hong Kong-Zhuhai-Macao Bridge Hong Kong Port and Hong Kong Link Road
Closed Area (Permission to Enter) (Amendment) Notice 2025

L.N. 121 of 2025
B3915

Joe CHOW Yat-ming
Commissioner of Police

29 May 2025

Hong Kong-Zhuhai-Macao Bridge Hong Kong Port and Hong Kong Link Road
Closed Area (Permission to Enter) (Amendment) Notice 2025

Explanatory Note
Paragraph 1

L.N. 121 of 2025
B3917

Explanatory Note

An area is declared as a closed area under the Closed Area (Hong Kong-Zhuhai-Macao Bridge Hong Kong Port and Hong Kong Link Road) Order (Cap. 245 sub. leg. L). This Notice amends the Schedule to the Hong Kong-Zhuhai-Macao Bridge Hong Kong Port and Hong Kong Link Road Closed Area (Permission to Enter) Notice (Cap. 245 sub. leg. M) (*Cap. 245M*) to grant permission to certain classes of persons to enter and leave the part of the new Airportcity Link that is located within the closed area.

2. This Notice also—
 - (a) renumbers the Schedule as Schedule 1; and
 - (b) adds a new Schedule 2, which contains a map that delineates the Airportcity Link, to Cap. 245M.