

**LegCo Panel on Education
Visit to schools on Thursday, 8 June 2000**

Brief Notes on Schools

Japanese International School

Mode of operation - Private, non-profit-making, co-educational, whole-day primary school

Age of school building - 3 years

Site area - around 9,200m² (layout plan attached)

Facilities - 40 classrooms, computer room, music room, art & crafts room, home economics room, 2 libraries, 2 science laboratories, indoor heated swimming pool, gymnasium and auditorium, covered outdoor playground, mini soccer pitch, administration area, lift and ancillary facilities.

Class/Enrolment (1999/2000) - Japanese stream: 16 classes; 527 pupils
English stream: 6 classes; 215 pupils
(including different nationalities, e.g. American, Australian, British, Canadian, Chinese, Japanese etc.)

Number of staff - Japanese stream: 1 Principal and 30 teachers
(including 4 part-time teachers)
English stream: 13 teachers
(including 2 part-time teachers)
The whole school has 16 non-teaching staff

Related information - An interest-free loan of amount HK\$44.8 million was provided to the school in July 1998.

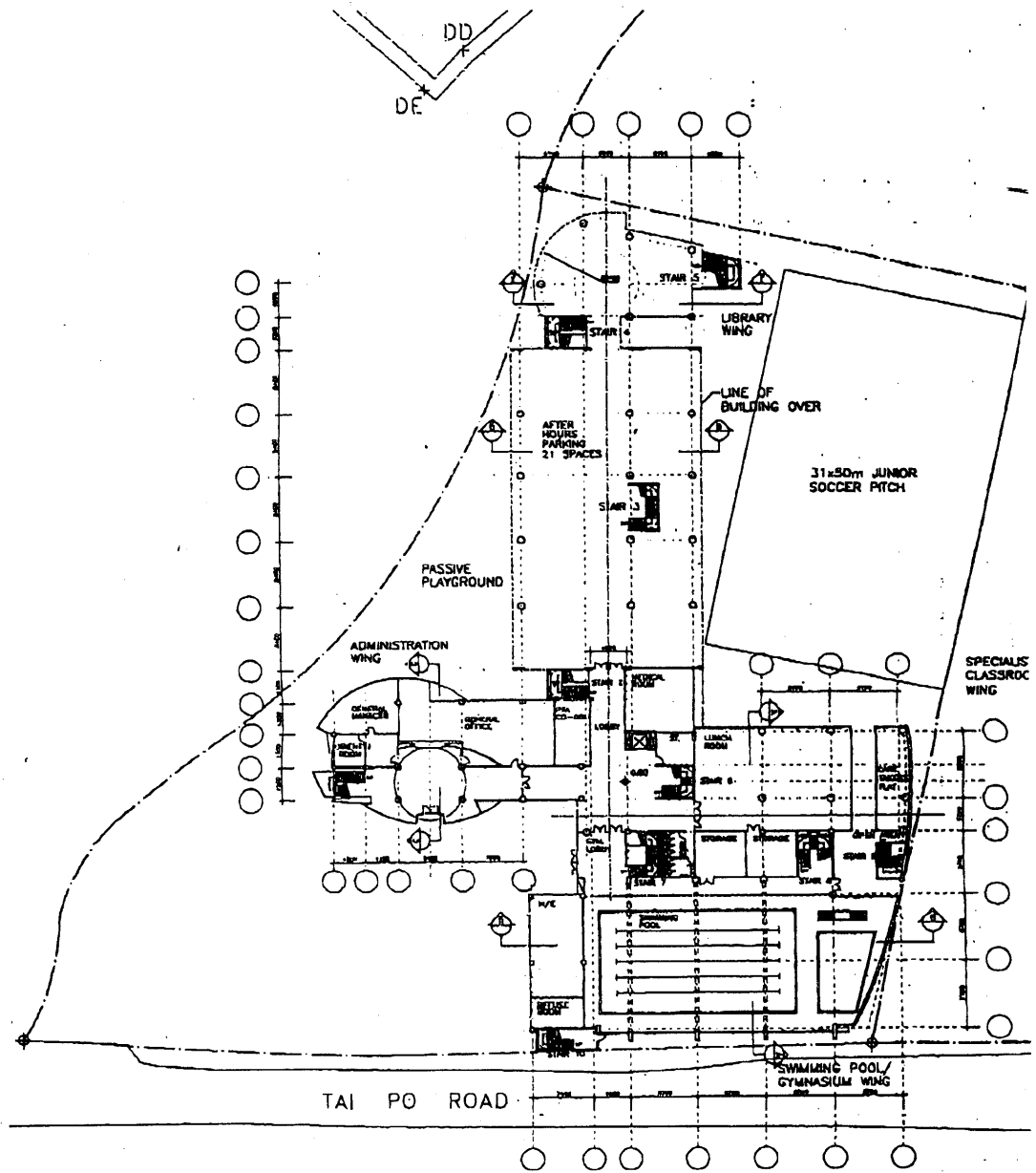

GROUND FLOOR PLAN

1:200 20-11-99 000000

PROPOSED HONG KONG JAPANESE

05-JUN-2000 17:02

Woo Chee Wong and Partners (HK) Limited
 Professional Engineers, Architects, Planners
 黃國賢建築師行 (香港) 有限公司

01/000000

01/000000

Baptist (Sha Tin Wai) Lui Ming Choi Primary School

Mode of operation - Aided, co-educational, whole-day primary school

Age of school building - 18 years (renovated and converted in 1999)

Site area - around 6,500m² (layout plan attached)

Facilities - 30 classrooms, music room, art & craft room, general studies room, multi-purpose room, library, student activity centre, computer assisted learning room, language room, 4 remedial teaching rooms, 2 interview rooms, demonstration room, observation room, guidance activity room, school history room, conference room, staff room, Principal's room, assembly hall, covered playground, open playground, 2 basketball courts, administration area.

Class/Enrolment - 25 classes; 884 pupils
(1999/2000)

Number of staff - 38 teachers and 11 non-teaching staff

Related information - Ex-premises of Annex of Sir Robert Black College of Education, renovated and converted in 1999 to accommodate the previous P.M. session of Baptist Lui Ming Choi Primary School for whole-day operation.

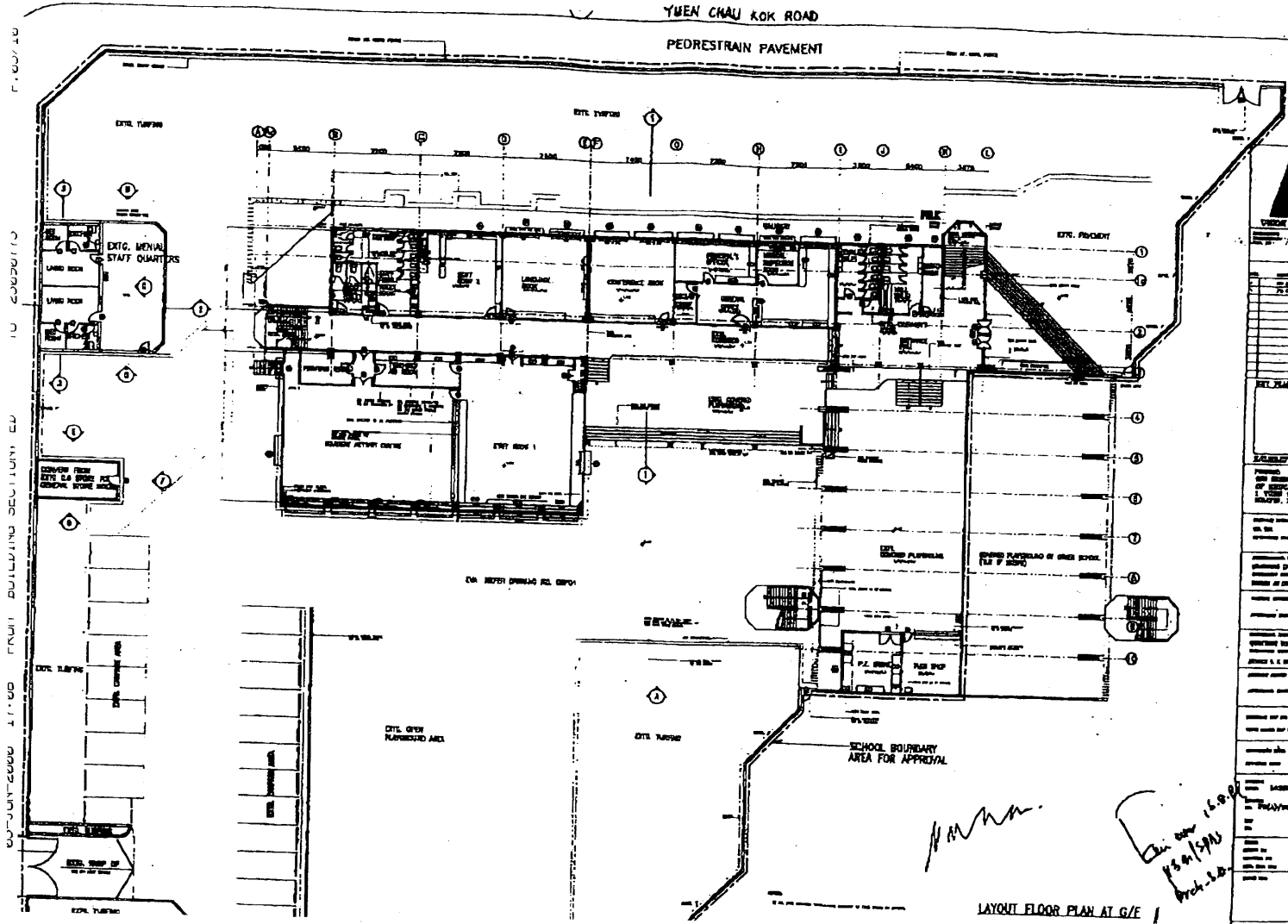

2 AUG 1999

NO.	REVISION	DATE
1	ISSUED FOR PERMIT	2 AUG 1999
2	FOR APPROVAL	2 AUG 1999

NO.	REVISION	DATE

GENERAL NOTES
 1. REFER TO THE ARCHITECT'S SPECIFICATIONS FOR MATERIALS AND FINISHES.
 2. ALL WORK TO BE IN ACCORDANCE WITH THE BUILDING REGULATIONS.
 3. THE CONTRACTOR SHALL BE RESPONSIBLE FOR OBTAINING ALL NECESSARY APPROVALS AND PERMITS.
 4. THE CONTRACTOR SHALL MAINTAIN ACCESS TO ALL ADJACENT PROPERTIES AT ALL TIMES.
 5. THE CONTRACTOR SHALL PROTECT ALL EXISTING UTILITIES AND STRUCTURES.
 6. THE CONTRACTOR SHALL MAINTAIN A SAFE WORKING ENVIRONMENT AT ALL TIMES.
 7. THE CONTRACTOR SHALL BE RESPONSIBLE FOR THE PROTECTION AND MAINTENANCE OF ALL ADJACENT PROPERTIES.
 8. THE CONTRACTOR SHALL BE RESPONSIBLE FOR THE PROTECTION AND MAINTENANCE OF ALL EXISTING UTILITIES AND STRUCTURES.
 9. THE CONTRACTOR SHALL BE RESPONSIBLE FOR THE PROTECTION AND MAINTENANCE OF ALL ADJACENT PROPERTIES.
 10. THE CONTRACTOR SHALL BE RESPONSIBLE FOR THE PROTECTION AND MAINTENANCE OF ALL EXISTING UTILITIES AND STRUCTURES.

PERMIT INFORMATION
 PROJECT NO. YC-99-001
 DRAWING NO. G/F-01
 DATE OF ISSUE: 2 AUG 1999
 EXPIRES: 2 AUG 2000
 ISSUED BY: YONG CONSTRUCTION LTD.
 CHECKED BY: [Signature]
 APPROVED BY: [Signature]

APPROVALS
 ARCHITECT: [Signature]
 ENGINEER: [Signature]
 SURVEYOR: [Signature]
 CONTRACTOR: [Signature]

SCALE
 1:500
 1:1000

NO.	REVISION	DATE

LAYOUT FLOOR PLAN AT G/F

[Handwritten signature]

[Handwritten note: 2000-08-16, 15:00, 13/01/1998, Arch. 2.0]

1:500/1:1000

1:500/1:1000

1:500/1:1000

Hennessy Road Government Primary School

Mode of operation - government, co-educational, bi-sessional primary school

Age of school building - 31 years.

Site area - around 1,500m² (layout plan attached)

Facilities - 30 classrooms, 5 remedial teaching rooms, 1 music room, 2 computer rooms, 1 art & craft room, 1 library, 2 interview rooms, 1 student activity centre, 2 staff rooms, 1 staff common room, 2 covered playgrounds, 1 basketball court, 2 roof playgrounds, administration area, lift and ancillary facilities.

Class/Enrolment - AM - 30 classes; 1013 pupils
(1999/2000) PM - 30 classes, 991 pupils

Number of staff - 44 teachers per session. The whole school has 16 non-teaching staff.

Related information - This school completed SIP in August 1998.

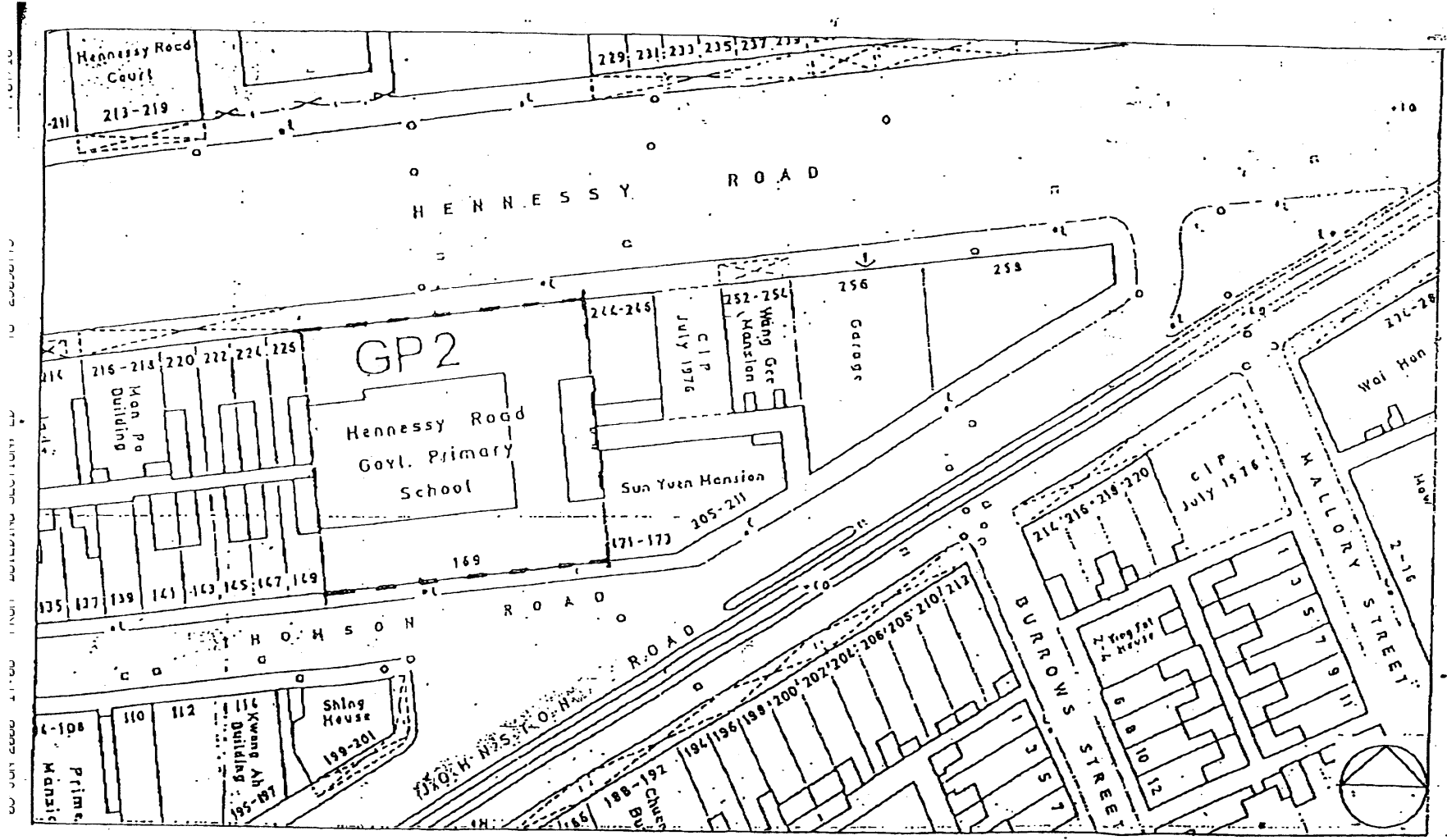

PRELIMINARY

St Mary's Church College

Mode of operation - Aided, co-educational, grammar secondary school

Age of school building - Block A & B - 41 years; Block C - 37 years

Site area - around 1,600m² (layout plan attached)

Facilities - 22 classrooms, 1 Physics laboratory, 1 Chemistry laboratory, 1 Biology laboratory, 2 computer rooms, 1 music room, 1 art room, 1 library, 1 conference room, 8 staff rooms, 1 social worker's office, 1 hall, 1 basketball court, administration area and ancillary facilities

Class/Enrolment (1999/2000 school year) - 25 classes; 819 pupils

Number of staff - 52 teachers (including 2 laboratory technicians) and 17 non-teaching staff

Related information - This school was first included in phase 2 of SIP. Due to site constraint and structural condition, construction of annex was not feasible. Conversion work was proposed.

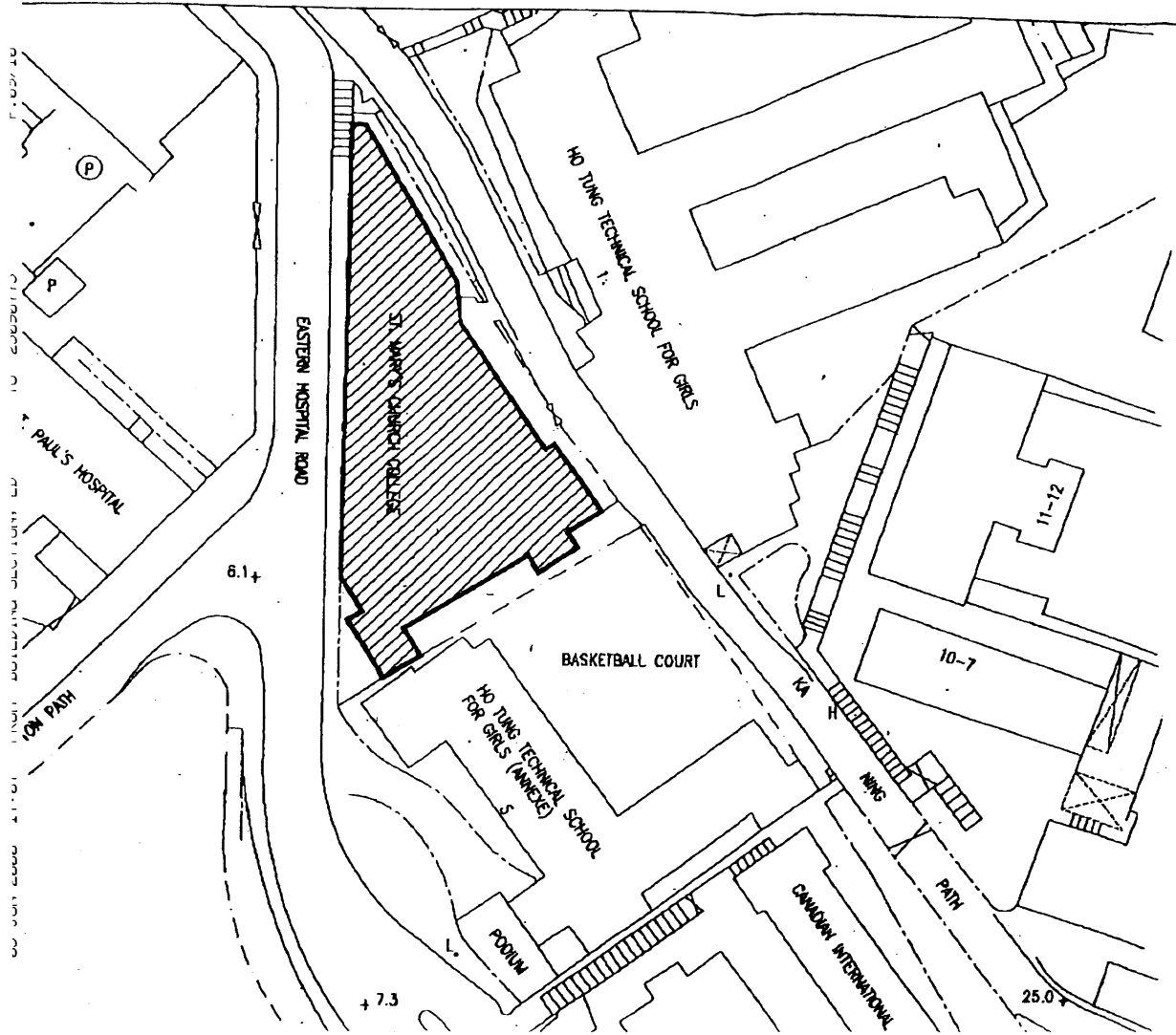



LD Asia
Landscape Planning & Design

S21111 ST MARY'S CHURCH COLLEGE
3 EASTERN HOSPITAL
CAUSEWAY BAY HONG KONG

**SCHOOL EMPLOYMENT
PROGRAMME FRAME ELI PACKAGE 3**

Drawn	Checked
Date	Date

LD Asia Project Reference: **S2130 (P210)**

All Drawing Number: **A4/B110/2010/2A/001**

Scale: 1:500

Drawing Title: **SITE PLAN**

P. 09

98%

+852 2573 3467

05-JUN-2000 17:04

附件一

不同年代的校舍設計所提供的體育運動設施

		60至70年代 或以前	70至 80年代	90年代初	1997 年設計	2000 年設計
佔地面積(m ²)	中學	少於 5000	5800	5850	6950	6950
	小學	2230	3900	5005	6200	6200
籃球場數目 (地面)*	中學	1	1	1	2	2
	小學	1	1	1	2	2
籃球場數目 (在禮堂頂)	中學	-	-	-	-	1
	小學	-	-	-	-	1
禮堂(m ²)	中學	1個	368	368	368	368
	小學	1個	283	368	368	368
學生活動中心 (m ²)	中學	-	-	-	176	176
	小學	-	-	-	176	176
有蓋操場(m ²)	中學	1個	446	766	766	766
	小學	1個	446	766	766	766
多用途場地 (m ²)	中學	-	-	-	-	580
	小學	-	-	-	-	525
露天空間	中學	-	-	每學生 1.13m ²	每學生 2m ²	每學生 2m ²
	小學	-	-	每學生 1.13m ²	每學生 2m ²	每學生 2m ²

* 籃球場的數目須視乎學校用地的大小及形狀而定。

學校數目	中學	小學	總計
	100 (24.8%)	201 (49.9%)	59 (14.6%)
	31 (7.7%)	12 (3%)	403
	253 (47.9%)	173 (32.8%)	49 (9.3%)
	29 (5.5%)	24 (4.5%)	528